

ITEM NO.	Part_Code	PART NUMBER	DESCRIPTION	QTY.
1	60541	9-81129	Anvil - FAE-4 (12 & 14 Ga.)	1
2	60123	9-FAE	Anvil	1
3	63737	9-FAE-3	Anvil - FAE-3 (14, 16, 18 Ga.)	1
4	100434	9-FAE-7	Anvil (10 & 12 Ga.)	1
5	60369	11-FAE	Plunger	1
6	60819	13-14324	Wire Rolling Tool FAE-7 (10 & 12 Ga.)	1
7	60496	13-81129	Wire Rolling Tool FAE-4 (12 & 14 Ga.)	1
8	60124	13-FAE	Wire Rolling Tool	1
9	63736	13-FAE-3	Wire Rolling Tool FAE-3 (14, 16, 18 Ga.)	1
10	69859	169	Gib	2
11	60147	176-FAE	Guard	1
12	63718	205-FAE	Base Plate	1
13	100330	1800-FAE	FAE-ECC Extended Parts Magazine *optional	1
14	62956	CS-101-BRIDGE	Casting	1
15	77634	CS-110	Plunger Shank	1
16	63719	DP-FAE	Die Plate	1
17	60146	FG-FAE	Front Guide	1
18	63720	RG-FAE	Rear Guide	1
19	63721	SLIDE-BRD	Slide	1
20	63722	SSET-FAE	Slide Set	1
21	62958	SSTOP-BRD	Slide Stop	1
22	63723	TG-FAE	Top Guide	1
23	60145	WG-FAE	Wire Guide	1
24	64058	WG-FAE-1	Wire Guide	1
25	60412	WSR-BRD	Wire Separator Retainer	1
26	69618	Carr Lane #CL-51-SPS-1	Short Spring Plunger	1
27	63506	McMaster-Carr #1095K11	1/8 NPT Grease Fitting	1
28	73785	SPI 99-602-5	#10 Black Knurled Knob	1
29	63724	5-40_38fh	#5-40 x 3/8" Flat Hd Socket Screw	2
30	63726	5-40_38sh	#5-40 x 3/8" Socket Hd Cap Screw	5
31	63209	6-32_38sh	#6-32 x 3/8" Socket Hd Cap Screw	2
32	63161	8-32_38sh	#8-32 x 3/8" Socket Hd Cap Screw	6
33	63164	8-32_50sh	#8-32 x 1/2" Socket Hd Cap Screw	6
34	63727	10fw-bn	#10 Narrow Flat Washer	2
35	63167	10-32 hn	#10-32 Hex Nut	1
36	70110	10-32_38sh	#10-32 x 3/8" Socket Hd Cap Screw	2
37	63056	10-32_50sh	#10-32 x 1/2" Socket Hd Cap Screw	1
38	63158	3.16_50dp	Ø 3/16" x 1/2" Dowel Pin	2
39	63155	10-32_1.00sh	#10-32 x 1" Socket Hd Cap Screw	1
40	63510	1.4_1.00dp	1/4 x 1" Dowel Pin	2
41	63168	1.4-20_1.00sh	1/4-20 x 1" Socket Hd Cap Screw	2
42	62622	1.2_75shss	1/2" x 3/4" Socket Hd Shoulder Screw	1

NOTE: ITEMS MARKED IN BOLD TEXT ARE HIGH WEAR ITEMS.

FAE-ECC
79182

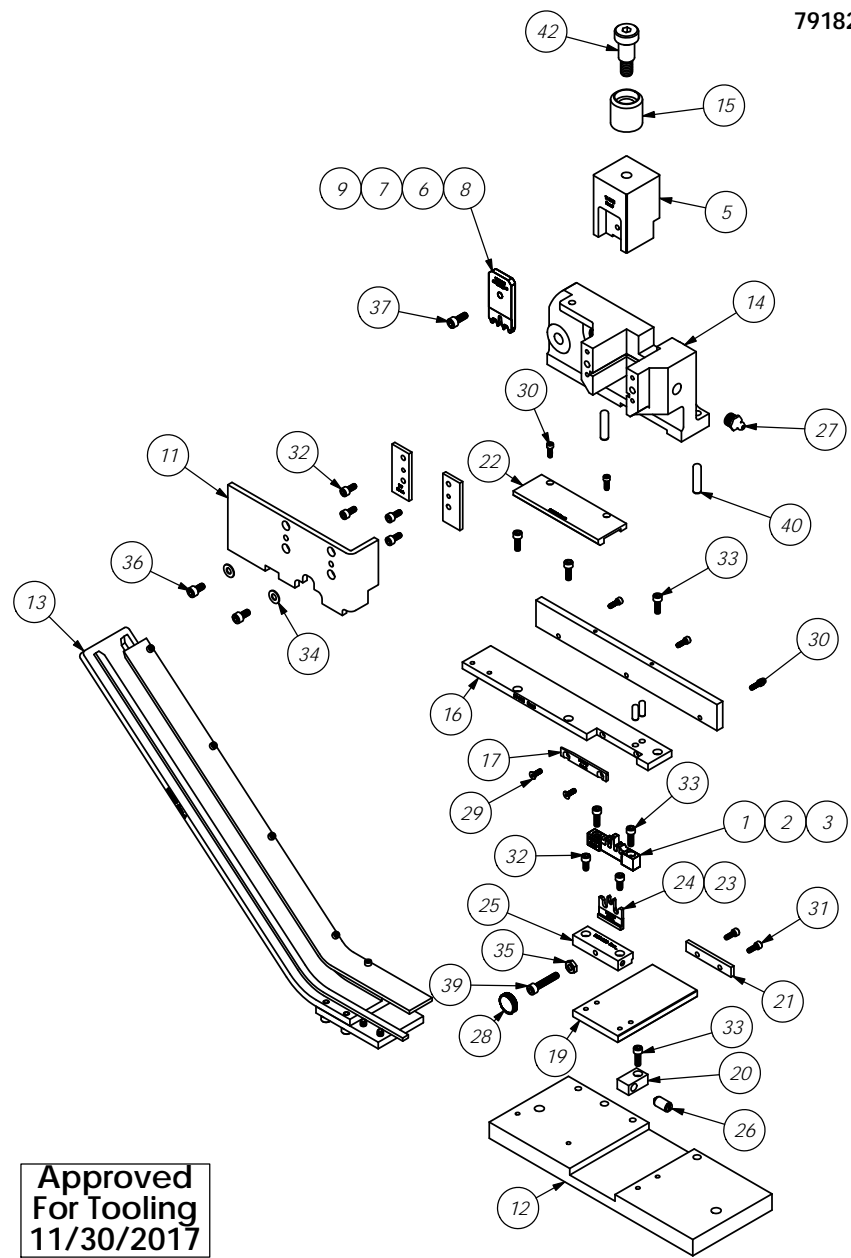

REV	DESCRIPTION	DATE	BY	QTY	USED ON	SCALE	CAD FILE	CHECKED BY	DATE	DATE	DATE
E	ECR# 4885 SCJ	12/09/17									
D	Added Magazine option SCJ	07/27/17									
C	ECR# 2476 SCJ	09/07/13									
B	Added 9-FAE-3 & 13-FAE-3 SCJ	12/08/12									
A	Added missing part codes SCJ	11/28/12									

ITEM NO.	PART NO.	DESCRIPTION	MATERIAL	QTY
1	9-81129	Anvil - FAE-4 (12 & 14 Ga.)	FAE	1
2	9-FAE	Anvil	FAE	1
3	9-FAE-3	Anvil - FAE-3 (14, 16, 18 Ga.)	FAE	1
4	100434	Anvil (10 & 12 Ga.)	FAE	1
5	60369	Plunger	FAE	1
6	60819	Wire Rolling Tool FAE-7 (10 & 12 Ga.)	FAE	1
7	60496	Wire Rolling Tool FAE-4 (12 & 14 Ga.)	FAE	1
8	60124	Wire Rolling Tool	FAE	1
9	63736	Wire Rolling Tool FAE-3 (14, 16, 18 Ga.)	FAE	1
10	69859	Gib	FAE	2
11	60147	Guard	FAE	1
12	63718	Base Plate	FAE	1
13	100330	FAE-ECC Extended Parts Magazine *optional	FAE	1
14	62956	CS-101-BRIDGE	FAE	1
15	77634	CS-110	FAE	1
16	63719	DP-FAE	FAE	1
17	60146	FG-FAE	FAE	1
18	63720	RG-FAE	FAE	1
19	63721	SLIDE-BRD	FAE	1
20	63722	SSET-FAE	FAE	1
21	62958	SSTOP-BRD	FAE	1
22	63723	TG-FAE	FAE	1
23	60145	WG-FAE	FAE	1
24	64058	WG-FAE-1	FAE	1
25	60412	WSR-BRD	FAE	1
26	69618	Carr Lane #CL-51-SPS-1	FAE	1
27	63506	McMaster-Carr #1095K11	FAE	1
28	73785	SPI 99-602-5	FAE	1
29	63724	5-40_38fh	FAE	2
30	63726	5-40_38sh	FAE	5
31	63209	6-32_38sh	FAE	2
32	63161	8-32_38sh	FAE	6
33	63164	8-32_50sh	FAE	6
34	63727	10fw-bn	FAE	2
35	63167	10-32 hn	FAE	1
36	70110	10-32_38sh	FAE	2
37	63056	10-32_50sh	FAE	1
38	63158	3.16_50dp	FAE	2
39	63155	10-32_1.00sh	FAE	1
40	63510	1.4_1.00dp	FAE	2
41	63168	1.4-20_1.00sh	FAE	2
42	62622	1.2_75shss	FAE	1

REV	DESCRIPTION	DATE	BY	QTY	USED ON	SCALE	CAD FILE	CHECKED BY	DATE	DATE	DATE
1	FAE-ECC	11/28/12	JT			7:3					