

ITEM NO.	Part_Code	PART NUMBER	DESCRIPTION	QTY.
<b>1</b>	<b>61801</b>	<b>9-82051-1</b>	<b>Anvil</b>	<b>1</b>
2	100302	11-82050	Plunger	1
3	100258	11A-82050	Plunger Block	1
<b>4</b>	<b>100350</b>	<b>13-82051</b>	<b>Wire Rolling Tool</b>	<b>1</b>
5	60410	16-82050	Spacer	1
6	100354	16A-82050	Stripper Handle	1
7	100351	101-82050	Casting	1
8	69859	169	Gib	2
9	100356	176-82050	Guard	1
10	100320	205-82050	Base Plate	1
11	77634	CS-110	Plunger Shank	1
12	100353	RB-82050	Retainer Block	1
13	100352	SH-82050	Slide Holder	1
14	62958	SSTOP-BRD	Slide Stop	1
15	60411	TH-82050	Terminal Holder	1
16	100355	THS-82050	Tool Holder Stop	1
17	60332	TS-82050	Terminal Stop	1
18	63506	McMaster-Carr #1095K11	1/8 NPT Grease Fitting	1
19	73785	SPI 99-602-5	#10 Black Knurled Knob	1
20	63209	6-32_38sh	#6-32 x 3/8" Socket Hd Cap Screw	2
21	63163	8-32_25sh	#8-32 x 1/4" Socket Hd Cap Screw	2
22		8-32_31fh	#8-32 x 5/16" Flat Head Socket Screw	1
23	100091	8-32_31sh	#8-32 x 5/16" Socket Hd Cap Screw	6
24	63161	8-32_38sh	#8-32 x 3/8" Socket Hd Cap Screw	6
25	70110	10-32_38sh	#10-32 x 3/8" Socket Hd Cap Screw	4
26	63165	10-32_44sh	#10-32 x 7/16" Socket Hd Cap Screw	1
27	63155	10-32_1.00sh	#10-32 x 1" Socket Hd Cap Screw	2
28	77396	10-32_1.25sh	#10-32 x 1 1/4" Socket Hd Cap Screw	1
29	63510	1.4_1.00dp	1/4 x 1" Dowel Pin	2
30	62622	1.2_.75shss	1/2" x 3/4" Socket Hd Shoulder Screw	1

NOTE: ITEMS MARKED IN BOLD TEXT ARE HIGH WEAR ITEMS

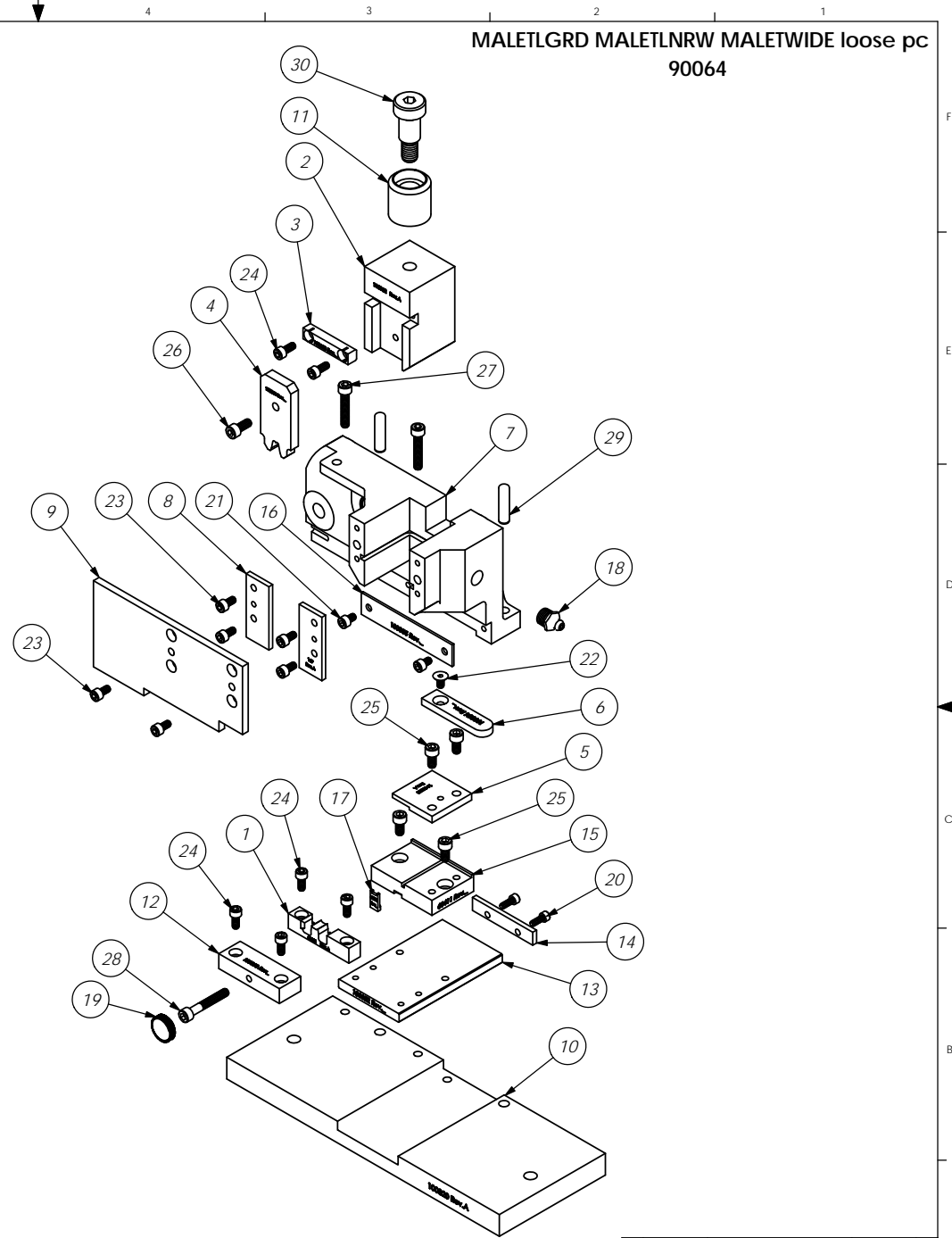

REV. NO.	PART No.	DESCRIPTION	MATERIAL SPECIFICATION	QTY. REQ'D
		See Parts List	ECC loose pc	
<p>DO NOT SCALE DRAWING</p> <p>UNLESS OTHERWISE SPECIFIED DIMENSIONS ARE IN INCHES. TOLERANCES ARE:</p> <p>FRACTIONS: DECIMALS: ANGLES:</p> <p>1/164 XX ±.01 ±1/8°</p> <p>XXXX ±.0002</p> <p>SURFACE FINISH: <input checked="" type="checkbox"/> ALL OVER</p> <p>THE INFORMATION CONTAINED WITHIN THE DRAWING IS THE SOLE PROPERTY OF ETCO INCORPORATED. ANY REPRODUCTION IN PART OR WHOLE WITHOUT THE WRITTEN PERMISSION OF ETCO INCORPORATED IS PROHIBITED.</p>				
		Redrawn in SW from Board SCJ	7/10/17	
LVL	REVISION	BY/DATE	QTY	USED ON
			7:2	APPLICATION
			CAD FILE	CHECKED BY: DATE: DRAWN BY: DATE: SIZE: C
			SCJ	7/10/17

MALETLGRD MALETNRW MALETWIDE loose pc 90064

ETCO ENGINEERED PRODUCTS  
25 BELLOWS STREET  
WARWICK, RI 02888 (401)-467-2400

MALETLGRD MALETNRW  
MALETWIDE loose pc

7/19/2017