

Rev.	Description of Change/ SCN#	Date
-	Approved For Mfg SCJ	2/24/16

ASSEMBLY ITEM	P/C	DESCRIPTION	MAT'L	PLATING
TERMINAL #1	14352	RE187N-PCB-HB	BRASS	NONE
TERMINAL #2	14356	CF156F-PCB-HB	BRASS	NONE
TERMINAL #3	14356	CF156F-PCB-HB	BRASS	NONE
HOUSING	81050	FAE-1	POLYCARBONATE	N/A

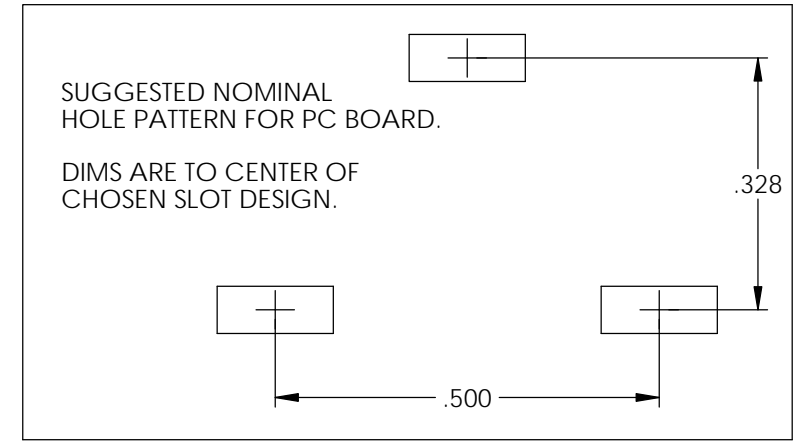
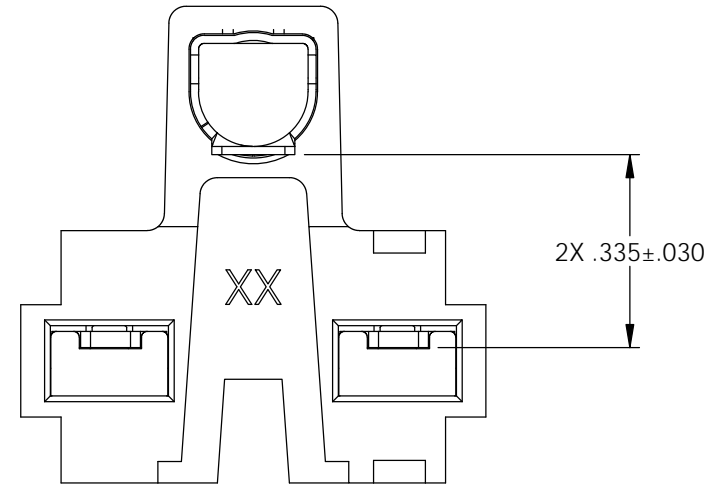
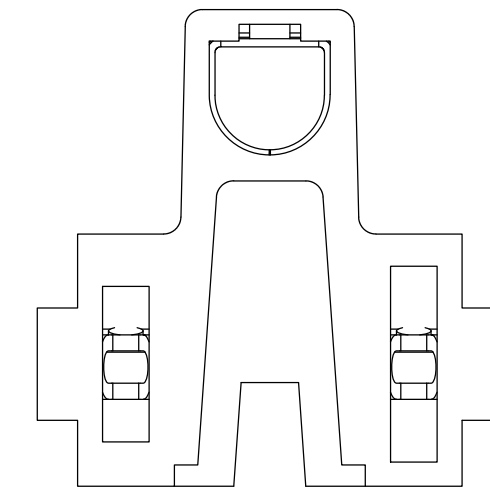
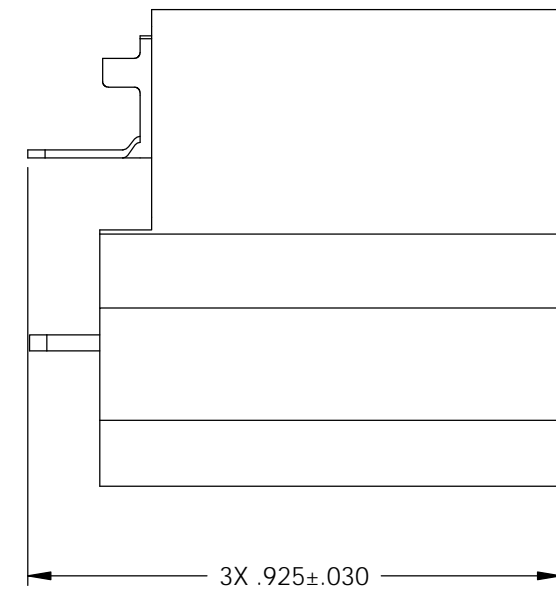
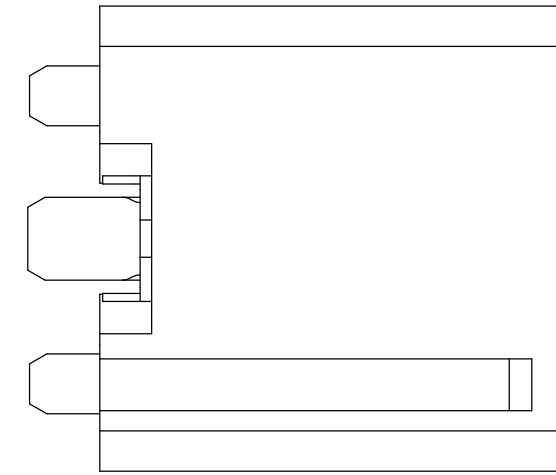
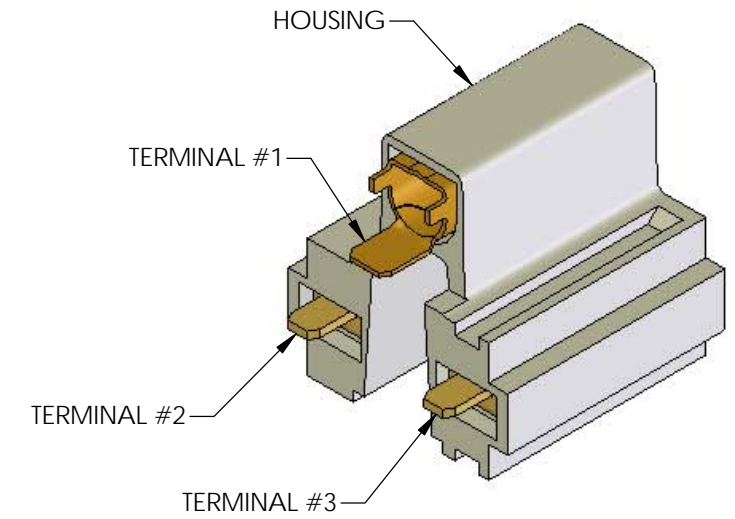

# UNCONTROLLED COPY

<p>THIRD ANGLE PROJECTION TOLERANCES UNLESS OTHERWISE SPECIFIED INCHES: .XX - ±.030 .XXX - ±.015 ANGLES: ±5°</p>	<p>TOOL NO. <b>0861</b></p>	<p>Title: <b>FEMALE BRIDGE HOUSING FOR PC BOARD-P/C 37046</b></p>		
		<p>DO NOT SCALE DWG.</p>	<p>Drawn By: S.Johnson</p>	<p>Date: 3/12/14</p>
<p>ETCO Incorporated Engineered Products 25 Bellows Street Warwick, RI 02888 Phone: (401) 467-2400 Fax: (401) 467-9230 www.ETCO.com</p>		<p>Chk'd/App'd By:</p>	<p>Scale: 3X</p>	<p>Size B</p>
<p>Dwg. No.:</p>			<p><b>FAE-PCB-IR1900</b></p>	