

NOTES:

- MAT'L: .016 THK, BRASS,  
#4 TEMPER (FULL HARD)  
PRE-ELECTRO SILVER PLATE: .000120 MIN THK.  
OVER NICKEL: .000050 MIN THK.  
PER ETCO METAL CODE 3-6023.
- ACCEPTED MALE TAB: .032 X .250
- WIRE RANGE: 18-14 AWG
- INSULATION DIAMETER RANGE:  $\phi$ .125-.155
- INSULATOR TEMP RATING: 150°C MAX.
- INSULATOR FLAMIBILITY RATING: UL94 V-0
- VOLTAGE RATING: 600 V MAX,  
1000 V MAX if used inside a fixture or sign.
- A BLACK INK IDENTIFYING STRIPE IS TO BE APPLIED TO THE INSULATOR APPROXIMATELY AS SHOWN.

P/C	DESCRIPTION	TERMINAL P/C	TERMINAL DESCRIPTION	TERMINAL MAT'L	INSULATOR P/C	INSULATOR MAT'L
30133	PDF224-FR-SHB	07996	DF224-SHB	NOTE 1	81120	6/6 NYLON FR

Rev.	Description of Change/ SCN#	Date
-	Initial Release ECR# 6691 SCJ	1/24/22

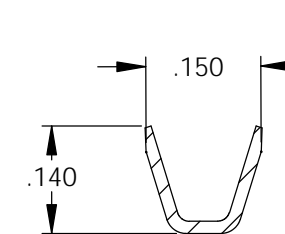
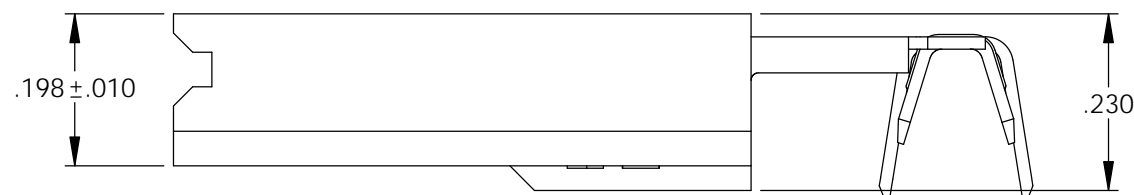

SECTION A-A  
SCALE 4 : 1

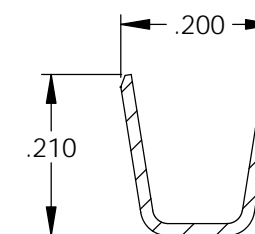

SECTION B-B  
SCALE 4 : 1

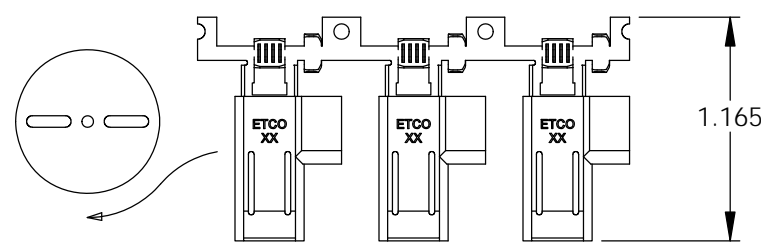
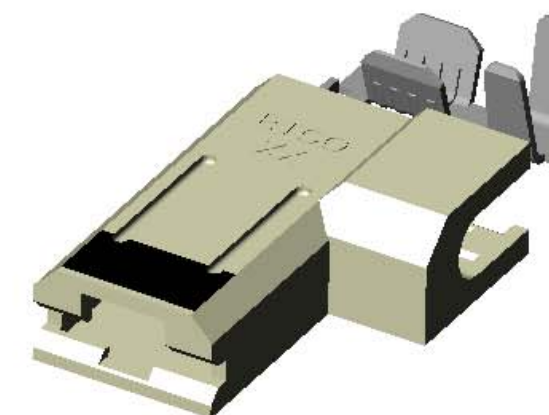
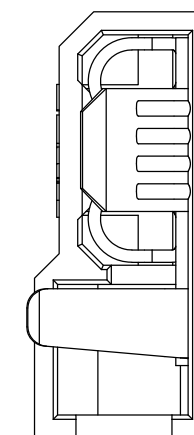
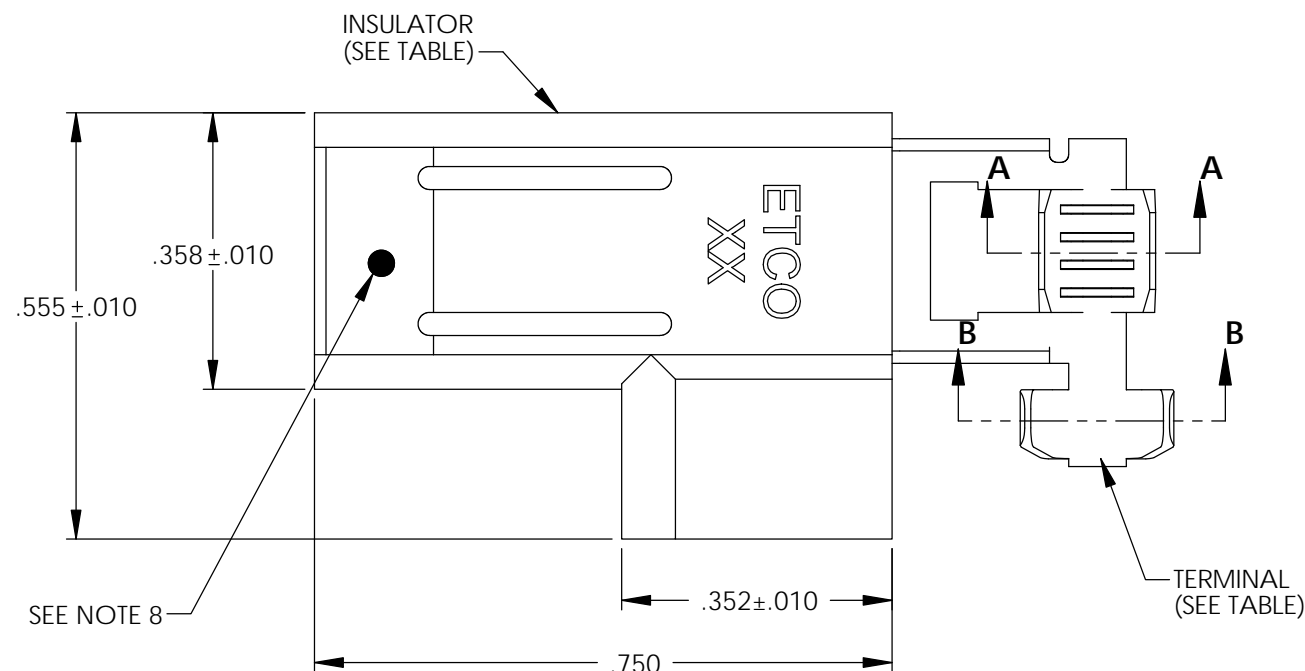

DIRECTION EXITING TOOL,  
RIGHT TO LEFT, EARS UP TO THE BACK

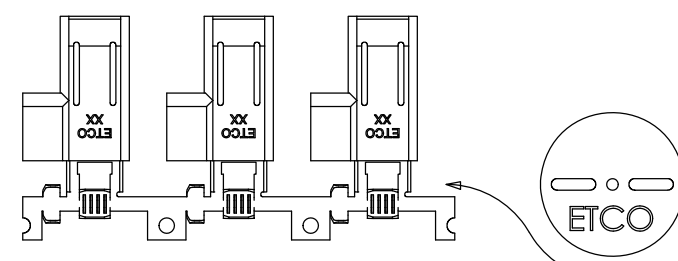

DIRECTION TOWARD APPLICATOR  
RIGHT TO LEFT, EARS UP, TO THE FRONT

THIS PRINT IS THE PROPERTY OF ETCO INCORPORATED. NO PART OF THIS DESIGN MAY BE USED IN ANY WAY WITHOUT WRITTEN CONSENT FROM ETCO INCORPORATED.

# UNCONTROLLED COPY

<p>THIRD ANGLE PROJECTION TOLERANCES UNLESS OTHERWISE SPECIFIED INCHES: .XX - ±.030 .XXX - ±.015 ANGLES: ±5°</p>	<p>TOOL NO. <b>0973</b></p>	<p>Title: <b>1/4" FLAG DISCONNECT ASSEMBLY</b></p>		
		<p>DO NOT SCALE DWG.</p>	<p>Drawn By: S.JOHNSON Date: 2/08/21</p>	<p>Design Control By: ETCO</p>
<p>ETCO Incorporated Engineered Products 25 Bellows Street Warwick, RI 02888 Phone: (401) 467-2400 Fax: (401) 467-9230 www.ETCO.com</p>		<p>Dwg. No.: <b>PDF224-SHB cust</b></p>	<p>Scale: 4X</p>	<p>Size B</p>