

Parts List					Parts List				
Item	Part Code	QTY.	Part No./File Name	Description	Item	Part Code	QTY.	Part No./File Name	Description
1	70753	1	9A-4007	Insulation Anvil	69	61993	1	MX358-2-ITD-S	Valve Mounting Plate
2	70752	1	9-4007	Wire Anvil	70	78835	1	MX360-ITD-S	Scrap Retainer
3	70748	1	13-4007	Wire Rolling Tool	71	72350	1	5-047x1.000	Compression Spring
4	70749	1	14-4007	Insulation Rolling Tool	72	72317	1	Clippard #12296	Cam Follower
5	73888	2	GS-125	Guard Spacer	73	72318	1	Clippard MJV-3	3-Way Valve
6	71494	1	MX2A-S-1	Mounting Frame	74	75083	2	Irving 3100-18	External Retaining Ring
7	71030	1	MX2B-S	Plunger Frame	75	72315	1	LC-022A-4	Compression Spring
8	74343	1	MX3	Ram	76	78681	2	LC-029B-3-M	Compression Spring
9	74438	1	MX5-S	Cam Rack	77	74611	1	LE-037CD-6	Extension Spring
10	74346	1	MX6-1	Gear Arm	78	70739	2	McMaster-Carr #3126A53	Spring Plunger
11	74347	1	MX7	Cam Pin	79	74447	1	McMaster-Carr #98296A109	Expansion Pin (1/16 x 1/2")
12	74350	1	MX8	Cam Roller	80	73222	1	Pisco PC250-N1U	1/4" x 1/8" NPT Straight
13	74351	2	MX10-S	Rack Pad	81	72352	3	Pisco PL250-N1U	Ø1/4" x 1/8" NPT Elbow Fitting, White
14	74352	2	MX11	Gib	82	63200	2	Truarc #5555-12	Retaining Ring
15	74356	1	MX12	Feed Finger Pivot Pin	83	63201	2	Vlier #PH-51-P	Spring Plunger
16	74360	1	MX13	Adjusting Bar	84	63202	2	4lw	#4 Lock Washer
17	76868	1	MX14-1-S	Feed Finger Arm	85	63203	2	4-40_13bh	#4-40 x 1/8" Button Hd Cap Screw
18	76874	1	MX15-1-S	Feed Finger Guide	86	63204	2	4-40_16sh	#4-40 x 5/32" Socket Hd Cap Screw
19	74364	1	MX16	Retainer	87	63205	1	1.8_38rp	Ø 1/8" x 3/8" Roll Pin
20	71495	1	MX18-S-1	Swing Arm	88	63053	2	1.8_63rp	1/8" x 5/8" Roll Pin
21	74376	1	MX25	Stroke Adjustment Screw	89	62040	1	1.8_1.00rp	1/8" x 1" Roll Pin
22	74407	1	MX33	Mounting Post	90	63206	2	5-40_19ssf	#5-40 x 3/16" Socket Set Screw
23	72103	1	MX34-F	Wire Crimp Dial	91	63207	6	6-32_25sh	#6-32 x 1/4" Socket Hd Cap Screw
24	74409	1	MX35	Insulation Dial	92	63209	4	6-32_38sh	#6-32 x 3/8" Socket Hd Cap Screw
25	74411	1	MX36	Dial Spacer	93	63057	2	6-32_50fh	#6-32 x 1/2" Flat Hd Cap Screw
26	74412	1	MX44	Locating Dowel	94	63210	2	8fv	#8 Flatwasher
27	74415	1	MX45-S	Feed Finger Spring	95	63211	2	8-32_13ssf	#8-32 x 1/8" Socket Hd Set Screw
28	74419	3	MX50	Safety Pivot Pin	96	63212	1	8-32_25bh	#8-32 x 1/4" Button Hd Cap Screw
29	71493	2	MX52-S-1	Pivot Pin	97	63052	2	8-32_50fh	#8-32 x 1/2" Flat Hd Cap Screw
30	74614	1	MX90-S	Spring Bracket	98	63164	2	8-32_50sh	#8-32 x 1/2" Socket Hd Cap Screw
31	72310	1	MX104	Wave Disc Spring	99	63162	2	8-32_63sh	#8-32 x 5/8" Socket Hd Cap Screw
32	71678	1	MX105-S	Pivot Pin Plate	100	63213	1	8-32_1.00sh	#8-32 x 1" Socket Hd Cap Screw
33	72167	1	MX301-7-ITD-S	Latching Gate	101	63158	4	3.16_50dp	Ø 3/16" x 1/2" Dowel Pin
34	72261	1	MX302-1-ITD-S	Base Plate	102	63470	12	3.16_75dp	Ø 3/16" x 3/4" Dowel Pin
35	76563	2	MX304-ITD-S	Hinge Pin	103	78517	2	10lw	#10 Lockwasher
36	76564	2	MX305-ITD-S	Pin	104	63531	2	10-24_38bh	#10-24 x 3/8" Button Hd Cap Screw
37	76567	1	MX308-ITD-S	Latch Pivot Pin	105	78327	1	10-32_13bh	#10-32 x 1/8" Button Hd Cap Screw
38	78917	1	MX309-5-ITD-S	Cut-off Keeper	106	63054	2	10-32_25ss	#10-32 x 1/4" Socket Hd Set Screw
39	76573	1	MX314-ITD-S	Catch	107	78687	2	10-32_25bh	#10-32 x 1/4" Button Hd Cap Screw
40	76574	1	MX315-ITD-S	Insulation Tool Spacer	108	78993	8	10-32_38bh	#10-32 x 3/8" Button Hd Cap Screw
41	76575	2	MX316-ITD-S	Latch Spring	109	70110	1	10-32_38sh	#10-32 x 3/8" Socket Hd Cap Screw
42	76576	1	MX317-ITD-S	Base Plate Spacer	110		4	10-32_38ssf	#10-32 x 3/8" Socket Hd Set Screw
43	76578	1	MX319-ITD-S	Knock off	111	63056	2	10-32_50sh	#10-32 x 1/2" Socket Hd Cap Screw
44	76579	1	MX320-ITD-S	Brake	112	76501	4	10-32_50bh	#10-32 x 1/2" Button Hd Cap Screw
45	76580	1	MX321-ITD-S	Brake Actuator	113	70293	1	10-32_63sh	#10-32 x 5/8" Socket Hd Cap Screw
46	71070	1	MX324-1-ITD-S	Cut-off Pad Pusher	114	63532	2	10-32_75sh	#10-32 x 3/4" Socket Hd Cap Screw
47	72937	1	MX327-1-ITD-S	Left Feed Rail	115	63827	2	1.4_50dp	Ø 1/4" x 1/2" Dowel Pin
48	76587	1	MX328-ITD-S	Hold Down Spring	116	63632	3	1.4-20_50bh	1/4-20 x 1/2" Button Hd Cap Screw
49	76588	1	MX329-ITD-S	Right Feed Rail	117	63055	1	5.16-18_1.00bh	5/16-18 x 1" Button Hd Cap Screw
50	76590	1	MX331-ITD-S	Latch (Automatic)	118	71086	1	5.16-24_75ssf	5/16-24 x 3/4" Socket Hd Set Screw
51	70767	1	MX343-ITD-S	Support	119		1	15.32_32 hex nut	Hex Nut
52	76608	1	MX335-ITD-S	Cam	120		1	1.2isw	1/2" Internal Star Washer
53	76661	1	MX337-ITD-S	Feed Finger					
54	70720	1	MX338-ITD-S	Arm Switch Cam (1 5/8" Stroke)					
55	72233	1	MX338-1-ITD-S	Arm Switch Cam (1 1/8" Stroke)					
56	70745	1	MX339-ITD-S	Guard					
57	78702	1	MX340-6-ITD-S	Cut-off Pad					
58	70765	1	MX341-ITD-S	Die Holder					
59	70766	1	MX342-ITD-S	Feed Plate					
60	72342	1	MX344-2-ITD-S	Leaf Spring					
61	72340	1	MX345-1-ITD-S	Insulation Pusher					
62	72099	1	MX348-ITD-S	.550 Strike Slide Cylinder					
63	72100	1	MX349-ITD-S	Stock Chute					
64	72101	1	MX350-ITD-S	Feed Finger Retainer					
65	72102	1	MX351-ITD-S	Support Spacer					
66	72172	1	MX352-ITD-S	Latch/Wire Stop					
67	72893	1	MX357-ITD-S	Bracket					
68	78733	1	MX358-1-ITD-S	Valve Mounting Plate					

**NOTE: ITEMS MARKED IN BOLD TEXT ARE HIGH WEAR ITEMS**

- NOTE:**
- (1) Items marked in bold text are high wear items.
  - (2) Use OEM replacement tooling only.
  - (3) Recommended machine speed for automatic equipment is a maximum of 3500 parts per hour.

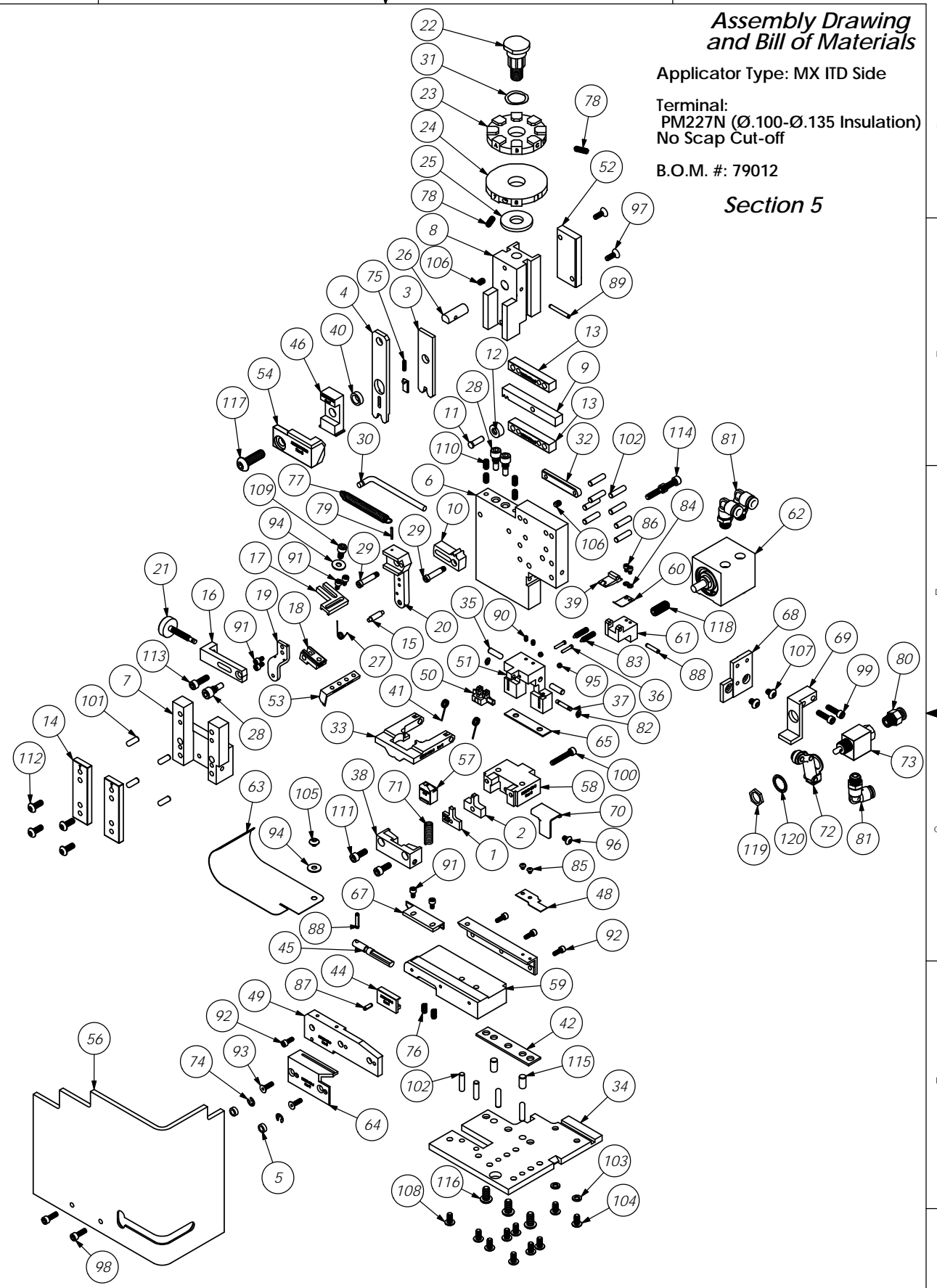

**Assembly Drawing and Bill of Materials**

Applicator Type: MX ITD Side  
Terminal: PM227N (Ø.100-Ø.135 Insulation)  
No Scrap Cut-off  
B.O.M. #: 79012

**Section 5**

REV	DESCRIPTION	DATE	BY	CHKD	APP
A	ECR# 2316 SCJ	6/7912			

ITEM NO.	PART NO.	DESCRIPTION	MATERIAL SPECIFICATION	QTY.	UOM
		DO NOT SCALE DRAWING			
		UNLESS OTHERWISE SPECIFIED DIMENSIONS ARE IN INCHES. TOLERANCES ARE FRACTIONAL DECIMALS ANGLES			
		#1/64 XX .015 #1/32 XXX .010 #1/16 XXXX .005			
		SURFACE FINISH: ✓ ALL OVER			
		SCALE: 1:2.5			
		DATE: 12Sep04			