

ITEM NO.	Part Code	PART NUMBER	DESCRIPTION	QTY.	ITEM NO.	Part Code	PART NUMBER	DESCRIPTION	QTY.
1	76652	9-4001	Wire Anvil	1	72	71043	MX361-2-ITD-S	Pivot Gate (Ø.070-Ø.100 Insulation)	1
2	76651	9A-4001	Insulation Anvil	1	73	61833	MX361-17-ITD-S	Pivot Gate (Ø.090-Ø.120 Insulation)	1
3	63742	9A-4012	Insulation Anvil-Briggs & Stratton	1	74	61843	MX361-18-ITD-S	Non-Pivoting Gate(.110-.140 dia. insulation)	1
4	76655	13-4001	Wire Rolling Tool	1	75	71087	MX361-14-ITD-S	Pivot Gate (Ø.055-Ø.075 Insulation)	1
5	76654	14-4003	Insulation Rolling Tool (Overlap)	1	76	71008	MX362-ITD-S	Pivot Gate Pin	1
6	63741	14-4012	Insulation Rolling Tool (Overlap)-Briggs & Stratton	1	77	72350	5-047x1.000	Compression Spring	1
7	73888	GS-125	Guard Spacer	2	78	72069	McMaster Carr #98407A118	#8 E-Style Retaining Ring	2
8	71494	MX2A-S-1	Mounting Frame	1	79	71013	LC-014A-1-M	Compression Spring	1
9	71030	MX2B-S	Plunger Frame	1	80	72315	LC-022A-4	Compression Spring	1
10	74343	MX3	Ram	1	81	78681	LC-029B-3-M	Compression Spring	2
11	74438	MX5-S	Cam Rack	1	82	74611	LE-037CD-6	Extension Spring	1
12	74346	MX6-1	Gear Arm	1	83	70739	McMaster-Carr #3126A53	Spring Plunger	2
13	74347	MX7	Cam Pin	1	84	74447	McMaster-Carr #98296A109	Expansion Pin (1/16 x 1/2")	1
14	74350	MX8	Cam Roller	1	85	72352	Pisco PL250-N1U	Ø1/4" x 1/8-NPT Elbow Fitting, White	3
15	74351	MX10-S	Rack Pad	2	86	63200	Truarc #5555-12	Retaining Ring	2
16	74352	MX11	Gib	2	87	63201	Vlier #PH-51-P	Spring Plunger	2
17	74356	MX12	Feed Finger Pivot Pin	1	88	63202	4lw	#4 Lock Washer	2
18	74360	MX13	Adjusting Bar	1	89	63203	4-40_.13bh	#4-40 x 1/8" Button Hd Cap Screw	2
19	76868	MX14-1-S	Feed Finger Arm	1	90	63204	4-40_.16sh	#4-40 x 5/32" Socket Hd Cap Screw	2
20	76874	MX15-1-S	Feed Finger Guide	1	91	63205	1.8_.38rp	Ø 1/8" x 3/8" Roll Pin	1
21	74364	MX16	Retainer	1	92	63053	1.8_.63rp	1/8" x 5/8" Roll Pin	2
22	71495	MX18-S-1	Swing Arm	1	93	62040	1.8_1.00rp	1/8" x 1" Roll Pin	1
23	74376	MX25	Stroke Adjustment Screw	1	94	63206	5-40_.19ssf	#5-40 x 3/16" Socket Set Screw	2
24	74407	MX33	Mounting Post	1	95	63207	6-32_.25sh	#6-32 x 1/4" Socket Hd Cap Screw	5
25	72002	MX34-D	Wire Crimp Dial	1	96	63208	6-32_.25ssf	#6-32 x 1/4" Socket Hd Set Screw	1
26	61844	MX35-2	Insulation Dial	1	97	63209	6-32_.38sh	#6-32 x 3/8" Socket Hd Cap Screw	4
27	74411	MX36	Dial Spacer	1	98	63057	6-32_.50fh	#6-32 x 1/2" Flat Hd Cap Screw	2
28	74412	MX44	Locating Dowel	1	99	63210	8fw	#8 Flatwasher	2
29	74415	MX45-S	Feed Finger Spring	1	100	63211	8-32_.13ssf	#8-32 x 1/8" Socket Hd Set Screw	2
30	74419	MX50	Safety Pivot Pin	3	101	63212	8-32_.25bh	#8-32 x 1/4" Button Hd Cap Screw	1
31	71493	MX52-S-1	Pivot Pin	2	102	63052	8-32_.50fh	#8-32 x 1/2" Flat Hd Cap Screw	2
32	74614	MX90-S	Spring Bracket	1	103	63164	8-32_.50sh	#8-32 x 1/2" Socket Hd Cap Screw	2
33	72310	MX104	Wave Disc Spring	1	104	63162	8-32_.63sh	#8-32 x 5/8" Socket Hd Cap Screw	2
34	71678	MX105-S	Pivot Pin Plate	1	105	63213	8-32_1.00sh	#8-32 x 1" Socket Hd Cap Screw	1
35	70606	MX301-11-ITD-S	Latching Gate	1	106	63158	3.16_.50dp	Ø 3/16" x 1/2" Dowel Pin	4
36	72261	MX302-1-ITD-S	Base Plate	1	107	63470	3.16_.75dp	Ø 3/16" x 3/4" Dowel Pin	12
37	76563	MX304-ITD-S	Hinge Pin	2	108	78517	10lw	#10 Lockwasher	2
38	76564	MX305-ITD-S	Pin	2	109	63531	10-24_.38bh	#10-24 x 3/8" Button Hd Cap Screw	2
39	78613	MX306-2-ITD-S	Insulation Pusher	1	110	78687	10-32_.25bh	#10-32 x 1/4" Button Hd Cap Screw	2
40	76566	MX307-ITD-S	Stock Chute	1	111	78327	10-32_.13bh	#10-32 x 1/8" Button Hd Cap Screw	1
41	76567	MX308-ITD-S	Latch Pivot Pin	1	112	63054	10-32_.25ss	#10-32 x 1/4" Socket Hd Set Screw	2
42	78936	MX309-4-ITD-S	Cut-off Keeper	1	113	78993	10-32_.38bh	#10-32 x 3/8" Button Hd Cap Screw	8
43	72257	MX310-1-ITD-S	Die Holder	1	114	70110	10-32_.38sh	#10-32 x 3/8" Socket Hd Cap Screw	1
44	76571	MX312-ITD-S	Left Feed Shim (3/16" Terminal)	1	115		10-32_.38ssf	#10-32 x 3/8" Socket Hd Set Screw	4
45	76573	MX314-ITD-S	Catch	1	116	63056	10-32_.50sh	#10-32 x 1/2" Socket Hd Cap Screw	2
46	76574	MX315-ITD-S	Insulation Tool Spacer	1	117	76501	10-32_.50bh	#10-32 x 1/2" Button Hd Cap Screw	4
47	76575	MX316-ITD-S	Latch Spring	2	118	70293	10-32_.63sh	#10-32 x 5/8" Socket Hd Cap Screw	1
48	76576	MX317-ITD-S	Base Plate Spacer	1	119	63532	10-32_.75sh	#10-32 x 3/4" Socket Hd Cap Screw	2
49	76578	MX319-ITD-S	Knock off	1	120	63827	1.4_.50dp	Ø 1/4" x 1/2" Dowel Pin	2
50	76579	MX320-ITD-S	Brake	1	121	63632	1.4-20_.50bh	1/4-20 x 1/2" Button Hd Cap Screw	3
51	76580	MX321-ITD-S	Brake Actuator	1	122	63055	5.16-18_1.00bh	5/16-18 x 1" Button Hd Cap Screw	1
52	76583	MX324-ITD-S	Cut-off Pad Pusher	1	123	71086	5.16-24_.75ssf	5/16-24 x 3/4" Socket Hd Set Screw	1
53	71014	MX326-8-ITD-S	Cut-off Pad	1	124	72318	Clippard MJV-3	3-Way Valve	1
54	76586	MX327-ITD-S	Left Feed Rail	1	125	72317	Clippard #12296	Cam Follower	1
55	76587	MX328-ITD-S	Hold Down Spring	1	126		15.32_32 hex nut	Hex Nut	1
56	76588	MX329-ITD-S	Right Feed Rail	1	127		1.2isw	1/2" Internal Star Washer	1
57	76589	MX330-ITD-S	Feed Plate	1	128	61993	MX358-2-ITD-S	Valve Mounting Plate	1
58	76590	MX331-ITD-S	Latch (Automatic)	1	129	73222	Pisco PC250-N1U	1/4" x 1/8" NPT Straight	1
59	76591	MX332-ITD-S	Support	1					
60	76593	MX334-ITD-S	Latch/Wire Stop	1					
61	76608	MX335-ITD-S	Cam	1					
62	76661	MX337-ITD-S	Feed Finger (fed between carrier and inslu ear)	1					
63	71686	MX337-2-ITD-S	Feed Finger (fed in carrier strip hole)	1					
64	70720	MX338-ITD-S	Arm Switch Cam (1 5/8" Stroke)	1					
65	72233	MX338-1-ITD-S	Arm Switch Cam (1 1/8" Stroke)	1					
66	70745	MX339-ITD-S	Guard	1					
67	72260	MX344-1-ITD-S	Leaf Spring	1					
68	72099	MX348-ITD-S	.550 Strike Slide Cylinder	1					
69	72893	MX357-ITD-S	Bracket	1					
70	78733	MX358-1-ITD-S	Valve Mounting Plate	1					
71	78835	MX360-ITD-S	Scrap Retainer	1					

NOTE:
(1) Items marked in bold text are high wear items.
(2) Use OEM replacement tooling only.
(3) Recommended machine speed for automatic equipment is a maximum of 3500 parts per hour.

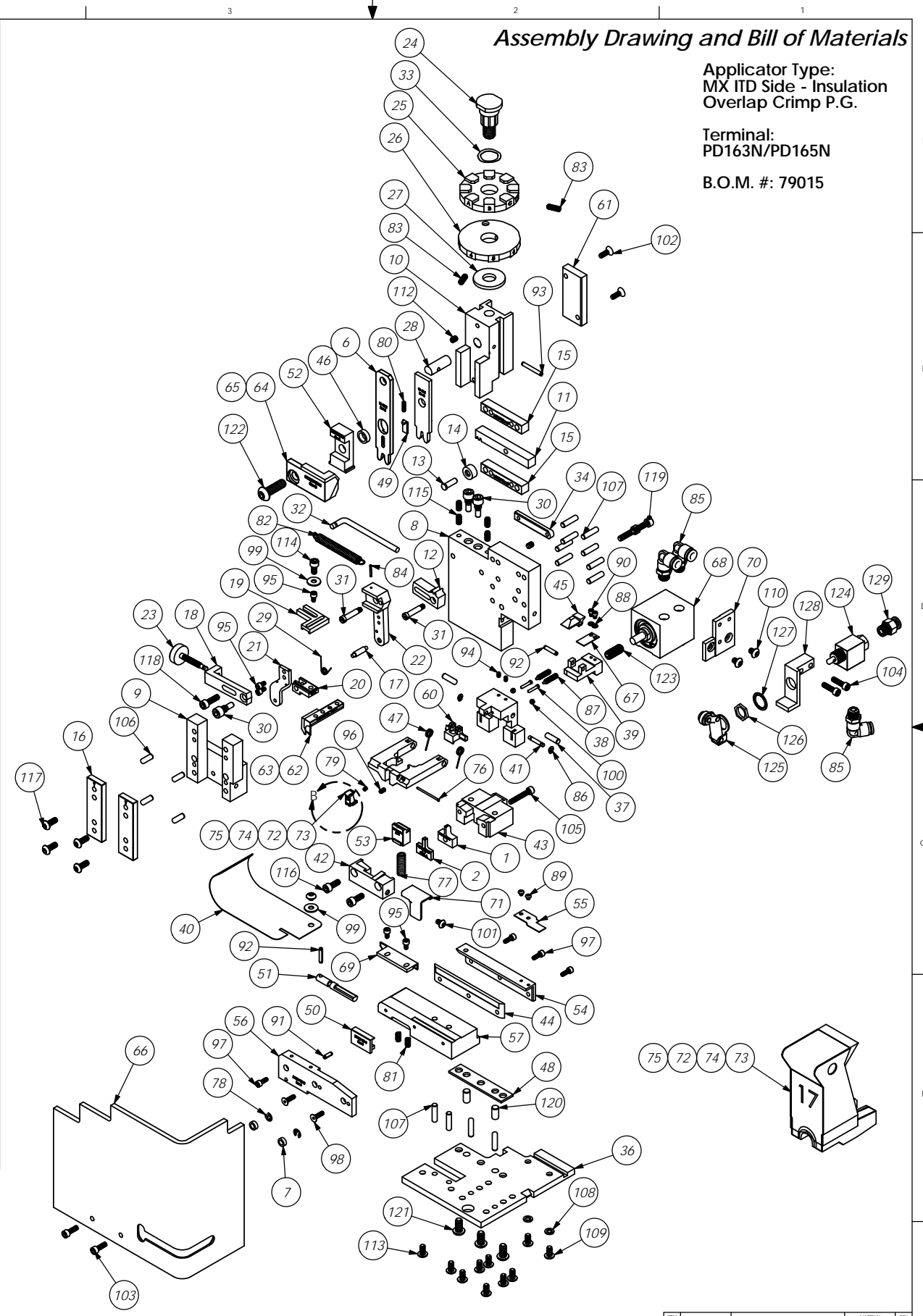

Assembly Drawing and Bill of Materials

Applicator Type:
MX ITD Side - Insulation
Overlap Crimp P.G.
Terminal:
PD163N/PD165N
B.O.M. #: 79015

REV	DESCRIPTION	DATE	BY	CHKD	APP	SCALE	DATE	BY	CHKD	APP
G	updated feed finger desc. SCJ	10/08/13								
F	ECR# 2546 SCJ	10/09/13								
E	Removed chart/added parts SCJ	12/27/12								
D	Updated P/Cs CSG	08/06/07								

ITEM NO.	PART NO.	DESCRIPTION	MATERIAL SPECIFICATION	QTY.	REMARKS
DO NOT SCALE DRAWING					
UNLESS OTHERWISE SPECIFIED DIMENSIONS ARE IN INCHES. DECIMALS ARE FRACTIONS. DIMENSIONS ANGLES					
#1/64 XX ±.01 #1/32 XXX ±.005 #1/16 XXX ±.002					
SURFACE FINISH: ALL OVER					
PARTS LIST					
See Parts List					
ETCO ENGINEERED PRODUCTS 25 BELLEWS STREET WARWICK, RI 02886 (401) 467-2400					
MX ITD Side Feed Applicator					
PD163N/PD165N					
PD163N_PD165N_PG (IOC)					
SCALE: 1:2.5					
DATE: 28Sep04					