

ITEM NO.	Part Code	PART NUMBER	DESCRIPTION	QTY.	ITEM NO.	Part Code	PART NUMBER	DESCRIPTION	QTY.
1	74287	8-3000	Cut-off Pad Retainer	1	68	63210	8fw	#8 Flatwasher	1
2	78393	8A-3121	*Cut-off Die	1	69	60265	8-32_19sh	#8-32 x 3/16" Socket Hd Cap Screw	1
3	78391	9-3121	Anvil	1	70	63161	8-32_38sh	#8-32 x 3/8" Socket Hd Cap Screw	2
4	74286	12-3000	Rear cut-off pad	1	71	63052	8-32_50fh	#8-32 x 1/2" Flat Hd Cap Screw	2
5	78394	13-3121	*Wire Rolling Tool (RE156C-1/RE180A)	1	72	63162	8-32_63sh	#8-32 x 5/8" Socket Hd Cap Screw	2
6	71435	14-3110	*Insulation Rolling Tool (RE156C-1/RE180A)	1	73	63158	3.16_50dp	Ø 3/16" x 1/2" Dowel Pin	4
7	72114	15-3121	Driver	1	74	63470	3.16_75dp	3/16" x 3/4" Dowel Pin	4
8	75770	26-3020	#8-32 x 3/8" Button Hd Cap Screw	4	75	10-32_13hl	10-32_13hl	#10-32 x 1/8" Hollow Lock Socket Hd Set Screw	2
9	77265	26-3088	Locking Screw	1	76	63054	10-32_25ss	#10-32 x 1/4" Socket Hd Set Screw	3
10	72269	34-3016	Wire Crimp Dial Blank	1	77	78993	10-32_38bh	#10-32 x 3/8" Button Hd Cap Screw	1
11	75902	190S-3001	IRT Spacer	1	78	70110	10-32_38sh	#10-32 x 3/8" Socket Hd Cap Screw	1
12	76403	199-3005	Safety Guard	1	79	71626	10-32_38ss	#10-32 x 3/8" Socket Hd Set Screw	4
13	71987	200-3121	Baseplate	1	80	76501	10-32_50bh	#10-32 x 1/2" Button Hd Cap Screw	2
14	71986	250-3121	Feed Plate	1	81	63056	10-32_50sh	#10-32 x 1/2" Socket Hd Cap Screw	6
15	75936	303-3024	Feed Finger	1	82	70293	10-32_63sh	#10-32 x 5/8" Socket Hd Cap Screw	1
16	78697	403-3097	Brake Shoe	1	83	63532	10-32_75sh	#10-32 x 3/4" Socket Hd Cap Screw	2
17	71984	500-3121	Rear Guide Rail	1	84	70925	10-32_88sh	#10-32 x 7/8" Socket Hd Cap Screw	2
18	71983	1000-3121	RE156 Front Guide Rail	1	85	77396	10-32_1.25sh	#10-32 x 1 1/4" Socket Hd Cap Screw	1
19	78392	1000-3121-1	RE180 Front Guide Rail	1	86	10-32_1.50sh	10-32_1.50sh	#10-32 x 1 1/2" Socket Hd Cap Screw	2
20	74568	1600-3000	Stripper / Wire Stop	1	87	63632	1.4-20_50bh	1/4-20 x 1/2" Button Hd Cap Screw	3
21	74491	GS-375	Guard Spacer	2	88	1.4_50dp	Ø 1/4" x 1/2" Dowel Pin	2	
22	71029	MX2A-S	Mounting Frame	1	89	63510	1.4_1.00dp	1/4 x 1" Dowel Pin	2
23	71030	MX2B-S	Plunger Frame	1	90	63055	5.16-18_1.00bh	5/16-18 x 1" Button Hd Cap Screw	1
24	74343	MX3	Ram	1					
25	74438	MX5-S	Cam Rack	1					
26	74346	MX6	Gear Arm	1					
27	74347	MX7	Cam Pin	1					
28	74350	MX8	Cam Roller	1					
29	74351	MX10-S	Rack Pad	2					
30	74352	MX11	Gib	2					
31	74356	MX12	Feed Finger Pivot Pin	1					
32	74360	MX13	Adjusting Bar	1					
33	74361	MX14-S	Feed Finger Arm	1					
34	74362	MX15-S	Feed Finger Guide	1					
35	74364	MX16	Retainer	1					
36	74371	MX18-S	Swing Arm	1					
37	74376	MX25	Stroke Adjustment Screw	1					
38	74384	MX29-S	Slide Support	1					
39	74388	MX30-S	Support Anchor	1					
40	74390	MX32-S	Support Cover	1					
41	74407	MX33	Mounting Post	1					
42	74409	MX35	Insulation Dial	1					
43	74411	MX36	Dial Spacer	1					
44	74412	MX44	Locating Dowel	1					
45	74415	MX45-S	Feed Finger Spring	1					
46	74417	MX48-S	Cam (1 1/8" Up Stroke)	1					
47	74418	MX49	Tool Retainer	1					
48	74419	MX50	Safety Pivot Pin	3					
49	74420	MX52	Pivot Pin	2					
50	74425	MX84-S	Brake Cam	1					
51	74426	MX85-S	Cam Pivot Pin	1					
52	75178	MX87-S	Lift Arm	1					
53	74430	MX88-S	Lever	1					
54	74614	MX90-S	Spring Bracket	1					
55	72310	MX104	Wave Disc Spring	1					
56	75083	Irving 3100-18	External Retaining Ring	2					
57	77322	LC-045E-10-M	Spring	2					
58	74611	LE-037CD-6	Extension Spring	1					
59	70739	McMaster-Carr #3126A53	Spring Plunger	2					
60	72519	McMaster-Carr #98029A043	#8 Hardened Washer	2					
61	74447	McMaster-Carr #98296A109	Expansion Pin (1/16 x 1/2")	1					
62	73785	SPI 99-602-5	#10 Black Knurled Knob	2					
63	76503	Spring_034x_25x_88	Cut-off Pad Spring	1					
64	62040	1.8_1.00rp	1/8" x 1" Roll Pin	1					
65	63792	6-32_25bh	#6-32 x 1/4" Button Hd Cap Screw	2					
66	63207	6-32_25sh	#6-32 x 1/4" Socket Hd Cap Screw	7					
67	63209	6-32_38sh	#6-32 x 3/8" Socket Hd Cap Screw	2					

NOTE: ITEMS MARKED WITH AN * ARE HIGH WEAR ITEMS

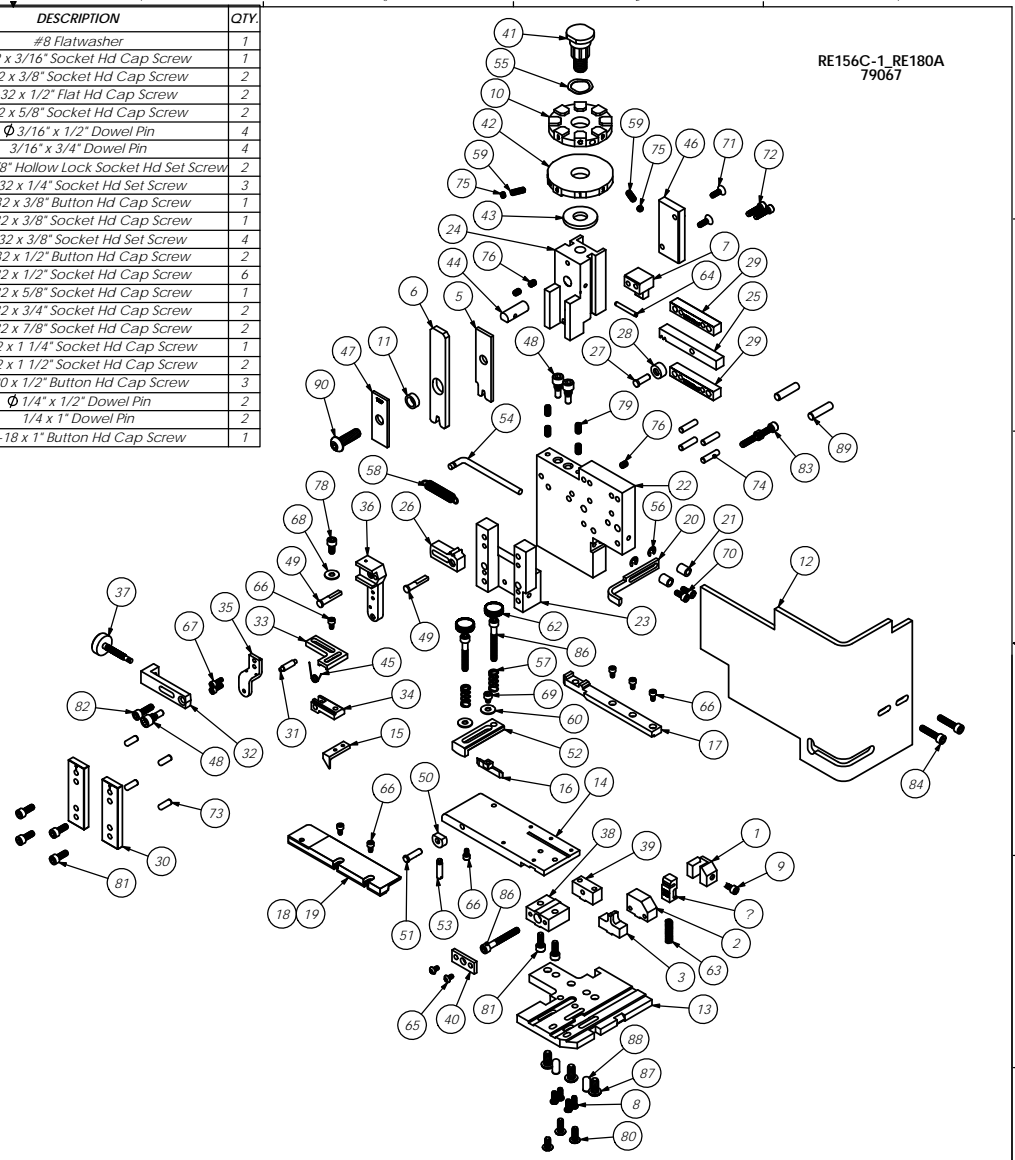

RE156C-1_RE180A
79067

See Parts List RE156C-1/RE180A MX Side Feed Applicator		RE156C-1_RE180A 79067
DATE: 2/13/2013 TIME: 10:00 AM USER: [blank]	APPLICATION: [blank]	PARTS LIST: [blank]