

ITEM NO.	Part Code	PART NUMBER	DESCRIPTION	QTY.
1	78424	8-447	Die Holder	1
2	78436	8-448	Cut-Off Die (Left) (Ring)	1
3	78437	8-449	Cut-Off Die (Right) (Ring)	1
4	78438	8-450	Cut-Off Die (Left) (Spade)	1
5	78439	8-451	Cut-Off Die (Right) (Spade)	1
6	78441	9-384	Anvil (#6 & #8 AWG)	2
7	78442	9-385	Anvil (#10 AWG)	2
8	78423	11-290	Punch Holder	1
9	78445	12-332	Cut-Off Punch (Spade)	1
10	78446	12-333	Cut-Off Punch (Spade)	1
11	78447	12-334	Cut-Off Punch (Ring)	2
12	78443	13-360	Wire Rolling Tool (#8 AWG)	2
13	78444	13-361	Wire Rolling Tool (#10 AWG)	2
14	78449	13-362	Wire Rolling Tool (#6 AWG)	2
15	71869	16-120	Feed Finger Spacer	1
16	73728	22-014	Slide Block	1
17	74722	26-150	Guide Rod	2
18	74747	26-151	Keeper	2
19	78487	26-418	Lifter	2
20	78511	26-426	Guide	2
21	78433	30-055	Die Set Base	1
22	78434	31-055	Die Set Hat	1
23	73739	33-009	Shaft Support Block	1
24	76270	34-013	Shaft Support / Feed Stop	1
25	78448	199-62	Safety Guard	1
26	78425	250-457	Feed Plate	1
27	78426	303-176	Feed Finger	1
28	71867	303A-174	Feed Shaft	1
29	76153	307-83	Feed Finger Spring	1
30	78432	314-163	Cam	1
31	73729	401-4	Brake Support Bracket	2
32	78431	403-238	Brake Shoe	2
33	71335	403A-231	Brake Arm	1
34	78485	403A-231-1	Brake Arm	1
35	74675	406	Cotter Pin	1
36	74676	407	Brake Spring	2
37	78440	1600-357	Stripper	1
38	-	68025 - SPRING CLIP	Spring Clip	1
39	-	5-055-1.187	Spring	2
40	73752	CYR1S	Cam Follower	1
41	-	Producto #M-614	Die Set Guide Pin	2
42	-	Producto #MB-6	Guide Pin Bushing	2
43	74901	Producto #MP-39	Feed Spring	2
44	-	SMC #NRBC-050-030	Shock Absorber	1
45	-	6lw	#6 Lockwasher	6
46	63207	6-32_.25sh	#6-32 x 1/4" Socket Hd Cap Screw	6
47	63167	10-32 hn	#10-32 Hex Nut	1
48	63399	10-32_.50ss	#10-32 x 1/2" Socket Hd Set Screw	2
49	61472	8-32_.38bh	#8-32 x 3/8" Button Hd Cap Screw	2
50	63056	10-32_.50sh	#10-32 x 1/2" Socket Hd Cap Screw	7
51	70293	10-32_.63sh	#10-32 x 5/8" Socket Hd Cap Screw	4
52	77396	10-32_1.25sh	#10-32 x 1 1/4" Socket Hd Cap Screw	8
53	63754	1.4fw	1/4" Flatwasher	2
54	-	1.4_.25shss	1/4" x 1/4" Socket Hd Shoulder Screw	2
55	-	1.4_.50shss	Φ 1/4" x 1/2" Socket Hd Shoulder Screw	2
56	78328	1.4-20_.50sh	1/4-20 x 1/2" Socket Hd Cap Screw	4
57	63492	1.4-20_.63sh	1/4-20 x 5/8" Socket Hd Cap Screw	2
58	-	1.4-20_.88sh	1/4-20 x 7/8" Socket Hd Cap Screw	4
59	63498	1.4-20_2.00sh	1/4-20 x 2" Socket Hd Cap Screw	2
60	63470	3.16_.75dp	Φ 3/16" x 3/4" Dowel Pin	3
61	62010	3.16_1.00dp	3/16" x 1" Dowel Pin	8
62	-	1.2-20jn	1/2-20 Jam Nut	1

NOTE: ITEMS MARKED IN BOLD TEXT ARE HIGH WEAR ITEMS

Assembly Drawing and Bill of Materials

Applicator Type: Rear Die Set Applicator
Terminal: R415E-S415E
B.O.M. #: 79076

Section 5

- NOTE:**
- (1) Items marked in bold text are high wear items.
 - (2) Use OEM replacement tooling only.
 - (3) Recommended machine speed for automatic equipment is a maximum of 3500 parts per hour.

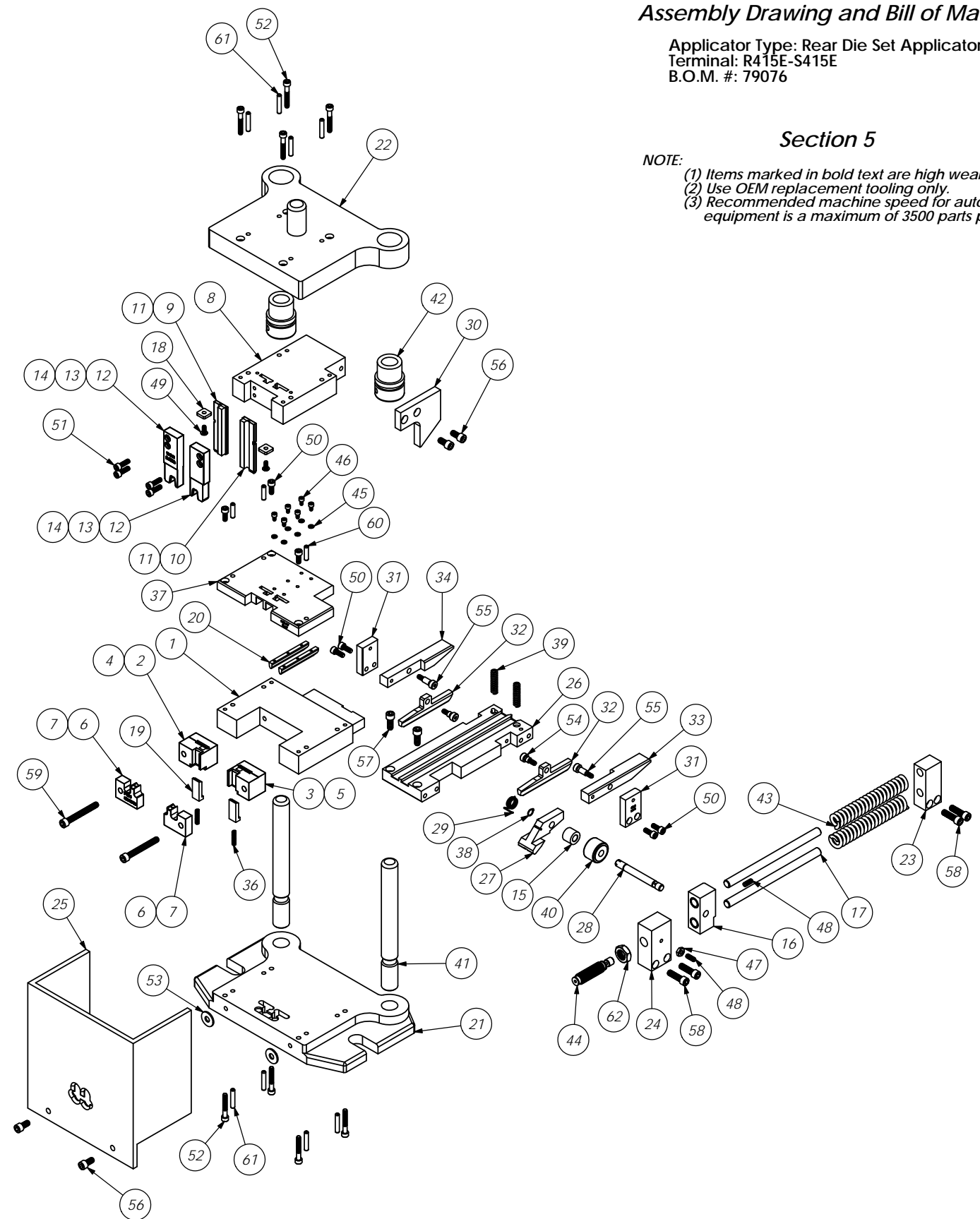

ITEM NO.	PART NO.	DESCRIPTION	MATERIAL SPECIFICATION	QTY.
See parts list				
R415E/S415E				
FINISH: -				
PART NO: R415E-S415E				
SCALE: 1:3				
DATE: 06Feb02				
DRAWN BY: CSJ				
CHECKED BY: -				
APPROVED BY: -				