

Item	Part Code	QTY	Part No./File Name	Description
1	60225	1	8-127	Die
2	61019	1	9-150	Anvil
3	69326	1	11-CS-153	Plunger
4	69589	1	12-099X-1	Shear Punch
5	62451	1	13-129	Wire Rolling Tool
6	67596	1	19-075	Spacer
7	60072	1	101-71R	Top Casting
8	67600	2	169-16	Gib
9	69300	1	176R-ACS	Guard
10	60226	2	176S-090	Guard Spacer
11	60904	1	210R	Base Plate, Right
12	69224	1	250-259	Die Plate
13	76923	1	301-6	Shoulder Screw
14	73399	1	302-.160	Feed Finger Spacer
15	61134	1	302-.302	Feed Finger Spacer
16	61136	1	303-33-1	Feed Finger
17	61135	1	304-.698	Feed Finger Spacer
18	73400	1	304-.840	Feed Finger Spacer
19	74393	1	305-Finished	Feed Finger Arm
20	69206	1	306-TH-1	Feed Stop Arm
21	74400	1	308-Finished	Feed Shaft
22	74402	1	310	Cam Return Spring
23	74403	1	311	Roll Pin
24	74404	1	312	Cam Taper Pin
25	74495	1	401-Finished	Brake Shaft
26	74496	1	402	Spring Retainer
27	74594	1	403-93	Brake Body
28	74673	1	404	Brake Cam
29	74674	1	405	Taper Pin
30	74675	1	406	Cotter Pin
31	74676	1	407	Brake Spring
32	69958	1	408-1.050	Brake Spacer
33	67610	1	500-CS-SB	Rear Guide
34	65321	1	1000-120	Front Guide
35	75716	1	1125R	Cam Roller Bracket
36	75719	1	1142	Cam Roller Bearing
37	75883	1	1600-122	Stripper
38	76191	1	1805	Stock Chute
39	77634	1	CS-110	Plunger Shank
40	75083	2	Irving 3100-18	External Retaining Ring
41	63506	1	McMaster-Carr #1095K11	1/8 NPT Grease Fitting
42	63507	2	1.8_.50dp	Ø 1/8" x 1/2" Dowel
43	62849	2	1.8_1.00dp	1/8" x 1" Dowel
44		2	5-40_.38ssf	#5-40 x 3/8" Socket Hd Set Screw
45	63161	14	8-32_.38sh	#8-32 x 3/8" Socket Hd Cap Screw
46	63164	6	8-32_.50sh	#8-32 x 1/2" Socket Hd Cap Screw
47	70293	1	10-32_.63sh	#10-32 x 5/8" Socket Hd Cap Screw
48	77396	1	10-32_1.25sh	#10-32 x 1 1/4" Socket Hd Cap Screw
49	63510	2	1.4_1.00dp	1/4 x 1" Dowel Pin
50	63511	2	1.4-20_.25ssf	1/4-20 x 1/4" Socket Hd Set Screw
51	63168	2	1.4-20_1.00sh	1/4-20 x 1" Socket Hd Cap Screw
52	63512	1	1.4-28_jn	1/4-28 Jam Nut
53	62184	1	1.4-28_.50sh	1/4-28 x 1/2" Socket Hd Cap Screw
54	63513	1	1.4-28_.75ss	1/4-28 x 3/4" Socket Set Screw
55	62622	1	1.2_.75shss	1/2" x 3/4" Socket Hd Shoulder Screw
56	61137	1	307R-17	Feed Finger Spring
57	75115	1	314R-17	Cam Body

Feed Finger Spacer Table

Series: SQ and SPQ
Use Items: #15, 302-.302
#17, 304-.698

Series: SH, SPH, SL and SPL
Use items: #14, 302-.160
#18, 304-.840

Assembly Drawing and Bill of Materials

Applicator Type:
Terminal: Shear Blade R-L
B.O.M. #: 79102

Section 5

NOTE:
(1) Use OEM replacement tooling only.

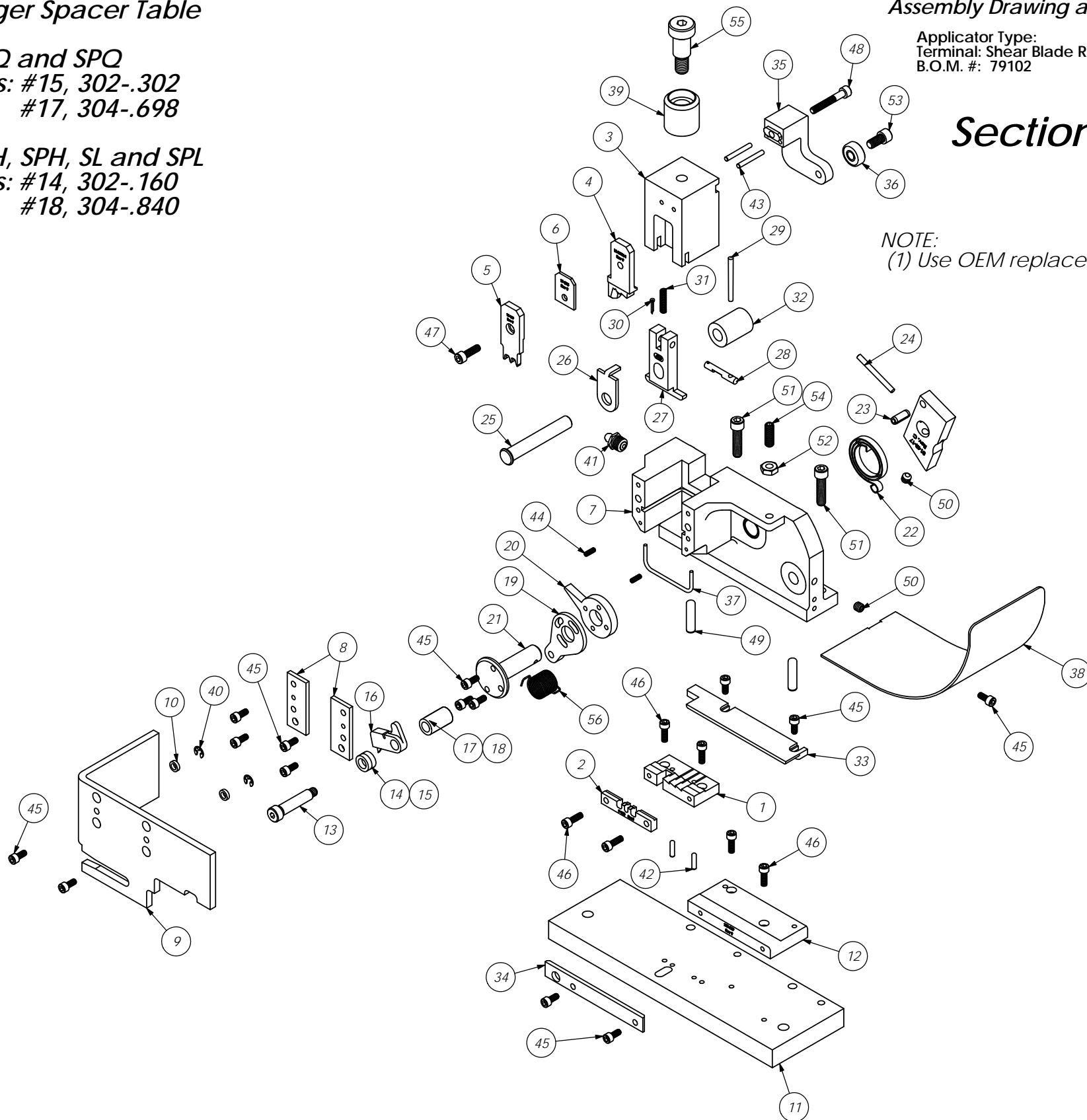

NOTE: ITEMS MARKED IN BOLD TEXT ARE HIGH WEAR ITEMS

REV	DESCRIPTION	DATE	BY	CHKD
B	ECR#12524	FR/23Jun04		
A				
LVL	REVISION	BY/DATE		

ITEM NO.	PART NO.	DESCRIPTION	MATERIAL SPECIFICATION	QTY	REVISION
DO NOT SCALE DRAWING					
UNLESS OTHERWISE SPECIFIED DIMENSIONS ARE IN INCHES. TOLERANCES ARE:					
FRACTIONS: DECIMALS: ANGLES:					
#1/64 XX .01 #1/8 XXX .005 #3/32 XXX .005					
SURFACE FINISH: ✓ ALL OVER					
THE INFORMATION CONTAINED WITHIN THIS DRAWING IS THE SOLE PROPERTY OF ETICO. NO REPRODUCTION OR TRANSMISSION OF THIS DRAWING IS PERMITTED WITHOUT THE WRITTEN PERMISSION OF ETICO ENGINEERED PRODUCTS.					
MATERIAL: See Parts List			ETICO ENGINEERED PRODUCTS 25 BELLEWS STREET WARWICK, RI 02886 (401) 467-2400		
HEAT TREAT: -			Shear Blade R-L Applicator		
FINISH: -			Shear Blade R-L		
SCALE: 1:2			DATE: 29Nov01		
CAD FILE:			DRAWN BY: JF		
CHECKED BY:			DATE:		