

Assembly Drawing and Bill of Materials

Applicator Type: ECC Side
Terminal: R395_90
B.O.M. #: 79125

Section 5

NOTE:
(1) Items marked in bold text are high wear items.
(2) Use OEM replacement tooling only.
(3) Recommended machine speed for automatic equipment is a maximum of 3500 parts per hour.

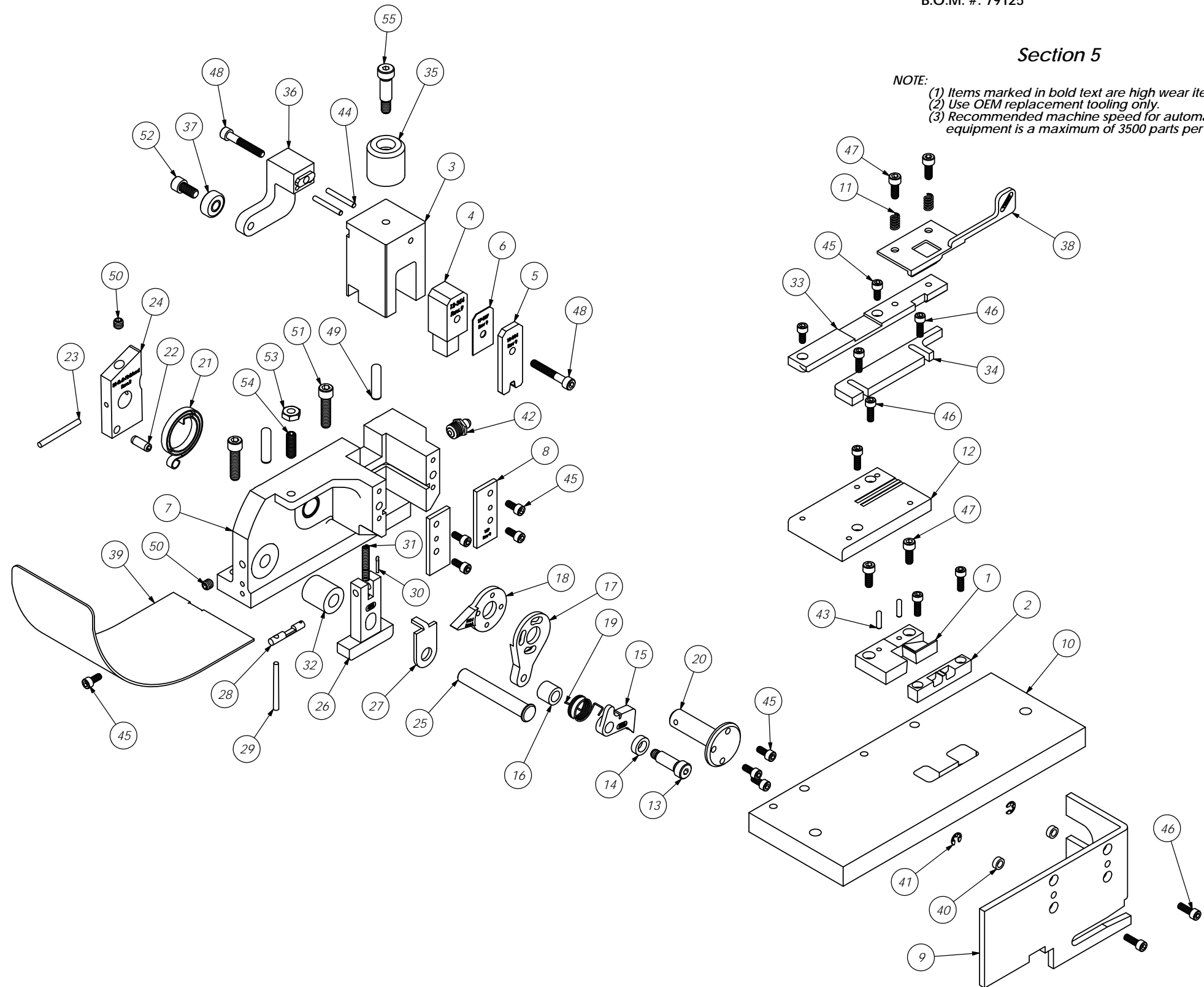

PARTS LIST				
46		2	6-32_.38sh	#6-32 x 3/8" Socket Hd Cap Screw
1	61145	1	8-483	Cut-off Die
2	61308	1	9-391	Anvil
3	61310	1	11-301	Plunger
4	61052	1	12-354	Cut-off/Bend Punch
5	75097	1	13-304	Wire Rolling Tool
6	73278	1	17-007	Spacer
7	63899	1	101	Casting
8	69859	2	169	Gib
9	73922	1	176	Guard
10	75215	1	205-39	Base Plate
11	73952	2	231	Stripper Spring
12	75091	1	250-407	Die Plate
13	76873	1	301-4	Shoulder Screw
14	73399	1	302-.070	Feed Finger Spacer
15	75125	1	303-5	Feed Finger
16	76828	1	304-.430	Feed Finger Spacer
17	74393	1	305-Finished	Feed Finger Arm
18	77049	1	306-1	Feed Stop Arm
19	67608	1	307-8	Spring
20	74400	1	308-Finished	Feed Shaft
21	74402	1	310	Cam Return Spring
22	74403	1	311	Spring Pin
23	74404	1	312	Cam Taper Pin
24	74410	1	314L-2-Finished	Cam
25	74495	1	401-Finished	Brake Shaft
26	61329	1	403-244	Brake Body
27	74496	1	402	Spring Retainer
28	74673	1	404	Brake Cam
29	74674	1	405	Taper Pin
30	74675	1	406	Cotter Pin
31	61346	1	407-1.050	Brake Spring
32	61345	1	408-.800	Brake Spacer
33	61309	1	500-503	Rear Guide
34	75093	1	1000-281	Front Guide
35	77918	1	1102-FS	Floating Shank
36	75710	1	1125-Finished	Cam Roller Bracket
37	75719	1	1142	Cam Roller Bearing
38	75094	1	1600-296	Stripper/Wire Stop
39	76186	1	1800	Stock Chute
40	73888	2	GS-125	Guard Spacer
41	75083	2	Irving 3100-18	External Retaining Ring
42	63506	1	McMaster-Carr #1095K11	1/8 NPT Grease Fitting
43	63507	2	1.8_.50dp	Φ 1/8" x 1/2" Dowel
44	62849	2	1.8_1.00dp	1/8" x 1" Dowel
45	63161	10	8-32_.38sh	#8-32 x 3/8" Socket Hd Cap Screw
46	63164	8	8-32_.50sh	#8-32 x 1/2" Socket Hd Cap Screw
47	63056	4	10-32_.50sh	#10-32 x 1/2" Socket Hd Cap Screw
48	77396	2	10-32_1.25sh	#10-32 x 1 1/4" Socket Hd Cap Screw
49	63510	2	1.4_1.00dp	1/4 x 1" Dowel Pin
50	63511	2	1.4-20_.25ssf	1/4-20 x 1/4" Socket Hd Set Screw
51	63168	2	1.4-20_1.00sh	1/4-20 x 1" Socket Hd Cap Screw
52	62184	1	1.4-28_.50sh	1/4-28 x 1/2" Socket Hd Cap Screw
53	63512	1	1.4-28_jn	1/4-28 Jam Nut
54	63513	1	1.4-28_.75ss	1/4-28 x 3/4" Socket Set Screw
55	62185	1	5/16_.75shss	5/16 x 3/4" Shoulder Screw

NOTE: ITEMS MARKED IN BOLD TEXT ARE HIGH WEAR ITEMS

REV	REVISION	BY/DATE	APP. DATE	SCALE	CAD FILE	CHECKED BY	DATE	DRAWN BY	DATE
1				2:3				FP	03/Jan05

ITEM NO.	PART NO.	DESCRIPTION	MATERIAL SPECIFICATION	QTY	REMARKS
See Parts List					

ITEM NO.	PART NO.	DESCRIPTION	MATERIAL SPECIFICATION	QTY	REMARKS
1	61145	Cut-off Die		1	
2	61308	Anvil		1	
3	61310	Plunger		1	
4	61052	Cut-off/Bend Punch		1	
5	75097	Wire Rolling Tool		1	
6	73278	Spacer		1	
7	63899	Casting		1	
8	69859	Gib		2	
9	73922	Guard		1	
10	75215	Base Plate		1	
11	73952	Stripper Spring		2	
12	75091	Die Plate		1	
13	76873	Shoulder Screw		1	
14	73399	Feed Finger Spacer		1	
15	75125	Feed Finger		1	
16	76828	Feed Finger Spacer		1	
17	74393	Feed Finger Arm		1	
18	77049	Feed Stop Arm		1	
19	67608	Spring		1	
20	74400	Feed Shaft		1	
21	74402	Cam Return Spring		1	
22	74403	Spring Pin		1	
23	74404	Cam Taper Pin		1	
24	74410	Cam		1	
25	74495	Brake Shaft		1	
26	61329	Brake Body		1	
27	74496	Spring Retainer		1	
28	74673	Brake Cam		1	
29	74674	Taper Pin		1	
30	74675	Cotter Pin		1	
31	61346	Brake Spring		1	
32	61345	Brake Spacer		1	
33	61309	Rear Guide		1	
34	75093	Front Guide		1	
35	77918	Floating Shank		1	
36	75710	Cam Roller Bracket		1	
37	75719	Cam Roller Bearing		1	
38	75094	Stripper/Wire Stop		1	
39	76186	Stock Chute		1	
40	73888	Guard Spacer		2	
41	75083	External Retaining Ring		2	
42	63506	1/8 NPT Grease Fitting		1	
43	63507	Φ 1/8" x 1/2" Dowel		2	
44	62849	1/8" x 1" Dowel		2	
45	63161	#8-32 x 3/8" Socket Hd Cap Screw		10	
46	63164	#8-32 x 1/2" Socket Hd Cap Screw		8	
47	63056	#10-32 x 1/2" Socket Hd Cap Screw		4	
48	77396	#10-32 x 1 1/4" Socket Hd Cap Screw		2	
49	63510	1/4 x 1" Dowel Pin		2	
50	63511	1/4-20 x 1/4" Socket Hd Set Screw		2	
51	63168	1/4-20 x 1" Socket Hd Cap Screw		2	
52	62184	1/4-28 x 1/2" Socket Hd Cap Screw		1	
53	63512	1/4-28 Jam Nut		1	
54	63513	1/4-28 x 3/4" Socket Set Screw		1	
55	62185	5/16 x 3/4" Shoulder Screw		1	