

ITEM NO.	Part Code	PART NUMBER	DESCRIPTION	QTY.
1	61716	8-490	Die Retainer	1
2	61720	8-491	Cut-Off Die	1
3	61721	9-392	Anvil (16-20 AWG)	1
4	61722	9-393	Anvil (12-16 AWG)	1
5	61727	11-302	Plunger	1
6	61724	12-356	Cut-Off Punch	1
7	61725	13-375	Wire Rolling Tool (16-20 AWG)	1
8	61726	13-376	Wire Rolling Tool (12-16 AWG)	1
9	61732	101-124	Casting	1
10	69859	169	Gib	2
11	73922	176	Guard	1
12	61728	205-56	Base Plate	1
13	73952	231	Stripper Spring	2
14	61717	250-473	Feed Plate	1
15	61958	301-9	Shoulder Screw	1
16	60483	302-.080	Feed Finger Spacer	1
17	70530	303-148	Feed Finger	1
18	61200	304-.544	Feed Finger Spacer	1
19	77497	305-2	Feed Finger Arm	1
20	74396	306	Feed Stop Arm	1
21	76861	307-14	Feed Finger Spring	1
22	74400	308-Finished	Feed Shaft	1
23	74402	310	Cam Return Spring	1
24	74403	311	Roll Pin	1
25	74404	312	Cam Taper Pin	1
26	61919	314-166	Cam Body	1
27	61985	401-2	Brake Shaft	1
28	74496	402	Spring Retainer	1
29	69214	403-104	Brake Body	1
30	74673	404	Brake Cam	1
31	74674	405	Taper Pin	1
32	74675	406	Cotter Pin	1
33	74676	407	Brake Spring	1
34	61729	408-.900	Brake Spacer	1
35	61718	500-504	Rear Guide Rail	1
36	61719	1000-350	Adjustable Front Guide	1
37	77918	1102-FS	Floating Shank	1
38	75710	1125-Finished	Cam Roller Bracket	1
39	75719	1142	Cam Roller Bearing	1
40	61723	1600-382	Stripper	1
41	76186	1800	Stock Chute	1
42	76945	GS-050	Guard Spacer	2
43	63506	McMaster-Carr #1095K11	1/8 NPT Grease Fitting	1
44	72069	McMaster Carr #98407A118	#8 E-Style Retaining Ring	2
45	63507	1.8_.50dp	Ø 1/8" x 1/2" Dowel	2
46	62849	1.8_1.00dp	1/8" x 1" Dowel	2
47	63510	1.4_1.00dp	1/4 x 1" Dowel Pin	2
48	62185	5/16_.75shss	5/16 x 3/4" Shoulder Screw	1
49	63161	8-32_.38sh	#8-32 x 3/8" Socket Hd Cap Screw	16
50	63164	8-32_.50sh	#8-32 x 1/2" Socket Hd Cap Screw	3
51	63213	8-32_1.00sh	#8-32 x 1" Socket Hd Cap Screw	2
52	63168	1/4-20_1.00sh	1/4-20 x 1" Socket Hd Cap Screw	2
53	62184	1/4-28_.50sh	1/4-28 x 1/2" Socket Hd Cap Screw	1
54	63513	1/4-28_.75ss	1/4-28 x 3/4" Socket Set Screw	1
55	63512	1/4-28 jn	1/4-28 Jam Nut	1
56	63511	1/4-20_.25ssf	1/4-20 x 1/4" Socket Hd Set Screw	1
57	63511	1/4-20_.38ssf	1/4-20 x 3/8" Socket Hd Set Screw	1
58	63056	10-32_.50sh	#10-32 x 1/2" Socket Hd Cap Screw	2
59	63532	10-32_.75sh	#10-32 x 3/4" Socket Hd Cap Screw	1
60	77396	10-32_1.25sh	#10-32 x 1 1/4" Socket Hd Cap Screw	1

Note:
 1) Items marked in bold italic are high wear tooling recommended for stocking.
 2) Use OEM tooling only.

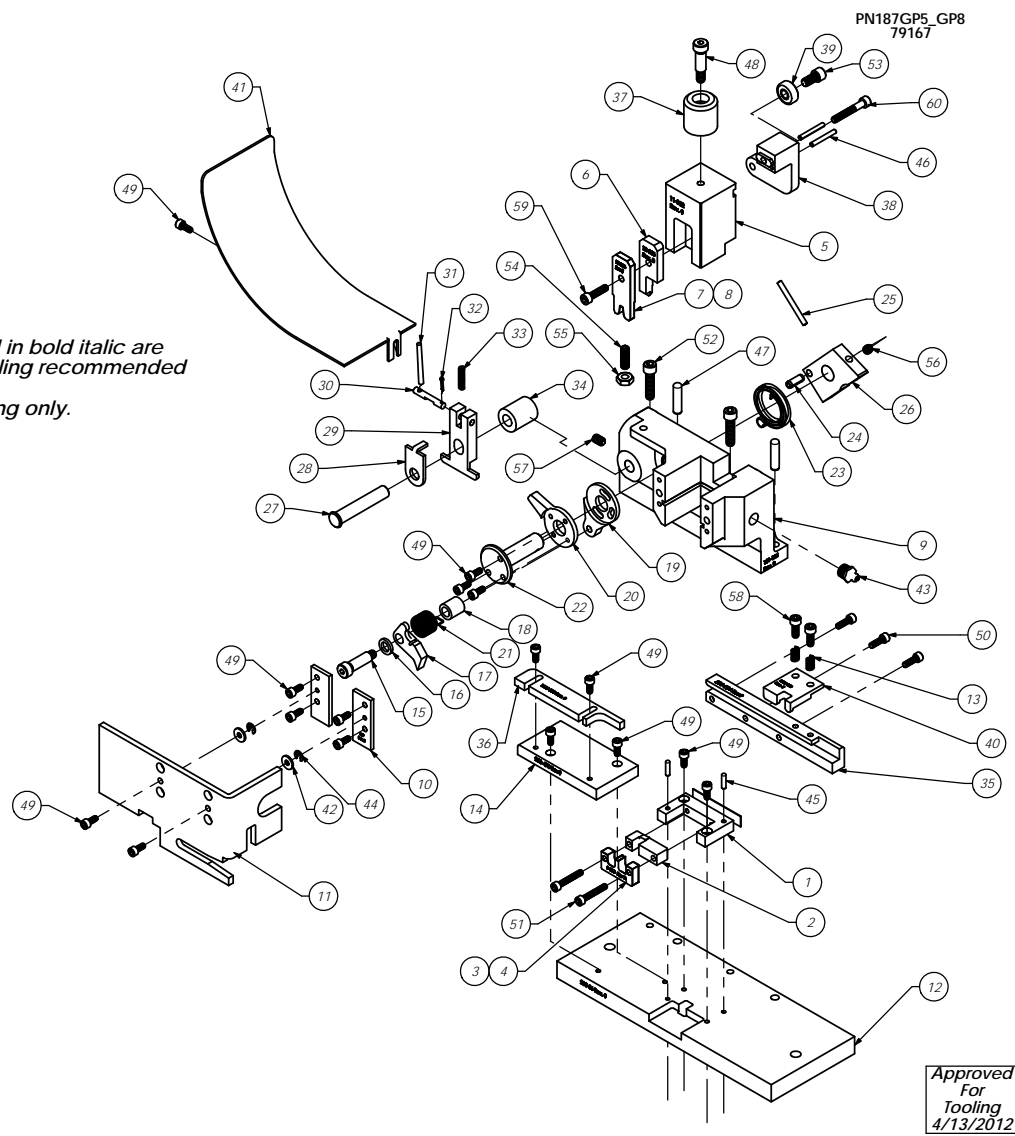

Approved For Tooling 4/13/2012

REV	DESCRIPTION	DATE	BY	CHKD	APP'D
C	10-32 x 1/2 was 10-32x7/16	2/22/07	CSG	CSG	CSG
B	308 was 306-1	2/22/07	CSG	CSG	CSG
B	311 was 311-1	2/22/07	CSG	CSG	CSG
B	402-2 was 401	2/22/07	CSG	CSG	CSG
A	301-9 was 301-5	2/22/07	CSG	CSG	CSG
A	1800 was 1800-7	2/22/07	CSG	CSG	CSG

ITEM NO.	DESCRIPTION	QTY.
1	PN187 GP5_GP8	1
2	PN187GP5_GP8	1