

ITEM NO.	PART NUMBER	DESCRIPTION	DT15E/QTY.
1	63254-Chute	Chute	1
2	68001 - HAT SHANK	Hat Shank	1
3	68014 - DIE PLATE	Die Plate	1
4	68018 - BRAKE MOUNT	Brake Mount	1
5	68021 - FEED FINGER SHAFT	Feed Finger Shaft	1
6	68022 - BEARING	Bearing	1
7	68023 - FEED FINGER SPACER	Feed Finger Spacer	1
8	68025 - SPRING CLIP	Spring Clip	1
9	68026 - FEED FINGER SPRING	Feed Finger Spring	1
10	68027 - SLIDE BRACKET	Slide Bracket	2
11	68028 - SLIDE SHAFT	Slide Shaft	2
12	68029 - SLIDE END CAP	Slide End Cap	2
13	68030 - SLIDE BLOCK	Slide Block	1
14	68031 - SPRING	Spring	1
15	68090 - Cotter Pin	Cotter Pin - 1/16" x 1"	1
16	68132-Cut Off Punch	Cut Off Punch	1
17	68165-Roll Tool	Roll Tool	1
18	68293-Die Hat	Die Hat	1
19	68294-Tool Holder	Tool Holder	1
20	68295-Cam	Cam	1
21	68296-Spacer	Spacer	1
22	68297-Die Base	Die Base	1
23	68298-Die Holder	Die Holder	1
24	68299-Die	Die	1
25	68300-Die	Die	1
26	68301-Anvil	Anvil	1
27	68302-Front Guide	Front Guide	1
28	68303-Riser	Riser	1
29	68304-Brake	Brake	1
30	68305-Feed Finger	Feed Finger	1
31	68306-Guard	Guard	1
32	68307-Stripper	Stripper	1
33	68308-Stripper Mount	Stripper Mount	1
34	68331-Spring	Spring	1
35	68490-Guide Block	Guide Block	1
36	100445-Die Cover	Die Cover	1
37	1.4-20_50sh	1/4-20 x 1/2" Socket Hd Cap Screw	6
38	1.4-20_1.00sh	1/4-20 x 1" Socket Hd Cap Screw	4
39	1.4-20_2.00sh	1/4-20 x 2" Socket Hd Cap Screw	2
40	1.4_.75dp	1/4" x 3/4" Dowel Pin	1
41	1.4_1.50dp	1/4" x 1 1/2" Dowel Pin	4
42	3.8-16_1.00ss	3/8-16 x 1" Socket Hd. Set Screw	1
43	3.8-16_1.25sh	3/8-16 x 1 1/4" Socket Hd Cap Screw	1
44	8-32_44sh	#8-32 x 7/16" Socket Hd Cap Screw	2
45	10fw-a	#10A Flatwasher	1
46	10-24_.75sh	#10-24 x 3/4" Socket Hd Cap Screw	1
47	10-32_.38bh	#10-32 x 3/8" Button Hd Cap Screw	1
48	10-32_.50sh	#10-32 x 1/2" Socket Hd Cap Screw	6
49	10-32_.75bh	#10-32 x 3/4" Button Hd Cap Screw	1
50	10-32_.75sh	#10-32 x 3/4" Socket Hd Cap Screw	7
51	10-32_1.00sh	#10-32 x 1" Socket Hd Cap Screw	1

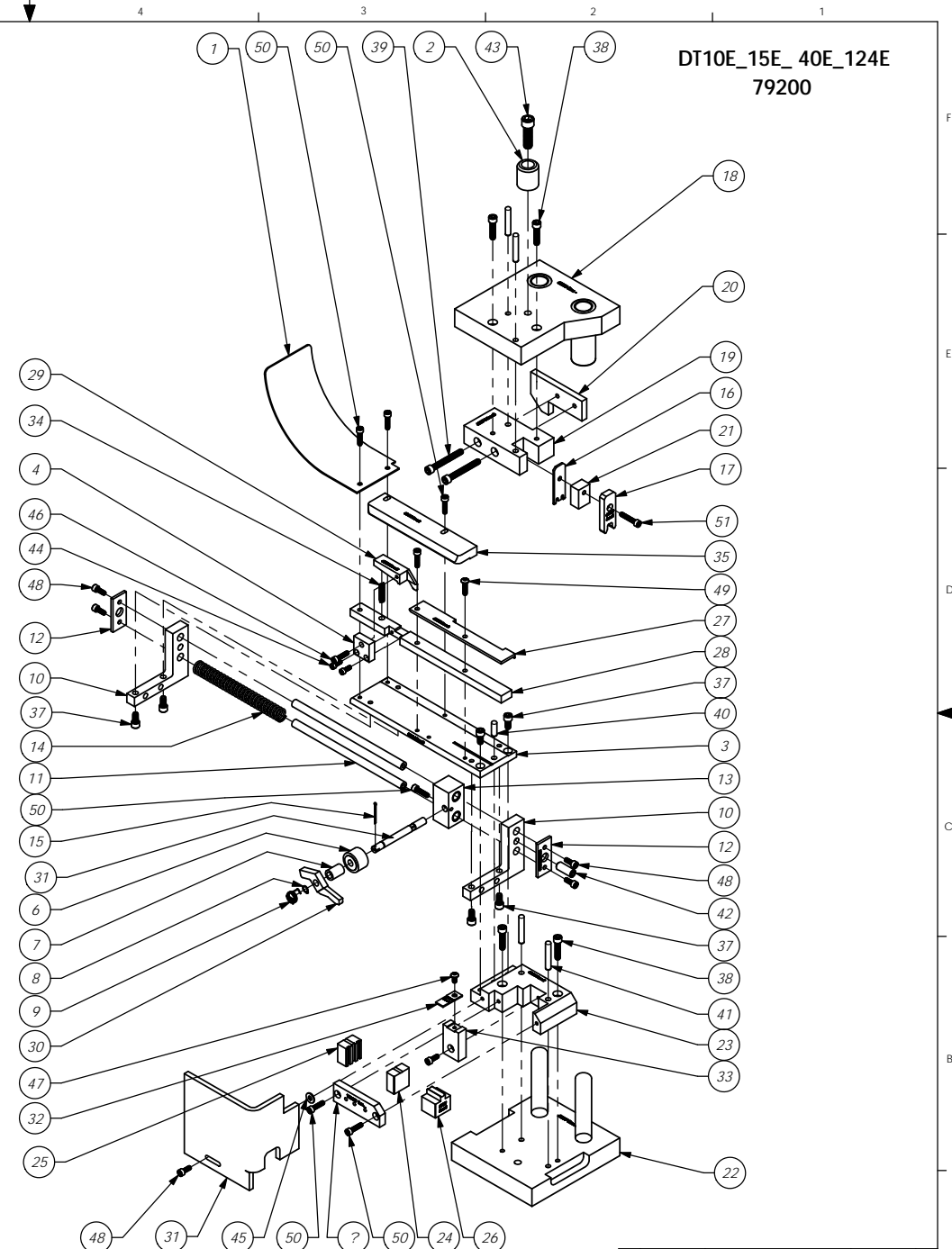

REV. NO.	DESCRIPTION	MATERIAL SPECIFICATION	QTY. REQ'D
	DO NOT SCALE DRAWING		
	UNLESS OTHERWISE SPECIFIED DIMENSIONS ARE IN INCHES. TOLERANCES ARE: FRACTIONS: DECIMALS: ANGLES: #1/64 .XX ±.01 XXXXX ±.0002		
E	ECR# 4922 SCJ	3/05/18	SURFACE FINISH: ALL OVER
D	Re-assy from AP 79200 Rev D	12/16/11	THE INFORMATION CONTAINED WITHIN THIS DRAWING IS THE SOLE PROPERTY OF ETCO. INCORPORATED. ANY REPRODUCTION IN PART OR WHOLE WITHOUT THE WRITTEN PERMISSION OF ETCO INCORPORATED IS PROHIBITED.
LVL	REVISION	BY/DATE	QTY. USED ON APPLICATION
			SCALE: 1:4 CAD FILE: DATE: DRAWN BY: SCJ DATE: 12-6-11

ITEM No. PART No. DESCRIPTION MATERIAL SPECIFICATION QTY. REQ'D
 See Parts List
 ETCO ENGINEERED PRODUCTS
 25 BELLOWS STREET
 WARWICK, RI 02888 (401)-467-2400
DT15E Applicator
 DT10E_15E_40E_124E
 SCJ 12-6-11