

ETCO INCORPORATED
AUTOMOTIVE PRODUCTS
PARTS REFERENCE LIST
REFER TO ASSEMBLY
FOR: DT60, DT65, DT66 ECC APPLICATOR

<u>KEY NO.</u>	<u>REQ'D</u>	<u>DESCRIPTION</u>	<u>AD PART NO.</u>	<u>RI Pt. No.</u>
1.	1	PLUNGER	70214	11-114
2.	1	ROLL TOOL - DT65	70215*	13-T6855-1
	1	ROLL TOOL - DT65, DT66	71445*	
3.	2	10-32 X 3/8" SHCS		
4.	1	DRIVER	70217	15-007
5.	1	TOP CASTING	70218	101A
6.	12	8-32 X 3/8" SHCS		
7.	2	GIB	70219	169-5
8.				
9.	1	CASTING SPACER	70220	116-188
10.	2	1/4-20 X 1/4" SSS		
11.	2	1/4-20 X 1" SHCS		
12.	2	1/4 X 1" DOWEL		
13.	1	1/4-28 JAM NUT		
14.	1	1/4-28 X 5/8" SSS		
15.	1	CAM ROLLER BRACKET	70221	1125
16.	1	10-32 X 1 1/2" SHCS		
17.	1	1/4-28 X 1/2" SHCS		
18.	1	CAM ROLLER BEARING	70146	1142
19.	2	1/8 X 1" DOWEL		
20.	1	BASE PLATE	70222	201-1
21.	3	SPRING	70161	407
22.	6	8-32 X 1/2" SHCS		
23.	1	ANVIL - DT60	70223*	9-040
	1	ANVIL - DT65, DT66	71446*	
24.	1	DIE	70225*	8-044
25.	1	1/8 X 1/2" DOWEL		
26.	1	FRONT GUIDE	70226	1000-63
27.	2	8-32 X 3/4" SHCS		
28.	1	WIRE STOP	70228	1600-140
29.	2	1/8 X 3/8" DOWEL		
30.	1	8-32 X 1/4" SHCS		
31.	1	REAR GUIDE	70229	500-176
32.	1	6-32 X 1/4" SHCS		
33.	2	8-32 X 3/8" BHCS		
34.	1	CARRIER CUTOFF	70231*	12-034
35.	1	DIE PLATE	70232	250-206
36.	2	6-32 X 1/2" SHCS		
37.	1	INCOMING RAMP	70233	1810
38.	1	5/16 X 3/8" SHCS		
39.				
40.	1	FEED FINGER	75246	303-135

41.	1	FEED FINGER SPRING	70235	307-3
42.	1	FEED FINGER SPACER	70190	304-25
43.	1	FEED SHAFT	70157	308
44.	1	FEED FINGER ARM	70236	305-5
45.	1	FEED STOP ARM	70191	306-1
46.	1	7/32 X 1/2" ROLL PIN	70152	311
47.	1	FEED TAPER PIN	70153	312
48.	1	CLOCK SPRING	70155	310
49.	1	CAM	70237	314-3
50.	1	BRAKE BODY	70238	403-36
51.	1	BRAKE SHAFT	70158	401
52.	1	BRAKE SPRING RETAINER	70159	402
53.	1	GUARD	70294	176L-1
54.	1	SPACER	70239	408-490
55.	1	COTTER PIN	70090	406
56.	1	BRAKE TAPER PIN	70163	405
57.	1	BRAKE CAM	70164	404
58.	1	CHUTE	70240	1800A
59.				
60.				
61.	1	DIE COVER	70242	8C-044

NOTE : ALL PARTS LISTED (*) ARE SUBJECT TO BREAKAGE

REV. "A" DATE 14Dec07

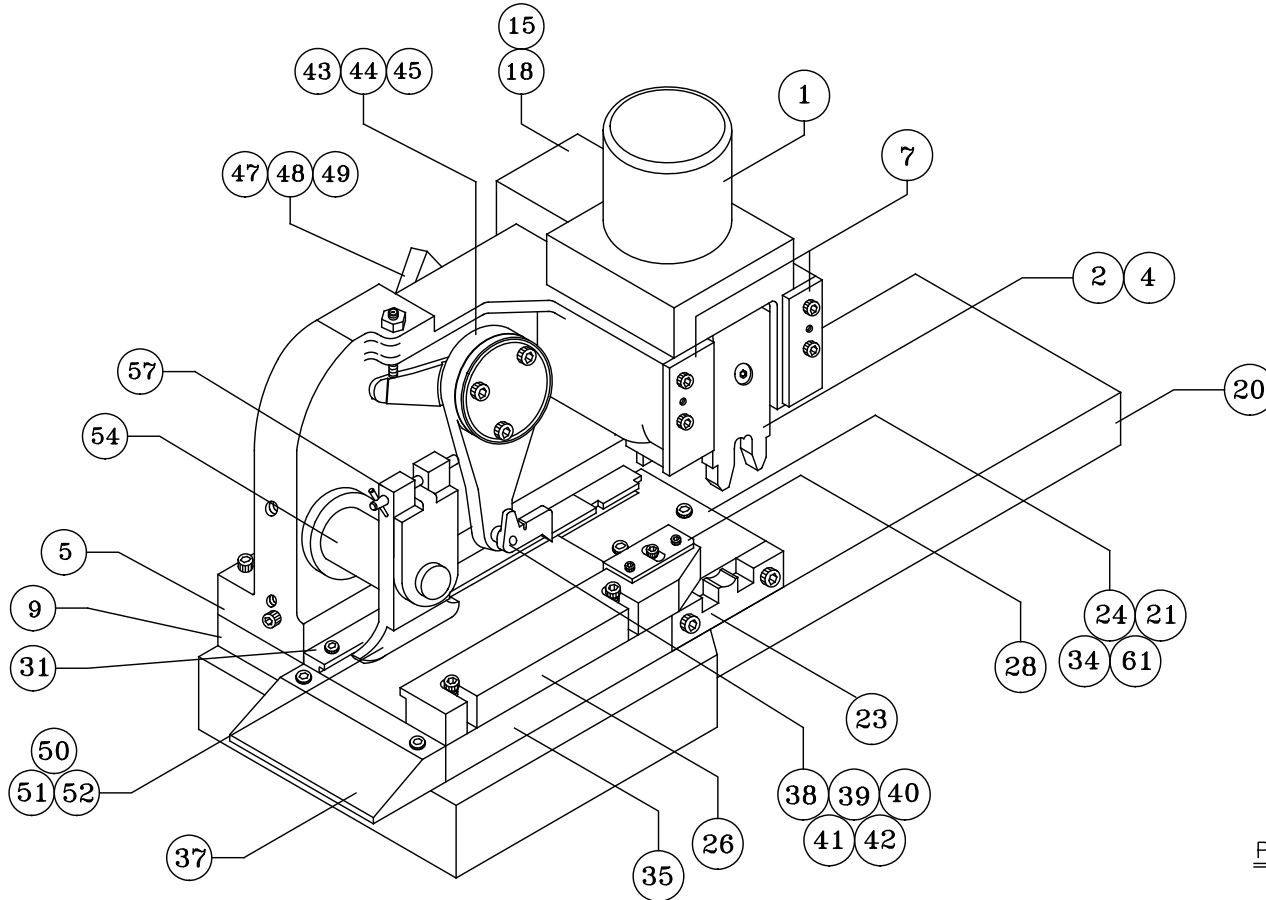

NOTE: ^(A)
 GUARD #70294 NOT SHOWN. DO NOT OPERATE APPLICATOR WITHOUT GUARD IN PLACE.

^(B)
 PART # DT60, DT65, DT66

REV.	DESCRIPTION	DATE	REV. BY	TOLERANCES UNLESS SPECIFIED	
				FRACTIONS ±	ANGLES ±
A	ADDED NOTE	9-11-96	SMK	.0000 ±	
B	ADD DT65, DELETE DT20, 30 & T6857	1/28/99	SEP	.000 ±	
				.00 ±	
DO NOT SCALE DRAWING					
ETCO INCORPORATED AUTOMOTIVE DIVISION 3004 62ND AVENUE EAST BRADENTON, FLORIDA 34203 (941) 756-8426					
ASSEMBLY					
MATERIAL				DATE	
				6-4-91	
DRAWN BY	CHECKED BY	SCALE	PART NO.		
CNP		1=1	7009		