

ITEM NO.	PART NUMBER	DESCRIPTION	SP24 R-L "7 mm"/QTY.
1	62127-Front Driver	Front Driver	1
2	62128-Rear Driver	Rear Driver	1
3	62154 - DIE COVER	Die Cover	1
4	62203-Feed Finger Holder	Feed Finger Holder	1
5	62897- CAM	Cam - 8.5mm	1
6	62929-Feed Finger Shaft	Feed Finger Shaft	1
7	62930-Feed Adj Block	Feed Adjustment Block	1
8	62928-Feed Finger	Feed finger	1
9	68001 - HAT SHANK	Hat Shank	1
10	68012 - SPRING	Spring	2
11	68020 - BRAKE SPRING	Spring	1
12	68022 - BEARING	Bearing	1
13	68025 - SPRING CLIP	Spring Clip	1
14	68028 - SLIDE SHAFT	Slide Shaft	2
15	68029 - SLIDE END CAP	Slide End Cap	1
16	68031 - SPRING	Spring	2
17	68034 - SPACER	Spacer	1
18	68037-Die Hat	Die Base	1
19	68038-Tool Holder	Tool Holder	1
20	68042-Spacer	Spacer	1
21	68043-Die Base	Die Base	1
22	68044-Die Holder	Die Holder	1
23	68045 - DIE COVER	Die Cover	1
24	68046-Spacer	Spacer	1
25	68047-Anvil	Anvil	1
26	68048-Front Carrier Cut-Off	Front Carrier Cut-Off	1
27	68049-Rear Die	Rear Die	1
28	68050-Rear Carrier Cut-Off	Rear Carrier Cut-Off	1
29	68052-Front Guide	Front Guide	1
30	68053-Brake Mount	Brake Mount	1
31	68054-Brake	Brake	1
32	68055-Slide Bracket	Slide Bracket	2
33	68056-Slide Block	Slide Block	1
34	68059-Rear Guide Rail	Rear Guide Rail	1
35	68060-Guard	Guard Assembly	1
36	68061-Driver Guide	Driver Guide	1
37	68062-Stock Retainer	Stock Retainer	1
38	68090 - Cotter Pin	Cotter Pin - 1/16" x 1"	1
39	68440-Stripper Mount	Stripper Mount	1
40	68441-Stripper Rod	Stripper Rod	1
41	68492-Roll Tool	Roll Tool (7MM)	1
42	68063-Spacer Chute	Spacer Chute	1
43	68503-Chute	Chute	1
44	100454-Feed Plate	Feed Plate	1
45	304-.500	Feed Finger Spacer	1
46	307-83R	Feed Finger Spring	1R
47	Boston Gear #B68-8	68092-Bushing	2
48	8-32_.31fh	#8-32 x 5/16" Flat Head Socket Screw	4
49	8-32_.31sh	#8-32 x 5/16" Socket Hd Cap Screw	3
50	8-32_.50sh	#8-32 x 1/2" Socket Hd Cap Screw	2
51	10-24_.75sh	#10-24 x 3/4" Socket Hd Cap Screw	1
52	10-32_.38bh	#10-32 x 3/8" Button Hd Cap Screw	3
53	10-32_.38sh	#10-32 x 3/8" Socket Hd Cap Screw	3
54	10-32_.50sh	#10-32 x 1/2" Socket Hd Cap Screw	6
55	10-32_.50ss	#10-32 x 1/2" Socket Hd Set Screw	1
56	10-32_.75sh	#10-32 x 3/4" Socket Hd Cap Screw	1
57	10-32_.88bh	#10-32 x 7/8" Button Hd Cap Screw	1
58	10-32_1.12sh	#10-32 x 1 1/8" Socket Hd Cap Screw	1
59	1.4-20_.31sh	1/4-20 x 5/16" Socket Hd Cap Screw	2
60	1.4-20_.38sh	1/4-20 x 3/8" Socket Hd Cap Screw	5
61	1.4-20_.50sh	1/4-20 x 1/2" Socket Hd Cap Screw	1
62	1.4-20_.63sh	1/4-20 x 5/8" Socket Hd Cap Screw	4
63	1.4-20_.75sh	1/4-20 x 3/4" Socket Hd Cap Screw	2
64	1.4-20_1.00sh	1/4-20 x 1" Socket Hd Cap Screw	2
65	1.4-20_1.25sh	1/4-20 x 1 1/4" Socket Hd Cap Screw	3
66	1.4-20_1.75 sh	1/4-20 x 1 3/4" Socket Hd Cap Screw	3
67	3.8-16_1.00sh	3/8-16 x 1" Socket Hd Cap Screw	1
68	3.8-16_1.00ss	3/8-16 x 1" Socket Hd. Set Screw	1
69	3.16_1.50dp	3/16 x 1 1/2" Dowel Pin	4

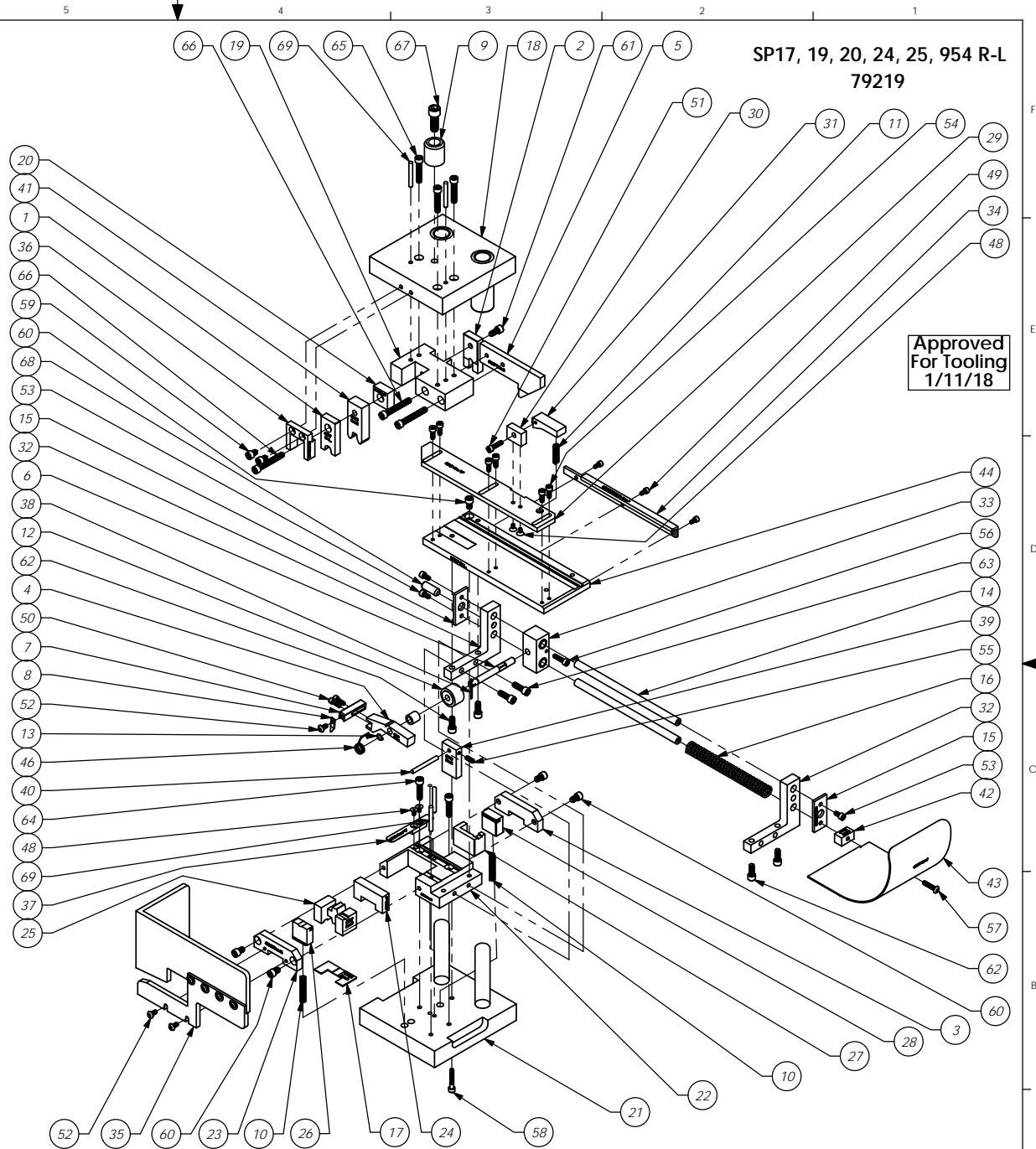

SP17, 19, 20, 24, 25, 954 R-L
79219

Approved
For Tooling
1/11/18

ITEM NO.	PART NO.	DESCRIPTION	MATERIAL SPECIFICATION	QTY	RECD
PARTS LIST					
See Parts List					
SP24 R-L "7 mm" Applicator					
MATERIAL: ETCO ENGINEERED PRODUCTS, 25 BELLOWS STREET, WARWICK, RI 02886 (401)-467-2400					
HEAT TREAT: NONE					
FINISH: NONE					
SCALE: 1:12					
CHECKED BY: SCJ					
DATE: 1/17/12					
DRAWN BY: SCJ					
DATE: 1/17/12					
SIZE: C					

REV	DESCRIPTION	BY/DATE	QTY	USED ON	APPLICATION
F	ECR# 4934 SCJ	3/7/18			
E	Re-assy from AP 7003 Rev D	3/7/12			
LVL	REVISION	BY/DATE	QTY	USED ON	APPLICATION