

ITEM NO.	PART NUMBER	DESCRIPTION	SP19 R-L "8 mm"/QTY.
1	62154 - DIE COVER	Die Cover	1
2	62203-Feed Finger Holder	Feed Finger Holder	1
3	62897- CAM	Cam - 8.5mm	1
4	62929-Feed Finger Shaft	Feed Finger Shaft	1
5	62930-Feed Adj Block	Feed Adjustment Block	1
6	62928-Feed Finger	Feed finger	1
7	68001 - HAT SHANK	Hat Shank	1
8	68007 - FRONT DRIVER	Front Driver - 8mm	1
9	68012 - SPRING	Spring	2
10	68020 - BRAKE SPRING	Spring	1
11	68022 - BEARING	Bearing	1
12	68025 - SPRING CLIP	Spring Clip	1
13	68028 - SLIDE SHAFT	Slide Shaft	2
14	68029 - SLIDE END CAP	Slide End Cap	2
15	68031 - SPRING	Spring	1
16	68034 - SPACER	Spacer	1
17	68037-Die Hat	Die Base	1
18	68038-Tool Holder	Tool Holder	1
19	68040-Rear Driver	Rear Driver	1
20	68041-Roll Tool	Roll Tool	1
21	68042-Spacer	Spacer	1
22	68043-Die Base	Die Base	1
23	68044-Die Holder	Die Holder	1
24	68045 - DIE COVER	Die Cover	1
25	68046-Spacer	Spacer	1
26	68047-Anvil	Anvil	1
27	68048-Front Carrier Cut-Off	Front Carrier Cut-Off	1
28	68049-Rear Die	Rear Die	1
29	68050-Rear Carrier Cut-Off	Rear Carrier Cut-Off	1
30	68052-Front Guide	Front Guide	1
31	68053-Brake Mount	Brake Mount	1
32	68054-Brake	Brake	1
33	68055-Slide Bracket	Slide Bracket	2
34	68056-Slide Block	Slide Block	1
35	68059-Rear Guide Rail	Rear Guide Rail	1
36	68060-Guard	Guard Assembly	1
37	68061-Driver Guide	Driver Guide	1
38	68062-Stock Retainer	Stock Retainer	1
39	68090 - Cotter Pin	Cotter Pin - 1/16" x 1"	1
40	68440-Stripper Mount	Stripper Mount	1
41	68441-Stripper Rod	Stripper Rod	1
42	68063-Spacer Chute	Spacer Chute	1
43	68503-Chute	Chute	1
44	100454-Feed Plate	Feed Plate	1
45	304-250	Feed Finger Spacer	1
46	307-83R	Feed Finger Spring	1
47	Boston Gear #B68-8	68092-Bushing	2
48	8-32_31fh	#8-32 x 5/16" Flat Head Socket Screw	4
49	8-32_31sh	#8-32 x 5/16" Socket Hd Cap Screw	3
50	8-32_50sh	#8-32 x 1/2" Socket Hd Cap Screw	2
51	10-24_75sh	#10-24 x 3/4" Socket Hd Cap Screw	1
52	10-32_38bh	#10-32 x 3/8" Button Hd Cap Screw	3
53	10-32_38sh	#10-32 x 3/8" Socket Hd Cap Screw	3
54	10-32_50sh	#10-32 x 1/2" Socket Hd Cap Screw	6
55	10-32_50ss	#10-32 x 1/2" Socket Hd Set Screw	1
56	10-32_75sh	#10-32 x 3/4" Socket Hd Cap Screw	1
57	10-32_88bh	#10-32 x 7/8" Button Hd Cap Screw	1
58	10-32_1.12sh	#10-32 x 1 1/8" Socket Hd Cap Screw	1
59	1.4-20_31sh	1/4-20 x 5/16" Socket Hd Cap Screw	2
60	1.4-20_38sh	1/4-20 x 3/8" Socket Hd Cap Screw	5
61	1.4-20_50sh	1/4-20 x 1/2" Socket Hd Cap Screw	1
62	1.4-20_63sh	1/4-20 x 5/8" Socket Hd Cap Screw	4
63	1.4-20_75sh	1/4-20 x 3/4" Socket Hd Cap Screw	2
64	1.4-20_1.00sh	1/4-20 x 1" Socket Hd Cap Screw	2
65	1.4-20_1.25sh	1/4-20 x 1 1/4" Socket Hd Cap Screw	3
66	1.4-20_1.75 sh	1/4-20 x 1 3/4" Socket Hd Cap Screw	3
67	3.8-16_1.00sh	3/8-16 x 1" Socket Hd Cap Screw	1
68	3.8-16_1.00ss	3/8-16 x 1" Socket Hd. Set Screw	1
69	3.16_1.50dp	3/16 x 1 1/2" Dowel Pin	4

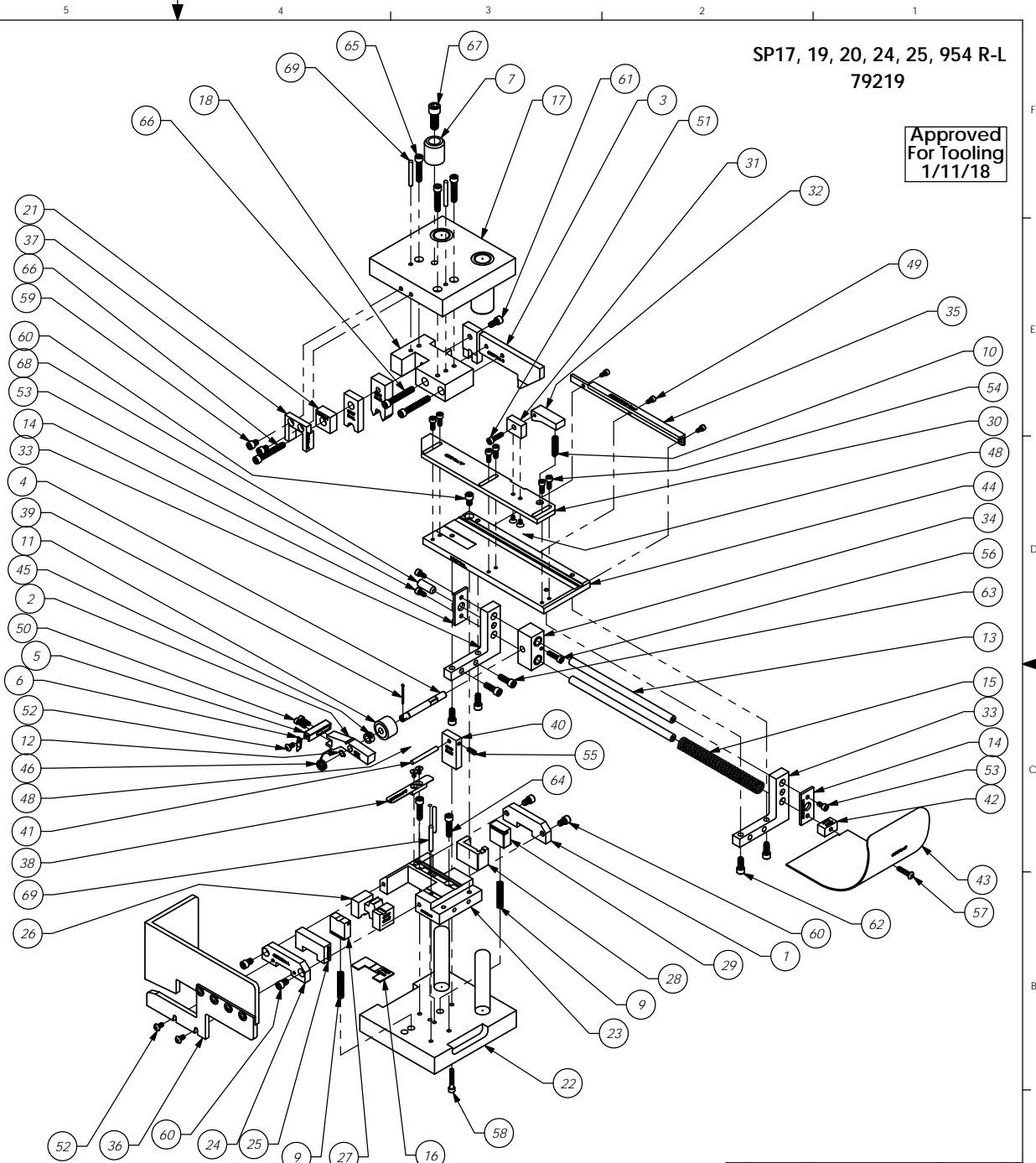

SP17, 19, 20, 24, 25, 954 R-L  
79219

Approved  
For Tooling  
1/11/18

ITEM NO.	PART NO.	DESCRIPTION	MATERIAL SPECIFICATION	QTY.	REVISION	BY/DATE	APPLICATION	SCALE	CAD FILE	CHECKED BY	DATE	DRAWN BY	DATE	SIZE
<p>DO NOT SCALE DRAWING</p> <p>UNLESS OTHERWISE SPECIFIED DIMENSIONS ARE IN INCHES. TOLERANCES ARE:</p> <p>FRACTIONS DECIMALS ANGLES</p> <p>±1/64 .001 ±15°</p> <p>XXXX.0002</p>														
F	ECR# 4934	SCJ				3/17/18	SURFACE FINISH	T	ALL OVER					
E	Re-assy from AP 7003	Rev D				3/18/12	<p>THE INFORMATION CONTAINED WITHIN THE DRAWING IS THE SOLE PROPERTY OF ETCO. NO REPRODUCTION OR TRANSMISSION OF ANY INFORMATION IN THIS DRAWING WITHOUT THE WRITTEN PERMISSION OF ETCO IS EXPRESSLY PROHIBITED.</p>							
<p>See Parts List</p> <p>SP19 R-L "8 mm" Applicator</p>														
<p>ETCO ENGINEERED PRODUCTS 25 BELLOWS STREET WARWICK, RI 02888 (401)-467-2400</p>														
<p>SCALE: 1:12</p>														
<p>DATE: 1/17/12</p>														
<p>DATE: 1/17/12</p>														