

ITEM NO.	PART NUMBER	DESCRIPTION	QTY.
1	62879 - Die Hat	Die Hat	1
2	68001 - HAT SHANK	Hat Shank	1
3	62880-Tool Holder	Tool Holder	1
4	62893-Core Roll Tool	Core Roll Tool - 7 & 8.5 mm	1
5	63400-Roll Tool	Roll Tool 7MM	1
6	62889-Roll Tool	Roll Tool (8.5MM)	1
7	62127-Front Driver	Front Driver	1
8	62128-Rear Driver	Rear Driver	1
9	68039-Cam	Cam	1
10	62881-Die Base	Die Base	1
11	62882-Die Holder	Die Holder	1
12	62896-Core Anvil	Core Anvil	1
13	62895-Anvil	Anvil	1
14	62891-Spacer	Spacer	1
15	68048-Front Carrier Cut-Off	Front Carrier Cut-Off	1
16	62890 - DIE COVER	Die Cover	1
17	68012 - SPRING	Spring	2
18	68663-Rear Die	Rear Die	1
19	68050-Rear Carrier Cut-Off	Rear Carrier Cut-Off	1
20	63337-Rear Die Cover	Rear Die Cover	1
21	68062-Stock Retainer	Stock Retainer	1
22	68440-Stripper Mount	Stripper Mount	1
23	68441-Stripper Rod	Stripper Rod	1
24	62886-Feed Plate	Feed Plate	1
25	62885-Front Guide Rail	Front Guide Rail	1
26	68054-Brake	Brake	1
27	62898-Brake Mount	Brake Mount	1
28	68020 - BRAKE SPRING	Spring	1
29	62887-Rear Guide	Rear Guide Rail	1
30	68055-Slide Bracket	Slide Bracket	2
31	68028 - SLIDE SHAFT	Slide Shaft	2
32	68031 - SPRING	Spring	1
33	68056-Slide Block	Slide Block	1
34	68029 - SLIDE END CAP	Slide End Cap	2
35	63339-Feed Finger Shaft	Feed Finger Shaft	1
36	68022 - BEARING	Bearing	1
37	63341-Feed Finger Spacer	Feed Finger Spacer	1
38	63340-Feed Finger Holder	Feed Finger Holder	1
39	68025 - SPRING CLIP	Spring Clip	1
40	307-83R	Feed Finger Spring	1
41	68090 - Cotter Pin	Cotter Pin - 1/16" x 1"	1
42	62201-Feed Adj Block	Feed Adjustment Block	1
43	63338-Feed Finger	Feed finger	1
44	68063-Spacer Chute	Spacer Chute	1
45	68503-Chute	Chute	1
46	62888 - GUARD	Guard	1
47	8-32_.31fhs	#8-32 x 5/16" Flat Hd Screw - Phillips	4
48	8-32_.31bh	#8-32 x 5/16" Button Hd Cap Screw	1
49	8-32_.38bh	#8-32 x 3/8" Button Hd Cap Screw	3
50	8-32_.50bh	#8-32 x 1/2" Button Hd Cap Screw	2
51	10-24_.75sh	#10-24 x 3/4" Socket Hd Cap Screw	1
52	10-32_.50ss	#10-32 x 1/2" Socket Hd Set Screw	1
53	10-32_.38sh	#10-32 x 3/8" Socket Hd Cap Screw	3
54	10-32_.50sh	#10-32 x 1/2" Socket Hd Cap Screw	1
55	10-32_.50bh	#10-32 x 1/2" Button Hd Cap Screw	2
56	10-32_.88bh	#10-32 x 7/8" Button Hd Cap Screw	1
57	10-32_1.00sh	#10-32 x 1" Socket Hd Cap Screw	1
58	3.16_1.50dp	3/16 x 1 1/2" Dowel Pin	4
59	1.4-20_.31sh	1/4-20 x 5/16" Socket Hd Cap Screw	1
60	1.4-20_.38sh	1/4-20 x 3/8" Socket Hd Cap Screw	6
61	1.4-20_.50sh	1/4-20 x 1/2" Socket Hd Cap Screw	7
62	1.4-20_.75sh	1/4-20 x 3/4" Socket Hd Cap Screw	1
63	1.4-20_1.00sh	1/4-20 x 1" Socket Hd Cap Screw	5
64	1.4-20_1.25sh	1/4-20 x 1 1/4" Socket Hd Cap Screw	1
65	1.4-20_2.50sh	1/4-20 x 2 1/2" Socket Hd Cap Screw	2
66	3.8-16_1.00sh	3/8-16 x 1" Socket Hd Cap Screw	1
67	3.8-16_1.00ss	3/8-16 x 1" Socket Hd. Set Screw	1

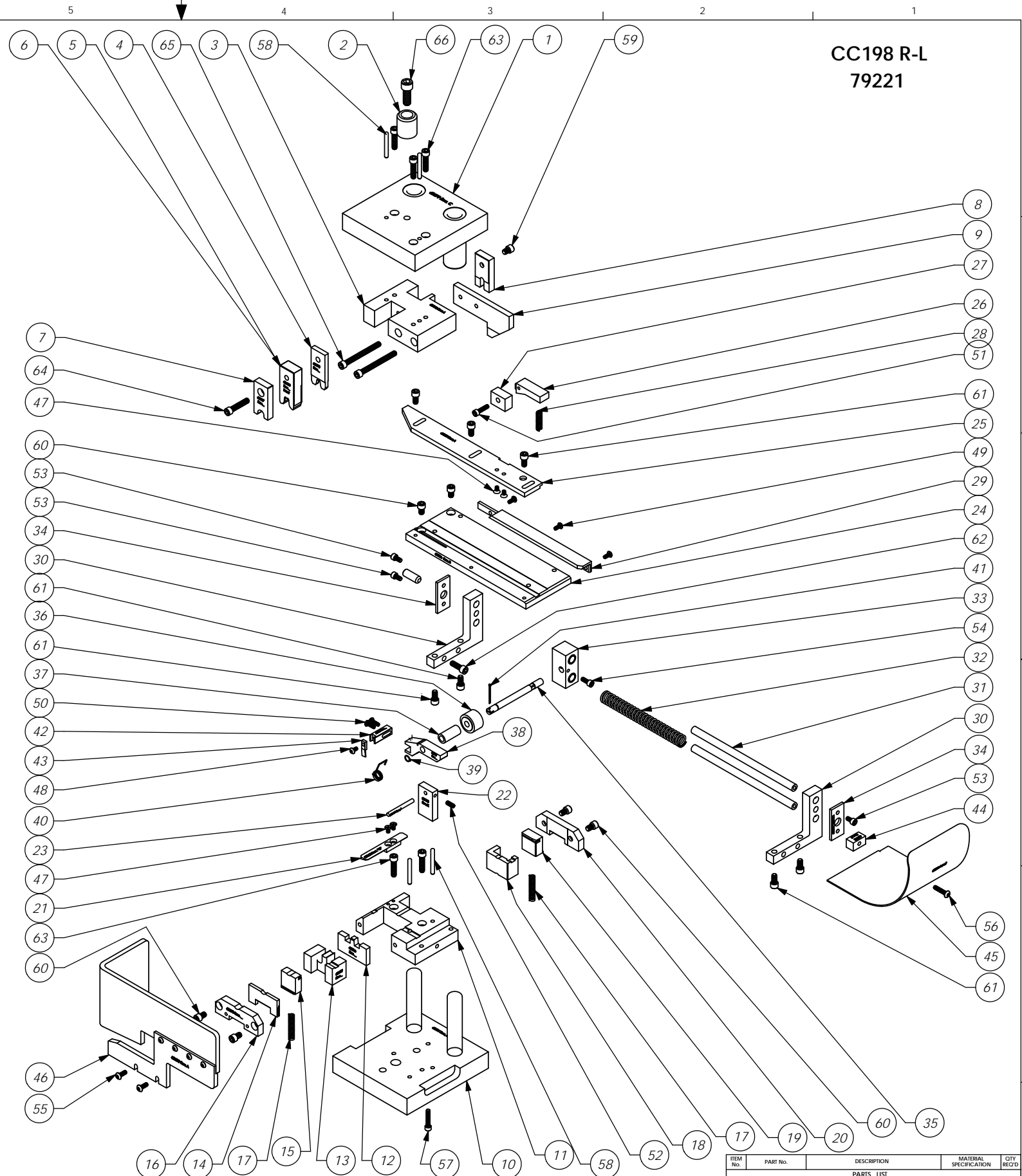

**CC198 R-L
79221**

ITEM NO.	PART No.	DESCRIPTION	MATERIAL SPECIFICATION	QTY	RECD
PARTS LIST					
MATERIAL: See Parts List					
ETCO ENGINEERED PRODUCTS 25 BELLOWS STREET WARWICK RI 02888 (401)-467-2400					
CC198 R-L Applicator					
HEAT TREAT:					
FINISH:					
DWG. NO. CC198 R-L					
SCALE: 1:4					
CAD FILE:					
CHECKED BY: SCJ DATE: 3/15/12					
DRAWN BY: SCJ DATE: 3/15/12					
SIZE: C					