

Parts List					Parts List				
Item No.	QTY.	Part Code	Part No.	Description	Item No.	QTY.	Part Code	Part No.	Description
1	1	74568	1600-3000	Stripper / Wire Stop	68	4	63209	6-32_.38sh	#6-32 x 3/8" Socket Hd Cap Screw
2	1	62336	15-3001	Driver	69	2	63057	6-32_.50fh	#6-32 x 1/2" Flat Hd Cap Screw
3	1	<b>61929</b>	<b>9-4011</b>	<b>Wire Anvil</b>	70	2	63210	8fw	#8 Flatwasher
4	1	<b>76679</b>	<b>9A-4004</b>	<b>Insulation Anvil</b>	71	1	63212	8-32_.25bh	#8-32 x 1/4" Button Hd Cap Screw
5	1	<b>61928</b>	<b>13-4011</b>	<b>Wire Rolling Tool</b>	72	2	63161	8-32_.38sh	#8-32 x 3/8" Socket Hd Cap Screw
6	1	<b>70875</b>	<b>14-4006</b>	<b>Ins. Rolling Tool (Overlap style)</b>	73	2	63052	8-32_.50fh	#8-32 x 1/2" Flat Hd Cap Screw
7	2	73888	GS-125	Guard Spacer	74	2	63164	8-32_.50sh	#8-32 x 1/2" Socket Hd Cap Screw
8	1	71494	MX2A-S-1	Mounting Frame	75	1	63213	8-32_1.00sh	#8-32 x 1" Socket Hd Cap Screw
9	1	71030	MX2B-S	Plunger Frame	76	4	63158	3.16_.50dp	Ø 3/16" x 1/2" Dowel Pin
10	1	74343	MX3	Ram	77	12	63470	3.16_.75dp	Ø 3/16" x 3/4" Dowel Pin
11	1	74344	MX4-S	Cam (1 5/8" Up Stroke)	78	1	78327	10-32_.13bh	#10-32 x 1/8" Button Hd Cap Screw
12	1	74438	MX5-S	Cam Rack	79	2	63054	10-32_.25ss	#10-32 x 1/4" Socket Hd Set Screw
13	1	74346	MX6	Gear Arm	80	6	78993	10-32_.38bh	#10-32 x 3/8" Button Hd Cap Screw
14	1	74347	MX7	Cam Pin	81	1	70110	10-32_.38sh	#10-32 x 3/8" Socket Hd Cap Screw
15	1	74350	MX8	Cam Roller	82	4		10-32_.38ssf	#10-32 x 3/8" Socket Hd Set Screw
16	2	74351	MX10-S	Rack Pad	83	2	63056	10-32_.50sh	#10-32 x 1/2" Socket Hd Cap Screw
17	2	74352	MX11	Gib	84	4	76501	10-32_.50bh	#10-32 x 1/2" Button Hd Cap Screw
18	1	74356	MX12	Feed Finger Pivot Pin	85	1	70293	10-32_.63sh	#10-32 x 5/8" Socket Hd Cap Screw
19	1	74360	MX13	Adjusting Bar	86	2	63532	10-32_.75sh	#10-32 x 3/4" Socket Hd Cap Screw
20	1	76868	MX14-1-S	Feed Finger Arm	87	2	63827	1.4_.50dp	Ø 1/4" x 1/2" Dowel Pin
21	1	76874	MX15-1-S	Feed Finger Guide	88	3	63632	1.4-20_.50bh	1/4-20 x 1/2" Button Hd Cap Screw
22	1	74364	MX16	Retainer	89	1	63055	5.16-18_1.00bh	5/16-18 x 1" Button Hd Cap Screw
23	1	71495	MX18-S-1	Swing Arm					
24	1	74376	MX25	Stroke Adjustment Screw					
25	1	74407	MX33	Mounting Post					
26	1	72042	MX34-E	Wire Crimp Dial					
27	1	74409	MX35	Insulation Dial					
28	1	74411	MX36	Dial Spacer					
29	1	74412	MX44	Locating Dowel					
30	1	74415	MX45-S	Feed Finger Spring					
31	3	74419	MX50	Safety Pivot Pin					
32	2	71493	MX52-S-1	Pivot Pin					
33	1	74614	MX90-S	Spring Bracket					
34	1	72310	MX104	Wave Disc Spring					
35	1	71678	MX105-S	Pivot Pin Plate					
36	1	72261	MX302-1-ITD-S	Base Plate					
37	1	76566	MX307-ITD-S	Stock Chute					
38	1	<b>78936</b>	<b>MX309-4-ITD-S</b>	<b>Cut-off Keeper</b>					
39	1	72257	MX310-1-ITD-S	Die Holder					
40	1	76570	MX311-ITD-S	Left Feed Shim (1/4")					
41	1	76574	MX315-ITD-S	Insulation Tool Spacer					
42	1	76576	MX317-ITD-S	Base Plate Spacer					
43	1	76578	MX319-ITD-S	Knock off					
44	1	76579	MX320-ITD-S	Brake					
45	1	76580	MX321-ITD-S	Brake Actuator					
46	1	<b>78935</b>	<b>MX326-4-ITD-S</b>	<b>Cut-off Pad</b>					
47	1	76586	MX327-ITD-S	Left Feed Rail					
48	1	76587	MX328-ITD-S	Hold Down Spring					
49	1	76588	MX329-ITD-S	Right Feed Rail					
50	1	76589	MX330-ITD-S	Feed Plate					
51	1	76661	MX337-ITD-S	Feed Finger (fed between carrier and inslu ear)					
52	1	71686	MX337-2-ITD-S	Feed Finger (fed in carrier strip hole)					
53	1	70745	MX339-ITD-S	Guard					
54	1	72893	MX357-ITD-S	Bracket					
55	1	78835	MX360-ITD-S	Scrap Retainer					
56	1	72350	5-047x1.000	Compression Spring					
57	2	72069	McMaster Carr #98407A118	#8 E-Style Retaining Ring					
58	1	72315	LC-022A-4	Compression Spring					
59	2	78681	LC-029B-3-M	Compression Spring					
60	1	74611	LE-037CD-6	Extension Spring					
61	2	70739	McMaster-Carr #3126A53	Spring Plunger					
62	1	74447	McMaster-Carr #98296A109	Expansion Pin (1/16 x 1/2")					
63	2	63203	4-40_.13bh	#4-40 x 1/8" Button Hd Cap Screw					
64	1	63205	1.8_.38rp	Ø 1/8" x 3/8" Roll Pin					
65	1	63053	1.8_.63rp	1/8" x 5/8" Roll Pin					
66	1	62040	1.8_1.00rp	1/8" x 1" Roll Pin					
67	5	63207	6-32_.25sh	#6-32 x 1/4" Socket Hd Cap Screw					

### Assembly Drawing and Bill of Materials

Applicator Type: MX ITD Side with Insulation Overlap Crimp (No Pod Insertion)  
Terminal: PD265  
BOM #79248

### Section 5

- Note:
- 1) Items marked in Bold Italic are high wear tooling
  - 2) Use OEM replacement tooling only.
  - 3) Recommended machine speed for automatic equipment is a maximum of 3500 parts per hour.

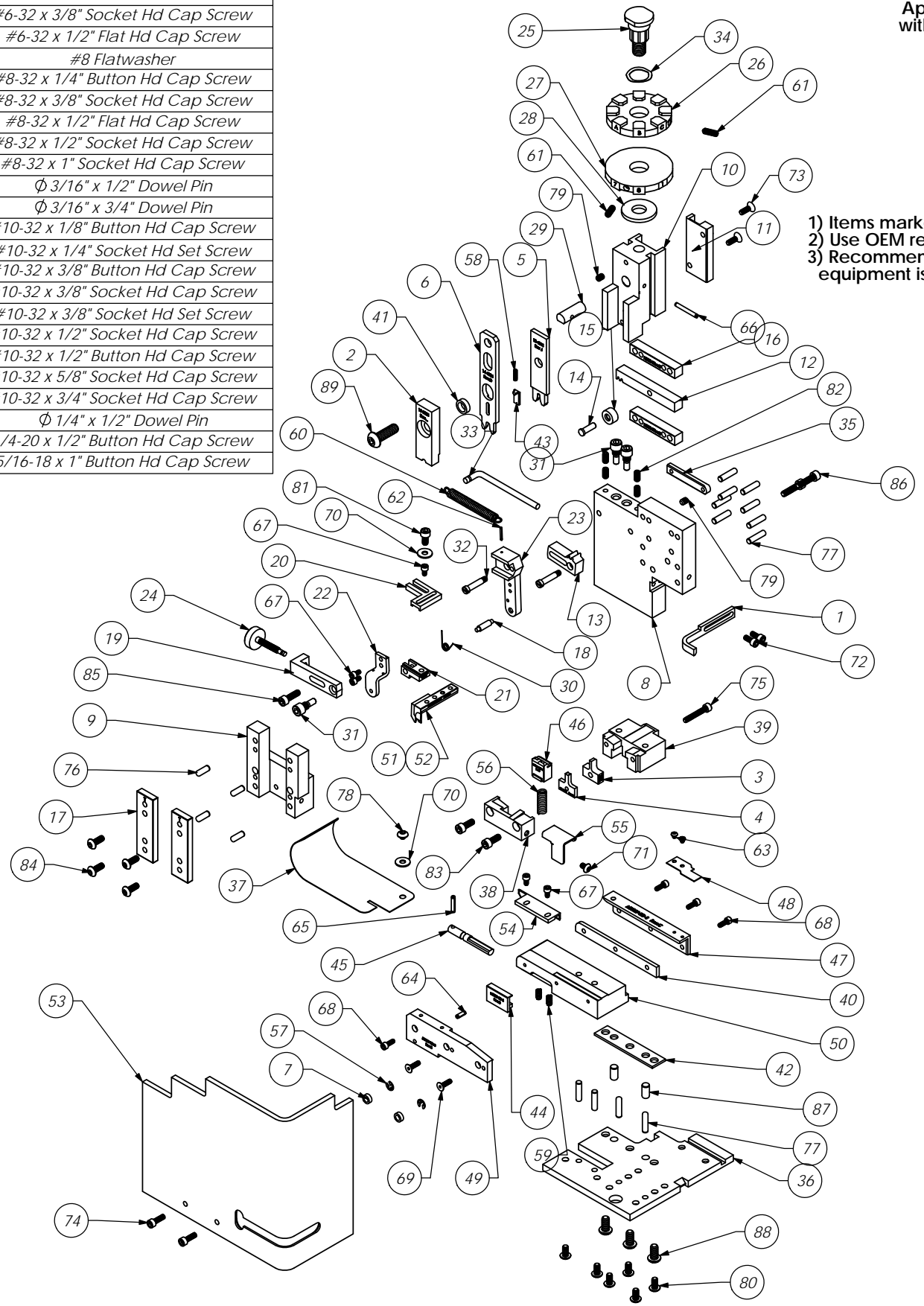

REV	DATE	DESCRIPTION	MATERIAL SPECIFICATION	OFF REC'D
1		Special for Honeywell		
A	9/14/15	ECR# 3894 SCJ		

PARTS LIST		MATERIAL		DATE	
1	PD265N	USED ON	SCALE	CAD REL.	DATE
1	PD265N(265)IOC/PG/N/P	1:12			8Dec04

DO NOT SCALE DRAWING		UNLESS OTHERWISE SPECIFIED DIMENSIONS ARE IN INCHES TOLERANCES ARE:	
FRACTIONS	DECIMALS	ANGLES	
±.004	±.01	±.01°	
	±.001	±.01°	
	±.0005		

REV	DATE	DESCRIPTION	MATERIAL SPECIFICATION	OFF REC'D
1		Special for Honeywell		
A	9/14/15	ECR# 3894 SCJ		