

Parts List				
Item No	Part Code	Part No	Description	QTY
1	61745	8A-4000	Front Cut-off Pad Retainer	1
2	62830	9-4031	Anvil	1
3	62831	9A-4031	Insulation Anvil	1
4	61747	12A-4000	Cut-off Pad	1
5	60601	IC-023C-B		1
6	62828	13-4031	Wire Rolling Tool	1
7	62829	14-4031	Insulation Rolling Tool	1
8	61916	15-6015	Cut-Off Pad Driver	1
9	61626	26-4000	Guard Bracket	1
10	76403	190-3008	Safety Guard	1
11	61542	MM1-S	Frame	1
12	61543	MM2-S	Base Plate	1
13	61545	MM3-S	Plunger	1
14	61761	250-6056	Feed Plate	1
15	62898	S00-6028	Rear Guide	1
16	61762	MM6-S-1	Front Guide	1
17	61549	MM7-S	Brake	1
18	61550	MM8-S	Brake Lever	1
19	61551	MM9-S	Adjustment Screw Retainer	1
20	61552	MM10-S	Adjustment Screw	1
21	61553	MM11-S	Brake Spring	2
22	61554	MM12	Adjustable Feed Piston	1
23	61555	MM13	Cam Roller	1
24	61556	MM14	Piston Spring	1
25	61557	MM15	Spring Plate	1
26	61558	MM16	Feed Adjustment Block	1
27	61559	MM17	Feed Adjustment Screw	1
28	61560	MM18	Retainer	1
29	61561	MM19	Guide Block	1
30	61562	MM20	Feed Washer	1
31	61563	MM21	Feed Finger Spring	1
32	61564	MM22	Feed Finger Shaft	1
33	61565	MM23	Feed Arm	1
34	61567	MM25-S	Feed Finger	1
35	61566	MM24	Feed Finger Retainer	1
36	61573	MM31	Post Feed Cam	1
37	61574	MM32	Pre-Feed Cam	1
38	61581	MM37-S	Tool Block	1
39	61582	MM38-S	Backup Block	1
40	61586	MM39	Cam	2
41	61585	MM43	Counter As'y	1
42	61586	MM44	Locator Pin	1
43	61588	MM47	Dog Screw	1
44	61912	MM49-S	Tool Holder	1
45	61590	MM48	Wt Adjustment Block	1
46	61592	MM50-S	Stripper Spacer	1
47	61593	MM51-S	Stripper	1
48	61595	MM56	Retaining Ring	1
49	61598	MM59	ID Plate	1
50	61596	MM57	Continuous Regulation Head Assembly	1
51	61597	MM58	Protection Spacer	1
52	<i>M3x0.5-5.0th</i>		<i>M3 x 5mm Socket Hd Cap Screw</i>	<i>2</i>
53	<i>M3x0.5-16.0th</i>		<i>M3 x 0.5 x 16mm Socket Hd Cap Screw</i>	<i>1</i>
54	<i>M4x 7-8.0th</i>		<i>M4 x 7 x 8mm Button Hd Cap Screw</i>	<i>3</i>
55	<i>M4x0.7-3.0th</i>		<i>M4 x 7 x 8 Socket Hd Cap Screw</i>	<i>1</i>
56	<i>M5-18.0tp</i>		<i>M5 x 18mm Dowel Pin</i>	<i>1</i>
57	<i>M5-M3 gear</i>		<i>M5 External Retaining Ring</i>	<i>2</i>
58	<i>M5x 8-10.0th</i>		<i>M5 x 8 x 10mm Socket Hd Cap Screw</i>	<i>1</i>
59	<i>M5x 8-16.0th</i>		<i>M5 x 8 x 16mm Socket Hd Cap Screw</i>	<i>5</i>
60	<i>M5x 8-12.0th</i>		<i>M5 x 8 x 12mm Socket Hd Cap Screw</i>	<i>3</i>
61	<i>M5x 8-35.0th</i>		<i>M5 x 35mm Socket Hd Cap Screw</i>	<i>2</i>
62	<i>M6x1.0-12.0th</i>		<i>M6 x 1.0 x 12mm Button Hd Cap Screw</i>	<i>1</i>
63	<i>M6x1.0-16.0th</i>		<i>M6 x 1.0 x 16mm Button Hd Cap Screw</i>	<i>2</i>
64	<i>M6-18tp</i>		<i>M6 x 18mm Dowel Pin</i>	<i>1</i>
65	<i>M6-20tp</i>		<i>M6 x 20mm Dowel Pin</i>	<i>2</i>
66	<i>M6-nr</i>		<i>M6 Lock Nut</i>	<i>1</i>
67	<i>M6x1.0-40.0th</i>		<i>M6 x 1.0 x 40mm Socket Hd Cap Screw</i>	<i>1</i>
68	<i>M6-10thss</i>		<i>M6 x 10mm Socket Hd Shoulder Screw</i>	<i>2</i>
69	<i>M8 x1.25-35.0th</i>		<i>M8 x 1.25 x 35mm Button Hd Cap Screw</i>	<i>1</i>
70	<i>M8-nr</i>		<i>M8 Lock Nut</i>	<i>2</i>
71	<i>M10x0.75-1.0th #10E607A132</i>		<i>#10 E-Style Retaining Ring</i>	<i>2</i>

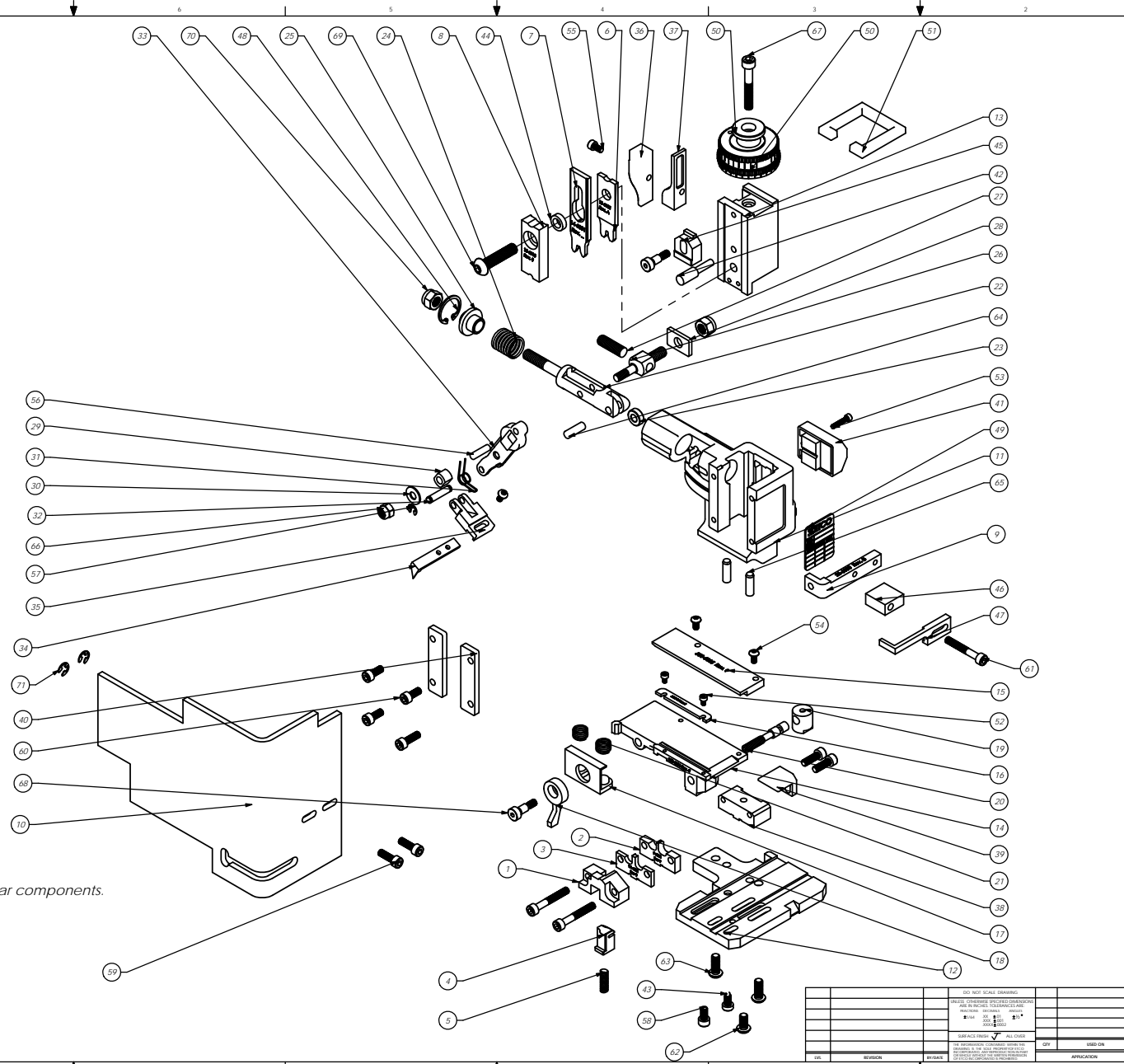

Note:  
 1) Items marked in **bold italic** are high wear components.  
 2) Use OEM replacement tooling only.

REV		DESCRIPTION	DATE
1		ISSUE FOR DRAWING	7/25/2012
2		ISSUE FOR DRAWING	7/25/2012
3		ISSUE FOR DRAWING	7/25/2012
4		ISSUE FOR DRAWING	7/25/2012
5		ISSUE FOR DRAWING	7/25/2012
6		ISSUE FOR DRAWING	7/25/2012
7		ISSUE FOR DRAWING	7/25/2012
8		ISSUE FOR DRAWING	7/25/2012
9		ISSUE FOR DRAWING	7/25/2012
10		ISSUE FOR DRAWING	7/25/2012
11		ISSUE FOR DRAWING	7/25/2012
12		ISSUE FOR DRAWING	7/25/2012
13		ISSUE FOR DRAWING	7/25/2012
14		ISSUE FOR DRAWING	7/25/2012
15		ISSUE FOR DRAWING	7/25/2012
16		ISSUE FOR DRAWING	7/25/2012
17		ISSUE FOR DRAWING	7/25/2012
18		ISSUE FOR DRAWING	7/25/2012
19		ISSUE FOR DRAWING	7/25/2012
20		ISSUE FOR DRAWING	7/25/2012
21		ISSUE FOR DRAWING	7/25/2012
22		ISSUE FOR DRAWING	7/25/2012
23		ISSUE FOR DRAWING	7/25/2012
24		ISSUE FOR DRAWING	7/25/2012
25		ISSUE FOR DRAWING	7/25/2012
26		ISSUE FOR DRAWING	7/25/2012
27		ISSUE FOR DRAWING	7/25/2012
28		ISSUE FOR DRAWING	7/25/2012
29		ISSUE FOR DRAWING	7/25/2012
30		ISSUE FOR DRAWING	7/25/2012
31		ISSUE FOR DRAWING	7/25/2012
32		ISSUE FOR DRAWING	7/25/2012
33		ISSUE FOR DRAWING	7/25/2012
34		ISSUE FOR DRAWING	7/25/2012
35		ISSUE FOR DRAWING	7/25/2012
36		ISSUE FOR DRAWING	7/25/2012
37		ISSUE FOR DRAWING	7/25/2012
38		ISSUE FOR DRAWING	7/25/2012
39		ISSUE FOR DRAWING	7/25/2012
40		ISSUE FOR DRAWING	7/25/2012
41		ISSUE FOR DRAWING	7/25/2012
42		ISSUE FOR DRAWING	7/25/2012
43		ISSUE FOR DRAWING	7/25/2012
44		ISSUE FOR DRAWING	7/25/2012
45		ISSUE FOR DRAWING	7/25/2012
46		ISSUE FOR DRAWING	7/25/2012
47		ISSUE FOR DRAWING	7/25/2012
48		ISSUE FOR DRAWING	7/25/2012
49		ISSUE FOR DRAWING	7/25/2012
50		ISSUE FOR DRAWING	7/25/2012
51		ISSUE FOR DRAWING	7/25/2012
52		ISSUE FOR DRAWING	7/25/2012
53		ISSUE FOR DRAWING	7/25/2012
54		ISSUE FOR DRAWING	7/25/2012
55		ISSUE FOR DRAWING	7/25/2012
56		ISSUE FOR DRAWING	7/25/2012
57		ISSUE FOR DRAWING	7/25/2012
58		ISSUE FOR DRAWING	7/25/2012
59		ISSUE FOR DRAWING	7/25/2012
60		ISSUE FOR DRAWING	7/25/2012
61		ISSUE FOR DRAWING	7/25/2012
62		ISSUE FOR DRAWING	7/25/2012
63		ISSUE FOR DRAWING	7/25/2012
64		ISSUE FOR DRAWING	7/25/2012
65		ISSUE FOR DRAWING	7/25/2012
66		ISSUE FOR DRAWING	7/25/2012
67		ISSUE FOR DRAWING	7/25/2012
68		ISSUE FOR DRAWING	7/25/2012
69		ISSUE FOR DRAWING	7/25/2012
70		ISSUE FOR DRAWING	7/25/2012
71		ISSUE FOR DRAWING	7/25/2012