

ITEM NO.	PART NUMBER	DESCRIPTION	SP98-8M/QTY.
1	68542-Die Hat	Die Hat	1
2	68001 - HAT SHANK	Hat Shank	1
3	68543-Tool Holder	Tool Holder	1
4	68039-Cam	Cam - 7-8mm	1
5	68752-Roll Tool	Roll Tool	1
6	62127-Front Driver	Front Driver (8MM)	1
7	68544-Die Base	Die Base	1
8	68545-Die Holder	Die Holder	1
9	68012 - SPRING	Spring	1
10	68034 - SPACER	Spacer	1
11	68547-Anvil	Anvil	1
12	68548-Carrier Cut Off	Carrier Cut Off	1
13	68546-Die Cover	Die Cover	1
14	68440-Stripper Mount	Stripper Mount	1
15	68441-Stripper Rod	Stripper Rod	1
16	68549-Feed Plate	Feed Plate	1
17	68550-Front Guide	Front Guide	1
18	62864-Rear Stock Guide	Rear Stock Guide	1
19	62865-Guide Spacer	Guide Spacer	1
20	68747-Rear Guide Extension	Rear Guide Extension	1
21	68053-Brake Mount	Brake Mount	1
22	68499-Brake	Brake	1
23	68020 - BRAKE SPRING	Spring	1
24	68055-Slide Bracket	Slide Bracket	2
25	68056-Slide Block	Slide Block	1
26	68028 - SLIDE SHAFT	Slide Shaft	2
27	68031 - SPRING	Spring	1
28	68029 - SLIDE END CAP	Slide End Cap	2
29	68551-Feed Finger Shaft	Feed Finger Shaft	1
30	68022 - BEARING	Bearing	1
31	62869-Feed Finger Spacer	Feed Finger Spacer	1
32	68024 - FEED FINGER	Feed Finger	1
33	68025 - SPRING CLIP	Spring Clip	1
34	68026 - FEED FINGER SPRING	Feed Finger Spring	1
35	Default	68090-Cotter Pin - 1/6" x 1"	1
36	62867-Chute Spacer	Chute Spacer	1
37	68064-Chute	Chute	1
38	68743-Guard	Guard	1
39	10-32_50bh	#10-32 x 1/2" Button Hd Cap Screw	2
40	3-8-16_1.00ss	3/8-16 x 2" Socket Hd. Set Screw	1
41	3-8-16_1.00sh	3/8-16 x 1" Socket Hd Cap Screw	1
42	1.4-20_50sh	1/4-20 x 1/2" Socket Hd Cap Screw	6
43	1.4-20_50lsh	Low Hd. Socket Cap Screw	2
44	1.4-20_75sh	1/4-20 x 3/4" Socket Hd Cap Screw	2
45	1.4-20_1.00sh	1/4-20 x 1" Socket Hd Cap Screw	6
46	1.4-20_1.75 sh	1/4-20 x 1 3/4" Socket Hd Cap Screw	2
47	8-32_31fhs	#8-32 x 5/16" Flat Hd Screw - Phillips	4
48	10-24_75sh	#10-24 x 3/4" Socket Hd Cap Screw	1
49	10-32_25bh	#10-32 x 1/4" Button Hd Cap Screw	1
50	10-32_38sh	#10-32 x 3/8" Socket Hd Cap Screw	3
51	10-32_44sh	#10-32 x 7/16" Socket Hd Cap Screw	5
52	10-32_50ss	#10-32 x 1/2" Socket Hd Set Screw	1
53	10-32_75sh	#10-32 x 3/4" Socket Hd Cap Screw	1
54	10-32_88sh	#10-32 x 7/8" Socket Hd Cap Screw	2
55	10-32_1.00sh	#10-32 x 1" Socket Hd Cap Screw	2
56	3.16_1.5dp	3/16 x 1 1/2" Dowel Pin	4

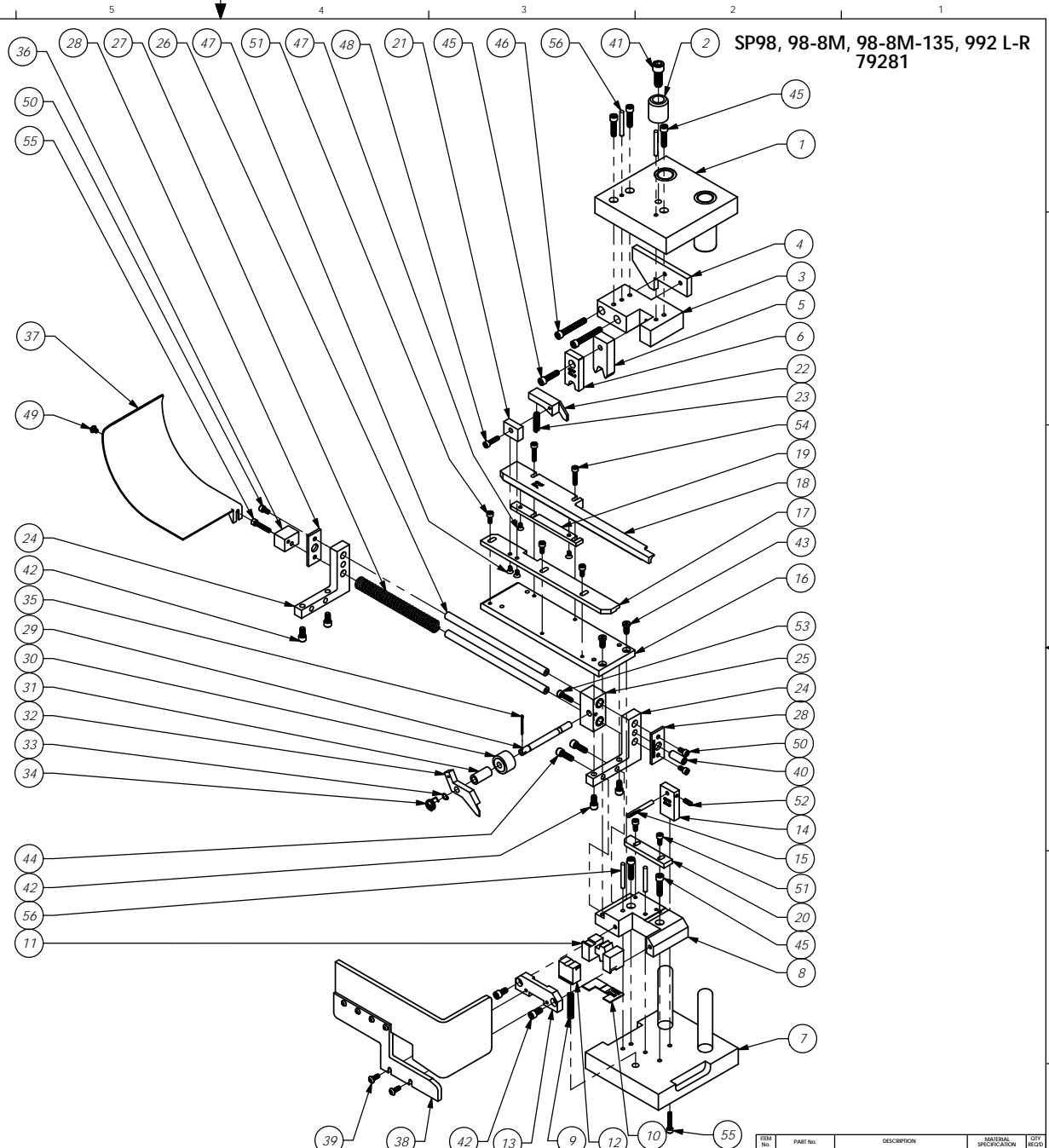

SP98, 98-8M, 98-8M-135, 992 L-R 79281

ITEM NO.	PART No.	DESCRIPTION	MATERIAL SPECIFICATION	QTY REQD																									
<table border="1"> <tr> <td colspan="2">DO NOT SCALE DRAWING</td> <td colspan="3">UNLESS OTHERWISE SPECIFIED DIMENSIONS ARE IN INCHES TOLERANCES ARE:</td> </tr> <tr> <td>FRACTIONS</td> <td>DECIMALS</td> <td>ANGLES</td> <td colspan="2"></td> </tr> <tr> <td>±1/64"</td> <td>XX ±0.1</td> <td>XX ±0.1</td> <td>XXX ±0.01</td> <td>±1/2°</td> </tr> <tr> <td colspan="5">SURFACE FINISH: <input checked="" type="checkbox"/> ALL OVER</td> </tr> <tr> <td colspan="5">THE INFORMATION CONTAINED HEREIN IS THE PROPERTY OF ETICO ENGINEERED PRODUCTS. IT IS TO BE USED ONLY FOR THE PART OR PARTS IDENTIFIED HEREIN. REPRODUCTION OR USE OF ANY PART OF THIS DOCUMENT IS PROHIBITED.</td> </tr> </table>					DO NOT SCALE DRAWING		UNLESS OTHERWISE SPECIFIED DIMENSIONS ARE IN INCHES TOLERANCES ARE:			FRACTIONS	DECIMALS	ANGLES			±1/64"	XX ±0.1	XX ±0.1	XXX ±0.01	±1/2°	SURFACE FINISH: <input checked="" type="checkbox"/> ALL OVER					THE INFORMATION CONTAINED HEREIN IS THE PROPERTY OF ETICO ENGINEERED PRODUCTS. IT IS TO BE USED ONLY FOR THE PART OR PARTS IDENTIFIED HEREIN. REPRODUCTION OR USE OF ANY PART OF THIS DOCUMENT IS PROHIBITED.				
DO NOT SCALE DRAWING		UNLESS OTHERWISE SPECIFIED DIMENSIONS ARE IN INCHES TOLERANCES ARE:																											
FRACTIONS	DECIMALS	ANGLES																											
±1/64"	XX ±0.1	XX ±0.1	XXX ±0.01	±1/2°																									
SURFACE FINISH: <input checked="" type="checkbox"/> ALL OVER																													
THE INFORMATION CONTAINED HEREIN IS THE PROPERTY OF ETICO ENGINEERED PRODUCTS. IT IS TO BE USED ONLY FOR THE PART OR PARTS IDENTIFIED HEREIN. REPRODUCTION OR USE OF ANY PART OF THIS DOCUMENT IS PROHIBITED.																													
See Parts List		<b>ETICO ENGINEERED PRODUCTS</b> 25 BELLOWS STREET WARRWICK RI 02888 (401)-467-2400																											
SP98-8M "8mm" L-R Applicator		REVISION: <b>F</b> REVISION: <b>Re-ass'y from AP 7022 Rev E</b> BY/DATE: <b>1/2012</b> SCALE: <b>1:4</b> DRAWN BY: <b>SCJ</b> DATE: <b>1/27/12</b>																											