

Parts List				
Item No.	Part Code	Part No.	Description	QTY.
1	63545	8A-6045	Front Cut-off Pad Retainer	1
2	63547	9-6045	Anvil	1
3	63546	12A-6045	Cut-off Pad	1
4	63548	13-6045	Rolling Tool	1
5	63550	15-6045	Cut-Off Pad Driver	1
6	61626	26-6000	Guard Bracket	1
7	63583	199-6045	Safety Guard	1
8	63554	250-6045	Feed Plate	1
9	64124	1000-6044-SP11-135	Rear Guide	1
10	64120	64120	Rear Guide Shim	1
11	64127	64127	Feed Arm	1
12	64141	64141	Feed Finger	1
13	64153	64153	Stock Chute	1
14	64154	64154	Stripper	1
15	64155	64155	Frame	1
16	61543	MM2-S	Base Plate	1
17	61545	MM3-S	Plunger	1
18	61762	MM6-S-1	Front Guide	1
19	61549	MM7-S	Brake	1
20	61550	MM8-S	Brake Lever	1
21	61551	MM9-S	Adjustment Screw Retainer	1
22	61552	MM10-S	Adjustment Screw	1
23	61553	MM11-S	Brake Spring	2
24	61554	MM12	Adjustable Feed Piston	1
25	61555	MM13	Cam Roller	1
26	61556	MM14	Piston Spring	1
27	61557	MM15	Spring Plate	1
28	61558	MM16	Feed Adjustment Block	1
29	61559	MM17	Feed Adjustment Screw	1
30	61560	MM18	Retainer	1
31	61561	MM19	Guide Block	1
32	61562	MM20	Feed Washer	1
33	61563	MM21	Feed Finger Spring	1
34	61564	MM22	Feed Finger Shaft	1
35	61566	MM24	Feed Finger Retainer	1
36	61573	MM31	Post-feed Cam	1
37	61574	MM32	Pre-Feed Cam	1
38	61581	MM37-S	Tool Block	1
39	63575	MM38-S-2	Backup Block	1
40	61583	MM39	Gib	2
41	61585	MM43	Counter Ass'y.	1
42	61586	MM44	Locator Pin	1
43	61588	MM47	Dog Screw	1
44	61590	MM48	IRT Adjustment Block	1
45	61595	MM56	Retaining Ring	1
46	61598	MM59	ID Plate	1
47	61596	MM57	Continuous Regulation Head Assembly	1
48	61597	MM58	Protection Spacer	1
49	60601	LC-032C-8	Spring	1
50	72069	McMaster Carr #98407A122	#10 E-Style Retaining Ring	2
51		M3x0.5_5.0sh	M3 x 5mm Socket Hd Cap Screw	2
52		M3x0.5_16.0sh	M3 x 0.5 x 16mm Socket Hd Cap Screw	1
53		M4x.7_8.0bh	M4 x .7 x 8mm Button Hd Cap Screw	1
54		M4x.7_14.0bh	M4 x .7 x 14mm Button Hd Cap Screw	2
55		M4x0.7_8.0sh	M4 x .7 x 8.0 Socket Hd Cap Screw	1
56		M4x0.7_12.0sh	M4 x 12mm Socket Hd Cap Screw	2
57		M5_18.0dp	M5 x 18mm Dowel Pin	1
58		M5_M3.9err	M5 External Retaining Ring	2
59	63521	M5x.8_10.0sh	M5 x .8 x 10mm Socket Hd Cap Screw	1
60		M5x.8_16.0sh	M5 x .8 x 16mm Socket Hd Cap Screw	5
61		M5x.8_12.0sh	M5 x .8 x 12mm Socket Hd Cap Screw	3
62		M5x.8_25.0sh	M5 x .08 x 25mm Socket Hd Cap Screw	3
63		M6x1.0_12.0bh	M6 x 1.0 x 12mm Button Hd Cap Screw	1
64		M6x1.0_16.0bh	M6 x 1.0 x 16mm Button Hd Cap Screw	2
65		M6_18dp	M6 x 18mm Dowel Pin	1
66		M6_20dp	M6 x 20mm Dowel Pin	2
67		M6_in	M6 Lock Nut	1
68		M6x1.0_40.0sh	M6 x 1.0 x 40mm Socket Hd Cap Screw	1
69		M6_10shss	M6 x 10mm Socket Hd Shoulder Screw	2
70	62092	M8 x1.25_35.0bh	M8 x 1.25 x 35mm Button Hd Cap Screw	1
71		M8_in	M8 Lock Nut	2

Note:
 1) Items marked in "Bold Italic" are high wear tooling.
 2) Use OEM replacement tooling only.

SP11-135 L-R
79395

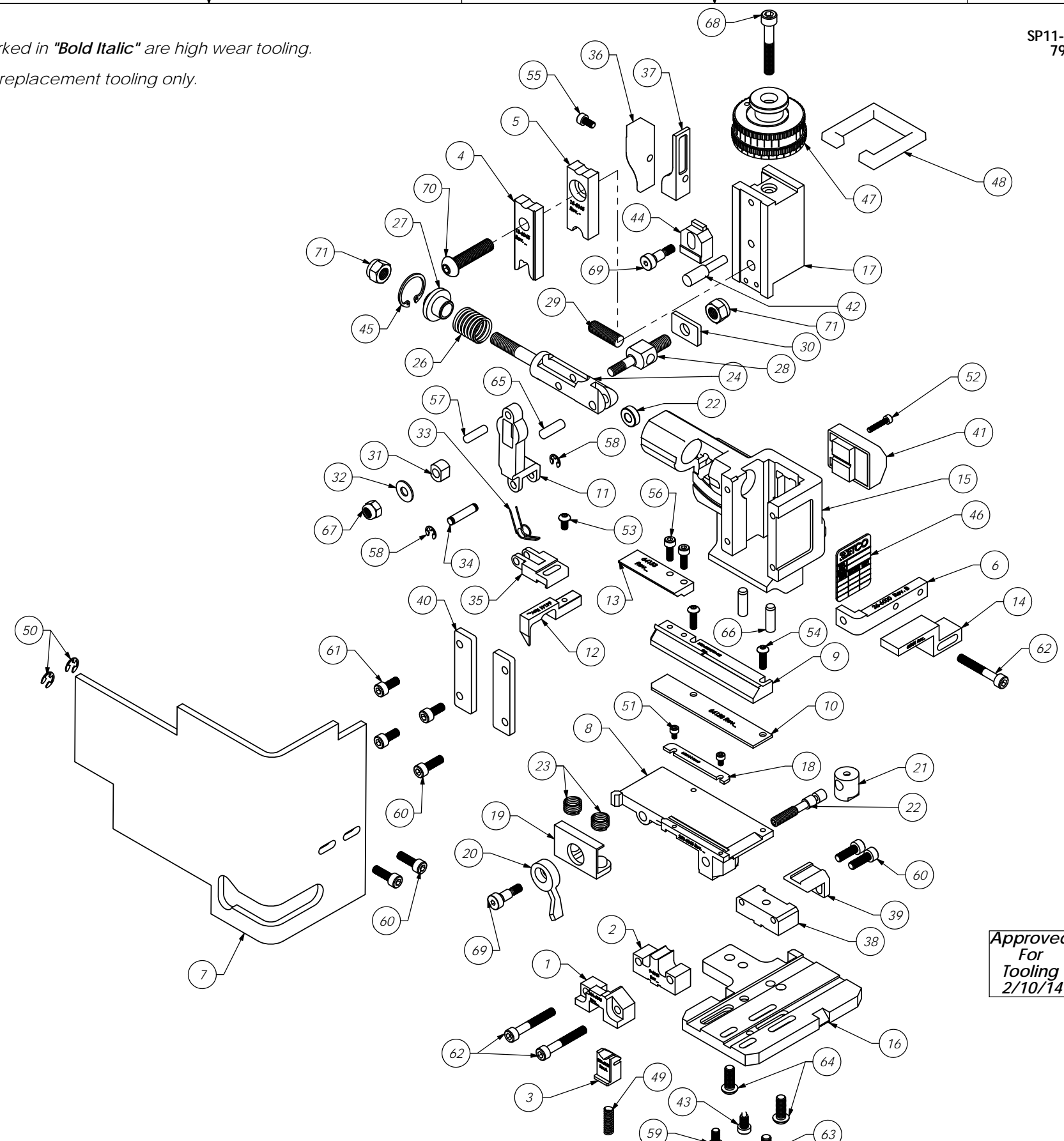

Approved For Tooling 2/10/14

ITEM NO.	PART NO.	DESCRIPTION	MATERIAL SPECIFICATION	QTY.
See Parts List				
SURFACE FINISH: <input checked="" type="checkbox"/> ALL OVER UNLESS OTHERWISE SPECIFIED DIMENSIONS ARE IN INCHES. TOLERANCES ARE: FRACTIONS DECIMALS ANGLES ±1/64 ±.01 ±1° XX ±.001 XXX ±.0005				
1		SP11-135	HEAT TREAT	
QTY.		USED ON	FINISH	
LVL		REVISION	BY/DATE	APPLICATION
		SCALE: 1:1	CAD FILE:	CHECKED BY: DATE: DRAWN BY: DATE: 2/10/14