

PN187-C (Edge MF)
79417

ITEM NO.	QTY.	Part_code	PART NUMBER	DESCRIPTION
1	1	100003	8-8000	Die Spacer
2	1	74440	8-3003	Front Cut-off Pad Retainer
3	1	100002	9-8000	Anvil
4	1	74441	12-3003	Cut-off Pad
5	1	100004	13-8000	Wire Rolling Tool
6	1	100022	15-8003	Cut-off Pad Driver
7	1	77265	26-3088	Locking Screw
8	1	74802	26-3000	Backup Block
9	1	100554	35-8000	No Insulation Dial
10	1	76403	199-3005	Safety Guard
11	1	100008	200-8000	Baseplate
12	1	100005	250-8000	Feed Plate
13	1	100006	500-8000	Rear Guide Rail
14	1	100007	1000-8000	Front Guide Rail
15	1	76464	1600A-3001	Adjustable Stripper
16	1	74803	1600B-3000	Adjustable Stripper Holder
17	1	63660	ED2-M	Frame
18	1	63658	ED3	Plunger
19	1	63709	ED4	Retainer
20	1	63731	ED5	Feed Adjustment Guide Block
21	1	63714	ED6	Spring Retainer
22	1	63733	ED7	Cam Roll Pin
23	1	63706	ED8	Cam Roller
24	1	63704	ED9	Feed Adjustment Block
25	1	64245	ED10	Feed Arm Pin
26	2	63717	ED11	Gib
27	1	63701	ED12	Feed Finger Shaft
28	1	63705	ED13	Adjustable Feed Piston
29	1	63700	ED14	Feed Arm
30	1	63702	ED16	Feed Finger Retainer
31	1	63703	ED17-S	Feed Finger
32	1	63659	ED44	Locating Dowel
33	1	63732	ED45	Feed Finger Spring
34	1	63715	ED51	Post-feed Cam
35	1	63716	ED52	Pre-Feed Cam
36	2	74491	GS-375	Guard Spacer
37	1	74384	MX29-S	Slide Support
38	1	74388	MX30-S	Support Anchor
39	1	74390	MX32-S	Support Cover
40	1	74407	MX33	Mounting Post
41	1	100023	MX34-8000	Wire Crimp Dial
42	1	74411	MX36	Dial Spacer
43	1	74425	MX84-S	Brake Cam
44	1	74426	MX85-S	Cam Pivot Pin
45	1	74428	MX86-S	Brake Shoe
46	1	100016	MX87-8000	Lift Arm
47	1	74430	MX88-S	Lever
48	1	72310	MX104	Wave Disc Spring
49	1	74578	4-034-875	Spring
50	2	77322	LC-045E-10-M	Spring
51	1	70739	McMaster-Carr #3126A53	Spring Plunger
52	1	64213	McMaster Carr #98370A28	1/4" Hardened Flatwasher
53	1	72519	McMaster Carr #98029A043	#8 Hardened Washer
54	2	72069	McMaster Carr #98407A118	#8 E-Style Retaining Ring
55	2	64214	McMaster Carr #98407A122	#10 E-Style Retaining Ring
56	1	63734	McMaster Carr #98455A_122	Retaining Ring
57	1	63735	MS24585-1453	Piston Spring
58	2	73785	SPI 99-602-5	#10 Black Knurled Knob
59	1	62040	1.8_1.00rp	1/8" x 1" Roll Pin
60	2	63792	6-32_.25bh	#6-32 x 1/4" Button Hd Cap Screw
61	6	63207	6-32_.25sh	#6-32 x 1/4" Socket Hd Cap Screw
62	1	60265	8-32_.19sh	#8-32 x 3/16" Socket Hd Cap Screw
63	2	63163	8-32_.25sh	#8-32 x 1/4" Socket Hd Cap Screw
64	1	77097	8-32_.31bh	#8-32 x 5/16" Button Hd Cap Screw
65	1	100091	8-32_.31sh	#8-32 x 5/16" Socket Hd Cap Screw
66	9	61472	8-32_.38bh	#8-32 x 3/8" Button Hd Cap Screw
67	1	63753	10fw	#10 Flatwasher
68	1	63054	10-32_.25ss	#10-32 x 1/4" Socket Hd Set Screw
69	1	78993	10-32_.38bh	#10-32 x 3/8" Button Hd Cap Screw
70	6	76501	10-32_.50bh	#10-32 x 1/2" Button Hd Cap Screw
71	2	63056	10-32_.50sh	#10-32 x 1/2" Socket Hd Cap Screw
72	2	64215	10-32_.69sh	#10-32 x 11/16" Socket Hd Cap Screw
73	1	77396	10-32_1.25sh	#10-32 x 1 1/4" Socket Hd Cap Screw
74	2	63826	10-32_1.50sh	#10-32 x 1 1/2" Socket Hd Cap Screw
75	2	63632	1.4-20_.50bh	1/4-20 x 1/2" Button Hd Cap Screw
76	2	64215	1.4_.75dp	1/4" x 3/4" Dowel Pin
77	1	63707	1.4_20 LN	1/4-20 Lock Nut
78	1	63055	5.16-18_1.00bh	5/16-18 x 1" Button Hd Cap Screw
79	2	63708	5.16-18 LN	5/16-18 Lock Nut
80	1	64216	5.16-24_1.00ssf	5/16-24 x 1" Socket Hd Set Screw

Note:

- 1) Items marked in "Bold Italic" are high wear tooling.
- 2) Use of Non-OEM Tooling may void UL ratings where applicable.

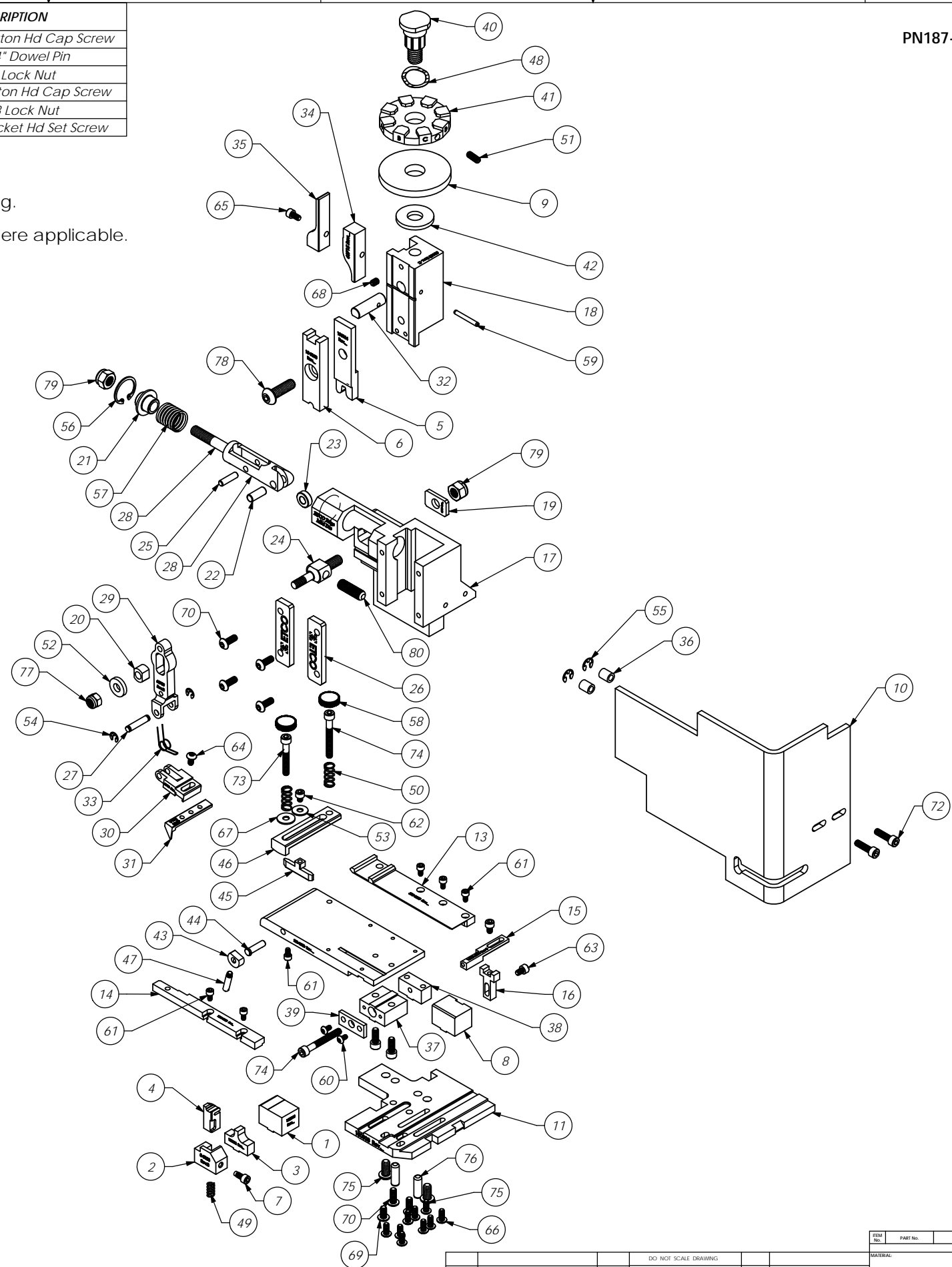

REV	REV	DESCRIPTION	MATERIAL SPECIFICATION	OFF RECD
A	ECR# 5199	SCJ	7/25/08	
LVL	REVISION	BY/DATE	SCALE	APPLICATION
			1:8	

PARTS LIST		MATERIAL SPECIFICATION	
DO NOT SCALE DRAWING	UNLESS OTHERWISE SPECIFIED DIMENSIONS ARE IN INCHES. TOLERANCES ARE:	FRACTIONS	DECIMALS
		1/16" ±.015	±.015"
		1/32" ±.010	±.010"
		1/64" ±.005	±.005"
SURFACE FINISH: ALL OVER		FINISH: USED ON	
DATE: 7/25/08		CHECKED BY: DATE: 27Oct14	
DRAWN BY: ECR		DESIGNED BY: CSJ	

PARTS LIST		MATERIAL SPECIFICATION	
ETECO ENGINEERED PRODUCTS 25 BELLOWS STREET WARWICK, RI 02888 (401) 467-2400			
PN187-C			
DATE: 7/25/08		REV: A	
DRAWN BY: ECR		DESIGNED BY: CSJ	