

| ITEM NO. | QTY. | Part_Code | PART NUMBER               | DESCRIPTION                         | ITEM NO. | QTY. | Part_Code | PART NUMBER     | DESCRIPTION                         |
|----------|------|-----------|---------------------------|-------------------------------------|----------|------|-----------|-----------------|-------------------------------------|
| 1        | 1    | 64260     | 8-SPB-M-1                 | Die                                 | 64       | 1    | 63826     | 10-32_1.50sh    | #10-32 x 1 1/2" Socket Hd Cap Screw |
| 2        | 1    | 60224     | 8S-CSM977                 | Die Holder (Single)                 | 65       | 1    | 62040     | 1.8_1.00rp      | 1/8" x 1" Roll Pin                  |
| 3        | 1    | 64265     | 9-SPB-M-1                 | Anvil                               | 66       | 2    | 63632     | 1.4-20_.50bh    | 1/4-20 x 1/2" Button Hd Cap Screw   |
| 4        | 1    | 64259     | 12-SPB-M-1                | Cut-off Punch                       | 67       | 1    | 63707     | 1.4_20 LN       | 1/4-20 Lock Nut                     |
| 5        | 1    | 64258     | 13-SPB-M-1                | Wire Rolling Tool                   | 68       | 2    | 64215     | 1.4_.75dp       | 1/4" x 3/4" Dowel Pin               |
| 6        | 1    | 100554    | 35-8000                   | No Insulation Dial                  | 69       | 1    | 63055     | 5.16-18_1.00bh  | 5/16-18 x 1" Button Hd Cap Screw    |
| 7        | 1    | 64266     | 199-B817F12               | Safety Guard                        | 70       | 2    | 63708     | 5.16-18 LN      | 5/16-18 Lock Nut                    |
| 8        | 1    | 64262     | 200-8001                  | Baseplate                           | 71       | 1    | 64216     | 5.16-24_1.00ssf | 5/16-24 x 1" Socket Hd Set Screw    |
| 9        | 1    | 100025    | 250-8001                  | Feed Plate                          | 72       | 1    | 63155     | 10-32_1.00sh    | #10-32 x 1" Socket Hd Cap Screw     |
| 10       | 1    | 100026    | 250A-8001                 | Feed Plate Spacer                   |          |      |           |                 |                                     |
| 11       | 1    | 64261     | 303-8001                  | Feed Finger                         |          |      |           |                 |                                     |
| 12       | 1    | 100029    | 403-8001                  | Brake Shoe                          |          |      |           |                 |                                     |
| 13       | 1    | 100028    | 500-8001                  | Rear Guide Rail                     |          |      |           |                 |                                     |
| 14       | 1    | 63711     | 1600-8000                 | Stripper                            |          |      |           |                 |                                     |
| 15       | 1    | 70380     | DPH-CSM977                | Die Plate Holder                    |          |      |           |                 |                                     |
| 16       | 1    | 63660     | ED2-M                     | Frame                               |          |      |           |                 |                                     |
| 17       | 1    | 63658     | ED3                       | Plunger                             |          |      |           |                 |                                     |
| 18       | 1    | 63709     | ED4                       | Retainer                            |          |      |           |                 |                                     |
| 19       | 1    | 63731     | ED5                       | Feed Adjustment Guide Block         |          |      |           |                 |                                     |
| 20       | 1    | 63714     | ED6                       | Spring Retainer                     |          |      |           |                 |                                     |
| 21       | 1    | 63733     | ED7                       | Cam Roll Pin                        |          |      |           |                 |                                     |
| 22       | 1    | 63706     | ED8                       | Cam Roller                          |          |      |           |                 |                                     |
| 23       | 1    | 63704     | ED9                       | Feed Adjustment Block               |          |      |           |                 |                                     |
| 24       | 1    | 64245     | ED10                      | Feed Arm Pin                        |          |      |           |                 |                                     |
| 25       | 2    | 63717     | ED11                      | Gib                                 |          |      |           |                 |                                     |
| 26       | 1    | 63701     | ED12                      | Feed Finger Shaft                   |          |      |           |                 |                                     |
| 27       | 1    | 63705     | ED13                      | Adjustable Feed Piston              |          |      |           |                 |                                     |
| 28       | 1    | 63700     | ED14                      | Feed Arm                            |          |      |           |                 |                                     |
| 29       | 1    | 63702     | ED16                      | Feed Finger Retainer                |          |      |           |                 |                                     |
| 30       | 1    | 63659     | ED44                      | Locating Dowel                      |          |      |           |                 |                                     |
| 31       | 1    | 63732     | ED45                      | Feed Finger Spring                  |          |      |           |                 |                                     |
| 32       | 1    | 100024    | ED50-S-1                  | Stripper Spacer                     |          |      |           |                 |                                     |
| 33       | 2    | 74491     | GS-375                    | Guard Spacer                        |          |      |           |                 |                                     |
| 34       | 1    | 74840     | MX28-1-S                  | Front Guide Rail                    |          |      |           |                 |                                     |
| 35       | 1    | 74407     | MX33                      | Mounting Post                       |          |      |           |                 |                                     |
| 36       | 1    | 100027    | MX34-8001                 | Wire Crimp Dial                     |          |      |           |                 |                                     |
| 37       | 1    | 74411     | MX36                      | Dial Spacer                         |          |      |           |                 |                                     |
| 38       | 1    | 74425     | MX84-S                    | Brake Cam                           |          |      |           |                 |                                     |
| 39       | 1    | 74426     | MX85-S                    | Cam Pivot Pin                       |          |      |           |                 |                                     |
| 40       | 1    | 75915     | MX87-1-S                  | Lift Arm                            |          |      |           |                 |                                     |
| 41       | 1    | 74430     | MX88-S                    | Lever                               |          |      |           |                 |                                     |
| 42       | 1    | 72310     | MX104                     | Wave Disc Spring                    |          |      |           |                 |                                     |
| 43       | 2    | 77322     | LC-045E-10-M              | Spring                              |          |      |           |                 |                                     |
| 44       | 1    | 70739     | McMaster-Carr #3126A53    | Spring Plunger                      |          |      |           |                 |                                     |
| 45       | 2    | 72519     | McMaster Carr #98029A043  | #8 Hardened Washer                  |          |      |           |                 |                                     |
| 46       | 1    | 64213     | McMaster Carr #98370A28   | 1/4" Hardened Flatwasher            |          |      |           |                 |                                     |
| 47       | 2    | 72069     | McMaster Carr #98407A118  | #8 E-Style Retaining Ring           |          |      |           |                 |                                     |
| 48       | 2    | 64214     | McMaster Carr #98407A122  | #10 E-Style Retaining Ring          |          |      |           |                 |                                     |
| 49       | 1    | 63734     | McMaster Carr #98455A_122 | Retaining Ring                      |          |      |           |                 |                                     |
| 50       | 1    | 63735     | MS24585-1453              | Piston Spring                       |          |      |           |                 |                                     |
| 51       | 2    | 73785     | SPI 99-602-5              | #10 Black Knurled Knob              |          |      |           |                 |                                     |
| 52       | 6    | 63207     | 6-32_.25sh                | #6-32 x 1/4" Socket Hd Cap Screw    |          |      |           |                 |                                     |
| 53       | 1    | 63163     | 8-32_.25sh                | #8-32 x 1/4" Socket Hd Cap Screw    |          |      |           |                 |                                     |
| 54       | 1    | 77097     | 8-32_.31bh                | #8-32 x 5/16" Button Hd Cap Screw   |          |      |           |                 |                                     |
| 55       | 2    | 63161     | 8-32_.38sh                | #8-32 x 3/8" Socket Hd Cap Screw    |          |      |           |                 |                                     |
| 56       | 2    | 78993     | 10-32_.38bh               | #10-32 x 3/8" Button Hd Cap Screw   |          |      |           |                 |                                     |
| 57       | 2    | 63056     | 10-32_.50sh               | #10-32 x 1/2" Socket Hd Cap Screw   |          |      |           |                 |                                     |
| 58       | 2    | 61472     | 8-32_.38bh                | #8-32 x 3/8" Button Hd Cap Screw    |          |      |           |                 |                                     |
| 59       | 2    | 72096     | 8-32_1.25sh               | #8-32 x 1 1/4" Socket Hd Cap Screw  |          |      |           |                 |                                     |
| 60       | 1    | 63054     | 10-32_.25ss               | #10-32 x 1/4" Socket Hd Set Screw   |          |      |           |                 |                                     |
| 61       | 4    | 76501     | 10-32_.50bh               | #10-32 x 1/2" Button Hd Cap Screw   |          |      |           |                 |                                     |
| 62       | 2    | 64215     | 10-32_.69sh               | #10-32 x 11/16" Socket Hd Cap Screw |          |      |           |                 |                                     |
| 63       | 1    | 77396     | 10-32_1.25sh              | #10-32 x 1 1/4" Socket Hd Cap Screw |          |      |           |                 |                                     |

Note:  
 1) Items marked in "Bold Italic" = High wear tooling.  
 2) Use OEM replacement tooling only.

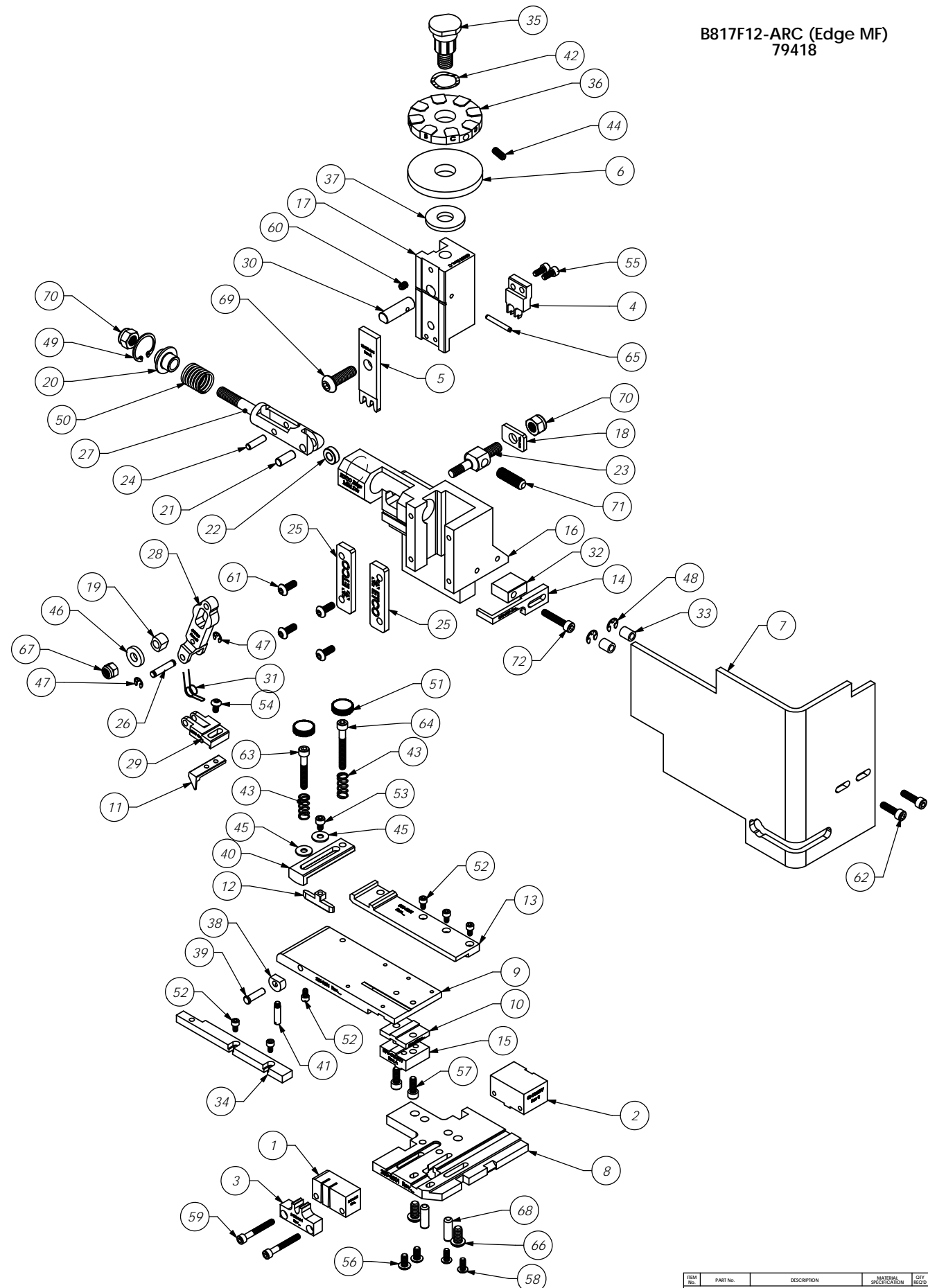

B817F12-ARC (Edge MF)  
79418

| REV | DATE | BY/DAE        | APP     | DESCRIPTION | SCALE | DATE | BY/DAE | APP | DESCRIPTION |
|-----|------|---------------|---------|-------------|-------|------|--------|-----|-------------|
| A   |      | ECR# 5199 SCJ | 7/25/08 |             | 1:8   |      |        |     |             |

| PART LIST |             | MATERIAL SPECIFICATION |     | OFF REC'D |
|-----------|-------------|------------------------|-----|-----------|
| QTY       | DESCRIPTION | MATERIAL               | QTY | REC'D     |
|           |             |                        |     |           |

|                      |  |   |  |
|----------------------|--|---|--|
| DO NOT SCALE DRAWING |  | UNLESS OTHERWISE SPECIFIED DIMENSIONS ARE IN INCHES TOLERANCES ARE FRACTIONS DECIMALS ANGLES                              |  |
|                      |  | 1/16" .005" .015" .030" .060" .125" .250" .500" 1.000" .001" .002" .005" .010" .015" .030" .060" .125" .250" .500" 1.000" |  |
| SURFACE FINISH       |  | ALL OVER  |  |
|                      |  |   |  |

|                                  |  |  |  |
|----------------------------------|--|--|--|
| MATERIAL: See Parts List         |  | ETICO ENGINEERED PRODUCTS<br>25 BELLOWS STREET<br>WARWICK, RI 02888 (401)-467-2400 |  |
| PART NAME: B817F12-ARC (Edge MF) |  | REV: 1   |  |
| DRAWN BY: CSJ                    |  | DATE: 30Nov12  |  |