

Parts List				
Item	Part Code	QTY.	Part No./File Name	Description
1	70753	1	9A-4007	Insulation Anvil
2	70752	1	9-4007	Wire Anvil
3	70749	1	14-4007	Insulation Rolling Tool
4	70748	1	13-4007	Wire Rolling Tool
5	73888	2	GS-125	Guard Spacer
6	71494	1	MX2A-S-1	Mounting Frame
7	71030	1	MX2B-S	Plunger Frame
8	74343	1	MX3	Ram
9	74438	1	MX5-S	Cam Rack
10	74346	1	MX6-1	Gear Arm
11	74347	1	MX7	Cam Pin
12	74350	1	MX8	Cam Roller
13	74351	2	MX10-S	Rack Pad
14	74352	2	MX11	Gib
15	74356	1	MX12	Feed Finger Pivot Pin
16	74360	1	MX13	Adjusting Bar
17	76868	1	MX14-1-S	Feed Finger Arm
18	76874	1	MX15-1-S	Feed Finger Guide
19	74364	1	MX16	Retainer
20	71495	1	MX18-S-1	Swing Arm
21	74376	1	MX25	Stroke Adjustment Screw
22	74407	1	MX33	Mounting Post
23	72103	1	MX34-F	Wire Crimp Dial
24	74409	1	MX35	Insulation Dial
25	74411	1	MX36	Dial Spacer
26	74412	1	MX44	Locating Dowel
27	74415	1	MX45-S	Feed Finger Spring
28	74419	3	MX50	Safety Pivot Pin
29	71493	2	MX52-S-1	Pivot Pin
30	74614	1	MX90-S	Spring Bracket
31	72310	1	MX104	Wave Disc Spring
32	71678	1	MX105-S	Pivot Pin Plate
33	72167	1	MX301-7-ITD-S	Latching Gate
34	72261	1	MX302-1-ITD-S	Base Plate
35	76563	2	MX304-ITD-S	Hinge Pin
36	76564	2	MX305-ITD-S	Pin
37	76567	1	MX308-ITD-S	Latch Pivot Pin
<b>38</b>	<b>78936</b>	<b>1</b>	<b>MX309-4-ITD-S</b>	<b>Cut-off Keeper</b>
39	76573	1	MX314-ITD-S	Catch
40	76574	1	MX315-ITD-S	Insulation Tool Spacer
41	76575	2	MX316-ITD-S	Latch Spring
42	76576	1	MX317-ITD-S	Base Plate Spacer
43	76578	1	MX319-ITD-S	Knock off
44	76579	1	MX320-ITD-S	Brake
45	76580	1	MX321-ITD-S	Brake Actuator
46	71070	1	MX324-1-ITD-S	Cut-off Pad Pusher
47	72937	1	MX327-1-ITD-S	Left Feed Rail
48	76587	1	MX328-ITD-S	Hold Down Spring
49	76588	1	MX329-ITD-S	Right Feed Rail
50	76590	1	MX331-ITD-S	Latch (Automatic)
51	76608	1	MX335-ITD-S	Cam
52	71078	1	MX337-1-ITD-S	Feed Finger
53	70720	1	MX338-ITD-S	Arm Switch Cam (1 5/8" Stroke)
54	72233	1	MX338-1-ITD-S	Arm Switch Cam (1 1/8" Stroke)
55	70745	1	MX339-ITD-S	Guard
56	78325	1	MX340-4-ITD-S	Cut-off Pad
57	70765	1	MX341-ITD-S	Die Holder
58	70766	1	MX342-ITD-S	Feed Plate
59	70767	1	MX343-ITD-S	Support
60	72342	1	MX344-2-ITD-S	Leaf Spring
61	72340	1	MX345-1-ITD-S	Insulation Pusher
62	72099	1	MX348-ITD-S	.550 Strike Slide Cylinder
63	72100	1	MX349-ITD-S	Stock Chute
64	72101	1	MX350-ITD-S	Feed Finger Retainer
65	72102	1	MX351-ITD-S	Support Spacer
66	72172	1	MX352-ITD-S	Latch/Wire Stop
67	72893	1	MX357-ITD-S	Bracket
68	78733	1	MX358-1-ITD-S	Valve Mounting Plate

Parts List				
Item	Part Code	QTY.	Part No./File Name	Description
69	61993	1	MX358-2-ITD-S	Valve Mounting Plate
70	78835	1	MX360-ITD-S	Scrap Retainer
71	72350	1	5-047x1.000	Compression Spring
72	72317	1	Clippard #12296	Cam Follower
73	72318	1	Clippard MJV-3	3-Way Valve
74	75083	2	Irving 3100-18	External Retaining Ring
75	72315	1	LC-022A-4	Compression Spring
76	78681	2	LC-029B-3-M	Compression Spring
77	74611	1	LE-037CD-6	Extension Spring
78	70739	2	McMaster-Carr #3126A53	Spring Plunger
79	74447	1	McMaster-Carr #98296A109	Expansion Pin (1/16 x 1/2")
80	73222	1	Pisco PC250-N1U	1/4" x 1/8" NPT Straight
81	72352	3	Pisco PL250-N1U	Ø1/4" x 1/8"-NPT Elbow Fitting, White
82	63200	2	Truarc #5555-12	Retaining Ring
83	63201	2	Vlier #PH-51-P	Spring Plunger
84	63202	2	4lw	#4 Lock Washer
85	63203	2	4-40_.13bh	#4-40 x 1/8" Button Hd Cap Screw
86	63204	2	4-40_.16sh	#4-40 x 5/32" Socket Hd Cap Screw
87	63205	1	1.8_.38rp	Ø 1/8" x 3/8" Roll Pin
88	63053	2	1.8_.63rp	1/8" x 5/8" Roll Pin
89	62040	1	1.8_1.00rp	1/8" x 1" Roll Pin
90	63206	2	5-40_.19ssf	#5-40 x 3/16" Socket Set Screw
91	63207	6	6-32_.25sh	#6-32 x 1/4" Socket Hd Cap Screw
92	63209	4	6-32_.38sh	#6-32 x 3/8" Socket Hd Cap Screw
93	63057	2	6-32_.50fh	#6-32 x 1/2" Flat Hd Cap Screw
94	63210	2	8fw	#8 Flatwasher
95	63211	2	8-32_.13ssf	#8-32 x 1/8" Socket Hd Set Screw
96	63212	1	8-32_.25bh	#8-32 x 1/4" Button Hd Cap Screw
97	63052	2	8-32_.50fh	#8-32 x 1/2" Flat Hd Cap Screw
98	63164	2	8-32_.50sh	#8-32 x 1/2" Socket Hd Cap Screw
99	63162	2	8-32_.63sh	#8-32 x 5/8" Socket Hd Cap Screw
100	63213	1	8-32_1.00sh	#8-32 x 1" Socket Hd Cap Screw
101	63158	4	3.16_.50dp	Ø 3/16" x 1/2" Dowel Pin
102	63470	12	3.16_.75dp	Ø 3/16" x 3/4" Dowel Pin
103	78517	2	10lw	#10 Lockwasher
104	63531	2	10-24_.38bh	#10-24 x 3/8" Button Hd Cap Screw
105	78327	1	10-32_.13bh	#10-32 x 1/8" Button Hd Cap Screw
106	63054	2	10-32_.25ss	#10-32 x 1/4" Socket Hd Set Screw
107	78687	2	10-32_.25bh	#10-32 x 1/4" Button Hd Cap Screw
108	78993	8	10-32_.38bh	#10-32 x 3/8" Button Hd Cap Screw
109	70110	1	10-32_.38sh	#10-32 x 3/8" Socket Hd Cap Screw
110		4	10-32_.38ssf	#10-32 x 3/8" Socket Hd Set Screw
111	63056	2	10-32_.50sh	#10-32 x 1/2" Socket Hd Cap Screw
112	76501	4	10-32_.50bh	#10-32 x 1/2" Button Hd Cap Screw
113	70293	1	10-32_.63sh	#10-32 x 5/8" Socket Hd Cap Screw
114	63532	2	10-32_.75sh	#10-32 x 3/4" Socket Hd Cap Screw
115	63827	2	1.4_.50dp	Ø 1/4" x 1/2" Dowel Pin
116	63632	3	1.4-20_.50bh	1/4-20 x 1/2" Button Hd Cap Screw
117	63055	1	5.16-18_1.00bh	5/16-18 x 1" Button Hd Cap Screw
118	71086	1	5.16-24_.75ssf	5/16-24 x 3/4" Socket Hd Set Screw
119		1	15.32_32 hex nut	Hex Nut
120		1	1.2isw	1/2" Internal Star Washer

**NOTE: ITEMS MARKED IN BOLD TEXT ARE HIGH WEAR ITEMS**

**NOTE:**  
 (1) Items marked in bold text are high wear items.  
 (2) Use OEM replacement tooling only.  
 (3) Recommended machine speed for automatic equipment is a maximum of 3500 parts per hour.

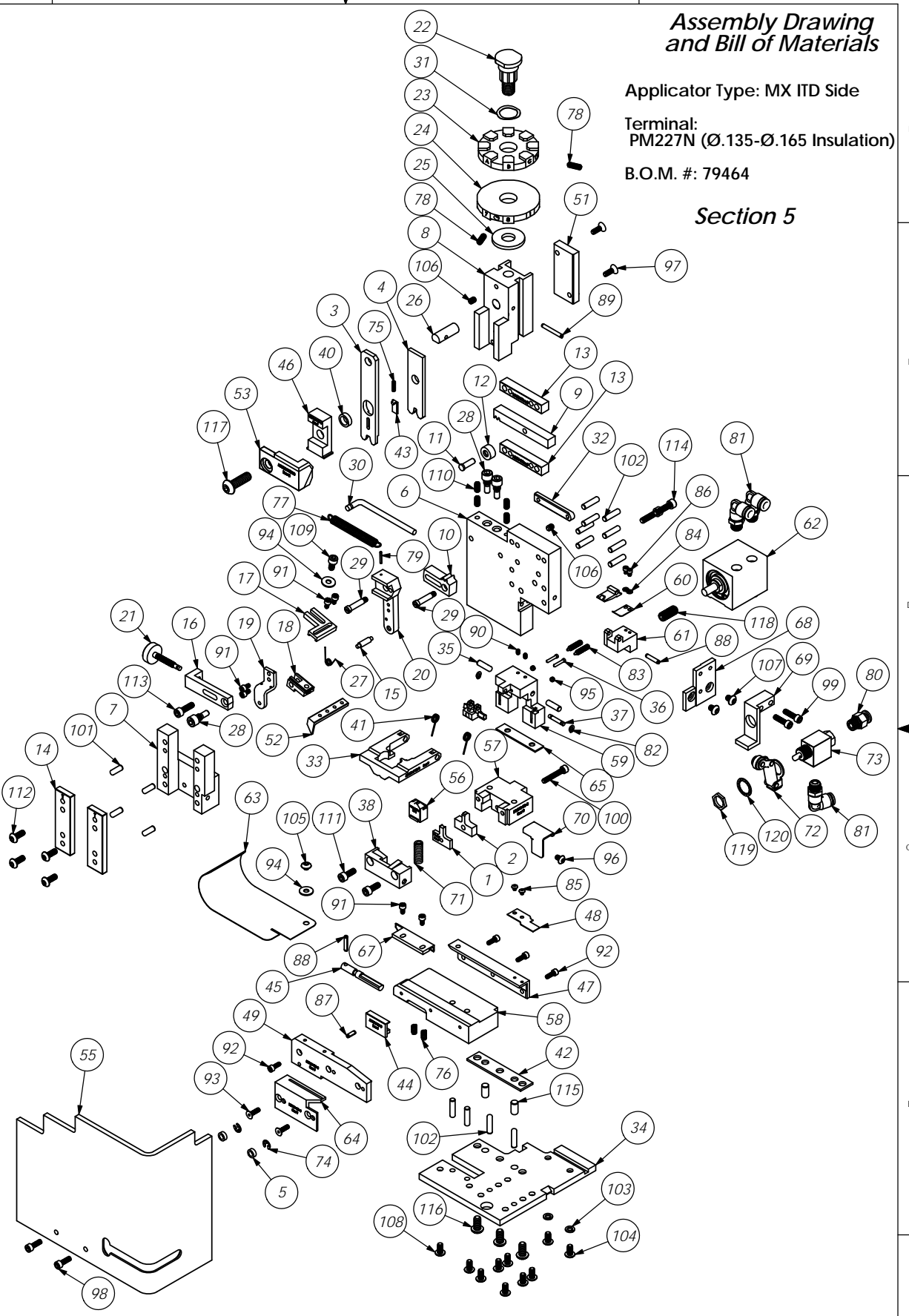

**Assembly Drawing and Bill of Materials**  
 Applicator Type: MX ITD Side  
 Terminal: PM227N (Ø.135-Ø.165 Insulation)  
 B.O.M. #: 79464

**Section 5**

REV	REVISED	DESCRIPTION	MATERIAL SPECIFICATION	QTY	REVISION
D	ECR# 2316 SCJ				
C	ECR# 12447				
B					
A					

DO NOT SCALE DRAWING	UNLESS OTHERWISE SPECIFIED DIMENSIONS ARE IN INCHES. DECIMALS ARE TO BE FRACTIONS. DIMENSIONS ARE TO BE TAKEN FROM THE UNLESS OTHERWISE SPECIFIED.
SURFACE FINISH: ALL OVER	FINISH: USED ON
SCALE: 1:2.5	DATE: 6/20/2013
CHECKED BY: JF	DATE: 6/20/2013
DRAWN BY: JF	DATE: 6/20/2013