

Parts List					Parts List				
Item	Part Code	QTY.	Part No./File Name	Description	Item	Part Code	QTY.	Part No./File Name	Description
1	70762	1	9-4009	Wire Anvil	69	61993	1	MX358-2-ITD-S	Valve Mounting Plate
2	70763	1	9A-4009	Insulation Anvil	70	78835	1	MX360-ITD-S	Scrap Retainer
3	70759	1	13-4009	Wire Rolling Tool	71	72350	1	5-047x1.000	Compression Spring
4	70761	1	14-4009	Insulation Rolling Tool	72	72318	1	Clippard MJV-3	3-Way Valve
5	73888	2	GS-125	Guard Spacer	73	72317	1	Clippard #12296	Cam Follower
6	71494	1	MX2A-S-1	Mounting Frame	74	75083	2	Irving 3100-18	External Retaining Ring
7	71030	1	MX2B-S	Plunger Frame	75	72315	1	LC-022A-4	Compression Spring
8	74343	1	MX3	Ram	76	78681	2	LC-029B-3-M	Compression Spring
9	74438	1	MX5-S	Cam Rack	77	74611	1	LE-037CD-6	Extension Spring
10	74346	1	MX6-1	Gear Arm	78	70739	2	McMaster-Carr #3126A53	Spring Plunger
11	74347	1	MX7	Cam Pin	79	74447	1	McMaster-Carr #98296A109	Expansion Pin (1/16 x 1/2")
12	74350	1	MX8	Cam Roller	80	73222	1	Pisco PC250-N1U	1/4" x 1/8" NPT Straight
13	74351	2	MX10-S	Rack Pad	81	72352	3	Pisco PL250-N1U	Ø1/4" x 1/8" NPT Elbow Fitting, White
14	74352	2	MX11	Gib	82	63200	2	Truarc #5555-12	Retaining Ring
15	74356	1	MX12	Feed Finger Pivot Pin	83	63201	2	Vlier #PH-51-P	Spring Plunger
16	74360	1	MX13	Adjusting Bar	84	63202	2	4lw	#4 Lock Washer
17	76868	1	MX14-1-S	Feed Finger Arm	85	63203	2	4-40_.13bh	#4-40 x 1/8" Button Hd Cap Screw
18	76874	1	MX15-1-S	Feed Finger Guide	86	63204	2	4-40_.16sh	#4-40 x 5/32" Socket Hd Cap Screw
19	74364	1	MX16	Retainer	87	63205	1	1.8_.38rp	Ø 1/8" x 3/8" Roll Pin
20	71495	1	MX18-S-1	Swing Arm	88	63053	2	1.8_.63rp	1/8" x 5/8" Roll Pin
21	74376	1	MX25	Stroke Adjustment Screw	89	62040	1	1.8_1.00rp	1/8" x 1" Roll Pin
22	74407	1	MX33	Mounting Post	90	63206	2	5-40_.19ssf	#5-40 x 3/16" Socket Set Screw
23	72103	1	MX34-F	Wire Crimp Dial	91	63207	6	6-32_.25sh	#6-32 x 1/4" Socket Hd Cap Screw
24	74409	1	MX35	Insulation Dial	92	63209	4	6-32_.38sh	#6-32 x 3/8" Socket Hd Cap Screw
25	74411	1	MX36	Dial Spacer	93	63057	2	6-32_.50fh	#6-32 x 1/2" Flat Hd Cap Screw
26	74412	1	MX44	Locating Dowel	94	63210	2	8fv	#8 Flatwasher
27	74415	1	MX45-S	Feed Finger Spring	95	63211	2	8-32_.13ssf	#8-32 x 1/8" Socket Hd Set Screw
28	74419	3	MX50	Safety Pivot Pin	96	63212	1	8-32_.25bh	#8-32 x 1/4" Button Hd Cap Screw
29	71493	2	MX52-S-1	Pivot Pin	97	63052	2	8-32_.50fh	#8-32 x 1/2" Flat Hd Cap Screw
30	74614	1	MX90-S	Spring Bracket	98	63164	2	8-32_.50sh	#8-32 x 1/2" Socket Hd Cap Screw
31	72310	1	MX104	Wave Disc Spring	99	63162	2	8-32_.63sh	#8-32 x 5/8" Socket Hd Cap Screw
32	71678	1	MX105-S	Pivot Pin Plate	100	63213	1	8-32_1.00sh	#8-32 x 1" Socket Hd Cap Screw
33	72167	1	MX301-7-ITD-S	Latching Gate	101	63158	4	3.16_.50dp	Ø 3/16" x 1/2" Dowel Pin
34	72261	1	MX302-1-ITD-S	Base Plate	102	63470	12	3.16_.75dp	Ø 3/16" x 3/4" Dowel Pin
35	76563	2	MX304-ITD-S	Hinge Pin	103	78517	2	10lw	#10 Lockwasher
36	76564	2	MX305-ITD-S	Pin	104	63531	2	10-24_.38bh	#10-24 x 3/8" Button Hd Cap Screw
37	76567	1	MX308-ITD-S	Latch Pivot Pin	105	78327	1	10-32_.13bh	#10-32 x 1/8" Button Hd Cap Screw
38	78936	1	MX309-4-ITD-S	Cut-off Keeper	106	63054	2	10-32_.25ss	#10-32 x 1/4" Socket Hd Set Screw
39	76573	1	MX314-ITD-S	Catch	107	78687	2	10-32_.25bh	#10-32 x 1/4" Button Hd Cap Screw
40	76574	1	MX315-ITD-S	Insulation Tool Spacer	108	78993	8	10-32_.38bh	#10-32 x 3/8" Button Hd Cap Screw
41	76575	2	MX316-ITD-S	Latch Spring	109	70110	1	10-32_.38sh	#10-32 x 3/8" Socket Hd Cap Screw
42	76576	1	MX317-ITD-S	Base Plate Spacer	110		4	10-32_.38ssf	#10-32 x 3/8" Socket Hd Set Screw
43	76578	1	MX319-ITD-S	Knock off	111	63056	2	10-32_.50sh	#10-32 x 1/2" Socket Hd Cap Screw
44	76579	1	MX320-ITD-S	Brake	112	76501	4	10-32_.50bh	#10-32 x 1/2" Button Hd Cap Screw
45	76580	1	MX321-ITD-S	Brake Actuator	113	70293	1	10-32_.63sh	#10-32 x 5/8" Socket Hd Cap Screw
46	71070	1	MX324-1-ITD-S	Cut-off Pad Pusher	114	63532	2	10-32_.75sh	#10-32 x 3/4" Socket Hd Cap Screw
47	72937	1	MX327-1-ITD-S	Left Feed Rail	115	63827	2	1.4_.50dp	Ø 1/4" x 1/2" Dowel Pin
48	76587	1	MX328-ITD-S	Hold Down Spring	116	63632	3	1.4-20_.50bh	1/4-20 x 1/2" Button Hd Cap Screw
49	76588	1	MX329-ITD-S	Right Feed Rail	117	63055	1	5.16-18_1.00bh	5/16-18 x 1" Button Hd Cap Screw
50	76590	1	MX331-ITD-S	Latch (Automatic)	118	71086	1	5.16-24_.75ssf	5/16-24 x 3/4" Socket Hd Set Screw
51	76608	1	MX335-ITD-S	Cam	119		1	15.32_32 hex nut	Hex Nut
52	71078	1	MX337-1-ITD-S	Feed Finger	120		1	1.2isw	1/2" Internal Star Washer
53	70720	1	MX338-ITD-S	Arm Switch Cam (1 5/8" Stroke)					
54	72233	1	MX338-1-ITD-S	Arm Switch Cam (1 1/8" Stroke)					
55	70745	1	MX339-ITD-S	Guard					
56	78314	1	MX340-3-ITD-S	Cut-off Pad					
57	70765	1	MX341-ITD-S	Die Holder					
58	70766	1	MX342-ITD-S	Feed Plate					
59	70767	1	MX343-ITD-S	Support					
60	72342	1	MX344-2-ITD-S	Leaf Spring					
61	72340	1	MX345-1-ITD-S	Insulation Pusher					
62	72099	1	MX348-ITD-S	.550 Strike Slide Cylinder					
63	72100	1	MX349-ITD-S	Stock Chute					
64	72101	1	MX350-ITD-S	Feed Finger Retainer					
65	72102	1	MX351-ITD-S	Support Spacer					
66	72172	1	MX352-ITD-S	Latch/Wire Stop					
67	72893	1	MX357-ITD-S	Bracket					
68	78733	1	MX358-1-ITD-S	Valve Mounting Plate					

NOTE: ITEMS MARKED IN BOLD TEXT ARE HIGH WEAR ITEMS

NOTE:
 (1) Items marked in bold text are high wear items.
 (2) Use OEM replacement tooling only.
 (3) Recommended machine speed for automatic equipment is a maximum of 3500 parts per hour.

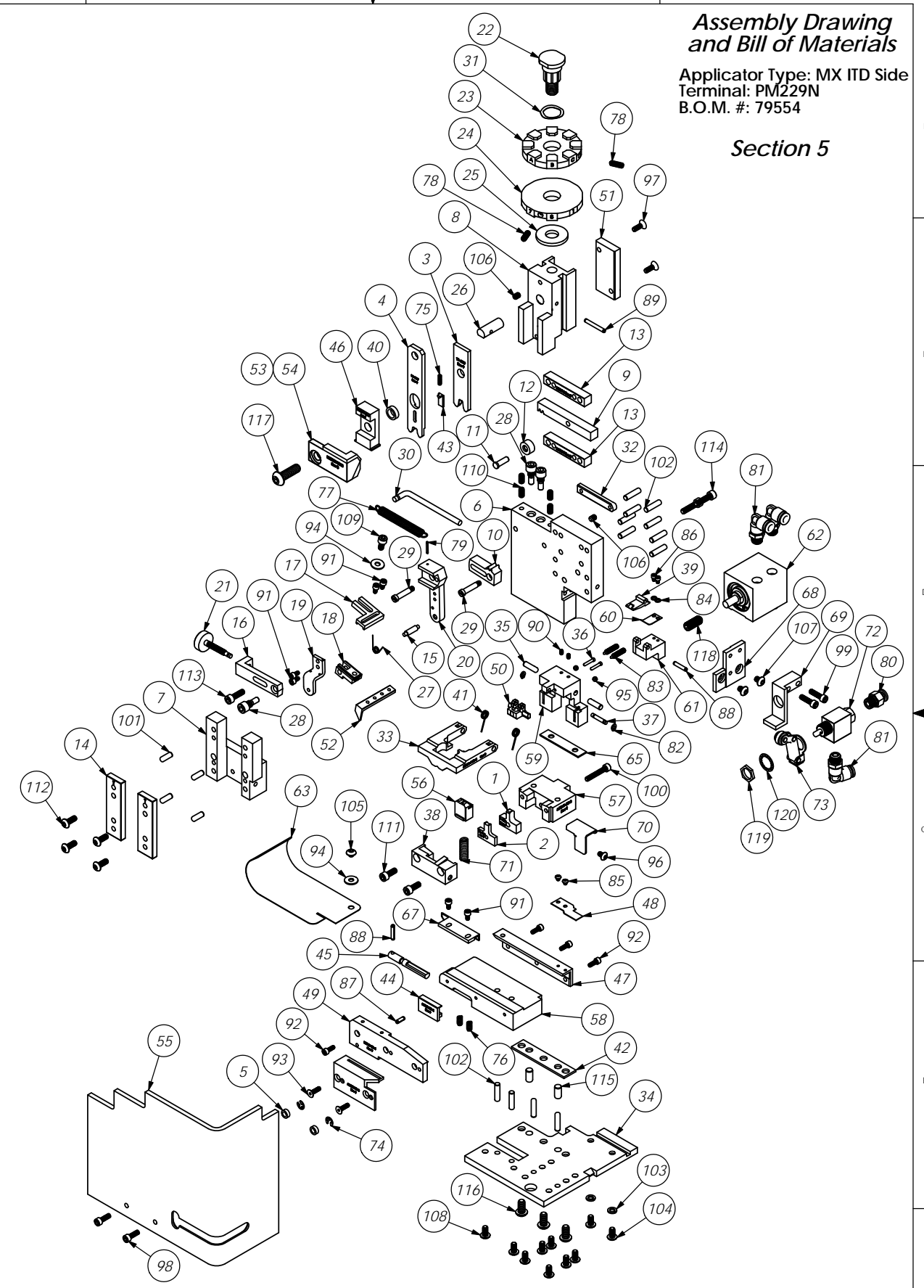

Assembly Drawing and Bill of Materials

Applicator Type: MX ITD Side Terminal: PM229N B.O.M. #: 79554

Section 5

REV	DESCRIPTION	DATE	BY	CHKD	APP
D	ECR# 2316 SCJ	6/19/13			
C	ECR# 12525				
B					
A					

ITEM NO.	PART NO.	DESCRIPTION	MATERIAL SPECIFICATION	QTY.	REMARKS
		DO NOT SCALE DRAWING			
		UNLESS OTHERWISE SPECIFIED DIMENSIONS ARE IN INCHES. DECIMALS ARE ANGLES			
		FRACTIONS: DECIMALS ANGLES			
		#1/64 XX #10 XXX #3000 #3000			
		SURFACE FINISH: ALL OVER			
		THE INFORMATION CONTAINED WITHIN THIS DRAWING IS THE SOLE PROPERTY OF ETICO ENGINEERED PRODUCTS. NO PART OF THIS DRAWING OR THE INFORMATION CONTAINED HEREIN IS TO BE REPRODUCED OR TRANSMITTED IN ANY FORM OR BY ANY MEANS, ELECTRONIC OR MECHANICAL, INCLUDING PHOTOCOPYING, RECORDING, OR BY ANY INFORMATION STORAGE AND RETRIEVAL SYSTEM, WITHOUT THE WRITTEN PERMISSION OF ETICO ENGINEERED PRODUCTS.			
		ETICO ENGINEERED PRODUCTS 25 BELLEWIS STREET WARWICK, RI 02886 (401) 467-2400			
		PM229N			
		SCALE: 1:2.5			
		DATE: 14Sep04			