



**REFERENCE LIST:
LS10, LS12 RIGHT TO LEFT
ECC APPLICATOR
BILL OF MATERIAL NUMBER
79574**

**WARNING !
NEVER OPERATE
THIS OR ANY
APPLICATOR
WITHOUT SAFETY
GUARD IN POSITION.**

PART CODE	PART NUMBER	QUANTITY	DESCRIPTION
77098	11075	(1)	PLUNGER
75716	1125-R	(1)	CAM ROLLER BRACKET
75719	1142	(1)	CAM ROLLER BEARING
75865	314L-2R	(1)	CAM
74403	311	(1)	SPRING PIN
74404	312	(1)	CAM TAPER PIN
74402	310	(1)	CAM RETURN SPRING
73901	101R	(1)	TOP CASTING
73889	LS10R	(1)	BASE PLATE
76969	169	(2)	UNIVERSAL GIBS
74675	406	(1)	COTTER PIN
74676	407	(1)	BRAKE SPRING
77102	408-920	(1)	BRAKE SPACER
74674	405	(1)	TAPER PIN
74673	404	(1)	BRAKE CAM
74633	403-131	(1)	BRAKE BODY
74496	402	(1)	SPRING RETAINER
74495	401	(1)	BRAKE SHAFT
77607	306R	(1)	FEED FINGER STOP
74393	305	(1)	FEED FINGER ARM
74400	308	(1)	FEED SHAFT
74392	304-750	(1)	REAR SPACER
76743	307-16	(1)	SPRING
77925	7A-LS10R	(1)	FEED FINGER
74048	4-041-38	(1)	SPRING
76713	301-5	(1)	SHOULDER SCREW
73952	231	(2)	STRIPPER SPRING
75853	1600-97	(1)	STRIPPER
77161	250-177R	(1)	DIE PLATE
70623	500-127	(1)	REAR GUIDE
75226	1000-27	(1)	FRONT GUIDE
75728	1155	(1)	ADJUST BLOCK SCREW
73890	SR-LS10R	(1)	STOCK RETAINER
73517	3-026-62	(1)	CUT-OFF SPRING

**NOTE: ITEMS MARKED WITH AN *
ARE HIGH WEAR ITEMS**



**REFERENCE LIST:
LS10, LS12 RIGHT TO LEFT
ECC APPLICATOR
BILL OF MATERIAL NUMBER
79574**

**WARNING !
NEVER OPERATE
THIS OR ANY
APPLICATOR
WITHOUT SAFETY
GUARD IN POSITION.**

PART CODE	PART NUMBER	QUANTITY	DESCRIPTION
73955	235	(1)	GUIDE SPACER BLOCK
72228	12D-DM266-2	(1)	CUT-OFF PUSHER
72563	*13-LS10R	(1)	WIRE ROLLING TOOL
73038	*14-LS10R	(1)	INSULATION ROLLING TOOL
70392	*8B9-LS10R	(1)	DIE / ANVIL
75726	1150-2	(1)	INSUL. ADJUST BLOCK
72140	*12A-LS10R	(1)	CUT-OFF DIE
70391	*8B-LS10R	(1)	CUT-OFF DIE
76191	1805	(1)	STOCK CHUTE
77104	GS-220	(2)	GUARD SPACER
73891	199-13	(1)	GUARD
		(1)	6-32 X .20 LG. S.H.C.S.
		(4)	6-32 X 1/2" S.H.C.S.
		(5)	8-32 X 3/8" S.H.C.S.
		(8)	8-32 X 1/2" S.H.C.S.
		(1)	8-32 X 3/4" S.H.C.S.
		(1)	10-32 X 3/8" S.H.C.S.
		(3)	10-32 X 1/2" S.H.C.S.
		(3)	10-32 X 1 1/4 S.H.C.S.
		(1)	1/4-20 X 1/4" S.S.S.
		(1)	1/4-28 X 1/2" S.H.C.S.
		(1)	1/4-28 X 5/8" S.S.S.
		(2)	1/4-20 X 1" S.H.C.S.
		(1)	1/4-28 JAM NUT
		(2)	1/4 X 3/8" SHOULDER SCREW
		(1)	5/16 X 3/4" SHOULDER SCREW
		(3)	1/8 X 1/2" DOWEL
		(2)	1/8 X 1" DOWEL
		(2)	1/4 X 1" DOWEL
		(1)	8-32 X 3/8" LG F.H.S.C.S.

**NOTE: ITEMS MARKED WITH AN *
ARE HIGH WEAR ITEMS**

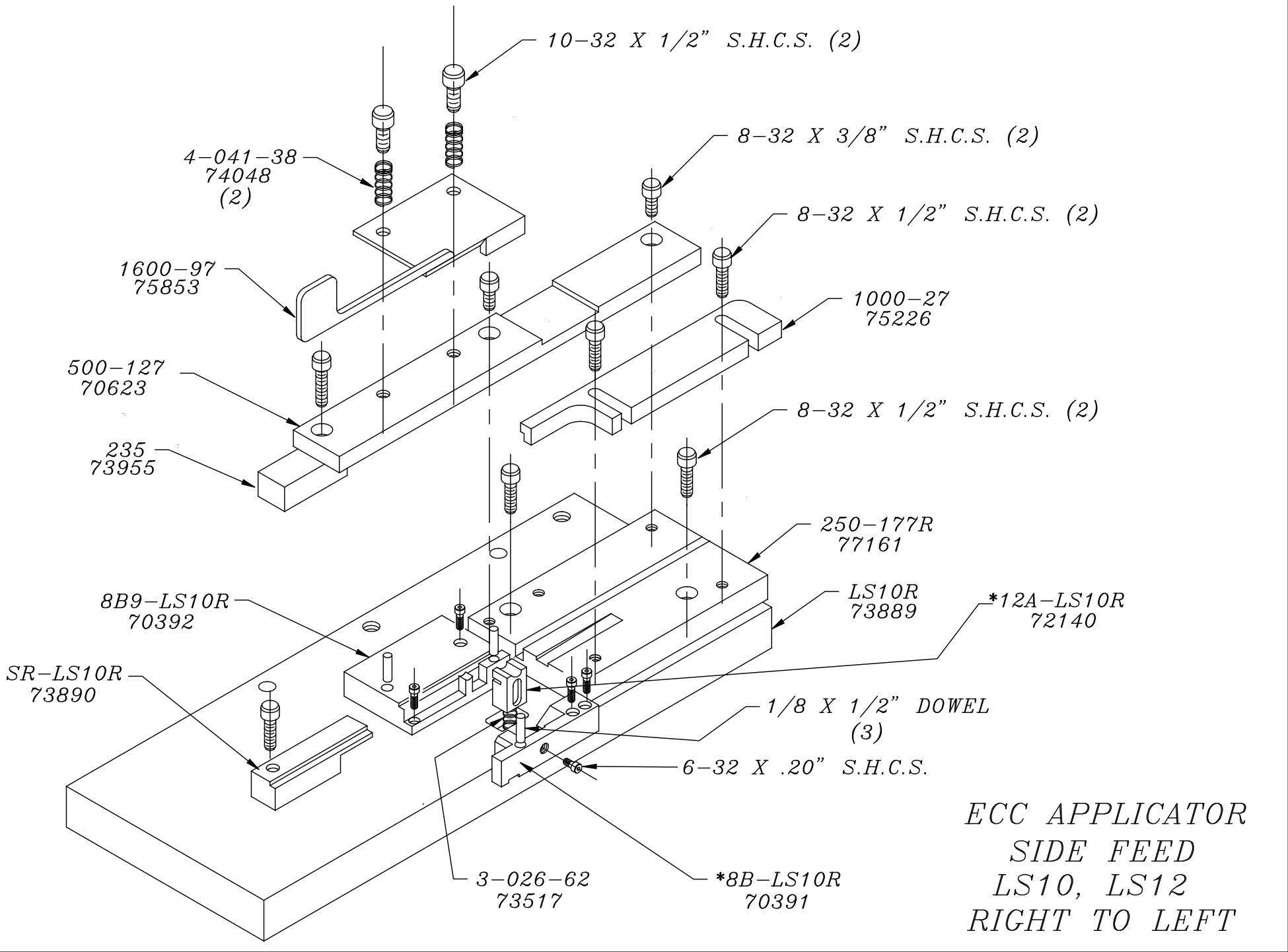

ECC APPLICATOR
 SIDE FEED
 LS10, LS12
 RIGHT TO LEFT

*ECC APPLICATOR
SIDE FEED
LS10 , LS12
RIGHT TO LEFT*

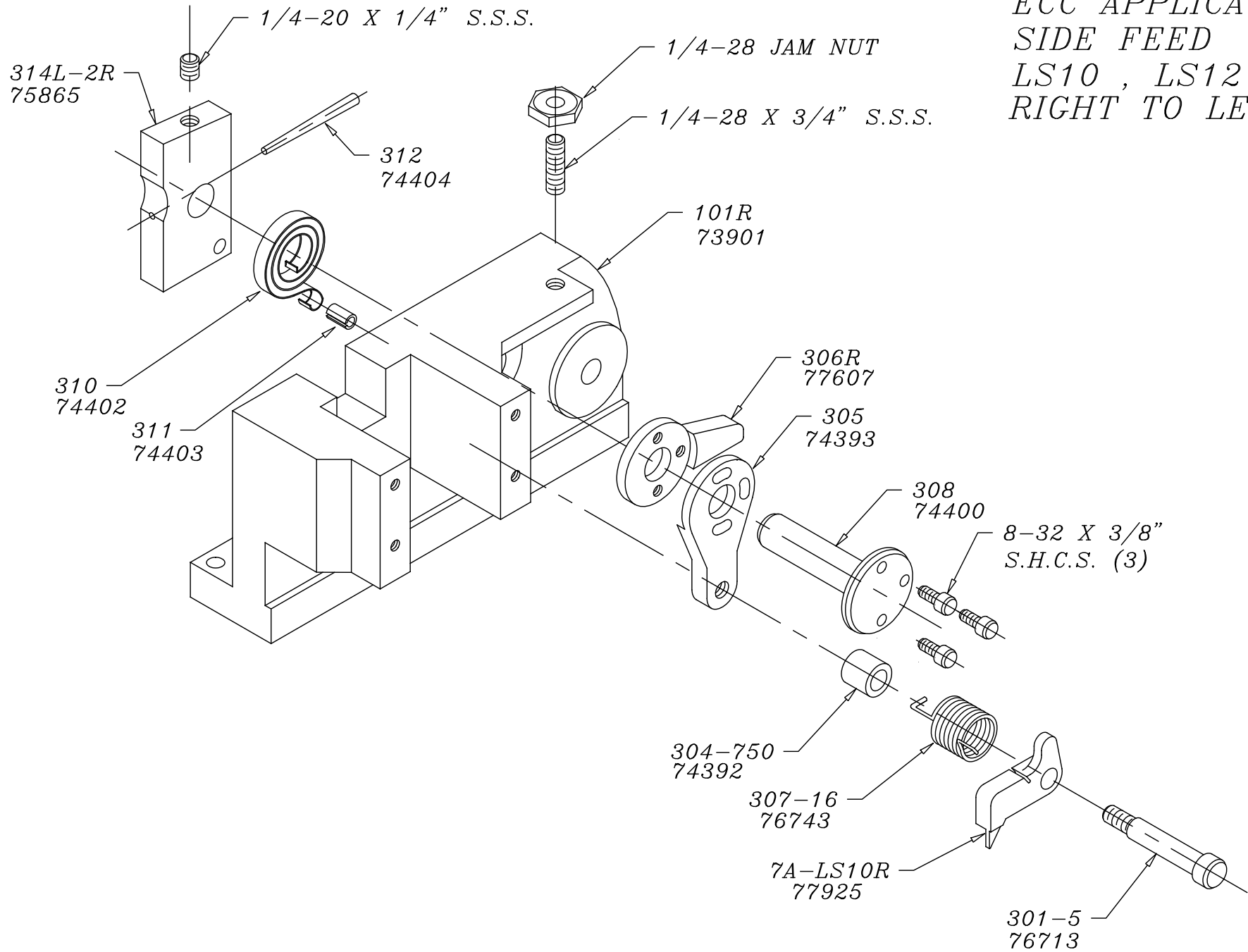

*ECC APPLICATOR
SIDE FEED
LS-10 , LS-12
RIGHT TO LEFT*

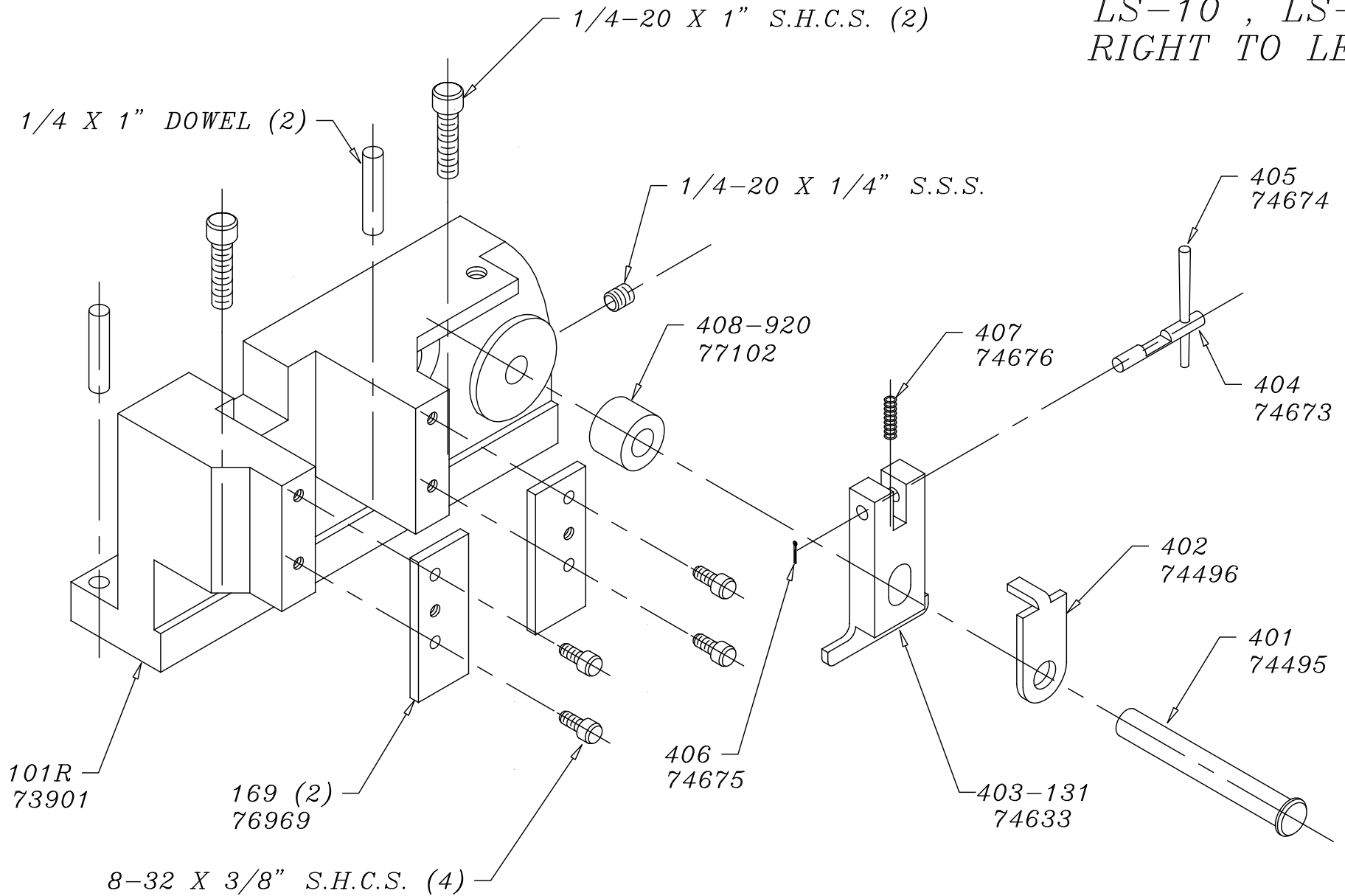

*ECC APPLICATOR
SIDE FEED
LS10 , LS12
RIGHT TO LEFT*

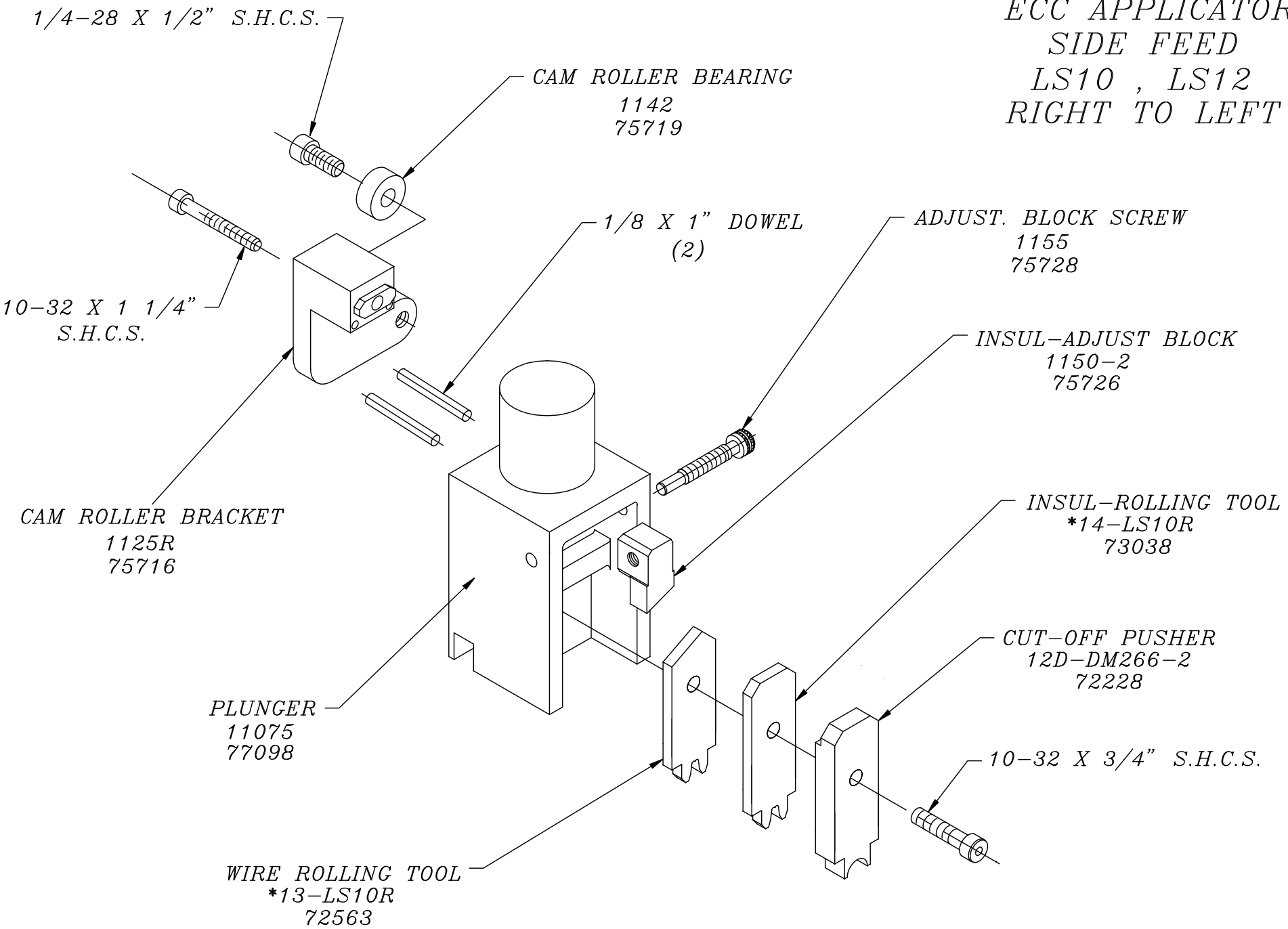

*ECC APPLICATOR
SIDE FEED
LS-10 , LS12
RIGHT TO LEFT*

