



**REFERENCE LIST:
R195E
ECC APPLICATOR-REAR
BILL OF MATERIAL NUMBER
79615**

**WARNING !
NEVER OPERATE
THIS OR ANY
APPLICATOR
WITHOUT SAFETY
GUARD IN POSITION.**

PART CODE	PART NUMBER	QUANTITY	DESCRIPTION
70186	*8-067	(1)	DIE
70187	*8-068	(1)	DIE
70957	*9-071	(1)	ANVIL
72380	*13-045	(1)	ROLLING TOOL
73935	202	(1)	BASE PLATE
77515	101-35A	(1)	TOP CASTING
75647	11-122	(1)	PLUNGER
74674	405	(1)	TAPER PIN
74676	407	(1)	SPRING
74759	17-045	(1)	SPACER
75713	11-B-1	(1)	BRACKET
77515	101-35A	(1)	TOP CASTING
70070	116-093R	(1)	CASTING SPACER
74676	407	(1)	SPRING
74675	406	(1)	COTTER PIN
76969	169	(1)	LEFT GIB
76969	169	(1)	RIGHT GIB
74648	403-146	(1)	BRAKE
74496	402	(1)	SPRING RETAINER
74495	401	(1)	SHAFT
74118	303-36	(1)	FEED FINGER
73214	304-340	(1)	SPACER
74123	17-044	(1)	SPACER
74393	305	(1)	FEED FINGER ARM
76788	307-5	(1)	SPRING
74337	303-12	(1)	FEED FINGER
76858	301-3	(1)	5/16 SHOULDER SCREW
72364	500-231-1	(1)	RIGHT GUIDE
72366	1000-117-1	(1)	LEFT GUIDE
77049	306-1	(1)	STOPARM
74400	308	(1)	SHAFT
74402	310	(2)	SPRING
74403	311	(1)	ROLL PIN
74404	312	(1)	TAPER PIN
71628	*12-062	(1)	CUT-OFF PUNCH
74405	313	(1)	1/4-20 X 1/4" SET SCREW

**NOTE: ITEMS MARKED WITH AN *
ARE HIGH WEAR ITEMS**

ECC APPLICATOR-REAR
BASE PLATE ASSEMBLY
R195E

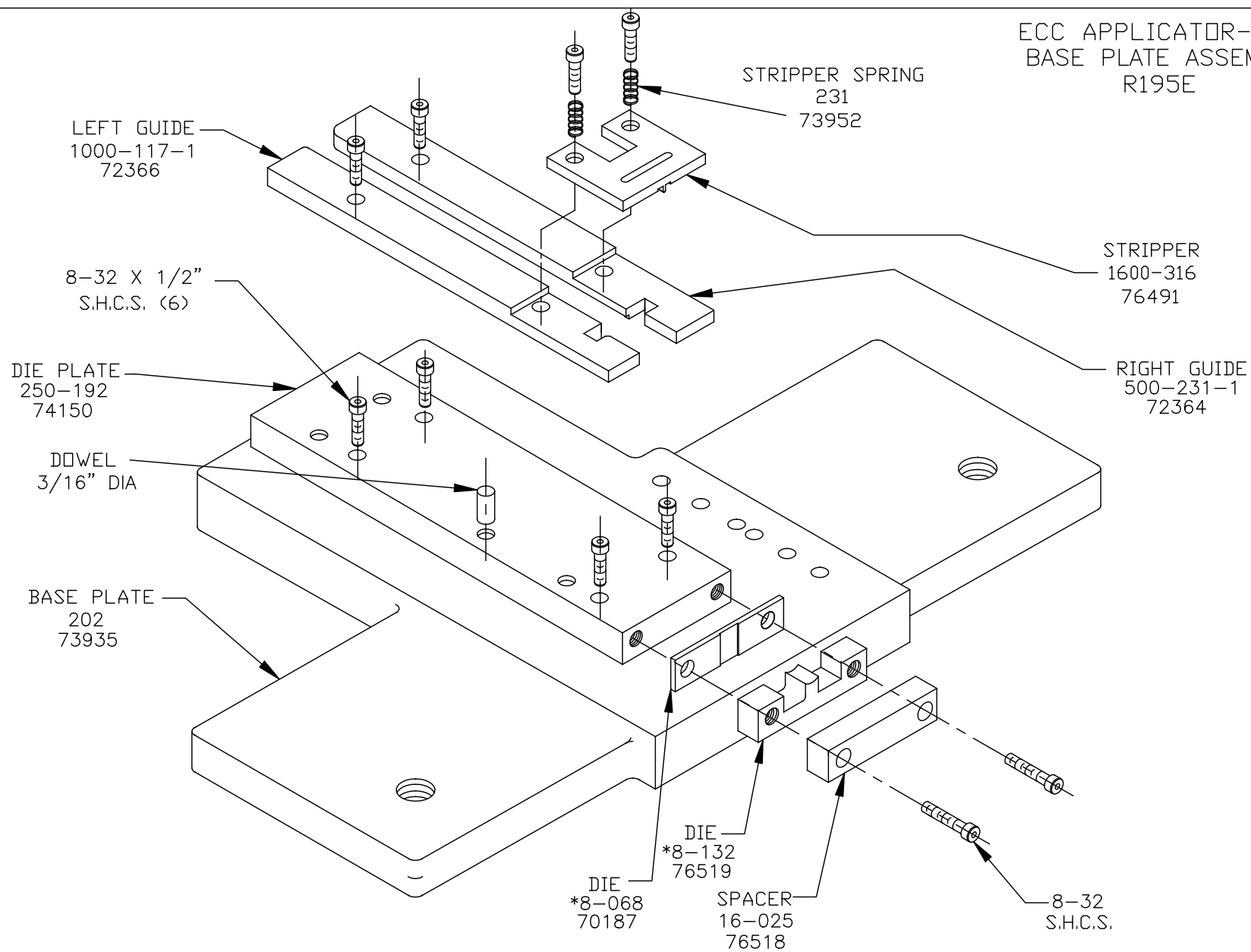

ECC APPLICATOR-REAR TOP CASTING ASSEMBLY R195E

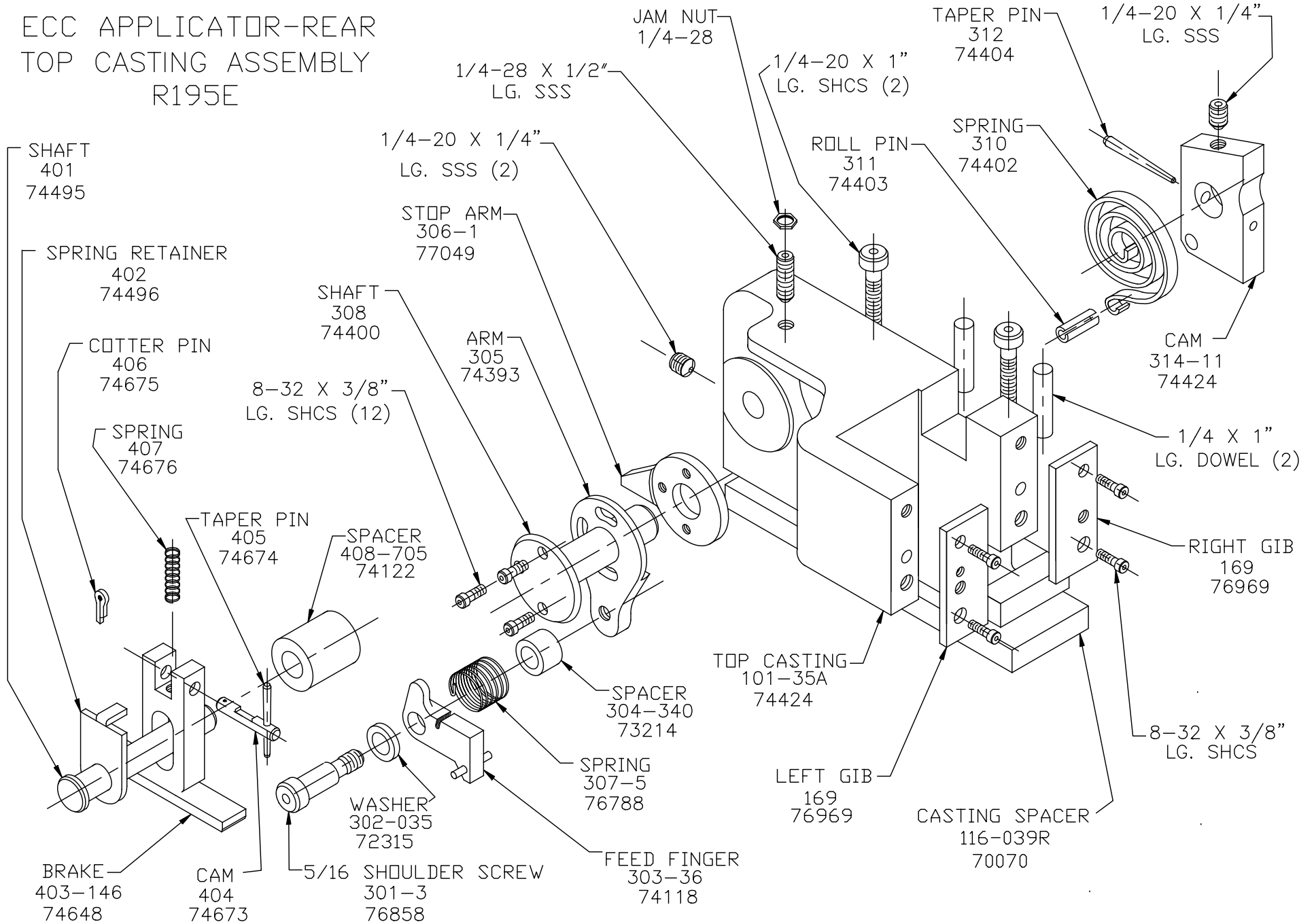

ECC APPLICATOR-REAR
SAFETY GUARD
R195E

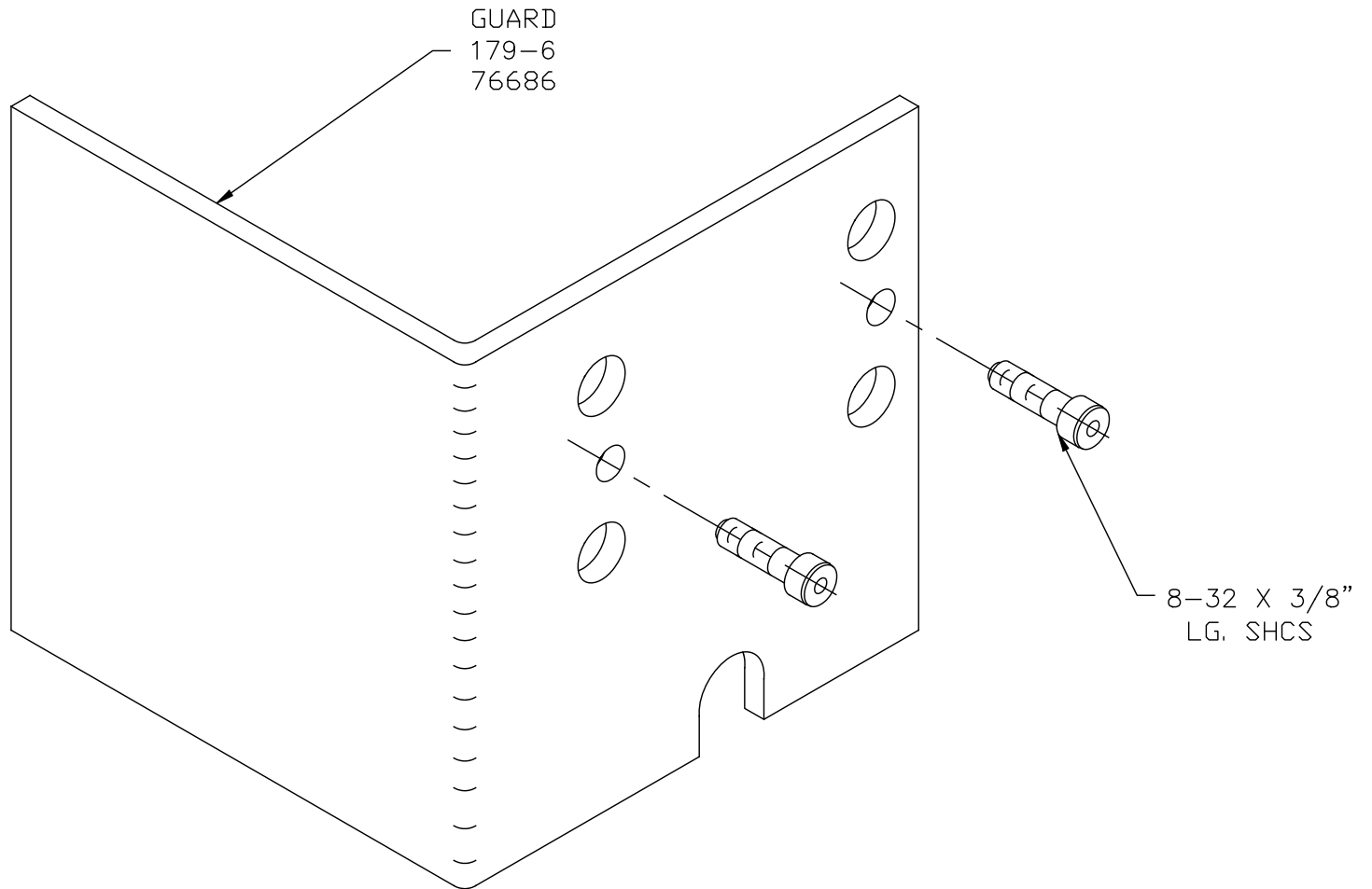

NEVER OPERATE APPLICATOR WITHOUT
SAFETY GUARD IN POSITION.

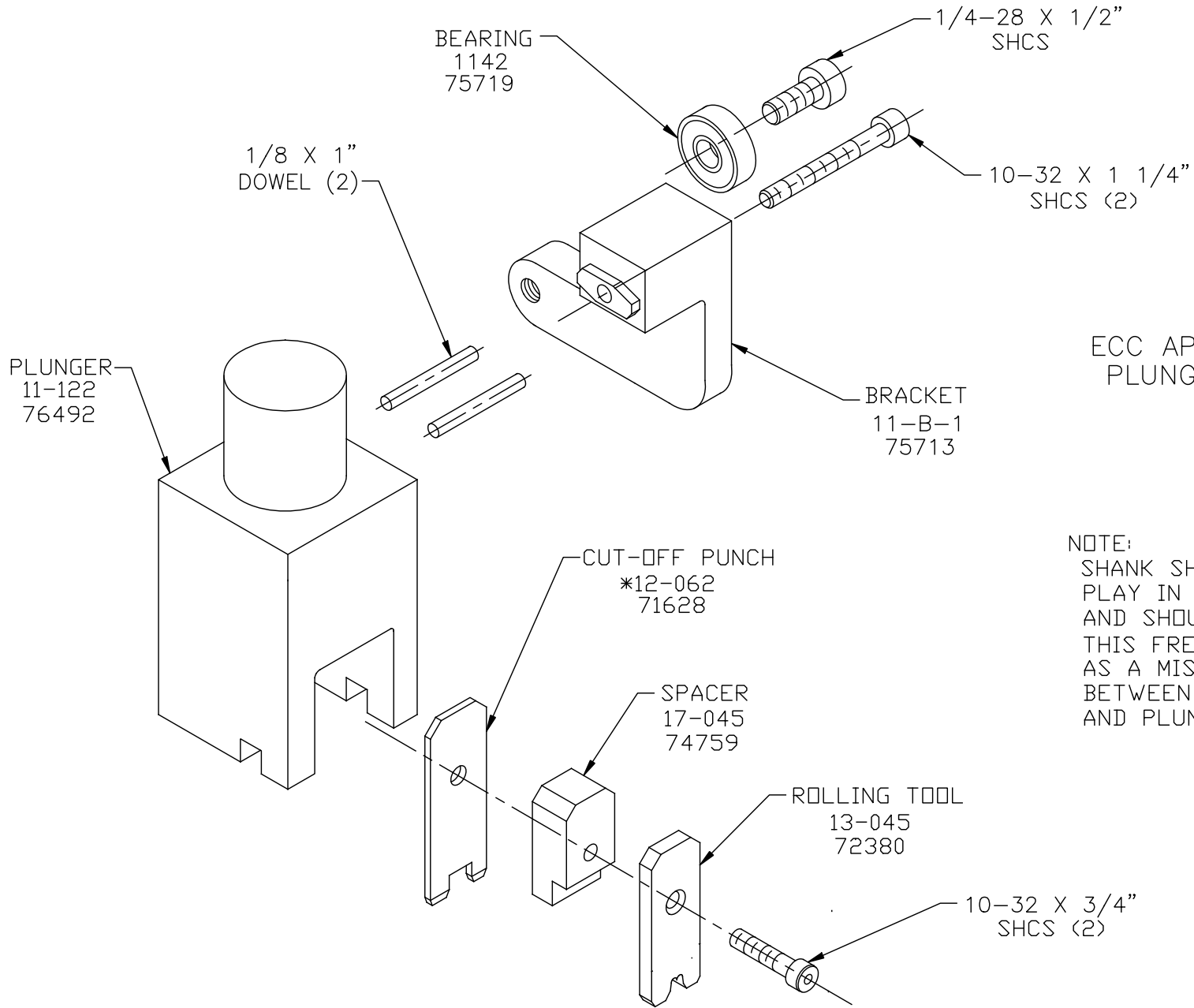

ECC APPLICATOR-REAR
PLUNGER ASSEMBLY
R195E

NOTE:
SHANK SHOULD HAVE FREE
PLAY IN THE VERTICAL AXIS
AND SHOULD SPIN FREELY,
THIS FREE MOTION SERVES
AS A MISALIGNMENT COUPLING
BETWEEN PRESS RAM
AND PLUNGER.