

# Assembly Drawing and Bill of Materials

Applicator Type: MX Side Feed Applicator - Right to Left  
Terminal: LS10R  
B.O.M. #: 79622

## Section 5

**NOTE:**  
(1) Items marked in bold text are high wear items.  
(2) Use OEM replacement tooling only.  
(3) Recommended machine speed for automatic equipment is a maximum of 3500 parts per hour.

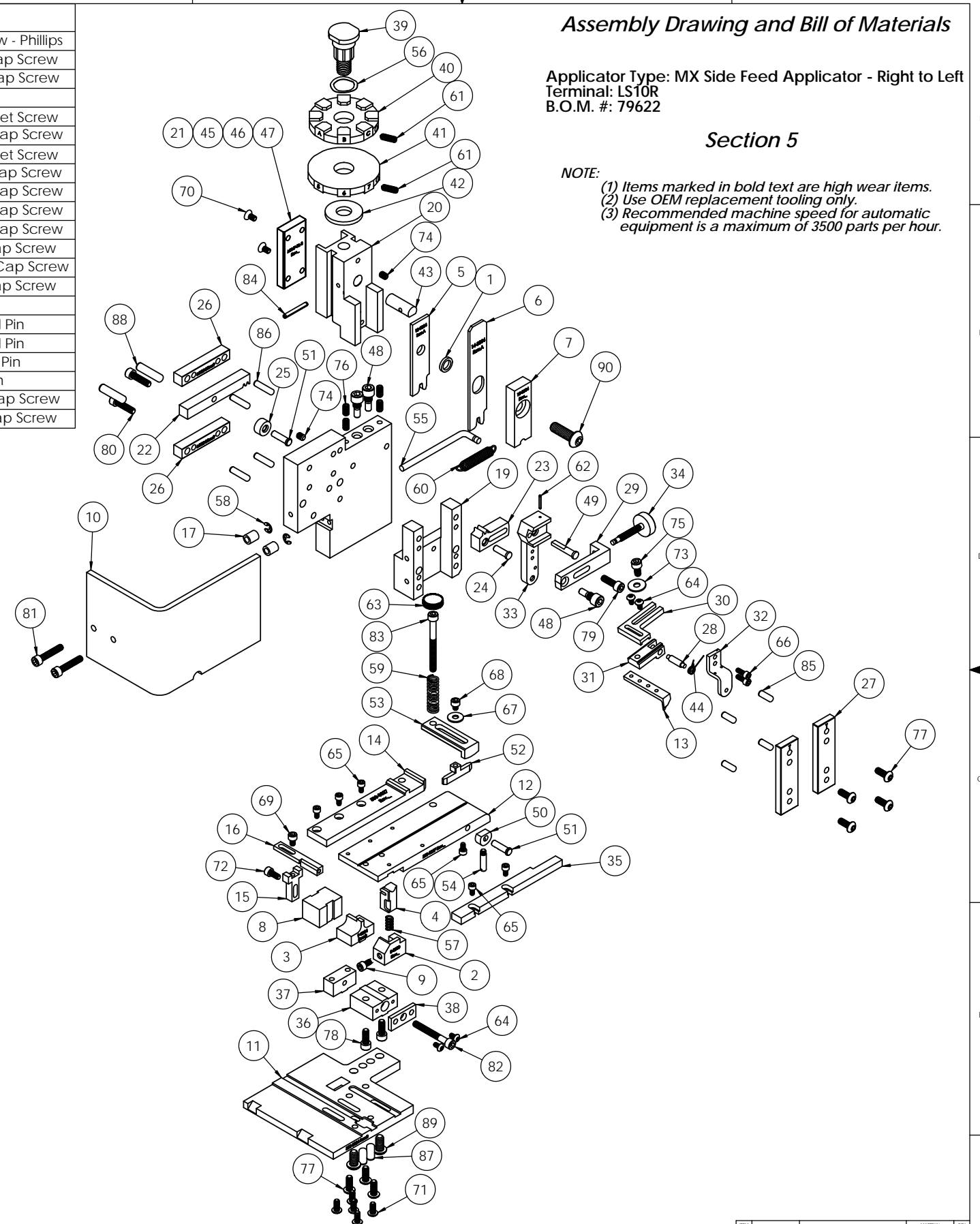

ITEM NO.	QTY.	Part_Code	PART NUMBER	DESCRIPTION	ITEM NO.	QTY.	Part_Code	PART NUMBER	DESCRIPTION
1	1	<b>76469</b>	<b>087S-3001</b>	<b>IRT Spacer</b>	70	2		8-32_.31fhs	#8-32 x 5/16" Flat Hd Screw - Phillips
2	1	<b>74287</b>	<b>8-3000</b>	<b>Cut-off Pad Retainer</b>	71	5	61472	8-32_.38bh	#8-32 x 3/8" Button Hd Cap Screw
3	1	<b>76425</b>	<b>9-3034</b>	<b>Anvil</b>	72	1	63161	8-32_.38sh	#8-32 x 3/8" Socket Hd Cap Screw
4	1	<b>76067</b>	<b>12-3027</b>	<b>Front Cut-off Pad</b>	73	1	63753	10fw	#10 Flatwasher
5	1	<b>76426</b>	<b>13-3034</b>	<b>Wire Rolling Tool</b>	74	2	63054	10-32_.25ss	#10-32 x 1/4" Socket Hd Set Screw
6	1	<b>76427</b>	<b>14-3034</b>	<b>Insulation Rolling Tool</b>	75	1	70110	10-32_.38sh	#10-32 x 3/8" Socket Hd Cap Screw
7	1	<b>76466</b>	<b>15-3034</b>	<b>Cut-off Pad Driver</b>	76	4	71626	10-32_.38ss	#10-32 x 3/8" Socket Hd Set Screw
8	1	76468	26-3034	Backup Block	77	7	76501	10-32_.50bh	#10-32 x 1/2" Button Hd Cap Screw
9	1	77265	26-3088	Locking Screw	78	2	63056	10-32_.50sh	#10-32 x 1/2" Socket Hd Cap Screw
10	1	76068	199-3027	Guard	79	1	70293	10-32_.63sh	#10-32 x 5/8" Socket Hd Cap Screw
11	1	76465	200-3034	Base Plate	80	2	63532	10-32_.75sh	#10-32 x 3/4" Socket Hd Cap Screw
12	1	76055	250-3027	Feed Plate	81	2	63155	10-32_1.00sh	#10-32 x 1" Socket Hd Cap Screw
13	1	76467	303-3034	Feed Finger	82	1	63826	10-32_1.50sh	#10-32 x 1 1/2" Socket Hd Cap Screw
14	1	76056	500-3027	Rear Guide Rail	83	1	71076	10-32_2.00sh	#10-32 x 2" Socket Hd Cap Screw
15	1	74803	1600B-3000	Adjustable Stripper Holder	84	1	62040	1.8_1.00rp	1/8" x 1" Roll Pin
16	1	76464	1600A-3001	Adjustable Stripper Block	85	4	63158	3.16_.50dp	Ø3/16" x 1/2" Dowel Pin
17	2	74491	GS-375	Guard Spacer	86	4	63470	3.16_.75dp	Ø3/16" x 3/4" Dowel Pin
18	1	71846	MX2A-RL-S	Mounting Frame, R-L	87	2	63827	1.4_.50dp	Ø1/4" x 1/2" Dowel Pin
19	1	71847	MX2B-RL-S	Plunger Frame	88	2	63510	1.4_1.00dp	1/4 x 1" Dowel Pin
20	1	74343	MX3	Ram	89	2	63632	1.4-20_.50bh	1/4-20 x 1/2" Button Hd Cap Screw
21	1	74344	MX4-S	Cam (1 5/8" Up Stroke)	90	1	63055	5.16-18_1.00bh	5/16-18 x 1" Button Hd Cap Screw
22	1	74438	MX5-S	Cam Rack					
23	1	74346	MX6	Gear Arm					
24	1	74347	MX7	Cam Pin					
25	1	74350	MX8	Cam Roller					
26	2	74351	MX10-S	Rack Pad					
27	2	74352	MX11	Gib					
28	1	74356	MX12	Feed Finger Pivot Pin					
29	1	74360	MX13	Adjusting Bar					
30	1	71848	MX14-RL-S	Feed Finger Arm					
31	1	74362	MX15-S	Feed Finger Guide					
32	1	74364	MX16	Retainer					
33	1	71852	MX18-RL-S	Swing Arm					
34	1	74376	MX25	Stroke Adjustment Screw					
35	1	76057	MX28-1-RL-S	Front Guide					
36	1	74384	MX29-S	Slide Support					
37	1	74388	MX30-S	Support Anchor					
38	1	74390	MX32-S	Support Cover					
39	1	74407	MX33	Mounting Post					
40	1	74408	MX34	Wire Crimp Dial Blank					
41	1	74409	MX35	Insulation Dial					
42	1	74411	MX36	Dial Spacer					
43	1	74412	MX44	Locating Dowel					
44	1	74415	MX45-S	Feed Finger Spring					
45	1	76472	MX47-RL-S	Cam (K-Press Upstroke R-L)					
46	1	74416	MX47-S	Cam (1 5/8" Down stroke)					
47	1	74417	MX48-S	Cam (1 1/8" Up Stroke)					
48	3	74419	MX50	Safety Pivot Pin					
49	1	74420	MX52	Pivot Pin					
50	1	74425	MX84-S	Brake Cam					
51	2	74426	MX85-S	Cam Pivot Pin					
52	1	74428	MX86-S	Brake Shoe					
53	1	75178	MX87-S	Lift Arm					
54	1	74430	MX88-S	Lever					
55	1	74614	MX90-S	Spring Bracket					
56	1	72310	MX104	Wave Disc Spring					
57	1	74578	4-034-875	Spring					
58	2	75083	Irving 3100-18	External Retaining Ring					
59	1	62873	LC-045E-12-M	Lee Spring LC-045E-12-M					
60	1	74611	LE-037CD-6	Extension Spring					
61	2	70739	McMaster-Carr #3126A53	Spring Plunger					
62	1	74447	McMaster-Carr #98296A109	Expansion Pin (1/16 x 1/2")					
63	1	73785	SPI 99-602-5	#10 Black Knurled Knob					
64	4	63792	6-32_.25bh	#6-32 x 1/4" Button Hd Cap Screw					
65	6	63207	6-32_.25sh	#6-32 x 1/4" Socket Hd Cap Screw					
66	2	63209	6-32_.38sh	#6-32 x 3/8" Socket Hd Cap Screw					
67	1	63210	8fw	#8 Flatwasher					
68	1	60265	8-32_.19sh	#8-32 x 3/16" Socket Hd Cap Screw					
69	1	63163	8-32_.25sh	#8-32 x 1/4" Socket Hd Cap Screw					

**NOTE: ITEMS MARKED IN BOLD TEXT ARE HIGH WEAR ITEMS**

DO NOT SCALE DRAWING		UNLESS OTHERWISE SPECIFIED DIMENSIONS ARE IN INCHES. TOLERANCES ARE FRACTIONS DECIMALS ANGLES	
SURFACE FINISH: ✓ ALL OVER		HEAT TREAT: _____	
THE INFORMATION CONTAINED WITHIN THIS DRAWING IS THE SOLE PROPERTY OF ETCO. NO PART OF THIS DRAWING OR THE INFORMATION CONTAINED HEREIN IS TO BE REPRODUCED OR TRANSMITTED IN ANY FORM OR BY ANY MEANS, ELECTRONIC OR MECHANICAL, WITHOUT THE WRITTEN PERMISSION OF ETCO ENGINEERED PRODUCTS.		EICO ENGINEERED PRODUCTS 25 BELLEVUE STREET WARWICK, RI 02888 (401) 467-2400	
Updated Parts List SCJ 2/27/14		LS10R	
REV	REVISION	DATE	BY
A		2/27/14	SCJ
APPLICATOR		SCALE	CAD FILE
		CHECKED BY	DATE
		DRAWN BY	DATE
		DATE	REV
		2/12/14	A
			D