



**REFERENCE LIST:  
RE93F  
ECC APPLICATOR-SIDE  
BILL OF MATERIAL NUMBER  
79680**

**WARNING !  
NEVER OPERATE  
THIS OR ANY  
APPLICATOR  
WITHOUT SAFETY  
GUARD IN POSITION.**

PART CODE	PART NUMBER	QUANTITY	DESCRIPTION
77918	1102-FS-1	(1)	PLUNGER
77918	1102-FS	(1)	FLOATING SHANK
75710	1125	(1)	CAM ROLLER BRACKET
75719	1142	(1)	CAM ROLLER BEARING
74410	314L-2	(1)	CAM
74403	311	(1)	SPRING PIN
74404	312	(1)	CAM TAPER PIN
74402	310	(1)	CAM RETURN SPRING
73899	101	(1)	TOP CASTING
75747	205-13	(1)	BASE PLATE
76969	169	(2)	UNIVERSAL GIBS
74675	406	(1)	COTTER PIN
74676	407	(1)	BRAKE SPRING
75745	408-910	(1)	BRAKE BUSHING
74674	405	(1)	TAPER PIN
74673	404	(1)	BRAKE CAM
75045	403-38BW	(1)	BRAKE BODY
74496	402	(1)	SPRING RETAINER
74495	401	(1)	BRAKE SHAFT
74396	306	(1)	FEED FINGER STOP
74393	305	(1)	FEED FINGER ARM
74400	308	(1)	FEED SHAFT
76263	304-765	(1)	REAR SPACER
76743	307-16	(1)	SPRING
76269	303-12-1	(1)	FEED FINGER
76713	301-5	(1)	SHOULDER SCREW
73952	231	(2)	STRIPPER SPRING
75926	1600-153	(1)	STRIPPER
75746	250-237	(1)	DIE PLATE
74893	500-203	(1)	REAR GUIDE
75291	1000-90	(1)	FRONT GUIDE
76845	3-026-75	(2)	SPRING
71635	*12-069	(1)	CUT-OFF PUNCH
72416	*13-089	(1)	WIRE ROLLING TOOL
73235	15-015	(1)	CUT-OFF PUNCH DRIVER
73308	21-013	(1)	CUT-OFF PUNCH RETAINER

**NOTE: ITEMS MARKED WITH AN \*  
ARE HIGH WEAR ITEMS**



**REFERENCE LIST:  
RE93F  
ECC APPLICATOR-SIDE  
BILL OF MATERIAL NUMBER  
79680**

**WARNING !  
NEVER OPERATE  
THIS OR ANY  
APPLICATOR  
WITHOUT SAFETY  
GUARD IN POSITION.**

PART CODE	PART NUMBER	QUANTITY	DESCRIPTION
75748	8-099	(1)	DIE
70203	*8-094	(1)	ANVIL
76186	1800	(1)	STOCK CHUTE
77725	176-3	(1)	GUARD
77146	176S-250	(2)	GUARD SPACER
		(14)	8-32 X 3/8" S.H.C.S.
		(4)	8-32 X 1/2" S.H.C.S.
		(2)	8-32 X 3/4" S.H.C.S.
		(2)	10-32 X 1/2" S.H.C.S.
		(1)	10-32 X 3/4" S.H.C.S.
		(1)	10-32 X 1 1/4" S.H.C.S.
		(2)	1/4-20 X 1/4" S.S.S.
		(1)	1/4-20 X 1 S.H.C.S.
		(1)	1/4-28 X 3/4" S.S.S.
		(1)	1/4-28 JAM NUT
		(1)	5/16 X 3/4" SHOULDER SCREW
		(2)	1/8 X 3/8" DOWEL
		(2)	1/8 X 1" DOWEL
		(2)	1/4 X 1" DOWEL

**NOTE: ITEMS MARKED WITH AN \*  
ARE HIGH WEAR ITEMS**

*ECC APPLICATOR  
SIDE FEED  
RE93F*

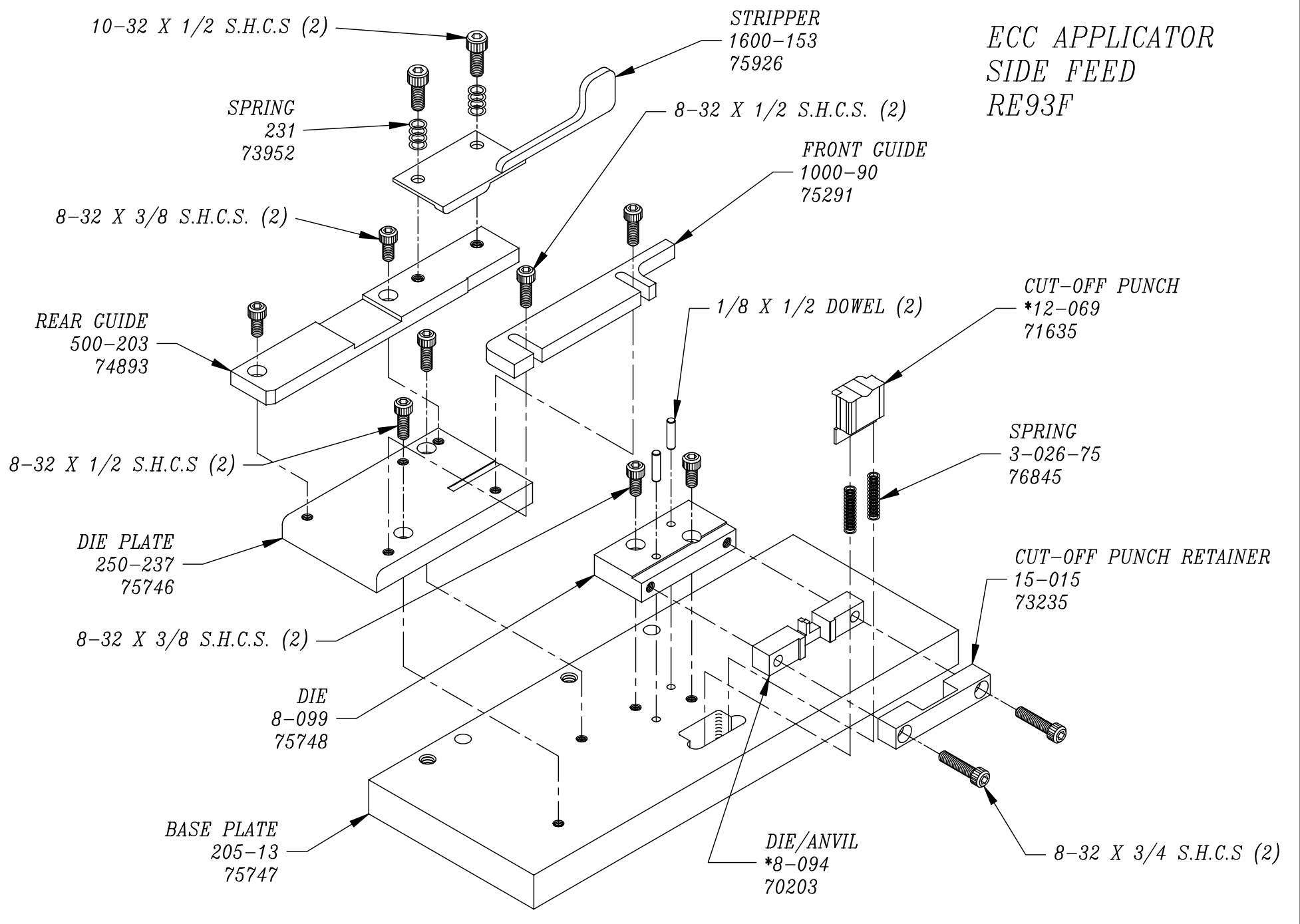

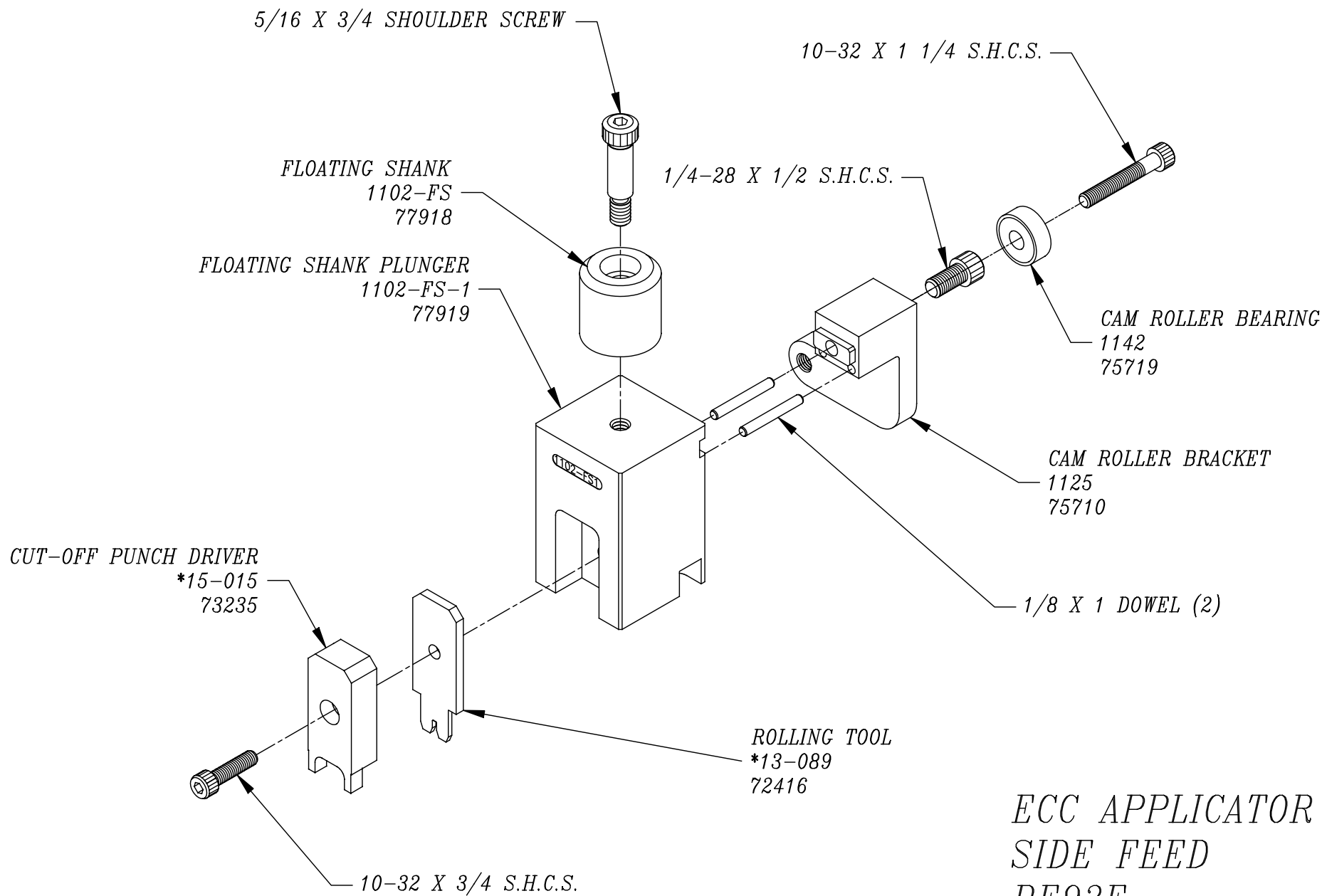

*ECC APPLICATOR  
SIDE FEED  
RE93F*

*ECC APPLICATOR  
SIDE FEED  
RE93F*

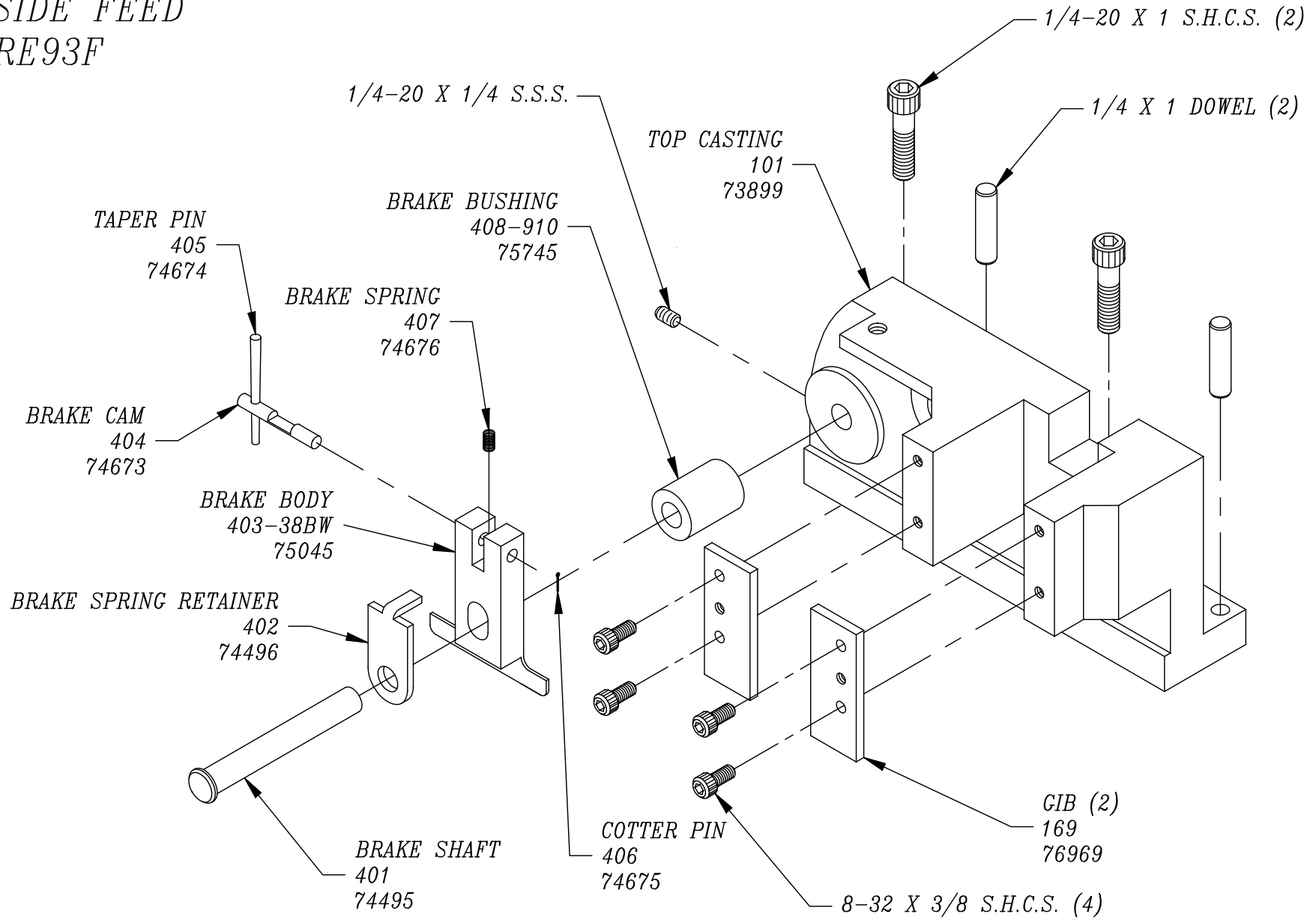

*ECC APPLICATOR  
SIDE FEED  
RE93F*

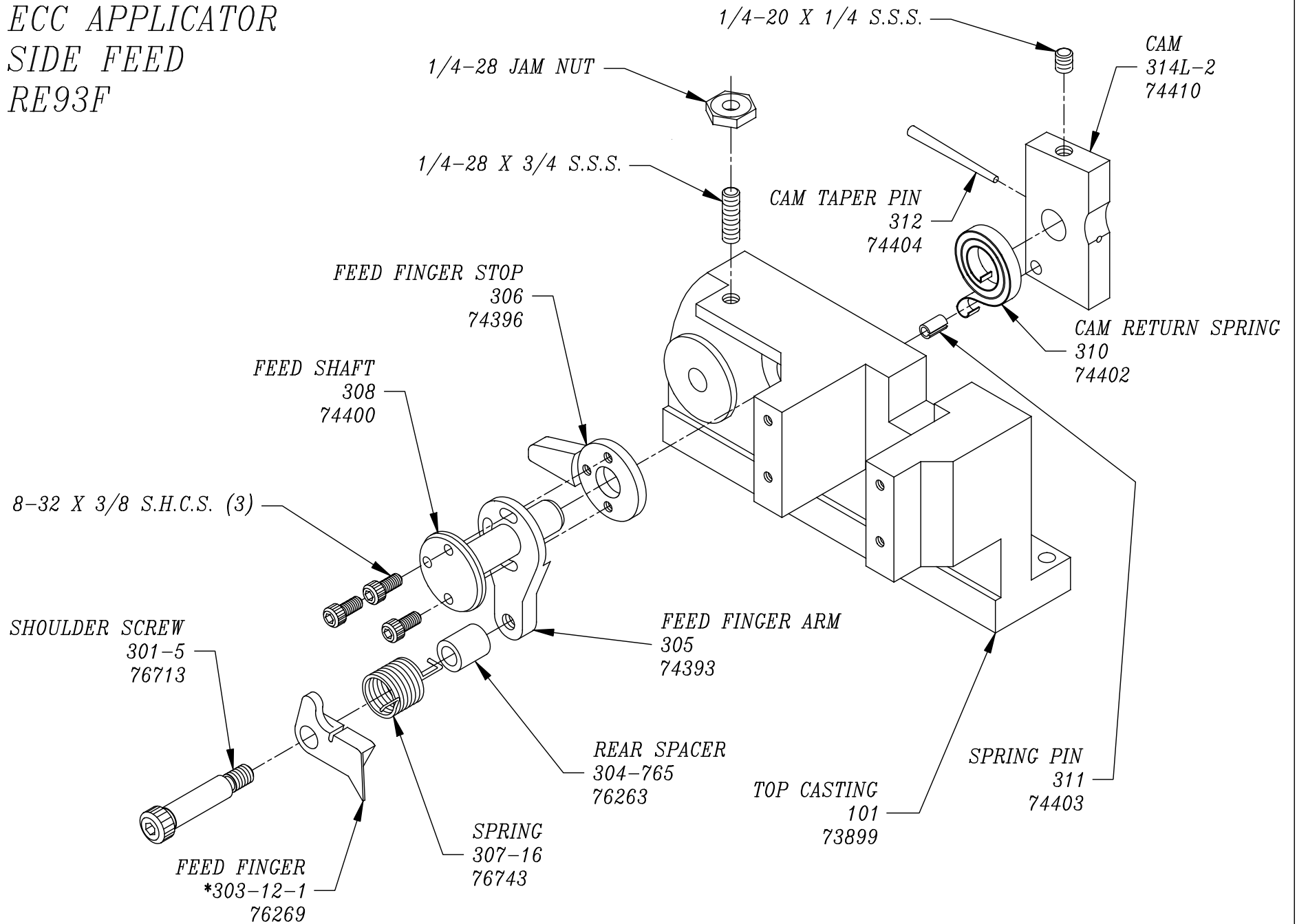

8-32 X 3/8 S.H.C.S.

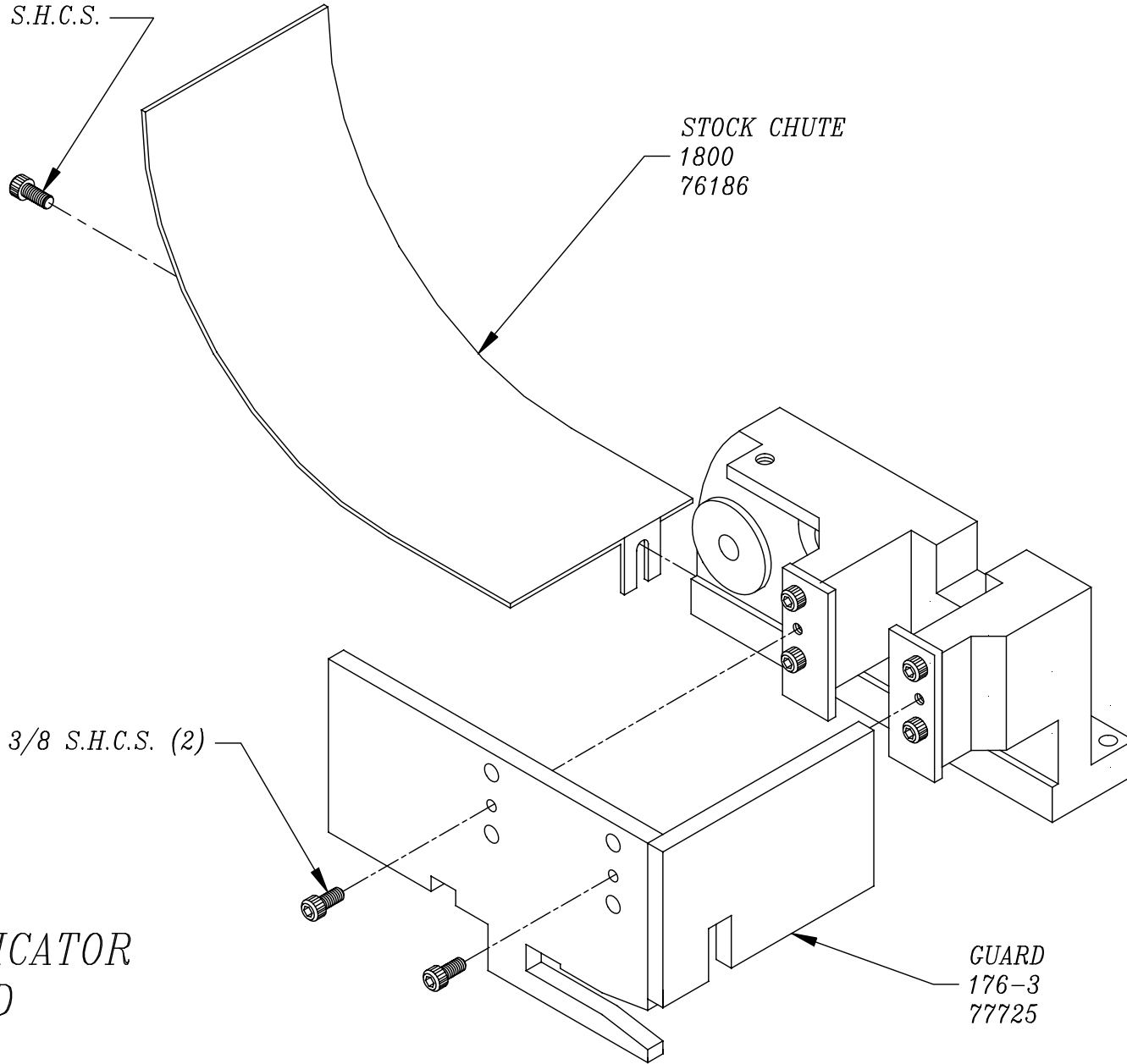

STOCK CHUTE  
1800  
76186

8-32 X 3/8 S.H.C.S. (2)

GUARD  
176-3  
77725

ECC APPLICATOR  
SIDE FEED  
RE93F