



**REFERENCE LIST:
PCB-001
ECC APPLICATOR
BILL OF MATERIAL NUMBER
79827**

**WARNING !
NEVER OPERATE
THIS OR ANY
APPLICATOR
WITHOUT SAFETY
GUARD IN POSITION.**

PART CODE	PART NUMBER	QUANTITY	DESCRIPTION
75630	11-105-FS	(1)	PLUNGER
77918	1102-FS	(1)	FLOATING SHANK
		N/A	CUT-OFF SCREW
75728	1155	(1)	ADJUST SCREW
75725	1150-1	(1)	INSULATION BLOCK
75710	1125	(1)	CAM ROLLER BRACKET
75719	1142	(1)	CAM ROLLER BEARING
73229	15-004	(1)	CUT-OFF PUNCH
72345	*13-005	(1)	WIRE ROLLING TOOL
72982	*14-002	(1)	INSULATION ROLLING TOOL
74410	314-2	(1)	CAM
74403	311	(1)	SPRING PIN
74404	312	(1)	CAM TAPER PIN
74402	310	(1)	CAM RETURN SPRING
74572	101-PCB	(1)	TOP CASTING
76969	169	(2)	UNIVERSAL GIBS
74675	406	(1)	COTTER PIN
74676	407	(1)	BRAKE SPRING
74575	408-.1060	(1)	BRAKE BUSHING
74674	405	(1)	TAPER PIN
74673	404	(1)	BRAKE CAM
70300	403-125-BW	(1)	BRAKE BODY
74496	402	(1)	SPRING RETAINER
74495	401	(1)	BRAKE SHAFT
74396	306	(1)	FEED FINGER STOP
76829	305-1	(1)	FEED FINGER ARM
74400	308	(1)	FEED SHAFT
74569	304-.900	(1)	REAR SPACER
77060	307-20	(1)	SPRING
76717	7A-PCB	(1)	FEED FINGER
70078	302-100	N/A	FRONT SPACER
76923	301-6	(1)	SHOULDER SCREW
		N/A	STRIPPER SPRING
75874	1600-113	(1)	STRIPPER
		N/A	GUIDE SPACER BLOCK
74830	500-141	(1)	REAR GUIDE

**NOTE: ITEMS MARKED WITH AN *
ARE HIGH WEAR ITEMS**



**REFERENCE LIST:
PCB-001
ECC APPLICATOR
BILL OF MATERIAL NUMBER
79827**

**WARNING !
NEVER OPERATE
THIS OR ANY
APPLICATOR
WITHOUT SAFETY
GUARD IN POSITION.**

PART CODE	PART NUMBER	QUANTITY	DESCRIPTION
74573	1000-36	(1)	FRONT GUIDE
74574	250-188	(1)	DIE PLATE
73939	205-1	(1)	BASE PLATE
70141	*8-012	(1)	DIE
70895	*9-005	N/A	ANVIL
70896	*9-006	N/A	ANVIL DIE
76303	*9-348	(1)	ANVIL
77094	*12-180	(1)	CUT-OFF PUNCH
77096	21-032	(1)	CUT-OFF PUNCH RETAINER
73516	3.-026-72	(2)	SPRING
76186	1800	(1)	STOCK CHUTE
74570	GS-.300	(2)	GUARD SPACER
74571	176-PCB	(1)	GUARD
		(1)	10-32 X 1 1/4" S.H.C.S.
		(1)	1/4-28 X 1/2" S.H.C.S.
		(2)	1/8 X 1" DOWEL
		(1)	5/16 X 3/4" SHOULDER SCREW
		(1)	1/4-28 X 3/4" S.S.S.
		(2)	1/4-20 X 1" S.H.C.S.
		(2)	1/4 X 1" DOWEL
		(1)	1/4-28 JAM NUT
		(1)	1/4-20 X 1/4" S.H.C.S.
		(5)	8-32 X 3/8" S.H.C.S.
		(1)	10-32 X 7/8" S.H.C.S.
		(2)	8-32 X 1" S.H.C.S.
		(12)	8-32 X 1/2" S.H.C.S.
		(2)	1/8 X 1/2" DOWEL
		(2)	1/4-20 X 1/4" S.S.S.
		(1)	5-40 X 5/16" S.S.S.

**NOTE: ITEMS MARKED WITH AN *
ARE HIGH WEAR ITEMS**

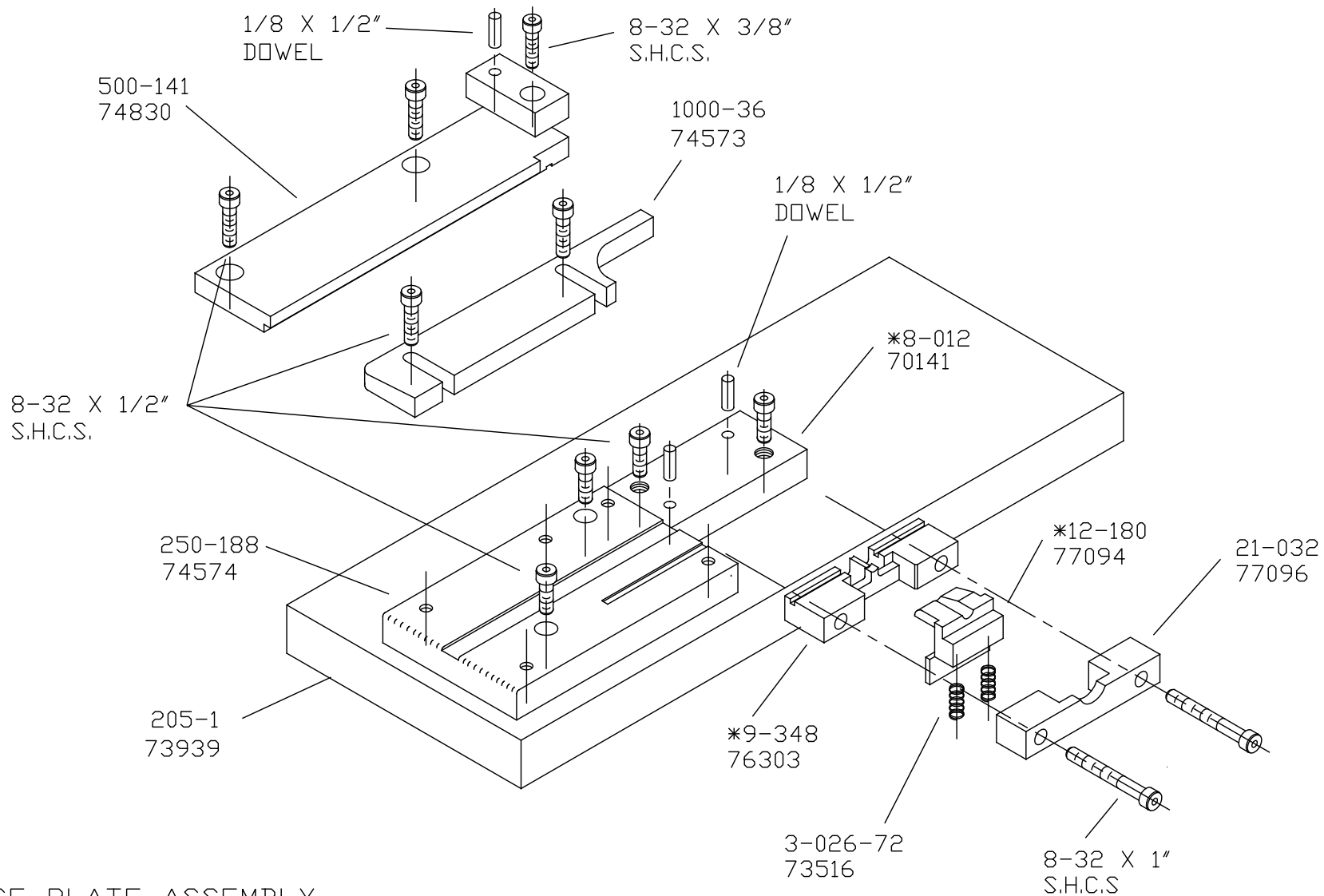

BASE PLATE ASSEMBLY
 SIDE FEED
 PCB-001

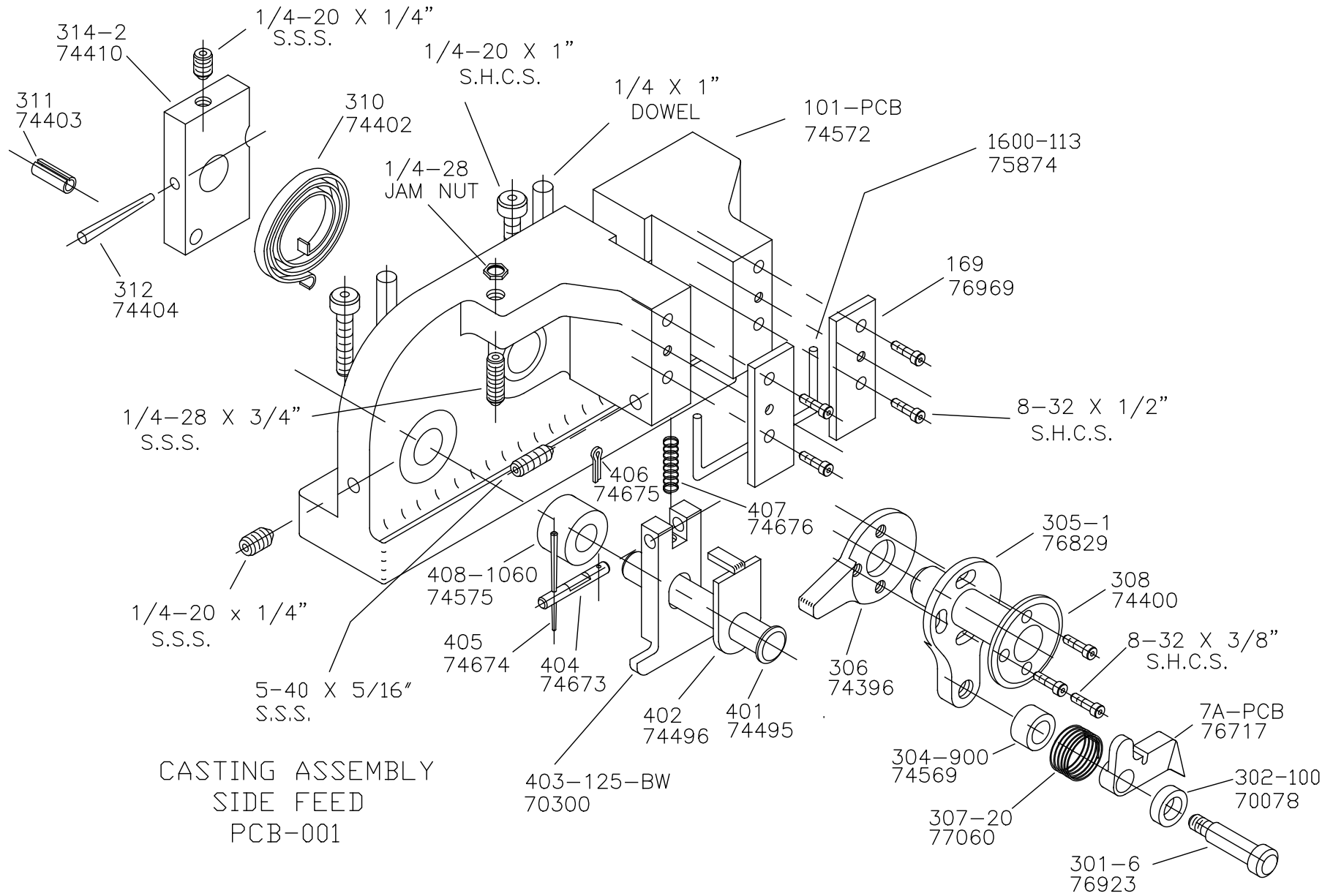

*ECC APPLICATOR
SIDE FEED
PCB-002*

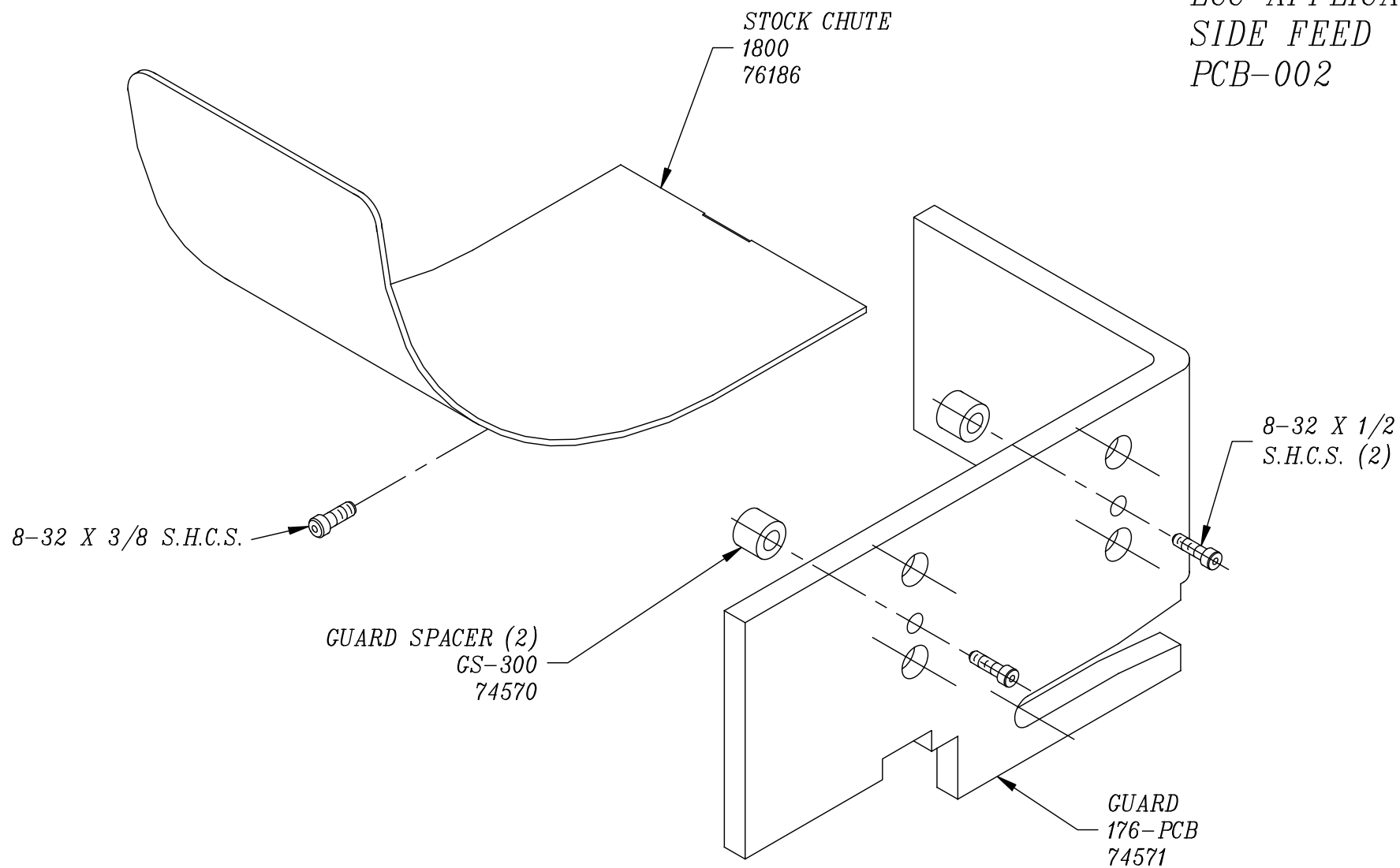

NEVER OPERATE APPLICATOR WITHOUT
SAFETY GUARD IN POSITION.

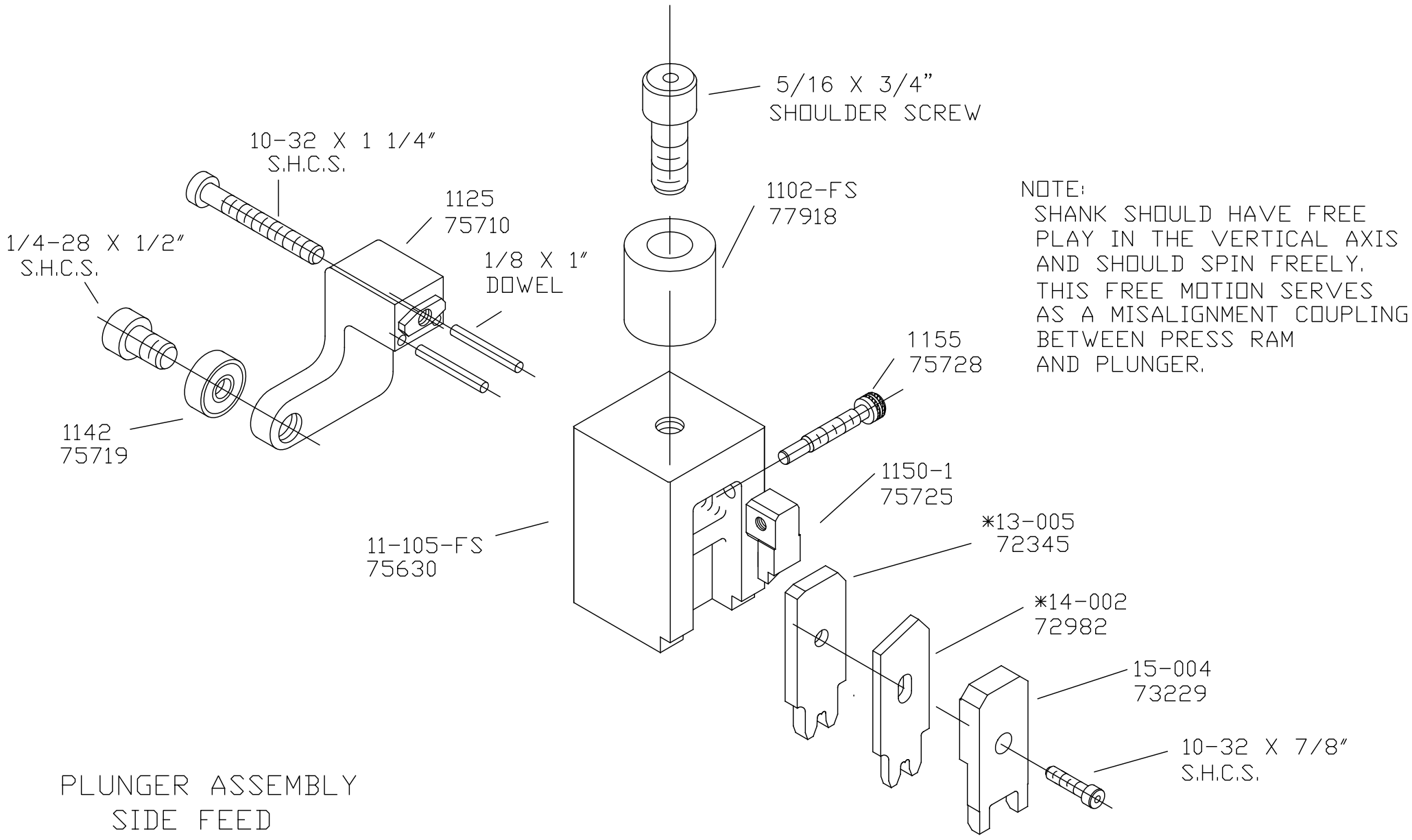

NOTE:
SHANK SHOULD HAVE FREE
PLAY IN THE VERTICAL AXIS
AND SHOULD SPIN FREELY.
THIS FREE MOTION SERVES
AS A MISALIGNMENT COUPLING
BETWEEN PRESS RAM
AND PLUNGER.

PLUNGER ASSEMBLY
SIDE FEED
PCB-001