



**REFERENCE LIST:
R24E, R28E "BUTT CRIMP"
ECC APPLICATOR
BILL OF MATERIAL NUMBER
79868**

**WARNING !
NEVER OPERATE
THIS OR ANY
APPLICATOR
WITHOUT SAFETY
GUARD IN POSITION.**

PART CODE	PART NUMBER	QUANTITY	DESCRIPTION
75631	11-106-FS	(1)	PLUNGER
77918	1102-FS	(1)	FLOATING SHANK
75728	1155	(1)	ADJUSTING BLOCK SCREW
75724	1150	(1)	INSULATION BLOCK
71584	*12-011	(1)	CUT-OFF PUNCH
73810	17-270	(1)	SPACER
77950	*13-534	(1)	WIRE ROLLING TOOL
		N/A	TOOL RETAINER
73090	*14-D160-1	(1)	INSULATION ROLLING TOOL
75713	11B1	(1)	CAM ROLLER BRACKET
75719	1142	(1)	CAM ROLLER BEARING
74421	314-9	(1)	CAM BODY
77106	312-1	(1)	CAM TAPER PIN
74402	310	(1)	CLOCK SPRING
73706	311-1	(1)	ROLL PIN
76969	169	(2)	UNIVERSAL GIBS
		N/A	GIB
73966	1600-278	(1)	WIRE STRIPPER
73903	101-35	(1)	TOP CASTING
73216	408-720	(1)	BRAKE BUSHING
74676	407	(1)	SPRING
74675	406	(1)	COTTER PIN
74674	405	(1)	BRAKE TAPER PIN
74673	404	(1)	BRAKE CAM
74535	403-35	(1)	BRAKE BODY
74496	402	(1)	BRAKE SPRING RETAINER
74495	401	(1)	BRAKE SHAFT
74396	306	(1)	FEED FINGER STOP
74393	305	(1)	FEED FINGER ARM
73214	304-340	(1)	REAR SPACER
74400	308	(1)	FEED SHAFT
76788	307-5	(1)	SPRING
74334	303-9	(1)	FEED FINGER
73399	302-160	(1)	FRONT SPACER
76873	301-4	(1)	SHOULDER SCREW
73808	10R-R22E	(1)	RIGHT GUIDE
73809	10L-R22E	(1)	LEFT GUIDE

**NOTE: ITEMS MARKED WITH AN *
ARE HIGH WEAR ITEMS**

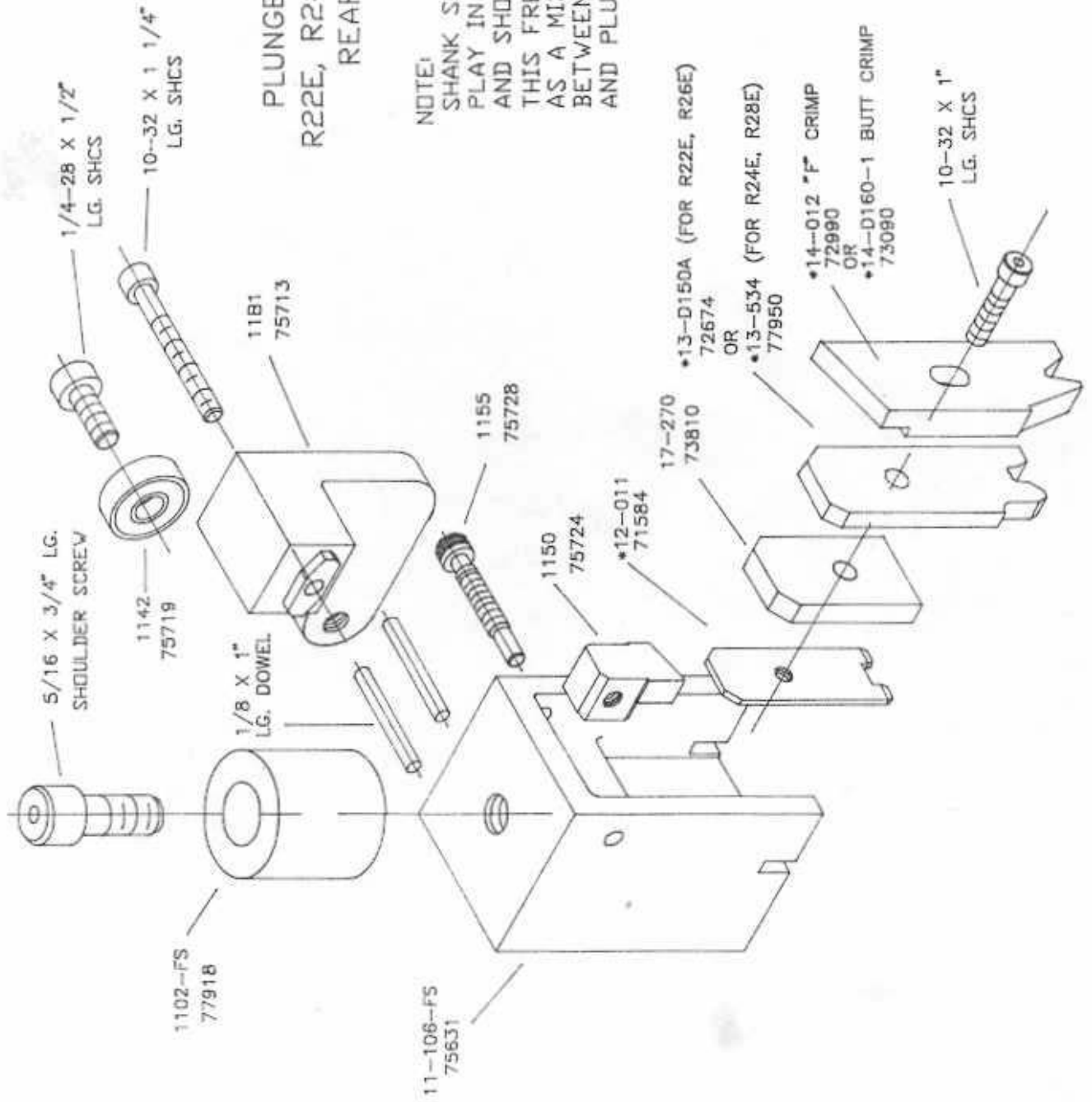

PLUNGER ASSEMBLY
R22E, R24E, R26E, R28E
REAR FEED

NOTE:
SHANK SHOULD HAVE FREE
PLAY IN THE VERTICAL AXIS
AND SHOULD SPIN FREELY.
THIS FREE MOTION SERVES
AS A MISALIGNMENT COUPLING
BETWEEN PRESS RAM
AND PLUNGER.

BASE PLATE ASSEMBLY
R22E, R24E, R26E, R28E
REAR FEED

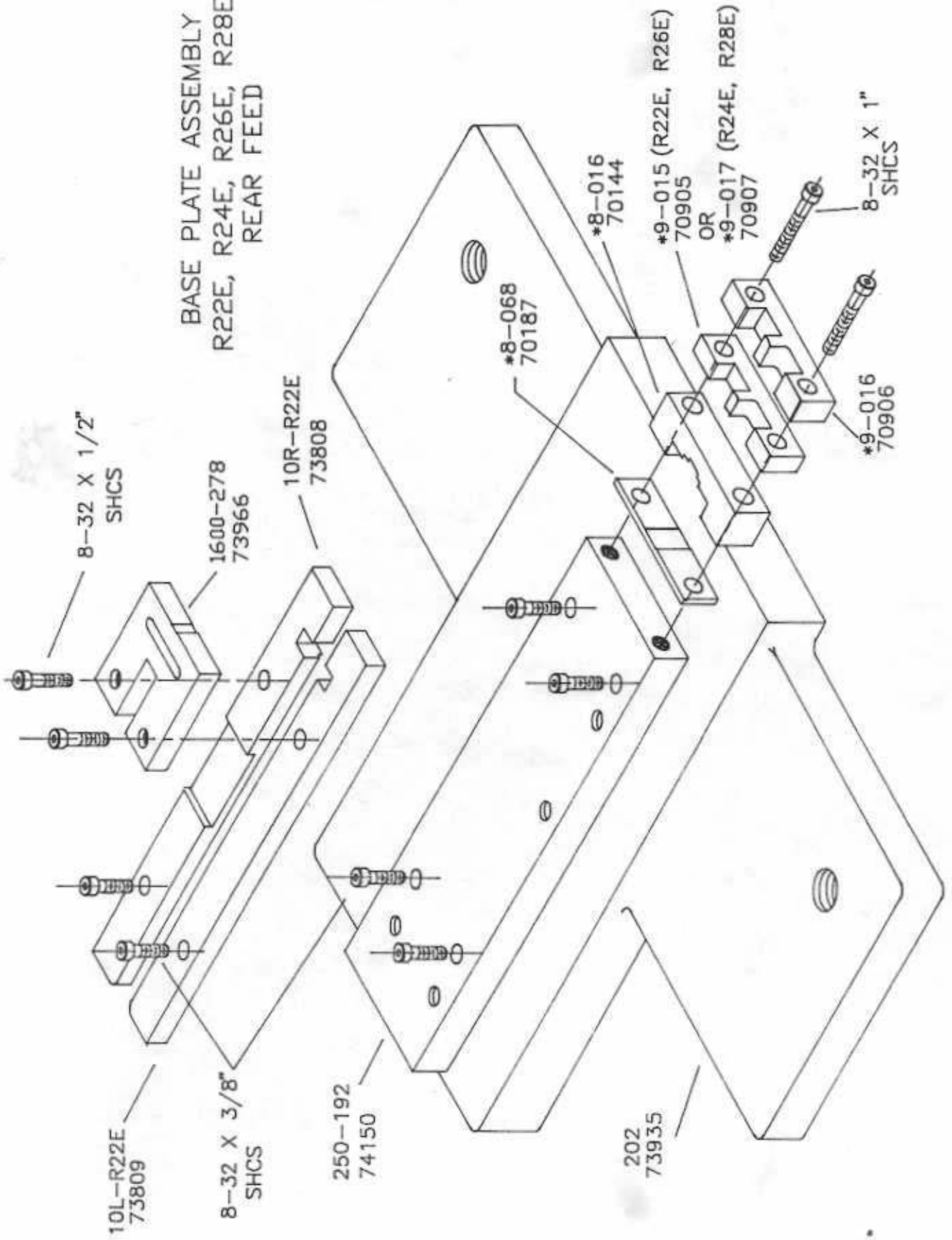

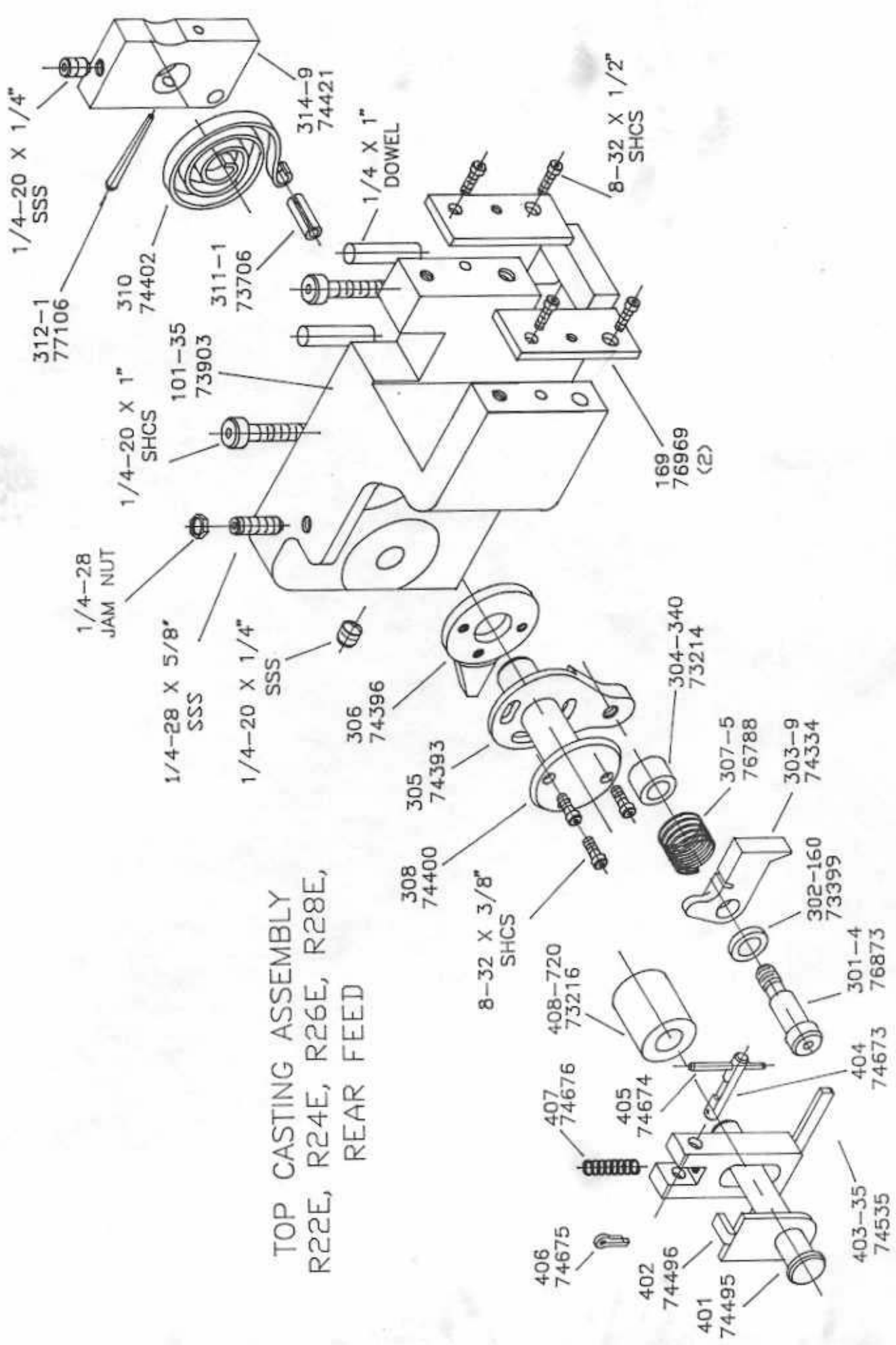

TOP CASTING ASSEMBLY
 R22E, R24E, R26E, R28E,
 REAR FEED

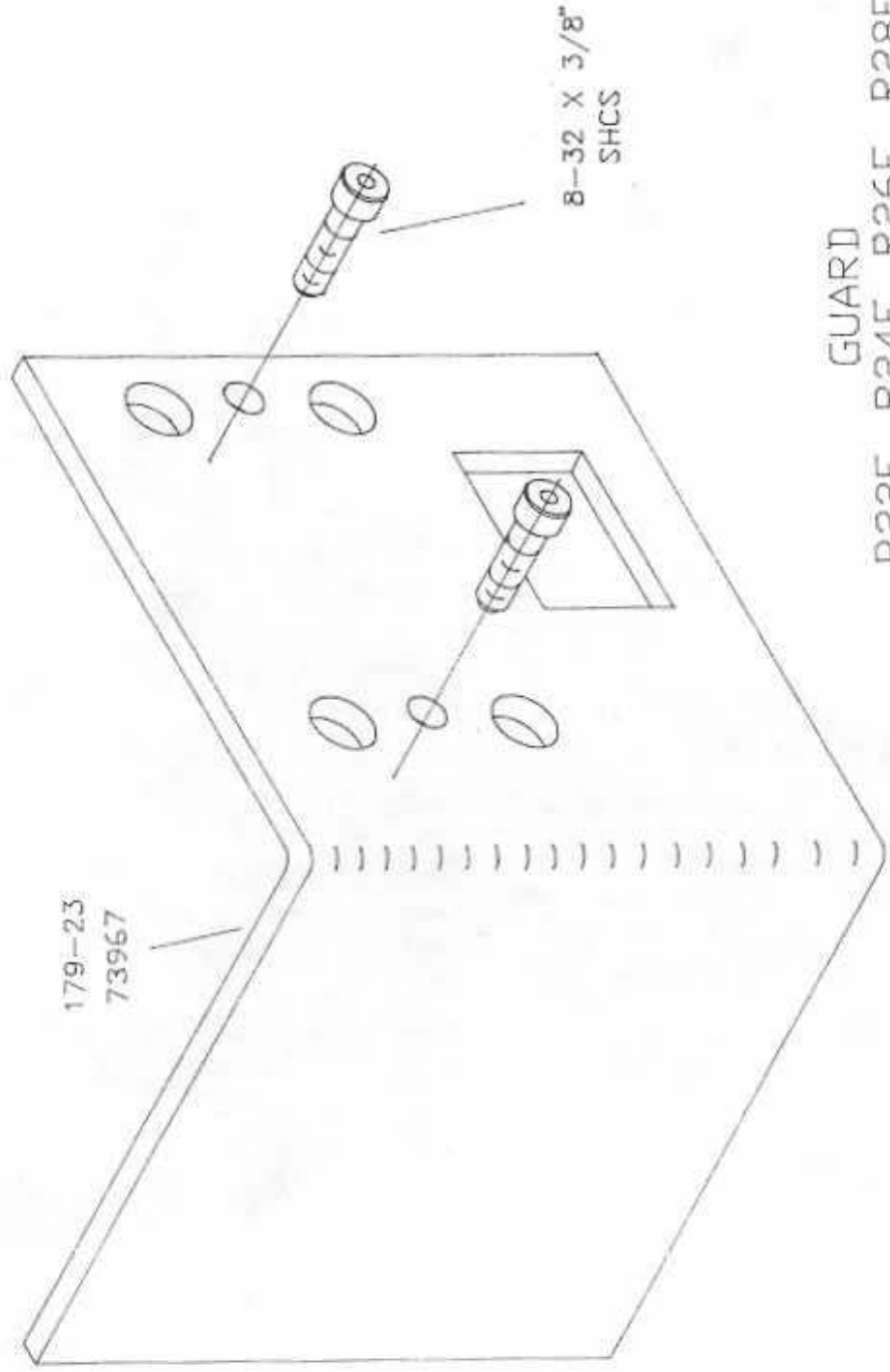

NEVER OPERATE APPLICATOR WITHOUT
SAFETY GUARD IN POSITION.

GUARD
R22E, R24E, R26E, R28E