



**REFERENCE LIST:  
D160E, D162E  
D167E  
ECC APPLICATOR  
BILL OF MATERIAL NUMBER  
79886  
REV A**

**WARNING !**  
NEVER OPERATE  
THIS OR ANY APPLICATOR  
WITHOUT SAFETY GUARD  
IN POSITION.

| PART CODE | PART NUMBER | QUANTITY | DESCRIPTION                                     |
|-----------|-------------|----------|---|
| 75580     | 11060-FS    | (1)      | PLUNGER   |
| 77918     | 1102-FS     | (1)      | FLOATING SHANK                                  |
| 75728     | 1155        | (1)      | ADJUST BLOCK SCREW                              |
| 75725     | 1150-1      | (1)      | INSULATION BLOCK                                |
| 71855     | *12-D154E   | (1)      | CUT-OFF PUNCH                                   |
| 72376     | *13-038     | (1)      | WIRE ROLLING TOOL                               |
| 71552     | *13-356     | (1)      | WIRE ROLLING TOOL<br>(OVERLAP CRIMP) (OPTIONAL) |
| 77508     | 17-040      | (1)      | SPACER  |
| 73140     | *14-DM265   | (1)      | INSULATION ROLLING TOOL                         |
| 75713     | 11B1        | (1)      | CAM ROLLER BRACKET                              |
| 75719     | 1142        | (1)      | CAM ROLLER BEARING                              |
| 74422     | 314L-9A     | (1)      | CAM BODY  |
| 77106     | 312-1       | (1)      | CAM TAPER PIN                                   |
| 74402     | 310         | (1)      | CLOCK SPRING                                    |
| 73706     | 311-1       | (1)      | ROLL PIN  |
| 76969     | 169         | (2)      | UNIVERSAL GIB                                   |
| 74073     | 1600-281    | (1)      | WIRE STRIPPER/STOP                              |
| 75029-    | 101-111     | (1)      | TOP CASTING                                     |
| 73216     | 408-720     | (1)      | BRAKE SPACER                                    |
| 74676     | 407         | (1)      | SPRING  |
| 74675     | 406         | (1)      | COTTER PIN                                      |
| 74674     | 405         | (1)      | TAPER PIN                                       |
| 74673     | 404         | (1)      | BRAKE CAM                                       |
| 73034     | 403-195     | (1)      | BRAKE BODY                                      |
| 74496     | 402         | (1)      | BRAKE SPRING RETAINER                           |
| 74495     | 401         | (1)      | BRAKE SHAFT                                     |
| 77049     | 306-1       | (1)      | FEED FINGER STOP                                |
| 74393     | 305         | (1)      | FEED FINGER ARM                                 |
| 77736     | 304-365     | (1)      | REAR SPACER                                     |
| 74400     | 308         | (1)      | FEED SHAFT                                      |
| 76859     | 307-6       | (1)      | SPRING  |
| 70091     | 7A-D154E    | (1)      | FEED FINGER                                     |
| 77735     | 302-135     | (1)      | FRONT SPACER                                    |
| 76873     | 301-4       | (1)      | SHOULDER SCREW                                  |
| 73035     | 500-166-2   | (1)      | RIGHT GUIDE                                     |

**NOTE: ITEMS MARKED WITH AN \*  
ARE HIGH WEAR ITEMS**



**REFERENCE LIST:**  
**D160E, D162E**  
**D167E**  
**ECC APPLICATOR**  
**BILL OF MATERIAL NUMBER**  
**79886**  
**REV A**

**WARNING !**  
 NEVER OPERATE  
 THIS OR ANY APPLICATOR  
 WITHOUT SAFETY GUARD  
 IN POSITION.

| PART CODE | PART NUMBER                 | QUANTITY | DESCRIPTION                |
|-----------|-----------------------------|----------|----------------------------|
| 73036     | 1000-52-2                   | (1)      | LEFT GUIDE                 |
| 70183     | *8-061                      | (1)      | DIE                        |
| 70187     | *8-068                      | (1)      | DIE                        |
| 70943     | *9-055                      | (1)      | INSULATION ANVIL           |
| 70952     | *9-064                      | (1)      | WIRE ANVIL                 |
| 74150     | 250-192                     | (1)      | DIE PLATE                  |
| 73935     | 202                         | (1)      | BASE PLATE                 |
|           | McMaster Carr<br>#98407a118 | (2)      | E-STYLE RETAINING RING     |
| 77512     | GS-060                      | (2)      | GUARD SPACER               |
| 73967     | 179-23                      | (1)      | GUARD                      |
|           |                             | (11)     | 8-32 X 3/8" S.H.C.S.       |
|           |                             | (1)      | 8-32 X 3/8" S.S.S.         |
|           |                             | (6)      | 8-32 X 1/2" S.H.C.S.       |
|           |                             | (2)      | 8-32 X 1" S.H.C.S.         |
|           |                             | (1)      | 10-32 X 1" S.H.C.S.        |
|           |                             | (1)      | 10-32 X 1 1/2" S.H.C.S.    |
|           |                             | (2)      | 1/4-20 X 1/4" S.S.S.       |
|           |                             | (2)      | 1/4-20 X 1" S.H.C.S.       |
|           |                             | (1)      | 1/4-28 X 1/2" S.H.C.S.     |
|           |                             | (1)      | 1/4-28 X 3/4" S.S.S.       |
|           |                             | (2)      | 1/4 X 1" DOWEL             |
|           |                             | (1)      | 1/4-28 JAM NUT             |
|           |                             | (1)      | 5/16 X 3/4" SHOULDER SCREW |
|           |                             | (2)      | 1/8 X 1" DOWEL             |
|           |                             |          |                            |
|           |                             |          |                            |
|           |                             |          |                            |
|           |                             |          |                            |
|           |                             |          |                            |
|           |                             |          |                            |
|           |                             |          |                            |

**NOTE: ITEMS MARKED WITH AN \***  
**ARE HIGH WEAR ITEMS**

*ECC APPLICATOR  
REAR FEED  
D160E/D162E  
D167E/51296*

8-32 X 3/8 S.H.C.S. (2)

8-32 X 1/2 S.H.C.S. (2)

*LEFT GUIDE  
1000-52-2  
73036*

*WIRE STOP/STRIPPER  
1600-281  
74073*

*RIGHT GUIDE  
500-166-2  
73035*

*FEED PLATE  
250-192  
74150*

8-32 X 1/2 S.H.C.S. (4)

*DIE  
\*8-068  
70187*

*WIRE ANVIL  
\*9-064  
70952*

*INSULATION ANVIL  
\*9-055  
70943*

*BASE PLATE  
202  
73935*

*DIE  
\*8-061  
70183*

8-32 X 1 S.H.C.S. (2)

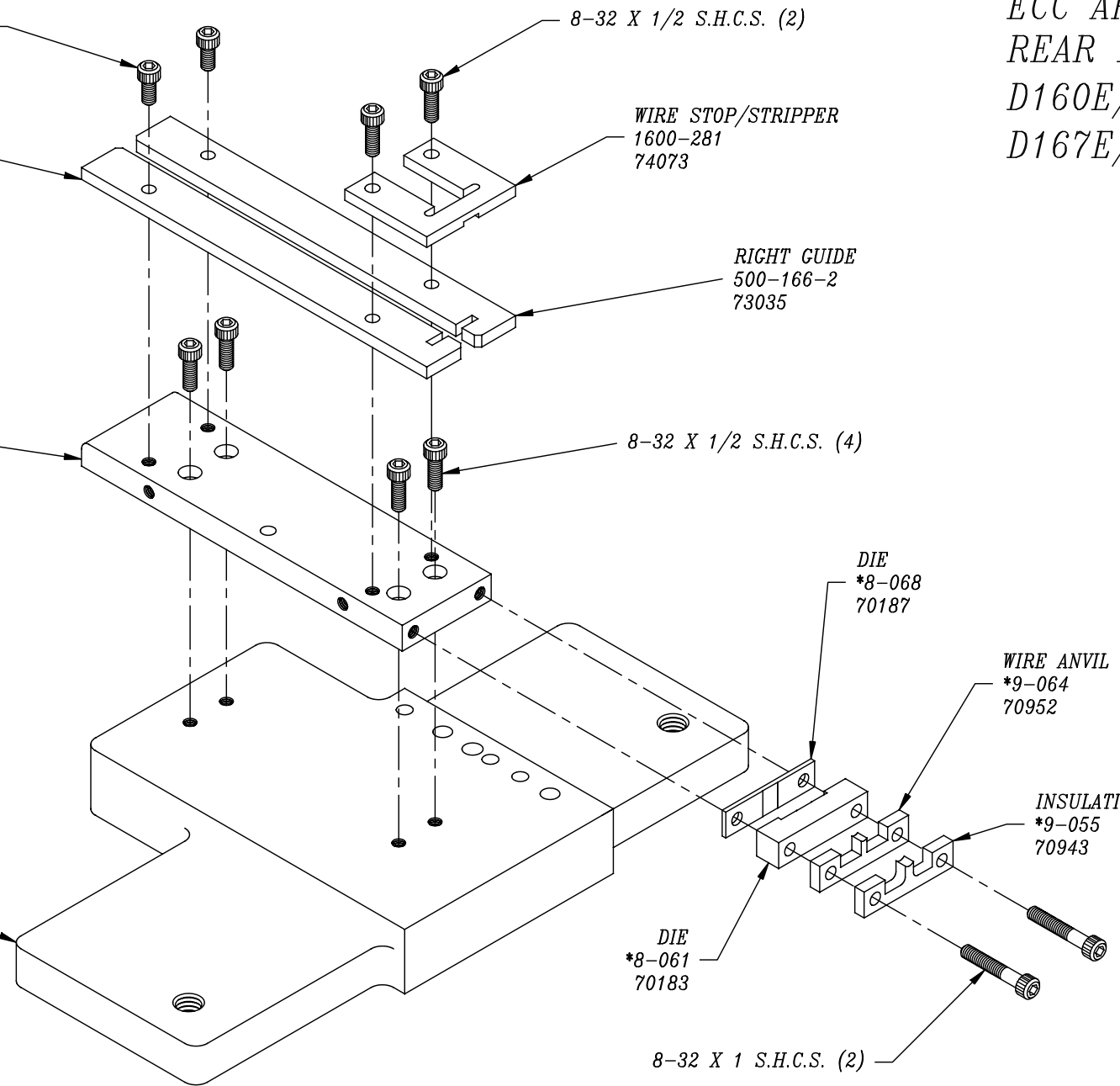

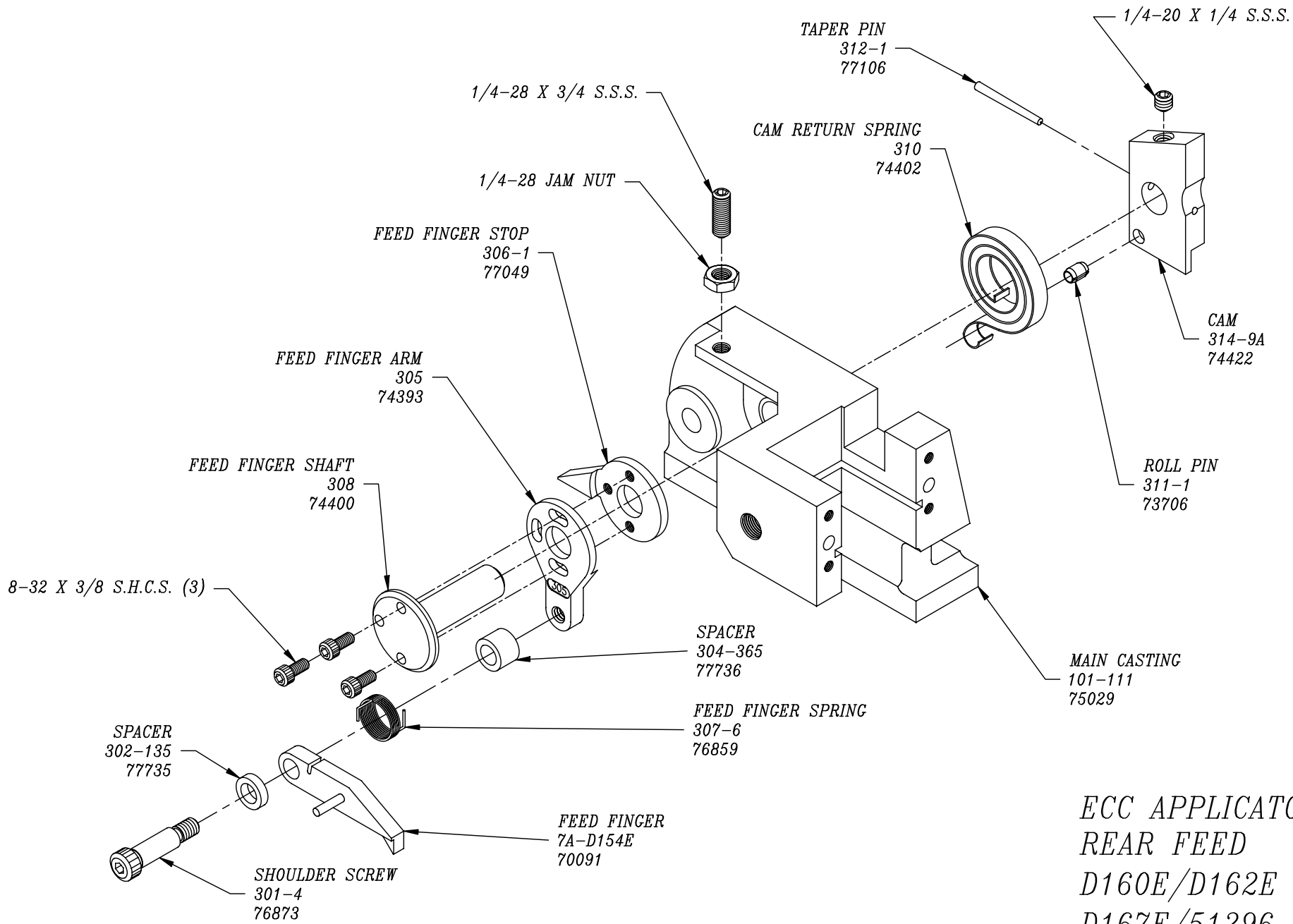

ECC APPLICATOR  
 REAR FEED  
 D160E/D162E  
 D167E/51296

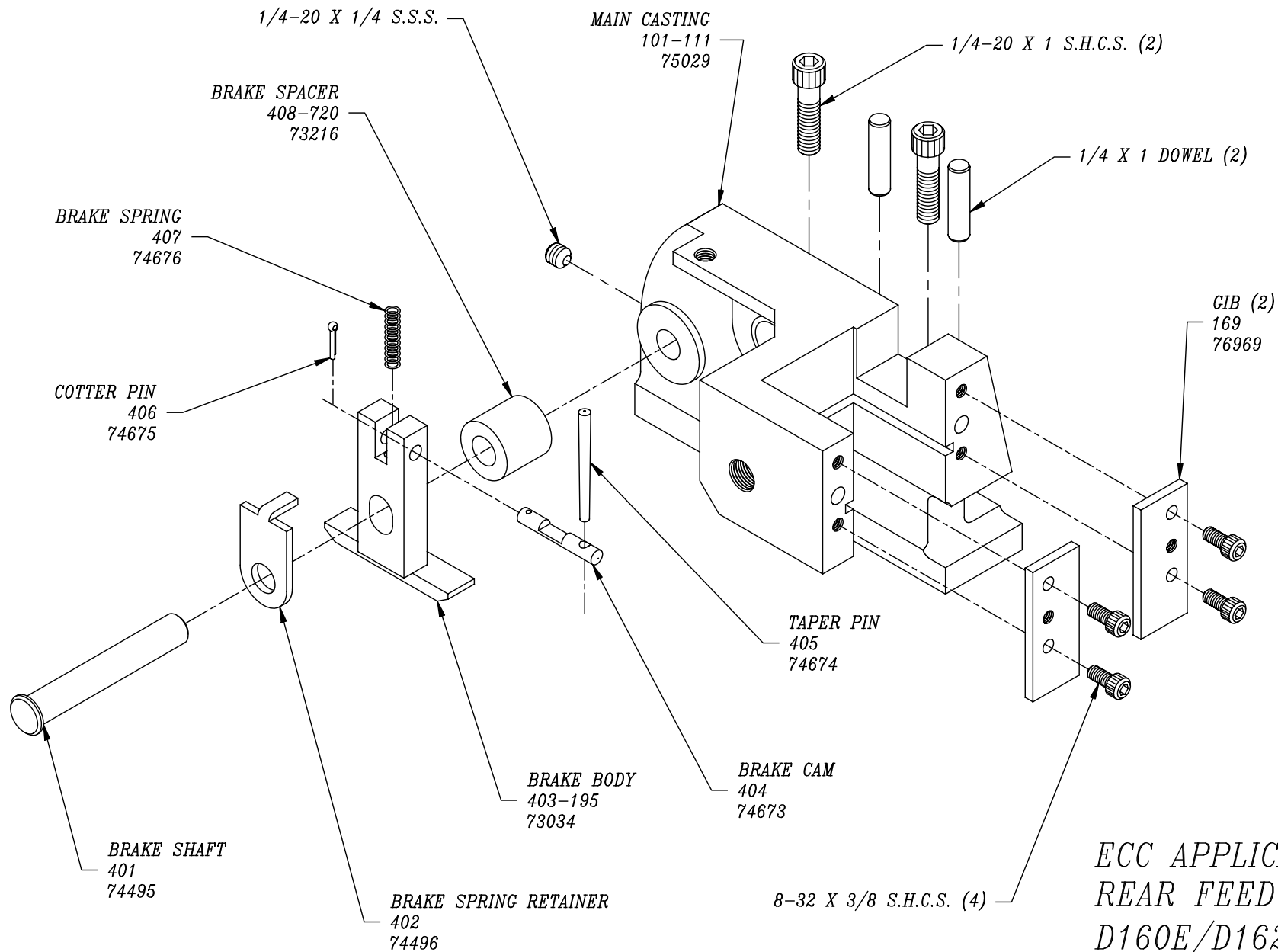

ECC APPLICATOR  
 REAR FEED  
 D160E/D162E  
 D167E/51296

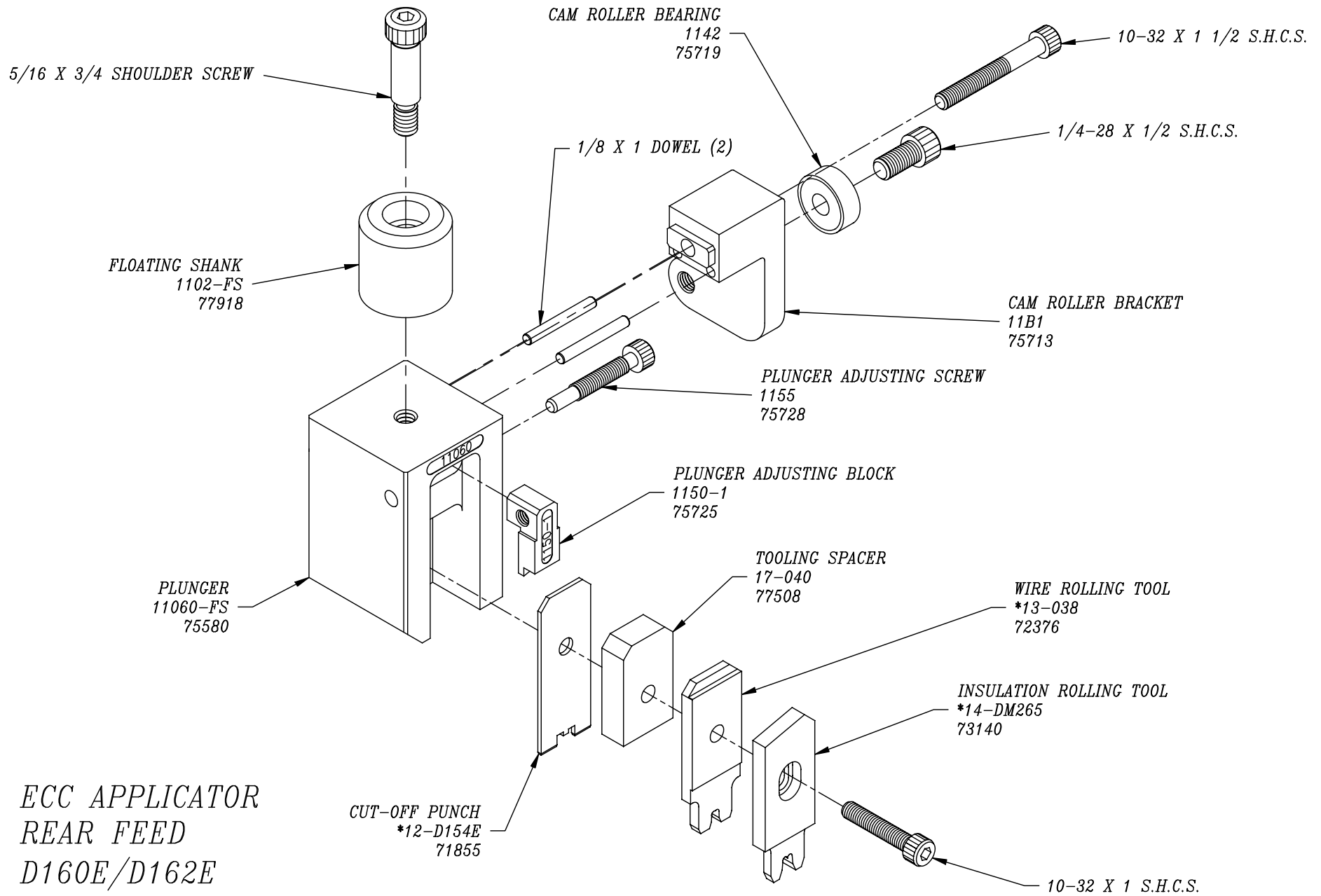

ECC APPLICATOR  
 REAR FEED  
 D160E/D162E  
 D167E/51296

*E-STYLE RETAINING RING (2)*  
98407A118  
75083

*GUARD SPACER (2)*  
GS-060  
77512

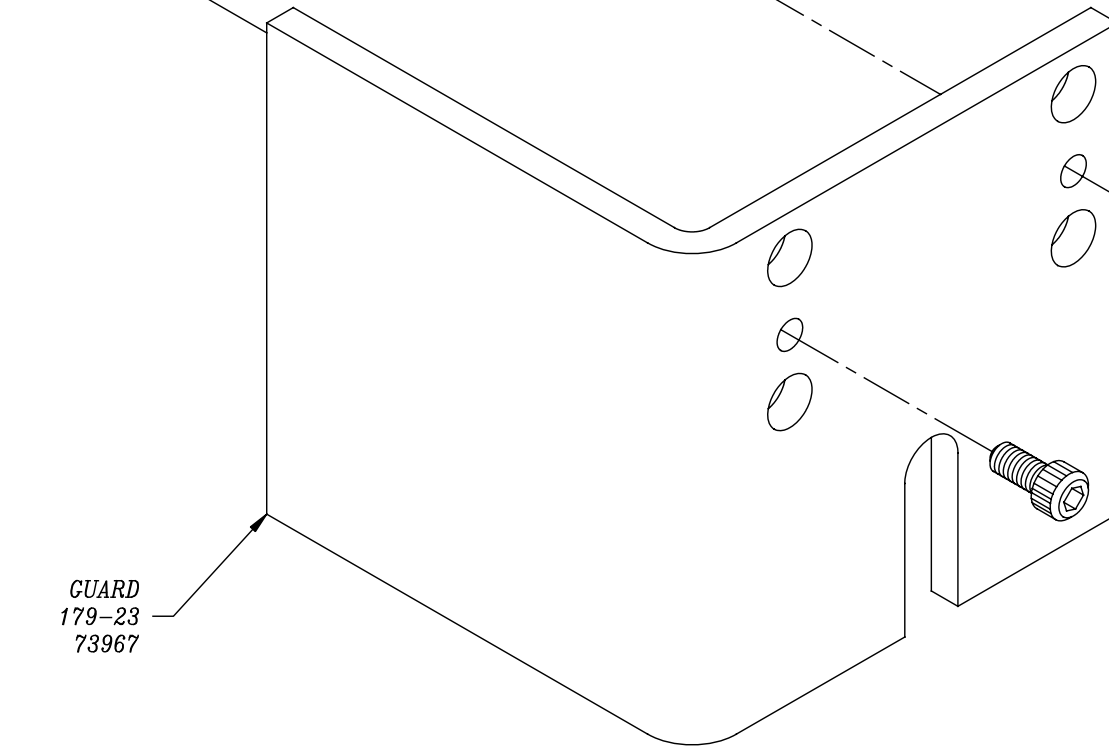
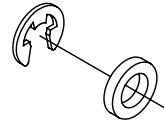

*GUARD*  
179-23  
73967

*8-32 X 3/8 S.H.C.S. (2)*

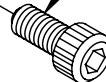

*ECC APPLICATOR  
REAR FEED  
D160E/D162E  
D167E/51296*