

MX Mini Die Side for UB3
BOM #79972

Parts List				
Item No.	QTY.	Part Code	Part No.	Description
1	1	74287	8-3000	Cut-off Pad Retainer
2	1	62052	9-3113-2	Anvil
3	1	74286	12-3000	Rear cut-off pad
4	1	62051	13-3113-2	Wire Rolling Tool
5	1	72883	15-3003-1	Cut-off Pad Driver
6	1	78682	15-3097	Driver
7	1	72882	15A-3003-1	Knock-off
8	1	77265	26-3088	Locking Screw
9	1	78694	34-3097	Wire Crimp Dial
10	1	76403	199-3005	Safety Guard
11	1	78680	200-3097	Base Plate
12	1	78700	250-3097	Feed Plate
13	1	75776	303-3019	Feed Finger
14	1	78696	500-3097	Rear Guide Rail
15	2	74491	GS-375	Guard Spacer
16	1	71029	MX2A-S	Mounting Frame
17	1	71030	MX2B-S	Plunger Frame
18	1	74343	MX3	Ram
19	1	74344	MX4-S	Cam (1 5/8" Up Stroke)
20	1	74438	MX5-S	Cam Rack
21	1	74346	MX6	Gear Arm
22	1	74347	MX7	Cam Pin
23	1	74350	MX8	Cam Roller
24	2	74351	MX10-S	Rack Pad
25	2	74352	MX11	Gib
26	1	74356	MX12	Feed Finger Pivot Pin
27	1	74360	MX13	Adjusting Bar
28	1	74361	MX14-S	Feed Finger Arm
29	1	74362	MX15-S	Feed Finger Guide
30	1	74364	MX16	Retainer
31	1	74371	MX18-S	Swing Arm
32	1	74376	MX25	Stroke Adjustment Screw
33	1	72643	MX28-2-S	Front Guide Rail
34	1	74384	MX29-S	Slide Support
35	1	74388	MX30-S	Support Anchor
36	1	74390	MX32-S	Support Cover
37	1	74407	MX33	Mounting Post
38	1	74409	MX35	Insulation Dial
39	1	74411	MX36	Dial Spacer
40	1	74412	MX44	Locating Dowel
41	1	74415	MX45-S	Feed Finger Spring
42	1	74416	MX47-S	Cam (1 5/8" Down stroke)
43	1	74417	MX48-S	Cam (1 1/8" Up Stroke)
44	3	74419	MX50	Safety Pivot Pin
45	2	74420	MX52	Pivot Pin
46	1	74425	MX84-S	Brake Cam
47	1	74426	MX85-S	Cam Pivot Pin
48	1	74428	MX86-S	Brake Shoe
49	1	75178	MX87-S	Lift Arm
50	1	74430	MX88-S	Lever
51	1	74614	MX90-S	Spring Bracket
52	1	72310	MX104	Wave Disc Spring
53	1	78681	LC-029B-3-M	Compression Spring
54	1	74611	LE-037CD-6	Extension Spring
55	2	77322	LC-045E-10-M	Spring
56	1	74578	4-034-875	Spring
57	2	75083	Irving 3100-18	External Retaining Ring
58	2	70739	McMaster-Carr #3126A53	Spring Plunger
59	2	72519	McMaster Carr #98029A043	#8 Hardened Washer
60	1	74447	McMaster-Carr #98296A109	Expansion Pin (1/16 x 1/2")
61	2	73785	SPI 99-602-5	#10 Black Knurled Knob
62	1	62040	1.8_1.00rp	1/8" x 1" Roll Pin

Parts List				
Item No.	QTY.	Part Code	Part No.	Description
63	2	63792	6-32_25bh	#6-32 x 1/4" Button Hd Cap Screw
64	7	63207	6-32_25sh	#6-32 x 1/4" Socket Hd Cap Screw
65	2	63209	6-32_38sh	#6-32 x 3/8" Socket Hd Cap Screw
66	1	63210	8fw	#8 Flatwasher
67	1	60265	8-32_19sh	#8-32 x 3/16" Socket Hd Cap Screw
68	2	63163	8-32_25sh	#8-32 x 1/4" Socket Hd Cap Screw
69	3	61472	8-32_38bh	#8-32 x 3/8" Button Hd Cap Screw
70	2	63052	8-32_50fh	#8-32 x 1/2" Flat Hd Cap Screw
71	4	63158	3.16_50dp	Φ 3/16" x 1/2" Dowel Pin
72	4	63470	3.16_75dp	Φ 3/16" x 3/4" Dowel Pin
73	2	63054	10-32_25ss	#10-32 x 1/4" Socket Hd Set Screw
74	1	78993	10-32_38bh	#10-32 x 3/8" Button Hd Cap Screw
75	1	70110	10-32_38sh	#10-32 x 3/8" Socket Hd Cap Screw
76	4	71626	10-32_38ss	#10-32 x 3/8" Socket Hd Set Screw
77	2	76501	10-32_50bh	#10-32 x 1/2" Button Hd Cap Screw
78	6	63056	10-32_50sh	#10-32 x 1/2" Socket Hd Cap Screw
79	1	70293	10-32_63sh	#10-32 x 5/8" Socket Hd Cap Screw
80	2	63532	10-32_75sh	#10-32 x 3/4" Socket Hd Cap Screw
81	2	70925	10-32_88sh	#10-32 x 7/8" Socket Hd Cap Screw
82	1	77396	10-32_1.25sh	#10-32 x 1 1/4" Socket Hd Cap Screw
83	2	63826	10-32_1.50sh	#10-32 x 1 1/2" Socket Hd Cap Screw
84	3	63632	1.4-20_50bh	1/4-20 x 1/2" Button Hd Cap Screw
85	2	63827	1.4_50dp	Φ 1/4" x 1/2" Dowel Pin
86	2	63510	1.4_1.00dp	1/4 x 1" Dowel Pin
87	1	63055	5.16-18_1.00bh	5/16-18 x 1" Button Hd Cap Screw

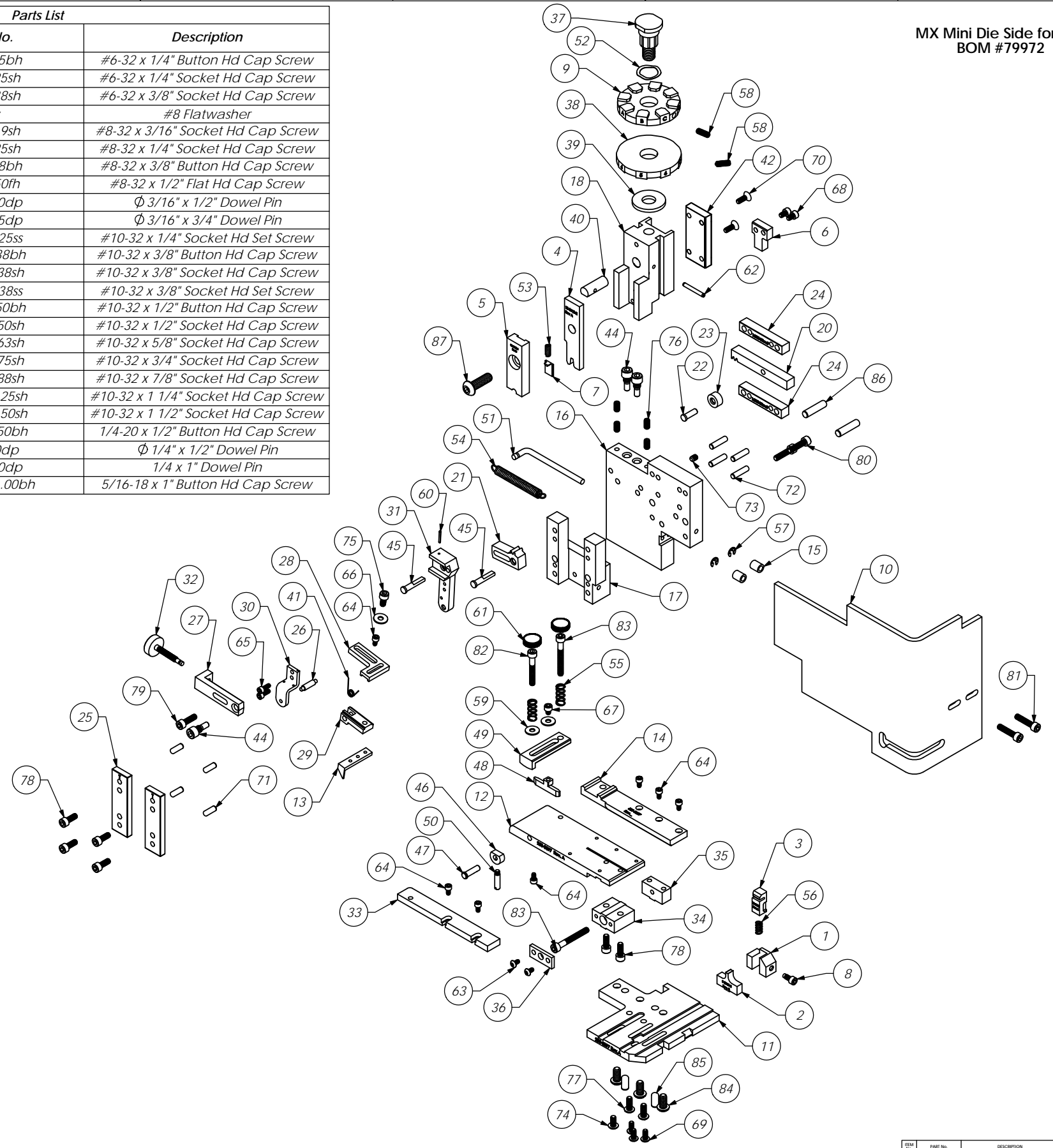

Note:
Items marked in bold italic are high wear tooling.

ITEM NO.	PART NO.	DESCRIPTION	MATERIAL SPECIFICATION	QTY.	REVISION
See Parts List					
UB3					
SURFACE FINISH: ALL OVER					
UNLESS OTHERWISE SPECIFIED DIMENSIONS ARE IN INCHES. TOLERANCES ARE FRACTIONAL DECIMALS ANGLES					
1/64 XX .01 1/8"					
.0005 XXX .001 .0002					
DO NOT SCALE DRAWING					
THE INFORMATION CONTAINED WITHIN THIS DRAWING IS THE SOLE PROPERTY OF ETICO ENGINEERED PRODUCTS AND IS TO BE USED ONLY FOR THE PURPOSES AND FOR WHICH IT WAS DESIGNED. ANY REPRODUCTION OR USE OF THIS INFORMATION WITHOUT THE WRITTEN PERMISSION OF ETICO ENGINEERED PRODUCTS IS PROHIBITED.					
DATE: 7/16/13		BY: SCJ		REV: 1	
APPRECIATION		SCALE: 1:8		DATE: 17Aug07	