

RED109 (Edge MF)
90009

ITEM NO.	QTY.	Part_Code	PART NUMBER	DESCRIPTION	ITEM NO.	QTY.	Part_Code	PART NUMBER	DESCRIPTION
1	1	74287	8-3000	Cut-off Pad Retainer	59	1	62040	1.8_1.00rp	1/8" x 1" Roll Pin
2	1	75112	8-3009	*Cut-off Die	60	2	63792	6-32_.25bh	#6-32 x 1/4" Button Hd Cap Screw
3	1	72327	9-3065	Anvil	61	6	63207	6-32_.25sh	#6-32 x 1/4" Socket Hd Cap Screw
4	1	74286	12-3000	Rear cut-off pad	62	1	60265	8-32_.19sh	#8-32 x 3/16" Socket Hd Cap Screw
5	1	72329	13-3065	Wire Rolling Tool	63	1	77097	8-32_.31bh	#8-32 x 5/16" Button Hd Cap Screw
6	1	75801	15-3024	Punch Driver	64	2	63161	8-32_.38sh	#8-32 x 3/8" Socket Hd Cap Screw
7	4	75770	26-3020	#8-32 x 3/8" BHCS (Modified)	65	2	63162	8-32_.63sh	#8-32 x 5/8" Socket Hd Cap Screw
8	1	77265	26-3088	Locking Screw	66	1	63753	10fw	#10 Flatwasher
9	1	70791	34-3032	Wire Crimp Dial	67	1	63054	10-32_.25ss	#10-32 x 1/4" Socket Hd Set Screw
10	1	100554	35-8000	No Insulation Dial	68	1	78993	10-32_.38bh	#10-32 x 3/8" Button Hd Cap Screw
11	1	76403	199-3005	Safety Guard	69	6	76501	10-32_.50bh	#10-32 x 1/2" Button Hd Cap Screw
12	1	100039	200-8005	Baseplate	70	2	63056	10-32_.50sh	#10-32 x 1/2" Socket Hd Cap Screw
13	1	77376	250-3065	Feed Plate	71	2	64215	10-32_.69sh	#10-32 x 11/16" Socket Hd Cap Screw
14	1	100045	303-8005	Feed Finger	72	2	77396	10-32_1.25sh	#10-32 x 1 1/4" Socket Hd Cap Screw
15	1	77377	500-3065	Rear Guide Rail	73	2	63826	10-32_1.50sh	#10-32 x 1 1/2" Socket Hd Cap Screw
16	1	70669	1000-3054	Front Guide Rail	74	2	63632	1.4-20_.50bh	1/4-20 x 1/2" Button Hd Cap Screw
17	1	63711	1600-8000	Stripper	75	2	64215	1.4_.75dp	1/4" x 3/4" Dowel Pin
18	1	63660	ED2-M	Frame	76	1	63707	1.4_20 LN	1/4-20 Lock Nut
19	1	63658	ED3	Plunger	77	1	63055	5.16-18_1.00bh	5/16-18 x 1" Button Hd Cap Screw
20	1	63709	ED4	Retainer	78	2	63708	5.16-18 LN	5/16-18 Lock Nut
21	1	63731	ED5	Feed Adjustment Guide Block	79	1	64216	5.16-24_1.00ssf	5/16-24 x 1" Socket Hd Set Screw

Note:
1) Items marked in "**Bold Italic**" = High wear tooling.
2) Use OEM replacement tooling only.

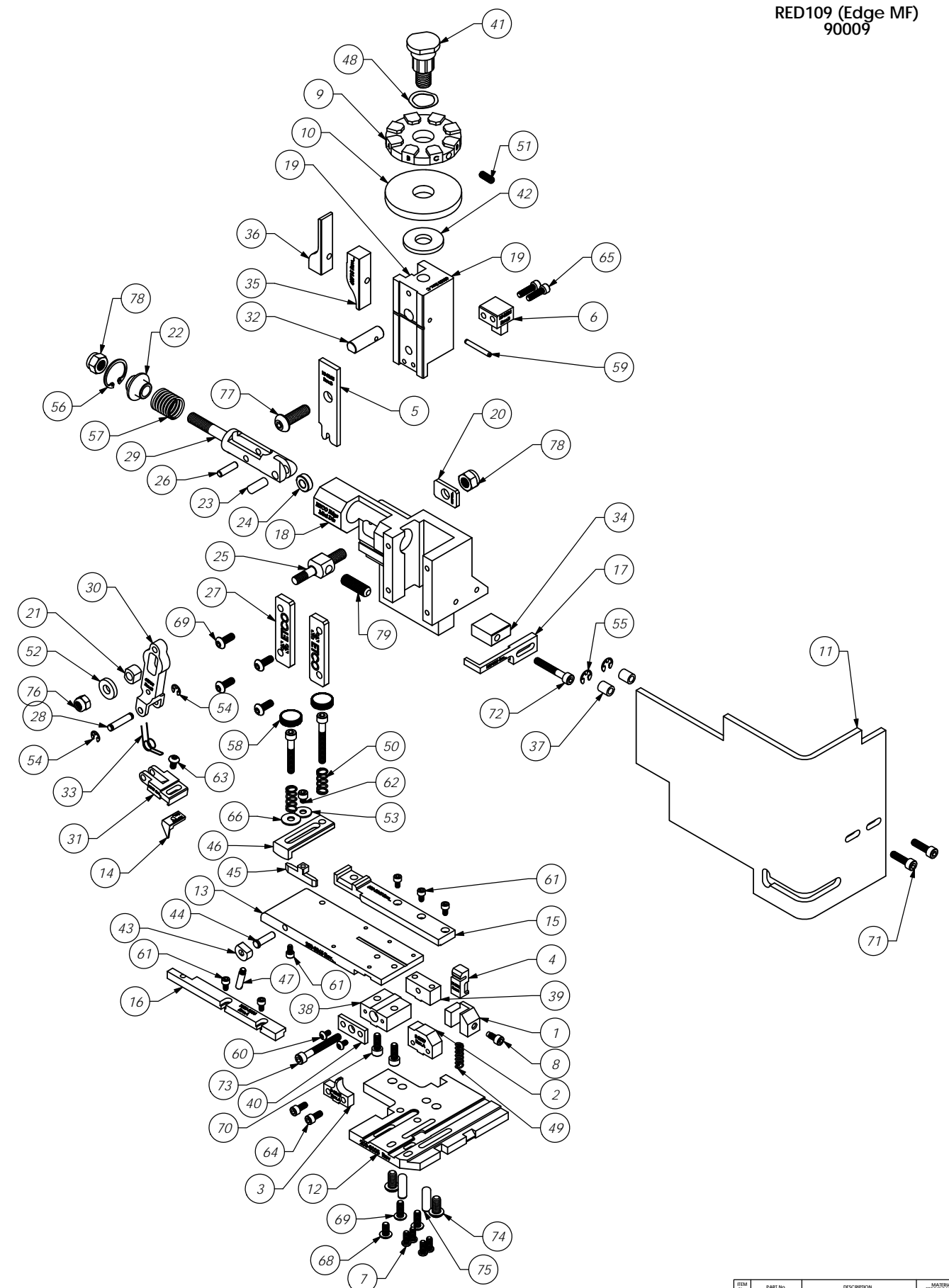

22	1	63714	ED6	Spring Retainer
23	1	63733	ED7	Cam Roll Pin
24	1	63706	ED8	Cam Roller
25	1	63704	ED9	Feed Adjustment Block
26	1	64245	ED10	Feed Arm Pin
27	2	63717	ED11	Gib
28	1	63701	ED12	Feed Finger Shaft
29	1	63705	ED13	Adjustable Feed Piston
30	1	63700	ED14	Feed Arm
31	1	63702	ED16	Feed Finger Retainer
32	1	63659	ED44	Locating Dowel
33	1	63732	ED45	Feed Finger Spring
34	1	63712	ED50-S	Stripper Spacer
35	1	63715	ED51	Post-feed Cam
36	1	63716	ED52	Pre-Feed Cam
37	2	74491	GS-375	Guard Spacer
38	1	74384	MX29-S	Slide Support
39	1	74388	MX30-S	Support Anchor
40	1	74390	MX32-S	Support Cover
41	1	74407	MX33	Mounting Post
42	1	74411	MX36	Dial Spacer
43	1	74425	MX84-S	Brake Cam
44	1	74426	MX85-S	Cam Pivot Pin
45	1	74428	MX86-S	Brake Shoe
46	1	75178	MX87-S	Lift Arm
47	1	74430	MX88-S	Lever
48	1	72310	MX104	Wave Disc Spring
49	1	74578	4-034-875	Spring
50	2	77322	LC-045E-10-M	Spring
51	1	70739	McMaster-Carr #3126A53	Spring Plunger
52	1	64213	McMaster Carr #98370A28	1/4" Hardened Flatwasher
53	1	72519	McMaster Carr #98029A043	#8 Hardened Washer
54	2	72069	McMaster Carr #98407A118	#8 E-Style Retaining Ring
55	2	64214	McMaster Carr #98407A122	#10 E-Style Retaining Ring
56	1	63734	McMaster Carr #98455A_122	Retaining Ring
57	1	63735	MS24585-1453	Piston Spring
58	2	73785	SPI 99-602-5	#10 Black Knurled Knob

DO NOT SCALE DRAWING		UNLESS OTHERWISE SPECIFIED DIMENSIONS ARE IN INCHES TOLERANCES ARE FRACTIONS DECIMALS ANGLES	
1/16" .001" .015"		.001" .001" .015"	
SURFACE FINISH: ALL OVER		FINISH: ALL OVER	
EQUIVALENTS: ALL OVER		EQUIVALENTS: ALL OVER	
MATERIAL: See Parts List		MATERIAL: See Parts List	
SCALE: 1:8		SCALE: 1:8	
DATE: 7/25/18		DATE: 7/25/18	
DRAWN BY: SCJ		DRAWN BY: SCJ	
CHECKED BY: [Signature]		CHECKED BY: [Signature]	
APPLICATION: [Blank]		APPLICATION: [Blank]	
PART NO: ECR# 5199		PART NO: ECR# 5199	
DESCRIPTION: SCJ		DESCRIPTION: SCJ	
DATE: 7/25/18		DATE: 7/25/18	
DRAWN BY: SCJ		DRAWN BY: SCJ	
CHECKED BY: [Signature]		CHECKED BY: [Signature]	
APPLICATION: [Blank]		APPLICATION: [Blank]	
SCALE: 1:8		SCALE: 1:8	
DATE: 7/25/18		DATE: 7/25/18	
DRAWN BY: SCJ		DRAWN BY: SCJ	
CHECKED BY: [Signature]		CHECKED BY: [Signature]	
APPLICATION: [Blank]		APPLICATION: [Blank]	