

ITEM NO.	Part Code	PART NUMBER	DESCRIPTION	QTY.
1	75326	8-3013	Rear Cut-off Die	1
2	75327	8A-3013	Front Cut-off Die	1
3	75554	9-3016	Wire Anvil	1
4	75555	9A-3016	Insulation Anvil	1
5	75329	12-3013	Cut-off Punch	1
6	75557	13-3016	Wire Rolling Tool	1
7	75556	14-3016	Insulation Rolling Tool	1
8	100124	14-3016-1	Insulation Overlap Rolling Tool	1
9	78855	26-3016-1	Hold Down	1
10	77640	26-3087	Feed Finger Adapter	1
11	77641	26A-3087	Feed Finger Cover Plate	1
12	71465	34-3016-1	Wire Crimp Dial	1
13	77647	35-3087	Twin Rod Cylinder	1
14	100125	35A-3127-3	Air Cylinder Support Bracket	1
15	75505	152S-3001	IRT Spacer	1
16	75285	199-3001	Guard	1
17	75507	200-3013	Baseplate	1
18	75550	303-3016	Feed Finger	1
19	71128	307-87	Feed Finger Spring	1
20	75553	403-3016	Brake Shoe	1
21	75287	1600-3011	Stripper	1
22	74491	GS-375	Guard Spacer	2
23	74343	MX3	Ram	1
24	74352	MX11	Gib	2
25	74356	MX12	Feed Finger Pivot Pin	1
26	74407	MX33	Mounting Post	1
27	74409	MX35	Insulation Dial	1
28	74411	MX36	Dial Spacer	1
29	74412	MX44	Locating Dowel	1
30	74418	MX49	Tool Retainer	1
31	74908	MX54-R	Slide Support	1
32	74816	MX55-R	Feed Plate	1
33	74817	MX56-R	Left Guide Rail	1
34	74818	MX57-R	Right Guide Rail	1
35	74909	MX58-R	Frame	1
36	72287	MX73-R-1	Feed Arm	1
37	74820	MX91-R	Lifter Plate	1
38	74821	MX92-R	Brake Support	2
39	74822	MX93-R	Lifter	2
40	74823	MX94-R	Brake Shaft	1
41	74825	MX96-R	Brake Handle	1
42	74827	MX97-R	Retaining Ring	2
43	72286	MX99-R-1	Spacer	1
44	72310	MX104	Wave Disc Spring	1
45	75083	Irving 3100-18	External Retaining Ring	2
46	75342	LC-045E-6-M	Brake Spring	2
47	70739	McMaster-Carr #3126A53	Spring Plunger	2
48	75691	Pisco PH156-U10U	5/32" x 10-32 Banjo Fitting	2
49	62040	1.8_1.00rp	1/8" x 1" Roll Pin	1
50	63209	6-32_.38sh	#6-32 x 3/8" Socket Hd Cap Screw	2
51	61472	8-32_.38bh	#8-32 x 3/8" Button Hd Cap Screw	2
52	63161	8-32_.38sh	#8-32 x 3/8" Socket Hd Cap Screw	1
53	63164	8-32_.50sh	#8-32 x 1/2" Socket Hd Cap Screw	2
54		8-32_.50bh	#8-32 x 1/2" Button Hd Cap Screw	2
55	63787	8-32_.75sh	#8-32 x 3/4" Socket Hd Cap Screw	2
56	63949	8-32_.88sh	#8-32 x 7/8" Socket Hd Cap Screw	8
57	63213	8-32_1.00sh	#8-32 x 1" Socket Hd Cap Screw	2
58	63158	3.16_.50dp	∅3/16" x 1/2" Dowel Pin	4
59		10fw-a	#10A Flatwasher	2
60	63473	10-32_.25sh	#10-32 x 1/4" Socket Hd Cap Screw	1
61	63054	10-32_.25ss	#10-32 x 1/4" Socket Hd Set Screw	2
62	78993	10-32_.38bh	#10-32 x 3/8" Button Hd Cap Screw	2
63	76501	10-32_.50bh	#10-32 x 1/2" Button Hd Cap Screw	8
64	70925	10-32_.88sh	#10-32 x 7/8" Socket Hd Cap Screw	2
65	63155	10-32_1.00sh	#10-32 x 1" Socket Hd Cap Screw	2
66	63826	10-32_1.50sh	#10-32 x 1 1/2" Socket Hd Cap Screw	2
67		1.4-20_.50fh	1/4-20 x 1/2" Flat Hd Cap Screw	2
68	63632	1.4-20_.50bh	1/4-20 x 1/2" Button Hd Cap Screw	3
69	64215	1.4_.75dp	1/4" x 3/4" Dowel Pin	2
70	63055	5.16-18_1.00bh	5/16-18 x 1" Button Hd Cap Screw	1
71		M4x0.7_25.0hh	M4 x 25mm Hex Head Screw	1

NOTE: ITEMS MARKED IN BOLD TEXT ARE HIGH WEAR ITEMS

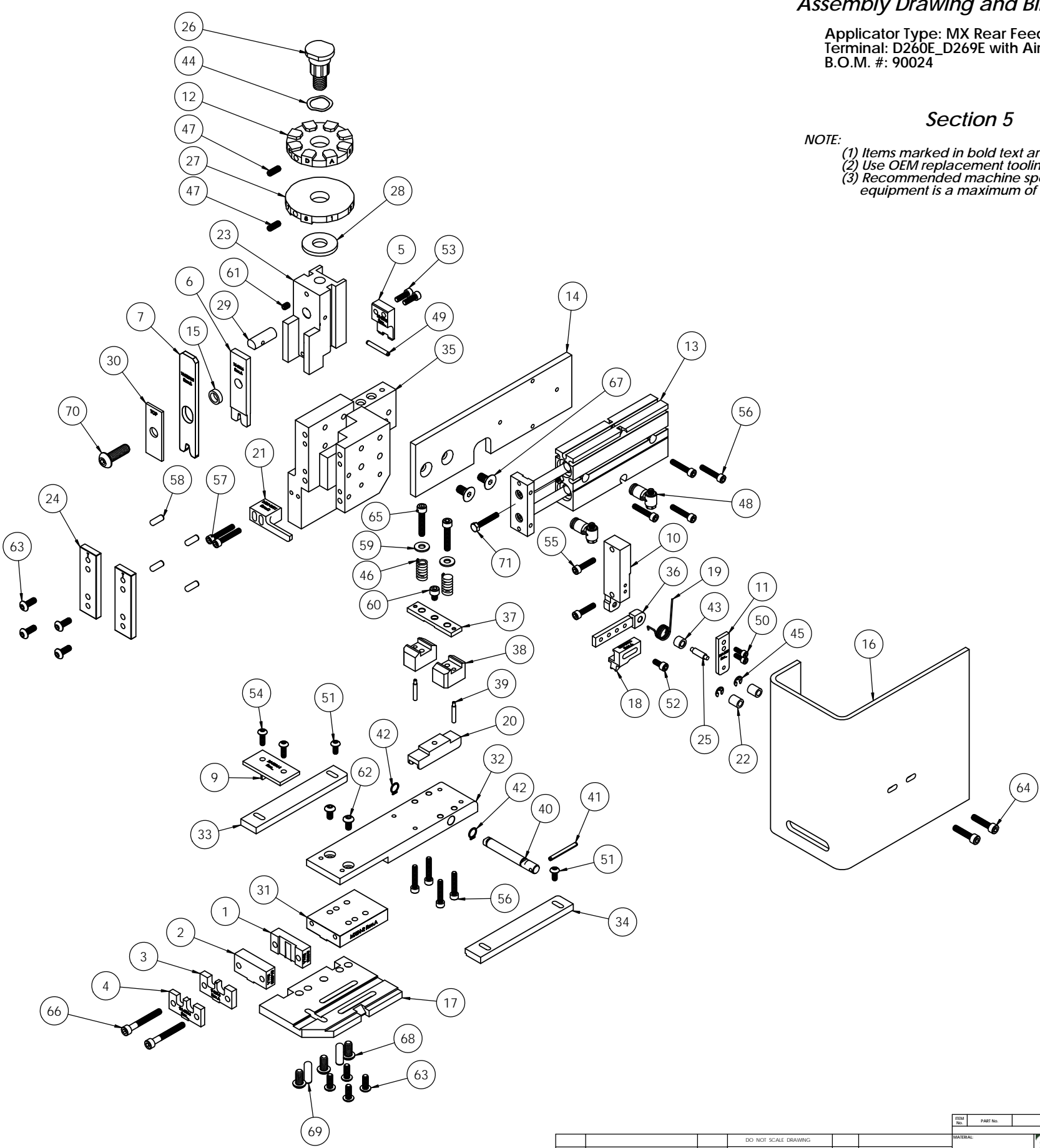

Assembly Drawing and Bill of Materials

Applicator Type: MX Rear Feed Applicator
Terminal: D260E_D269E with Air Feed
B.O.M. #: 90024

Section 5

NOTE:
(1) Items marked in bold text are high wear items.
(2) Use OEM replacement tooling only.
(3) Recommended machine speed for automatic equipment is a maximum of 3500 parts per hour.

REV	DESCRIPTION	DATE	BY/DATE	APP. / REVISION	SCALE	APP.	DATE	REV
1					1:2		12/22/15	

REV	PART NO.	DESCRIPTION	MATERIAL SPECIFICATION	QTY. RECD.
		DO NOT SCALE DRAWING		
		UNLESS OTHERWISE SPECIFIED DIMENSIONS ARE IN INCHES TOLERANCES ARE FRACTIONS DECIMALS ANGLES		
		#1/64 .001 30X .001 XXXX .010 XXXXX .010		
		SURFACE FINISH ALL OVER		
		QTY. USED ON		
		SCALE		
		APP.		
		DATE		
		REV		

PARTS LIST		MATERIAL		DATE	
3	ETECO ENGINEERED PRODUCTS 25 BELLOWS STREET WARWICK, RI 02888 (401) 467-2400				
	See Parts List				
	MX Rear Feed Applicator				
	D260E_D269E with Air Feed				
	12/22/15				