

# Assembly Drawing and Bill of Materials

Applicator Type: ETCO Edge Composite Frame  
Terminal: SP10 SP11 SP078 SP15 (Edge CF)  
B.O.M. #: 90039

## Section 5

NOTE:  
(1) Items marked in bold text are high wear items.  
(2) Use OEM replacement tooling only.  
(3) Recommended machine speed for automatic equipment is a maximum of 3500 parts per hour.

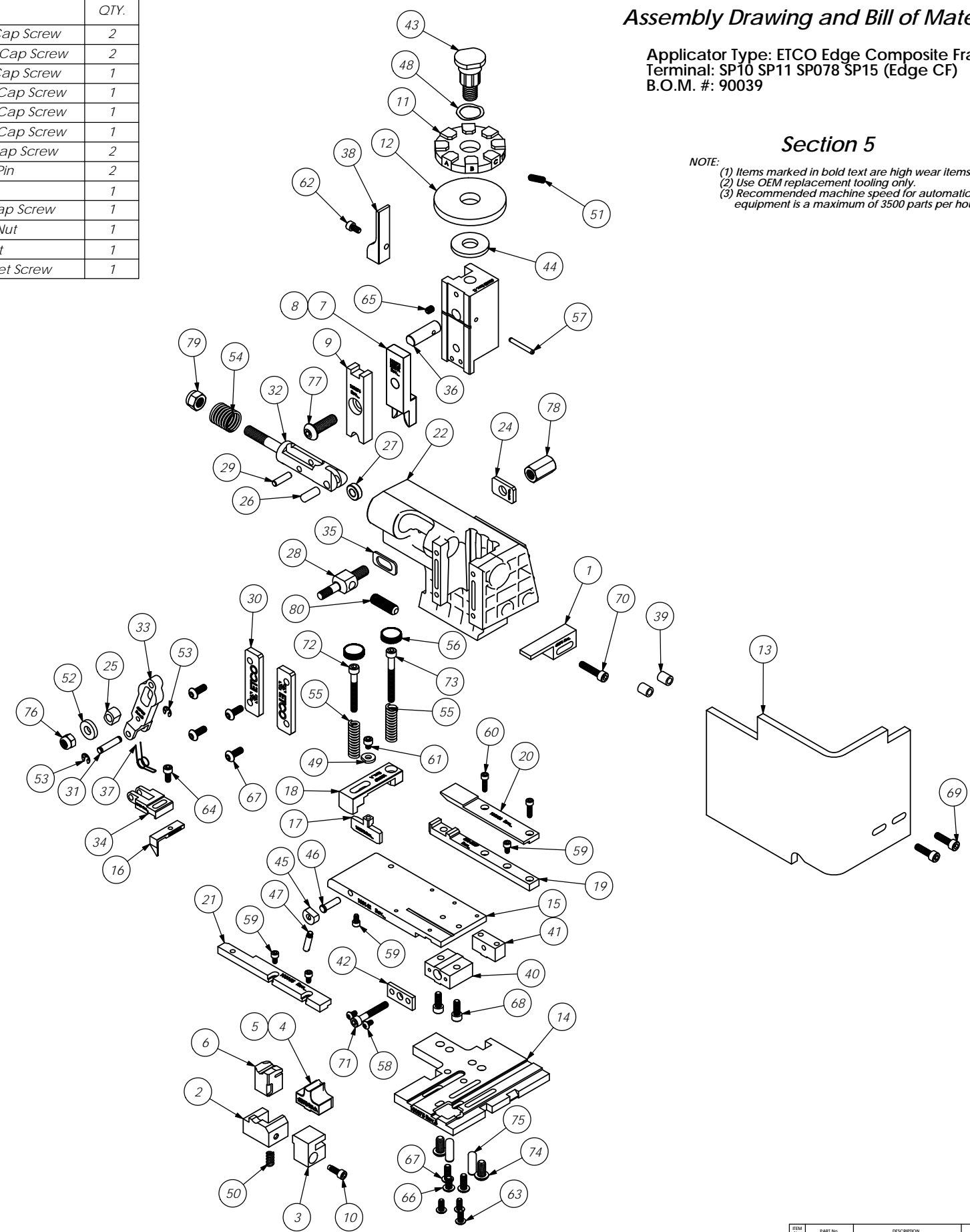

**NOTE: ITEMS MARKED IN BOLD TEXT ARE HIGH WEAR ITEMS**

ITEM NO.	Part_Code	PART NUMBER	DESCRIPTION	QTY.	ITEM NO.	Part_Code	PART NUMBER	DESCRIPTION	QTY.
1	63576	63576	Stripper	1	68	63056	10-32_50sh	#10-32 x 1/2" Socket Hd Cap Screw	2
2	62977	62977	Front Cut-off Pad Retainer	1	69	64215	10-32_69sh	#10-32 x 11/16" Socket Hd Cap Screw	2
3	62979	62979	Scrap Deflector	1	70	70925	10-32_88sh	#10-32 x 7/8" Socket Hd Cap Screw	1
4	100073	9-8007	Conductor Anvil - SP11, SP15	1	71	77396	10-32_1.25sh	#10-32 x 1 1/4" Socket Hd Cap Screw	1
5	100145	9-8010	Anvil	1	72	63826	10-32_1.50sh	#10-32 x 1 1/2" Socket Hd Cap Screw	1
6	100100	12-8007	Cut-Off Pad	1	73	63166	10-32_1.75sh	#10-32 x 1 3/4" Socket Hd Cap Screw	1
7	100072	13-8007	Rolling Tool - SP11, SP15, 52264	1	74	63632	1.4-20_50bh	1/4-20 x 1/2" Button Hd Cap Screw	2
8	100157	13-8007-1	Wire Rolling Tool	1	75	64215	1.4_75dp	1/4" x 3/4" Dowel Pin	2
9	100074	15-8007	Cut-off Pad Driver	1	76	63707	1.4_20 LN	1/4-20 Lock Nut	1
10	78292	26C-3087	Locking Screw	1	77	63055	5.16-18_1.00bh	5/16-18 x 1" Button Hd Cap Screw	1
11	100101	34-8007	Wire Crimp Dial	1	78	100063	5.16-18cn	5/16-18 Coupling Nut	1
12	100554	35-8000	No Insulation Dial	1	79	63708	5.16-18 LN	5/16-18 Lock Nut	1
13	63583	199-6045	Safety Guard	1	80	64216	5.16-24_1.00ssf	5/16-24 x 1" Socket Hd Set Screw	1
14	100075	200-8007	Baseplate	1					
15	100142	250-8007-1	Feed Plate	1					
16	100076	303-8007	Feed Finger	1					
17	100078	403-8007	Brake Shoe	1					
18	100139	403A-8007-1	Brake Lift Arm	1					
19	100079	500-8007	Rear Guide Rail	1					
20	100138	500A-8007-1	Rear Guide Top Plate	1					
21	100155	1000-8007-1	Front Guide Rail	1					
22	100001	ED2-C-1	ETCO Edge Composite Frame - Machined	1					
23	63658	ED3	Plunger	1					
24	63709	ED4	Retainer	1					
25	63731	ED5	Feed Adjustment Guide Block	1					
26	63733	ED7	Cam Roll Pin	1					
27	63706	ED8	Cam Roller	1					
28	63704	ED9	Feed Adjustment Block	1					
29	64245	ED10	Feed Arm Pin	1					
30	63717	ED11	Gib	2					
31	63701	ED12	Feed Finger Shaft	1					
32	63705	ED13	Adjustable Feed Piston	1					
33	63700	ED14	Feed Arm	1					
34	63702	ED16	Feed Finger Retainer	1					
35	64121	ED19-C	Shim for Nylon Frame	1					
36	63659	ED44	Locating Dowel	1					
37	63732	ED45	Feed Finger Spring	1					
38	63716	ED52	Pre-Feed Cam	1					
39	74491	GS-375	Guard Spacer	2					
40	74384	MX29-S	Slide Support	1					
41	74388	MX30-S	Support Anchor	1					
42	74390	MX32-S	Support Cover	1					
43	74407	MX33	Mounting Post	1					
44	74411	MX36	Dial Spacer	1					
45	74425	MX84-S	Brake Cam	1					
46	74426	MX85-S	Cam Pivot Pin	1					
47	74430	MX88-S	Lever	1					
48	72310	MX104	Wave Disc Spring	1					
49	78984	MX424-ITD-R	#8 Hardened Washer	1					
50	74578	4-034-875	Spring	1					
51	70739	McMaster-Carr #3126A53	Spring Plunger	1					
52	64213	McMaster Carr #98370A28	1/4" Hardened Flatwasher	1					
53	72069	McMaster Carr #98407A118	#8 E-Style Retaining Ring	2					
54	63735	MS24585-1453	Piston Spring	1					
55	62481	Producto #MP-02	3/8" x 1" Blue Die Spring	2					
56	73785	SPI 99-602-5	#10 Black Knurled Knob	2					
57	62040	1.8_1.00rp	1/8" x 1" Roll Pin	1					
58	63792	6-32_25bh	#6-32 x 1/4" Button Hd Cap Screw	2					
59	63207	6-32_25sh	#6-32 x 1/4" Socket Hd Cap Screw	4					
60	63544	6-32_50sh	#6-32 x 1/2" Socket Hd Cap Screw	2					
61	60265	8-32_19sh	#8-32 x 3/16" Socket Hd Cap Screw	1					
62	100091	8-32_31sh	#8-32 x 5/16" Socket Hd Cap Screw	1					
63	61472	8-32_38bh	#8-32 x 3/8" Button Hd Cap Screw	3					
64	63161	8-32_38sh	#8-32 x 3/8" Socket Hd Cap Screw	1					
65	63054	10-32_25ss	#10-32 x 1/4" Socket Hd Set Screw	1					
66	78993	10-32_38bh	#10-32 x 3/8" Button Hd Cap Screw	1					
67	76501	10-32_50bh	#10-32 x 1/2" Button Hd Cap Screw	6					

REV	REVISION	BY/DATE	APP	SCALE	DATE	REV	REVISION	BY/DATE	APP	SCALE	DATE
B	ECR# 5199	SCJ	7/25/18			A	ECR# 4963	SCJ	2/26/18		

ITEM	PART No.	DESCRIPTION	MATERIAL SPECIFICATION	QTY
1	63576	Stripper		1
2	62977	Front Cut-off Pad Retainer		1
3	62979	Scrap Deflector		1
4	100073	Conductor Anvil - SP11, SP15		1
5	100145	Anvil		1
6	100100	Cut-Off Pad		1
7	100072	Rolling Tool - SP11, SP15, 52264		1
8	100157	Wire Rolling Tool		1
9	100074	Cut-off Pad Driver		1
10	78292	Locking Screw		1
11	100101	Wire Crimp Dial		1
12	100554	No Insulation Dial		1
13	63583	Safety Guard		1
14	100075	Baseplate		1
15	100142	Feed Plate		1
16	100076	Feed Finger		1
17	100078	Brake Shoe		1
18	100139	Brake Lift Arm		1
19	100079	Rear Guide Rail		1
20	100138	Rear Guide Top Plate		1
21	100155	Front Guide Rail		1
22	100001	ETCO Edge Composite Frame - Machined		1
23	63658	ED3		1
24	63709	ED4		1
25	63731	ED5		1
26	63733	ED7		1
27	63706	ED8		1
28	63704	ED9		1
29	64245	ED10		1
30	63717	ED11		2
31	63701	ED12		1
32	63705	ED13		1
33	63700	ED14		1
34	63702	ED16		1
35	64121	ED19-C		1
36	63659	ED44		1
37	63732	ED45		1
38	63716	ED52		1
39	74491	GS-375		2
40	74384	MX29-S		1
41	74388	MX30-S		1
42	74390	MX32-S		1
43	74407	MX33		1
44	74411	MX36		1
45	74425	MX84-S		1
46	74426	MX85-S		1
47	74430	MX88-S		1
48	72310	MX104		1
49	78984	MX424-ITD-R		1
50	74578	4-034-875		1
51	70739	McMaster-Carr #3126A53		1
52	64213	McMaster Carr #98370A28		1
53	72069	McMaster Carr #98407A118		2
54	63735	MS24585-1453		1
55	62481	Producto #MP-02		2
56	73785	SPI 99-602-5		2
57	62040	1.8_1.00rp		1
58	63792	6-32_25bh		2
59	63207	6-32_25sh		4
60	63544	6-32_50sh		2
61	60265	8-32_19sh		1
62	100091	8-32_31sh		1
63	61472	8-32_38bh		3
64	63161	8-32_38sh		1
65	63054	10-32_25ss		1
66	78993	10-32_38bh		1
67	76501	10-32_50bh		6