

ITEM NO.	Part Code	PART NUMBER	DESCRIPTION	QTY.
1	100374	8-82080	Rear Die	1
2	<b>60666</b>	<b>9-82081</b>	<b>Anvil</b>	<b>1</b>
3	100368	11-82081	Plunger	1
4	100369	11A-82081	Plunger Block	1
5	<b>60898</b>	<b>12-82081</b>	<b>Cut-off Punch</b>	<b>1</b>
6	<b>60137</b>	<b>13-82081</b>	<b>Wire Rolling Tool</b>	<b>1</b>
7	100370	15-82081	Cut-off Punch Driver	1
8	100373	21-82081	Cut-off Punch Retainer	1
9	100371	101R-82080	Top Casting	1
10	77600	169-16	Gib	2
11	76839	176R	Guard	1
12	77402	176S-500	Guard Spacer	2
13	100372	205R-82081	Base Plate	1
14	100375	250-82080	Feed Plate	1
15	76858	301-3	Shoulder Screw	1
16	60483	302-.080	Feed Finger Spacer	1
17	74325	303	Feed Finger	1
18	74050	304-.300	Feed Finger Spacer	1
19	76829	305-1	Feed Finger Arm	1
20	77639	306-TH	Feed Stop Arm	1
21	68711	307R-5	Feed Finger Spring	1
22	74400	308-Finished	Feed Shaft	1
23	74402	310	Cam Return Spring	1
24	74403	311	Roll Pin	1
25	74404	312	Cam Taper Pin	1
26	76749	314-156	Cam	1
27	74495	401-Finished	Brake Shaft	1
28	74496	402	Spring Retainer	1
29	100380	403-7	Brake Body	1
30	74673	404_405as	Brake Cam Assy	1
31	74675	406	Cotter Pin	1
32	74676	407	Brake Spring	1
33	67107	408-.990	Brake Spacer	1
34	100377	500-82080	Rear Guide Rail	1
35	100376	1000-82081	Front Guide Rail	1
36	75716	1125R	Cam Roller Bracket	1
37	75719	1142	Cam Roller Bearing	1
38	75883	1600-122	Stripper	1
39	76191	1805	Stock Chute	1
40	77634	CS-110	Plunger Shank	1
41		LC-029B-08-M	Spring	2
42	63506	McMaster-Carr #1095K11	1/8 NPT Grease Fitting	1
43	72069	McMaster Carr #98407A118	#8 E-Style Retaining Ring	2
44	63153	5-40_.75sh	#5-40 x 3/4" Socket Hd Cap Screw	2
45	63161	8-32_.38sh	#8-32 x 3/8" Socket Hd Cap Screw	15
46	63052	8-32_.50fh	#8-32 x 1/2" Flat Hd Cap Screw	2
47	63471	8-32_1.13sh	#8-32 x 1 1/8" Socket Hd Cap Screw	4
48	63213	8-32_1.00sh	#8-32 x 1" Socket Hd Cap Screw	2
49	63532	10-32_.75sh	#10-32 x 3/4" Socket Hd Cap Screw	1
50	63155	10-32_1.00sh	#10-32 x 1" Socket Hd Cap Screw	2
51	77396	10-32_1.25sh	#10-32 x 1 1/4" Socket Hd Cap Screw	1
52	63507	1.8_.50dp	Ø 1/8" x 1/2" Dowel	2
53	62849	1.8_1.00dp	1/8" x 1" Dowel	2
54	63511	1.4-20_.25ssf	1/4-20 x 1/4" Socket Hd Set Screw	2
55	63510	1.4_1.00dp	1/4 x 1" Dowel Pin	2
56	62184	1.4-28_.50sh	1/4-28 x 1/2" Socket Hd Cap Screw	1
57	62622	1.2_.75shss	1/2" x 3/4" Socket Hd Shoulder Screw	1

**NOTE: ITEMS MARKED IN BOLD TEXT ARE HIGH WEAR ITEMS**

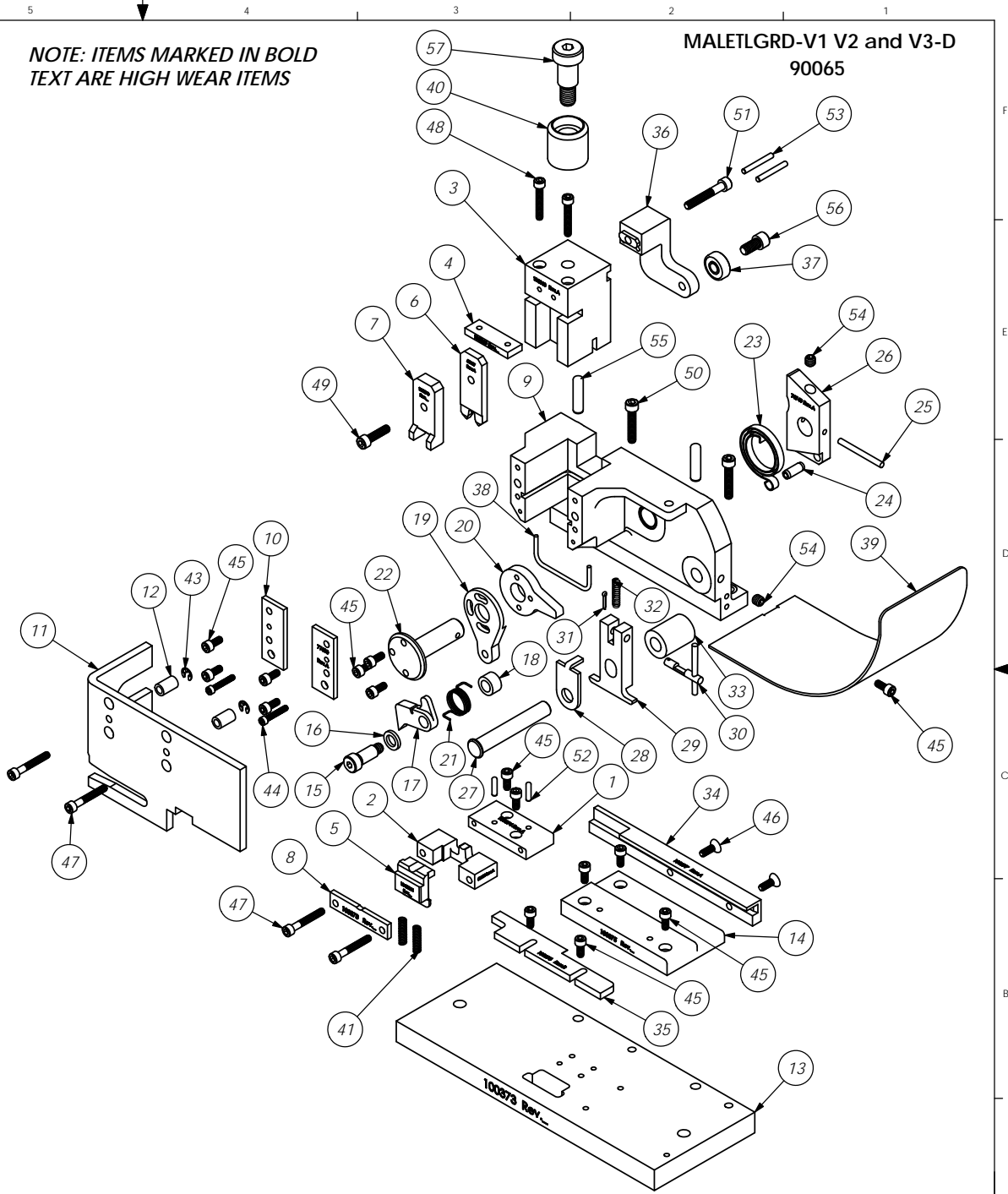

**MALETGRD-V1 V2 and V3-D  
90065**

DO NOT SCALE DRAWING		MATERIAL	
UNLESS OTHERWISE SPECIFIED DIMENSIONS ARE IN INCHES. TOLERANCES ARE: FRACTIONS: DECIMALS: ANGLES: #1/64 .XX ±.01 XXX ±.01 XXXX ±.002		See Parts List	
SURFACE FINISH: <input checked="" type="checkbox"/> ALL OVER		HEAT TREAT	
FINISH		MALETGRD-V1 V2 and V3-D	
SCALE: 7:2		CAD FILE	
CHECKED BY: SCJ		DATE: 7/13/17	
REVISION: <b>A</b> Changed spacers		BY/DATE: SCJ/7/27/17	
LVL		APPLICATION	
REV		DATE	
SIZE		7/24/2017	