

Assembly Drawing and Bill of Materials

Applicator Type: ETCO Edge Metal Frame - Side Feed
Terminal: CF276F (Edge MF)
B.O.M. #: 90117

Section 5

- NOTE:**
- (1) Items marked in bold text are high wear items.
 - (2) Use OEM replacement tooling only.
 - (3) Recommended machine speed for automatic equipment is a maximum of 3500 parts per hour.

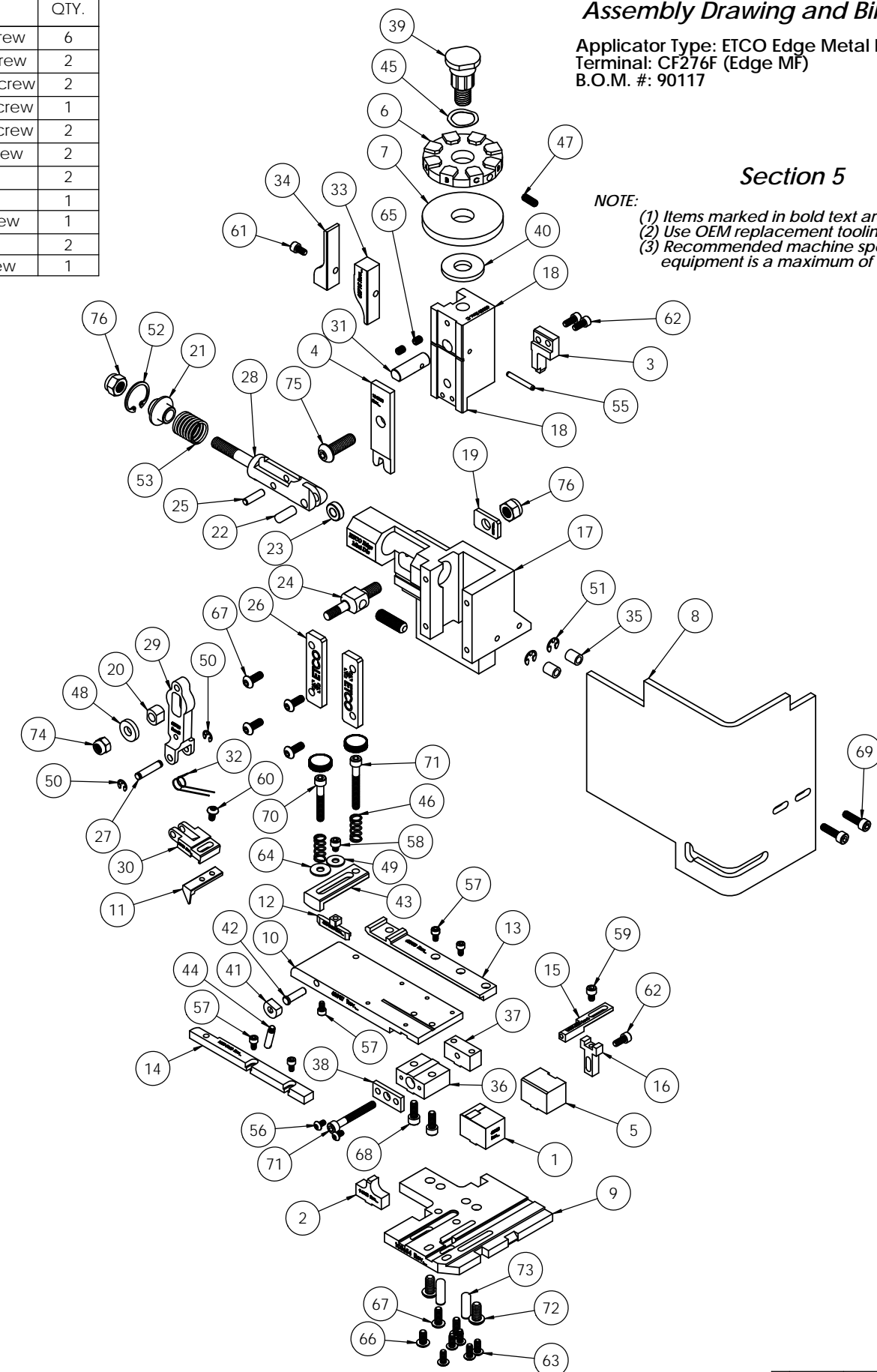

NOTE: ITEMS MARKED IN BOLD TEXT ARE HIGH WEAR ITEMS

ITEM NO.	Part_Code	PART NUMBER	DESCRIPTION	QTY.
1	63955	8-3153	Cut-off Die	1
2	63954	9-3153	Anvil	1
3	63962	12-3153	Cut-off Punch	1
4	63956	13-3153	Wire Rolling Tool	1
5	74802	26-3000	Backup Block	1
6	77330	34-3014	Wire Crimp Dial	1
7	100554	35-8000	No Insulation Dial	1
8	76403	199-3005	Safety Guard	1
9	100654	200-8042	Baseplate	1
10	63959	250-3153	Feed Plate	1
11	64261	303-8001	Feed Finger	1
12	63961	403-3153	Brake Shoe	1
13	63958	500-3153	Rear Guide Rail	1
14	63960	1000-3153	Front Guide Rail	1
15	76464	1600A-3001	Adjustable Stripper	1
16	74803	1600B-3000	Adjustable Stripper Holder	1
17	63660	ED2-M	Frame	1
18	63658	ED3	Plunger	1
19	63709	ED4	Retainer	1
20	63731	ED5	Feed Adjustment Guide Block	1
21	63714	ED6	Spring Retainer	1
22	63733	ED7	Cam Roll Pin	1
23	63706	ED8	Cam Roller	1
24	63704	ED9	Feed Adjustment Block	1
25	64245	ED10	Feed Arm Pin	1
26	63717	ED11	Gib	2
27	63701	ED12	Feed Finger Shaft	1
28	63705	ED13	Adjustable Feed Piston	1
29	63700	ED14	Feed Arm	1
30	63702	ED16	Feed Finger Retainer	1
31	63659	ED44	Locating Dowel	1
32	63732	ED45	Feed Finger Spring	1
33	63715	ED51	Post-feed Cam	1
34	63716	ED52	Pre-feed Cam	1
35	74491	GS-375	Guard Spacer	2
36	74384	MX29-S	Slide Support	1
37	74388	MX30-S	Support Anchor	1
38	74390	MX32-S	Support Cover	1
39	74407	MX33	Mounting Post	1
40	74411	MX36	Dial Spacer	1
41	74425	MX84-S	Brake Cam	1
42	74426	MX85-S	Cam Pivot Pin	1
43	75178	MX87-S	Lift Arm	1
44	74430	MX88-S	Lever	1
45	72310	MX104	Wave Disc Spring	1
46	77322	LC-045E-10-M	Spring	2
47	70739	McMaster-Carr #3126A53	Spring Plunger	1
48	64213	McMaster Carr #98370A28	1/4" Hardened Flatwasher	1
49	72519	McMaster Carr #98029A043	#8 Hardened Washer	1
50	72069	McMaster Carr #98407A118	#8 E-Style Retaining Ring	2
51	64214	McMaster Carr #98407A122	#10 E-Style Retaining Ring	2
52	63734	McMaster Carr #98455A_122	Retaining Ring	1
53	63735	MS24585-1453	Piston Spring	1
54	73785	SPI 99-602-5	#10 Black Knurled Knob	2
55	62040	1.8_1.00rp	1/8" x 1" Roll Pin	1
56	63792	6-32_.25bh	#6-32 x 1/4" Button Hd Cap Screw	2
57	63207	6-32_.25sh	#6-32 x 1/4" Socket Hd Cap Screw	6
58	60265	8-32_.19sh	#8-32 x 3/16" Socket Hd Cap Screw	1
59	63163	8-32_.25sh	#8-32 x 1/4" Socket Hd Cap Screw	1
60	77097	8-32_.31bh	#8-32 x 5/16" Button Hd Cap Screw	1
61	100091	8-32_.31sh	#8-32 x 5/16" Socket Hd Cap Screw	1
62	63161	8-32_.38sh	#8-32 x 3/8" Socket Hd Cap Screw	3
63	61472	8-32_.38bh	#8-32 x 3/8" Button Hd Cap Screw	5
64	63753	10fw	#10 Flatwasher	1
65	63054	10-32_.25ss	#10-32 x 1/4" Socket Hd Set Screw	2
66	78993	10-32_.38bh	#10-32 x 3/8" Button Hd Cap Screw	1
67	76501	10-32_.50bh	#10-32 x 1/2" Button Hd Cap Screw	6
68	63056	10-32_.50sh	#10-32 x 1/2" Socket Hd Cap Screw	2
69	64215	10-32_.69sh	#10-32 x 11/16" Socket Hd Cap Screw	2
70	77396	10-32_1.25sh	#10-32 x 1 1/4" Socket Hd Cap Screw	1
71	63826	10-32_1.50sh	#10-32 x 1 1/2" Socket Hd Cap Screw	2
72	63632	1.4-20_.50bh	1/4-20 x 1/2" Button Hd Cap Screw	2
73	64215	1.4_.75dp	1/4" x 3/4" Dowel Pin	2
74	63707	1.4_20 LN	1/4-20 Lock Nut	1
75	63055	5.16-18_1.00bh	5/16-18 x 1" Button Hd Cap Screw	1
76	63708	5.16-18 LN	5/16-18 Lock Nut	2
77	64216	5.16-24_1.00ssf	5/16-24 x 1" Socket Hd Set Screw	1

REV	DESCRIPTION	DATE	BY/DATE	APP	QTY	USED ON	SCALE	CAD FILE	CHECKED BY	DATE	DESIGNED BY	DATE	REV
1							1:2		SCJ	5/06/19			D