

Assembly Drawing and Bill of Materials

Applicator Type: ETCO Edge- Air Feed - Metal Frame
Terminal: SP98-8M (Edge Air Feed MF)
B.O.M. #: 90132

Section 5

- NOTE:
- (1) Items marked in bold text are high wear items.
 - (2) Use OEM replacement tooling only.
 - (3) Recommended machine speed for automatic equipment is a maximum of 3500 parts per hour.

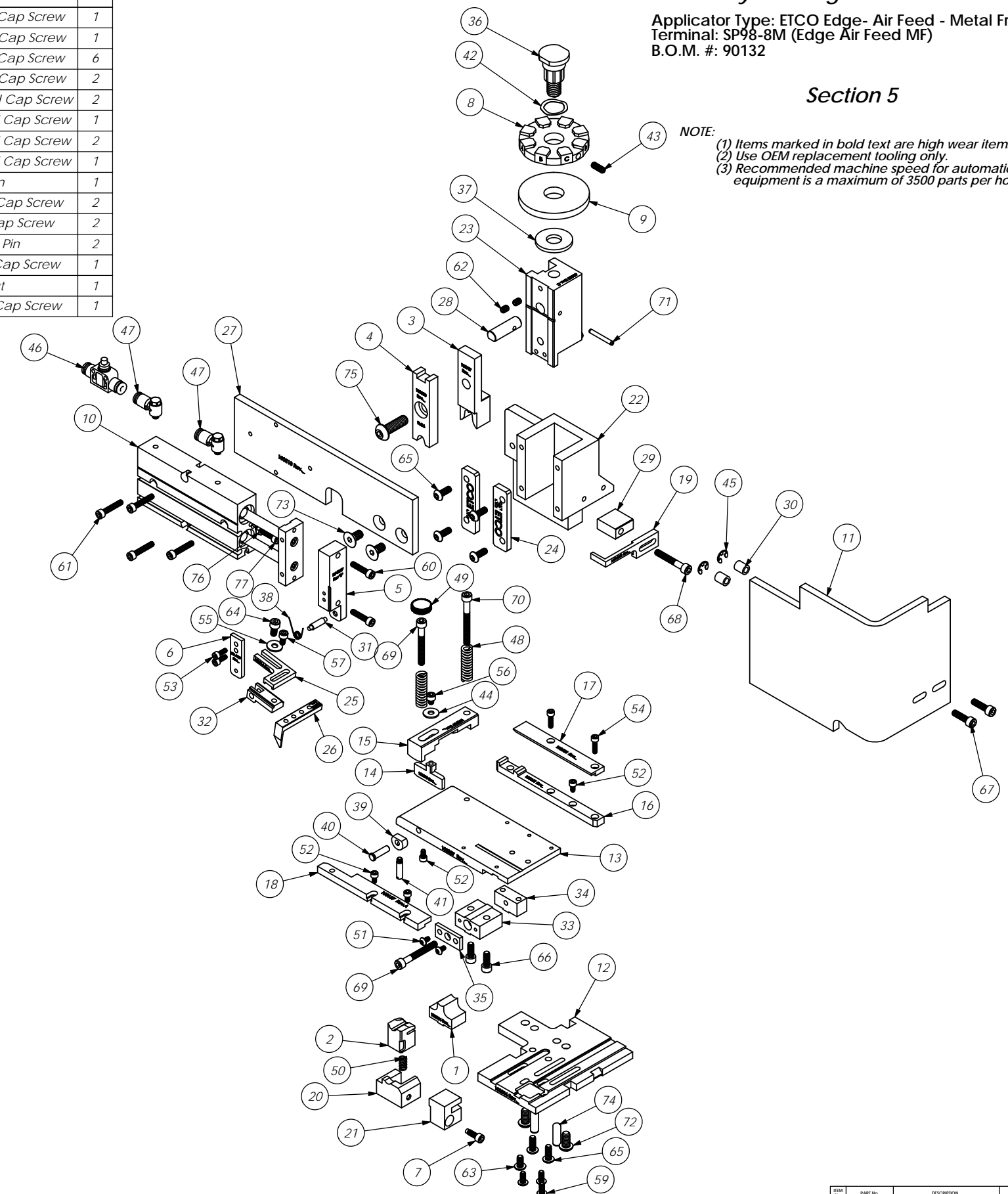

NOTE: ITEMS MARKED IN BOLD TEXT ARE HIGH WEAR ITEMS

ITEM NO.	Part_Code	PART NUMBER	DESCRIPTION	QTY.	ITEM NO.	Part_Code	PART NUMBER	DESCRIPTION	QTY.
1	100304	9-8019	Anvil	1	63	78993	10-32_.38bh	#10-32 x 3/8" Button Hd Cap Screw	1
2	100144	12-8010	Cut-Off Pad	1	64	70110	10-32_.38sh	#10-32 x 3/8" Socket Hd Cap Screw	1
3	100757	13-8019-1	Wire Rolling Tool	1	65	76501	10-32_.50bh	#10-32 x 1/2" Button Hd Cap Screw	6
4	100553	15-8007-1	Cut-off Pad Driver - 9MM	1	66	63056	10-32_.50sh	#10-32 x 1/2" Socket Hd Cap Screw	2
5	77640	26-3087	Feed Finger Adapter	1	67	64215	10-32_.69sh	#10-32 x 11/16" Socket Hd Cap Screw	2
6	77641	26A-3087	Feed Finger Cover Plate	1	68	77396	10-32_1.25sh	#10-32 x 1 1/4" Socket Hd Cap Screw	1
7	78292	26C-3087	Locking Screw	1	69	63826	10-32_1.50sh	#10-32 x 1 1/2" Socket Hd Cap Screw	2
8	100101	34-8007	Wire Crimp Dial	1	70	63166	10-32_1.75sh	#10-32 x 1 3/4" Socket Hd Cap Screw	1
9	100554	35-8000	No Insulation Dial	1	71	62040	1.8_1.00p	1/8" x 1" Roll Pin	1
10	77647	35-3087	Twin Rod Cylinder	1	72	63632	1.4-20_.50bh	1/4-20 x 1/2" Button Hd Cap Screw	2
11	63583	199-6045	Safety Guard	1	73		1.4-20_.50fh	1/4-20 x 1/2" Flat Hd Cap Screw	2
12	100306	200-8019	Baseplate	1	74	64215	1.4_.75dp	1/4" x 3/4" Dowel Pin	2
13	100307	250-8019	Feed Plate	1	75	63055	5.16-18_1.00bh	5/16-18 x 1" Button Hd Cap Screw	1
14	100078	403-8007	Brake Shoe	1	76		M4x0.7hn	M4 x .7 Hex Nut	1
15	100789	403A-8019-8M	Lift Arm	1	77		M4x0.7_20.0sh	M4 x 20mm Socket Hd Cap Screw	1
16	100151	500-8010	Rear Guide Rail	1					
17	100308	500A-8019	Rear Guide Top Plate	1					
18	100137	1000-8010	Front Guide Rail	1					
19	63711	1600-8000	Stripper	1					
20	62977	62977	Front Cut-off Pad Retainer	1					
21	62979	62979	Scrap Deflector	1					
22	100512	ED2-M-AF	Edge Frame for Air Feed	1					
23	63658	ED3	Plunger	1					
24	63717	ED11	Gib	2					
25	100514	ED14-1-S	Feed Finger Arm	1					
26	100510	ED17-S-Air	Feed Finger for Air Feed	1					
27	100513	ED35-S	Air Cylinder Support Bracket	1					
28	63659	ED44	Locating Dowel	1					
29	63712	ED50-S	Stripper Spacer	1					
30	74491	GS-375	Guard Spacer	2					
31	74356	MX12	Feed Finger Pivot Pin	1					
32	74362	MX15-S	Feed Finger Guide	1					
33	74384	MX29-S	Slide Support	1					
34	74388	MX30-S	Support Anchor	1					
35	74390	MX32-S	Support Cover	1					
36	74407	MX33	Mounting Post	1					
37	100758	MX36-115	Dial Spacer	1					
38	74415	MX45-S	Feed Finger Spring	1					
39	74425	MX84-S	Brake Cam	1					
40	74426	MX85-S	Cam Pivot Pin	1					
41	74430	MX88-S	Lever	1					
42	72310	MX104	Wave Disc Spring	1					
43	70739	McMaster-Carr #3126A53	Spring Plunger	1					
44	72519	McMaster Carr #98029A043	#8 Hardened Washer	1					
45	64214	McMaster Carr #98407A122	#10 E-Style Retaining Ring	2					
46	72408	Pisco JSU156	Ø5/32" In-line Flow Control	1					
47	75691	Pisco PH156-U10U	5/32" x 10-32 Banjo Fitting	2					
48	62481	Producto #MP-02	3/8" x 1" Blue Die Spring	2					
49	73785	SPI 99-602-5	#10 Black Knurled Knob	1					
50	74578	4-034-875	Spring	1					
51	63792	6-32_.25bh	#6-32 x 1/4" Button Hd Cap Screw	2					
52	63207	6-32_.25sh	#6-32 x 1/4" Socket Hd Cap Screw	4					
53	63209	6-32_.38sh	#6-32 x 3/8" Socket Hd Cap Screw	2					
54	63544	6-32_.50sh	#6-32 x 1/2" Socket Hd Cap Screw	2					
55	63210	8fw	#8 Flatwasher	1					
56	60265	8-32_.19sh	#8-32 x 3/16" Socket Hd Cap Screw	1					
57	100091	8-32_.31sh	#8-32 x 5/16" Socket Hd Cap Screw	1					
58	63161	8-32_.38sh	#8-32 x 3/8" Socket Hd Cap Screw	2					
59	61472	8-32_.38bh	#8-32 x 3/8" Button Hd Cap Screw	3					
60	63787	8-32_.75sh	#8-32 x 3/4" Socket Hd Cap Screw	2					
61	63949	8-32_.88sh	#8-32 x 7/8" Socket Hd Cap Screw	4					
62	63054	10-32_.25ss	#10-32 x 1/4" Socket Hd Set Screw	2					

DO NOT SCALE DRAWING		UNLESS OTHERWISE SPECIFIED DIMENSIONS ARE IN INCHES TOLERANCES ARE FRACTIONS DECIMALS ANGLES	
1/16" ±.015		.001 ±.001	
1/32" ±.010		.005 ±.005	
3/32" ±.010		.005 ±.005	
1/8" ±.010		.005 ±.005	
1/4" ±.015		.005 ±.005	
3/8" ±.015		.005 ±.005	
1/2" ±.020		.005 ±.005	
3/4" ±.020		.005 ±.005	
1" ±.025		.005 ±.005	
1 1/2" ±.030		.005 ±.005	
2" ±.030		.005 ±.005	
3" ±.030		.005 ±.005	
4" ±.030		.005 ±.005	
5" ±.030		.005 ±.005	
6" ±.030		.005 ±.005	
7" ±.030		.005 ±.005	
8" ±.030		.005 ±.005	
9" ±.030		.005 ±.005	
10" ±.030		.005 ±.005	
11" ±.030		.005 ±.005	
12" ±.030		.005 ±.005	
13" ±.030		.005 ±.005	
14" ±.030		.005 ±.005	
15" ±.030		.005 ±.005	
16" ±.030		.005 ±.005	
17" ±.030		.005 ±.005	
18" ±.030		.005 ±.005	
19" ±.030		.005 ±.005	
20" ±.030		.005 ±.005	
21" ±.030		.005 ±.005	
22" ±.030		.005 ±.005	
23" ±.030		.005 ±.005	
24" ±.030		.005 ±.005	
25" ±.030		.005 ±.005	
26" ±.030		.005 ±.005	
27" ±.030		.005 ±.005	
28" ±.030		.005 ±.005	
29" ±.030		.005 ±.005	
30" ±.030		.005 ±.005	
31" ±.030		.005 ±.005	
32" ±.030		.005 ±.005	
33" ±.030		.005 ±.005	
34" ±.030		.005 ±.005	
35" ±.030		.005 ±.005	
36" ±.030		.005 ±.005	
37" ±.030		.005 ±.005	
38" ±.030		.005 ±.005	
39" ±.030		.005 ±.005	
40" ±.030		.005 ±.005	
41" ±.030		.005 ±.005	
42" ±.030		.005 ±.005	
43" ±.030		.005 ±.005	
44" ±.030		.005 ±.005	
45" ±.030		.005 ±.005	
46" ±.030		.005 ±.005	
47" ±.030		.005 ±.005	
48" ±.030		.005 ±.005	
49" ±.030		.005 ±.005	
50" ±.030		.005 ±.005	
51" ±.030		.005 ±.005	
52" ±.030		.005 ±.005	
53" ±.030		.005 ±.005	
54" ±.030		.005 ±.005	
55" ±.030		.005 ±.005	
56" ±.030		.005 ±.005	
57" ±.030		.005 ±.005	
58" ±.030		.005 ±.005	
59" ±.030		.005 ±.005	
60" ±.030		.005 ±.005	
61" ±.030		.005 ±.005	
62" ±.030		.005 ±.005	
63" ±.030		.005 ±.005	
64" ±.030		.005 ±.005	
65" ±.030		.005 ±.005	
66" ±.030		.005 ±.005	
67" ±.030		.005 ±.005	
68" ±.030		.005 ±.005	
69" ±.030		.005 ±.005	
70" ±.030		.005 ±.005	
71" ±.030		.005 ±.005	
72" ±.030		.005 ±.005	
73" ±.030		.005 ±.005	
74" ±.030		.005 ±.005	
75" ±.030		.005 ±.005	
76" ±.030		.005 ±.005	
77" ±.030		.005 ±.005	