

ITEM NO.	Part_Code	PART NUMBER	DESCRIPTION	QTY.
1	100754	8A-8049	Rear Cut-off Die	1
2	100724	8-8049	Front Cut-off Die	1
3	100725	9-8049	Wire Anvil	1
4	100726	9A-8049	Insulation Anvil	1
5	100753	12-8049	Cut-off Punch	1
6	100727	12A-8049	Cut-off Punch Spacer	1
7	100729	13-8049	Wire Rolling Tool	1
8	100730	14-8049	Insulation Rolling Tool	1
9	100731	26-8049	Hold Down	1
10	100756	34-8049	Wire Crimp Dial	1
11	100755	127S-3002	Insulation Tool Spacer	1
12	100732	200-8049	Baseplate	1
13	100733	303-8049	Feed Finger	1
14	100734	403-8049	Brake Shoe	1
15	100099	ED2-R	Frame	1
16	100104	ED3-R	Plunger	1
17	63709	ED4	Retainer	1
18	63731	ED5	Feed Adjustment Guide Block	1
19	63714	ED6	Spring Retainer	1
20	63733	ED7	Cam Roll Pin	1
21	63706	ED8	Cam Roller	1
22	63704	ED9	Feed Adjustment Block	1
23	64245	ED10	Feed Arm Pin	1
24	63717	ED11	Gib	2
25	63701	ED12	Feed Finger Shaft	1
26	63705	ED13	Adjustable Feed Piston	1
27	63700	ED14	Feed Arm	1
28	63659	ED44	Locating Dowel	1
29	63732	ED45	Feed Finger Spring	1
30	100105	ED51-R	Post Feed Cam	1
31	100106	ED52-R	Pre-Feed Cam	1
32	100097	ED199-R	Safety Guard	1
33	100098	ED1600-R	Standard Stripper	1
34	74491	GS-375	Guard Spacer	2
35	72310	MX104	Wave Disc Spring	1
36	74407	MX33	Mounting Post	1
37	74409	MX35	Insulation Dial	1
38	74411	MX36	Dial Spacer	1
39	74908	MX54-R	Slide Support	1
40	74816	MX55-R	Feed Plate	1
41	74817	MX56-R	Left Guide Rail	1
42	74818	MX57-R	Right Guide Rail	1
43	74820	MX91-R	Lifter Plate	1
44	74821	MX92-R	Brake Support	2
45	74822	MX93-R	Lifter	2
46	74823	MX94-R	Brake Shaft	1
47	74825	MX96-R	Brake Handle	1
48	74827	MX97-R	Retaining Ring	2
49	75342	LC-045E-6-M	Brake Spring	2
50	70739	McMaster-Carr #3126A53	Spring Plunger	2
51	64213	McMaster Carr #98370A28	1/4" Hardened Flatwasher	1
52	72069	McMaster Carr #98407A118	#8 E-Style Retaining Ring	2
53	64214	McMaster Carr #98407A122	#10 E-Style Retaining Ring	2
54	63734	McMaster Carr #98455A_122	Retaining Ring	1
55	63735	MS24585-1453	Piston Spring	1
56	73785	SPI 99-602-5	#10 Black Knurled Knob	2
57		8-32_.50bh	#8-32 x 1/2" Button Hd Cap Screw	2
58	63164	8-32_.50sh	#8-32 x 1/2" Socket Hd Cap Screw	3
59		8-32_.62bh	#8-32 x 5/8" Button Hd Cap Screw	2
60	63949	8-32_.88sh	#8-32 x 7/8" Socket Hd Cap Screw	4
61	63213	8-32_1.00sh	#8-32 x 1" Socket Hd Cap Screw	2
62	64215	10-32_.69sh	#10-32 x 11/16" Socket Hd Cap Screw	2
63	63054	10-32_.25ss	#10-32 x 1/4" Socket Hd Set Screw	4
64	63473	10-32_.25sh	#10-32 x 1/4" Socket Hd Cap Screw	1
65	78993	10-32_.38bh	#10-32 x 3/8" Button Hd Cap Screw	2
66	76501	10-32_.50bh	#10-32 x 1/2" Button Hd Cap Screw	8

NOTE: ITEMS MARKED IN BOLD TEXT ARE HIGH WEAR ITEMS

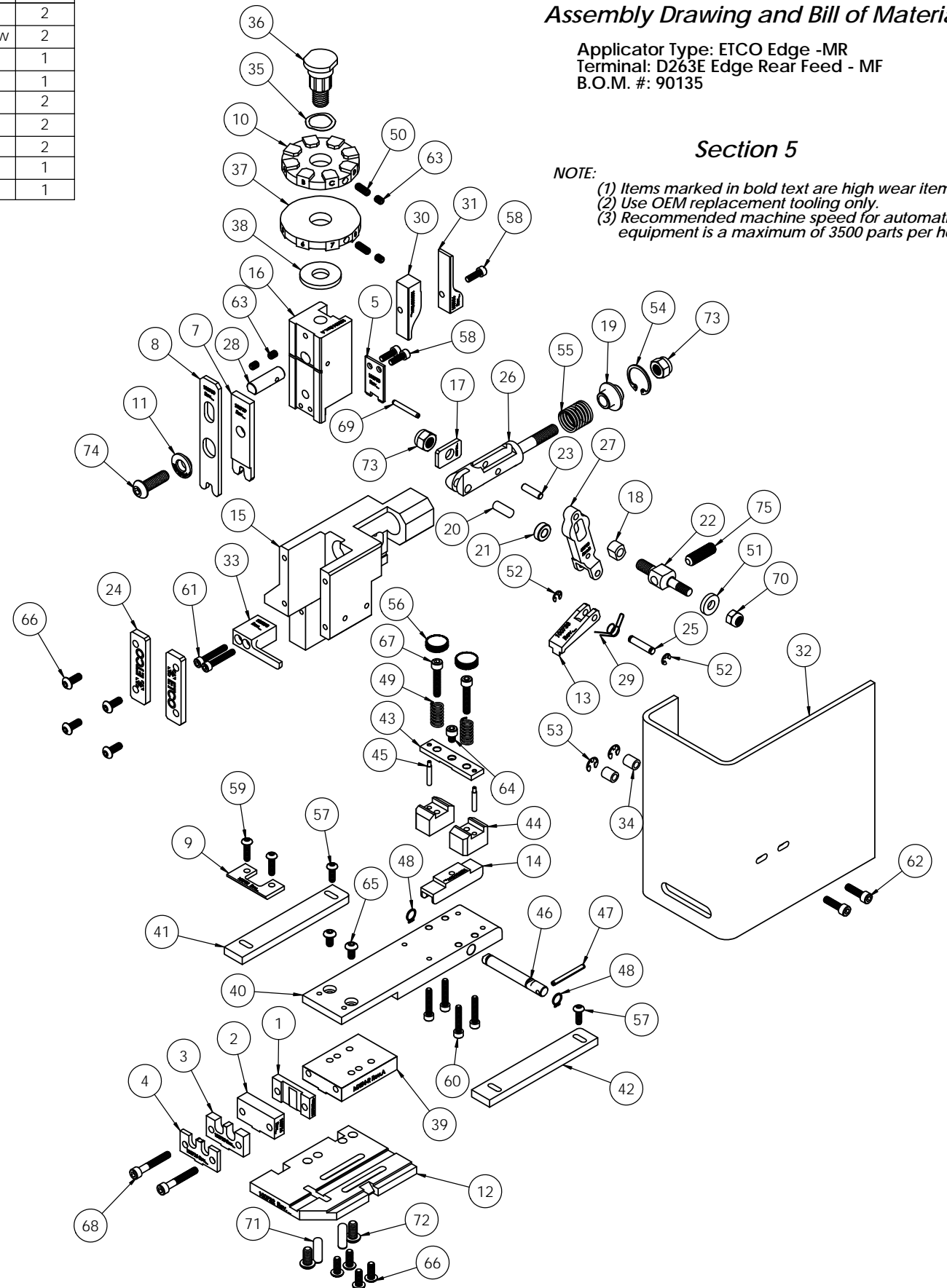

Assembly Drawing and Bill of Materials

Applicator Type: ETCO Edge -MR
Terminal: D263E Edge Rear Feed - MF
B.O.M. #: 90135

Section 5

- NOTE:**
- (1) Items marked in bold text are high wear items.
 - (2) Use OEM replacement tooling only.
 - (3) Recommended machine speed for automatic equipment is a maximum of 3500 parts per hour.

REV	DATE	DESCRIPTION	BY/DATE	APP	SCALE	DATE	BY/DATE	APP

DO NOT SCALE DRAWING	UNLESS OTHERWISE SPECIFIED DIMENSIONS ARE IN INCHES TOLERANCES ARE FRACTIONS DECIMALS ANGLES .1254 .001 .015 .0001 2 1/2	SURFACE FINISH ALL OVER

