

ITEM NO.	Part_Code	PART NUMBER	DESCRIPTION	QTY.
1	72884	8-5002	Cut-off Die	1
2	72598	9-5002	Wire Anvil	1
3	72599	9A-5002	Insulation Anvil	1
4	72885	12-5002	Cut-off Pad	1
5	72601	13-5002	*Wire Rolling Tool	1
6	72603	14-5002	Insulation Rolling Tool	1
7	61838	14-5002-1	Insulation Rolling Tool (Overlap)	1
8	72604	15-5002	Backing Dog	1
9	72886	15-5003	Cut-Off Driver	1
10	72224	1600-5001	Ejector Punch	1
11	100583	ED2-ITD-R	Frame (ITD Rear)	1
12	100584	ED3-ITD-R	Plunger	1
13	63709	ED4	Retainer	1
14	63731	ED5	Feed Adjustment Guide Block	1
15	63714	ED6	Spring Retainer	1
16	63733	ED7	Cam Roll Pin	1
17	63706	ED8	Cam Roller	1
18	63704	ED9	Feed Adjustment Block	1
19	64245	ED10	Feed Arm Pin	1
20	63717	ED11	Gib	2
21	63701	ED12	Feed Finger Shaft	1
22	63705	ED13	Adjustable Feed Piston	1
23	63700	ED14	Feed Arm	1
24	63732	ED45	Feed Finger Spring	1
25	100105	ED51-R	Post Feed Cam	1
26	100287	ED53-R	Pivot Pin	1
27	100288	ED100-R	Spring Bracket	1
28	100799	ED315-ITD-R	IRT Spacer	1
29	100050	ED324-ITD-S	Cut-off Pad Driver	1
30	100585	ED403-ITD-R	Base Plate	1
31	100786	ED419-ITD-R	Feed Finger	1
32	74407	MX33	Mounting Post	1
33	72234	MX34-G	Wire Crimp Dial	1
34	74409	MX35	Insulation Dial	1
35	74411	MX36	Dial Spacer	1
36	74412	MX44	Locating Dowel	1
37	74425	MX84-S	Brake Cam	1
38	74426	MX85-S	Cam Pivot Pin	1
39	74430	MX88-S	Lever	1
40	72310	MX104	Wave Disc Spring	1
41	76578	MX319-ITD-S	Knock off	1
42	72233	MX338-1-ITD-S	Arm Switch Cam	1
43	61993	MX358-2-ITD-S	Valve Mounting Plate	1
44	72203	MX401-ITD-R	Insulation Pusher	1
45	72202	MX402-ITD-R	CYLINDER MOUNTING BLOCK	1
46	72213	MX404-ITD-R	Right Guide Rail	1
47	72214	MX405-ITD-R	Left Guide Rail	1
48	72215	MX406-ITD-R	Brake Shoe	1
49	72216	MX407-ITD-R	Safety Guard	1
50	72217	MX408-ITD-R	Anvil Guide (Right)	1
51	72218	MX409-ITD-R	Anvil Guide Left	1
52	72219	MX410-ITD-R	Die Plate	1
53	72220	MX411-ITD-R	TERMINAL GUIDE BLOCK	1
54	72223	MX414-ITD-R	Slide Cover	1
55	72225	MX416-ITD-R	Lift Arm	1
56	72227	MX417-ITD-R	Slide Cylinder	1
57	72232	MX420-ITD-R	Guard Spacer	2
58	78984	MX424-ITD-R	#8 Hardened Washer	1
59	70021	MX425-ITD-R	Valve Mounting Plate	1
60	72317	Clippard #12296	Cam Follower	1
61	72318	Clippard MJV-3	3-Way Valve	1
62	74882	Irving 3100-25	Ø1/4" External Retaining Ring	2
63	72315	LC-022A-4	Compression Spring	2
64	72355	LC-032C-12-M	Compression Spring	2
65	72353	LC-038C-8-M	Ejector Punch Spring	1
66	77322	LC-045E-10-M	Spring	2
67	74611	LE-037CD-6	Extension Spring	1
68	70739	McMaster-Carr #3126A53	Spring Plunger	2

ITEM NO.	Part_Code	PART NUMBER	DESCRIPTION	QTY.
69	64213	McMaster Carr #98370A28	1/4" Hardened Flatwasher	1
70	72069	McMaster Carr #98407A118	#8 E-Style Retaining Ring	2
71	63734	McMaster Carr #98455A_122	Retaining Ring	1
72	63735	MS24585-1453	Piston Spring	1
73	73222	Pisco PC250-N1U	1/4" x 1/8" NPT Straight	1
74	72352	Pisco PL250-N1U	Ø1/4" x 1/8"-NPT Elbow Fitting	3
75	73785	SPI 99-602-5	#10 Black Knurled Knob	2
76	63207	6-32_25sh	#6-32 x 1/4" Socket Hd Cap Screw	4
77	69493	6-32_75sh	#6-32 x 3/4" Socket Hd Cap Screw	1
78	60265	8-32_19sh	#8-32 x 3/16" Socket Hd Cap Screw	1
79	100091	8-32_31sh	#8-32 x 5/16" Socket Hd Cap Screw	1
80	63161	8-32_38sh	#8-32 x 3/8" Socket Hd Cap Screw	2
81	63162	8-32_63sh	#8-32 x 5/8" Socket Hd Cap Screw	2
82	63753	10fw	#10 Flatwasher	1
83		10-24_38fh	#10-24 x 3/8" Flat Hd Socket Screw	2
84	63054	10-32_25ss	#10-32 x 1/4" Socket Hd Set Screw	7
85	63473	10-32_25sh	#10-32 x 1/4" Socket Hd Cap Screw	1
86	78687	10-32_25bh	#10-32 x 1/4" Button Hd Cap Screw	2
87	78993	10-32_38bh	#10-32 x 3/8" Button Hd Cap Screw	4
88	76501	10-32_50bh	#10-32 x 1/2" Button Hd Cap Screw	10
89	63155	10-32_1.00sh	#10-32 x 1" Socket Hd Cap Screw	2
90	77396	10-32_1.25sh	#10-32 x 1 1/4" Socket Hd Cap Screw	6
91	78517	10lw	#10 Lockwasher	2
92	62040	1.8_1.00rp	1/8" x 1" Roll Pin	1
93	63632	1.4-20_50bh	1/4-20 x 1/2" Button Hd Cap Screw	2
94	64215	1.4_75dp	1/4" x 3/4" Dowel Pin	2
95		1.4-20_1.37sh	1/4-20 x 1-3/8" Socket Hd Cap Screw	2
96	63707	1.4_20 LN	1/4-20 Lock Nut	1
97	63055	5.16-18_1.00bh	5/16-18 x 1" Button Hd Cap Screw	1
98	63708	5.16-18 LN	5/16-18 Lock Nut	2
99	71086	5.16-24_75ssf	5/16-24 x 3/4" Socket Hd Set Screw	1
100	64216	5.16-24_1.00ssf	5/16-24 x 1" Socket Hd Set Screw	1
101		15.32_32 hex nut	Hex Nut	1
102		1.2isw	1/2" Internal Star Washer	1

NOTE: ITEMS MARKED IN BOLD TEXT ARE HIGH WEAR ITEMS

Assembly Drawing and Bill of Materials

Applicator Type:
IP Edge Rear Feed Applicator
Terminal: PDF225 Rear EDGE
B.O.M. #: 90146

Section 5

- NOTE:**
- (1) Items marked in bold text are high wear items.
 - (2) Use OEM replacement tooling only.
 - (3) Recommended machine speed for automatic equipment is a maximum of 3500 parts per hour.

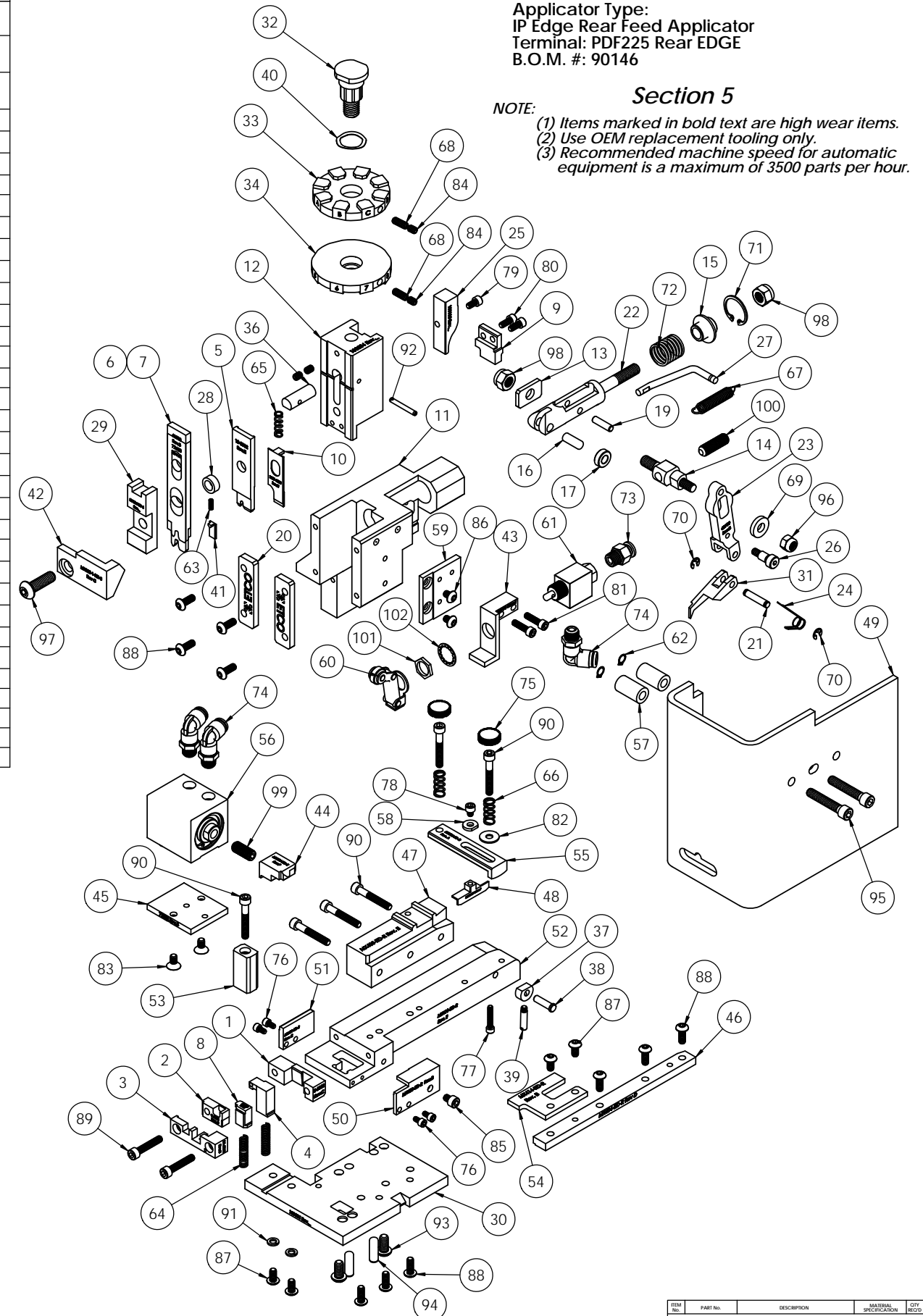

REV	DESCRIPTION	DATE	BY	CHKD	APP

DO NOT SCALE DRAWING	UNLESS OTHERWISE SPECIFIED DIMENSIONS ARE IN INCHES. TOLERANCES ARE:
FRACTIONS: DECIMALS: ANGLES:	±.004 ±.01 ±.015 ±.030 ±.0005 FID
SURFACE FINISH: ALL OVER	
THE INFORMATION CONTAINED HEREIN IS THE PROPERTY OF ETICO ENGINEERED PRODUCTS. IT IS TO BE USED ONLY FOR THE PURPOSES SPECIFIED HEREIN. NO OTHER REPRODUCTION OR TRANSMISSION IS PERMITTED WITHOUT THE WRITTEN PERMISSION OF ETICO ENGINEERED PRODUCTS.	

PART LIST	
See Parts List	
ETICO ENGINEERED PRODUCTS 25 BELLOWS STREET WARWICK, RI 02888 (401) 467-2400	
IP Edge Rear Feed Applicator	
PDF225 Rear EDGE	
CHECKED BY: DATE: 2/11/20	