

Assembly Drawing and Bill of Materials

Applicator Type: ETCO Edge -MR
Terminal: DF240L Edge Rear Feed - MF
B.O.M. #: 90181

Section 5
NOTE:
(1) Items marked in bold text are high wear items.
(2) Use OEM replacement tooling only.
(3) Recommended machine speed for automatic equipment is a maximum of 3500 parts per hour.

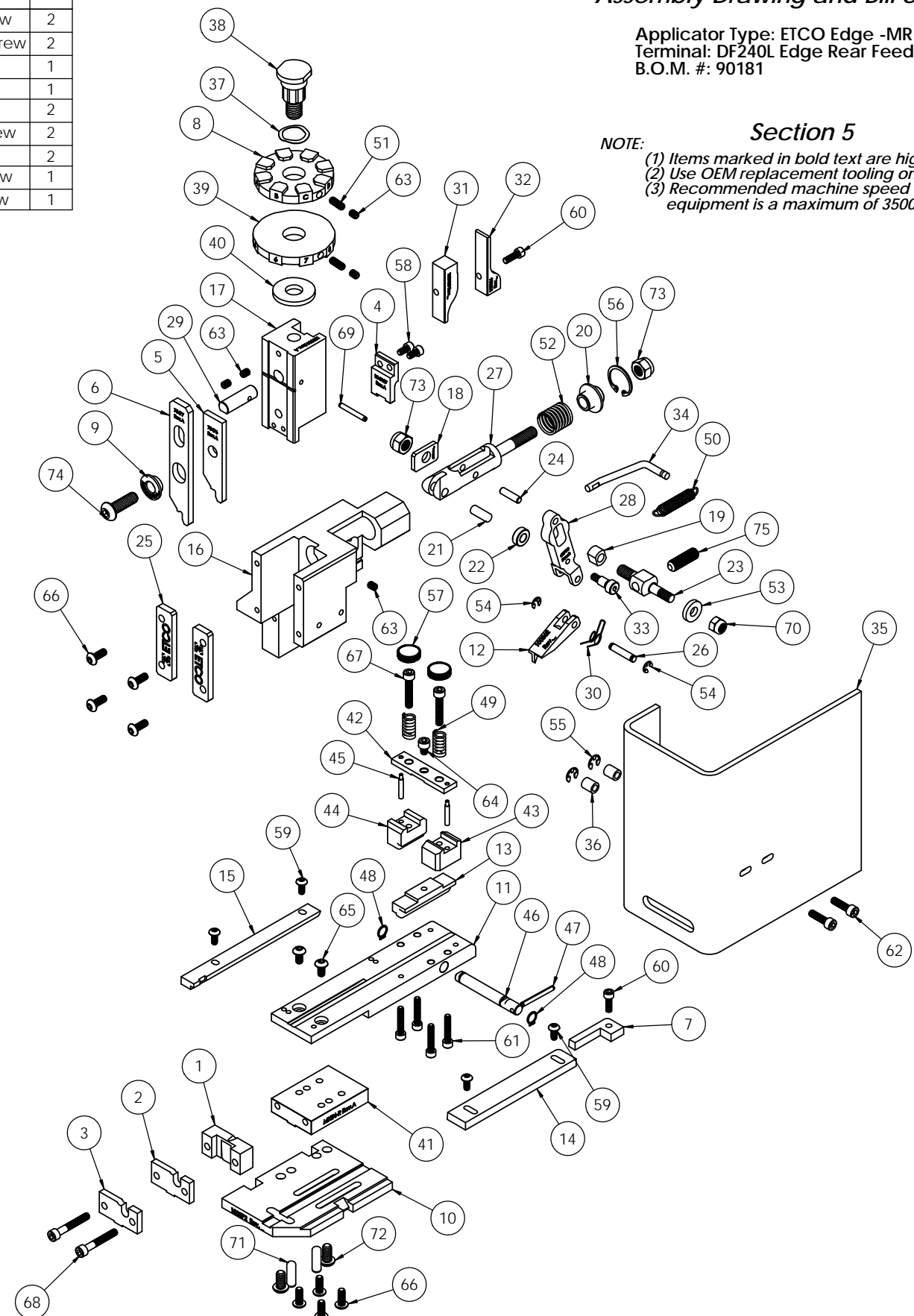

NOTE: ITEMS MARKED IN BOLD TEXT ARE HIGH WEAR ITEMS

ITEM NO.	Part_Code	PART NUMBER	DESCRIPTION	QTY.	ITEM NO.	Part_Code	PART NUMBER	DESCRIPTION	QTY.
1	78474	8-3125	Rear Cut-Off Die	1	67	63155	10-32_1.00sh	#10-32 x 1" Socket Hd Cap Screw	2
2	78475	9-3125	Wire Anvil	1	68	77396	10-32_1.25sh	#10-32 x 1 1/4" Socket Hd Cap Screw	2
3	78481	9A-3125	Insulation Anvil	1	69	62040	1.8_1.00rp	1/8" x 1" Roll Pin	1
4	71258	12-3107	Cut-Off Punch	1	70	63707	1.4_20 LN	1/4-20 Lock Nut	1
5	78476	13-3125	Wire Rolling Tool	1	71	64215	1.4_.75dp	1/4" x 3/4" Dowel Pin	2
6	78477	14-3125	Insulation Rolling Tool	1	72	63632	1.4-20_.50bh	1/4-20 x 1/2" Button Hd Cap Screw	2
7	100872	26-3125	Guide Block	1	73	63708	5.16-18 LN	5/16-18 Lock Nut	2
8	71311	34-3107	Wire Crimp Dial	1	74	63055	5.16-18_1.00bh	5/16-18 x 1" Button Hd Cap Screw	1
9	63728	188S-3002	Insulation Tool Spacer	1	75	64216	5.16-24_1.00ssf	5/16-24 x 1" Socket Hd Set Screw	1
10	100572	200-8039	Baseplate	1					
11	78478	250-3125	Feed Plate	1					
12	100862	303-8060	Feed Finger	1					
13	71260	403-3107	Brake	1					
14	78479	500-3125	Right Guide Rail	1					
15	78480	1000-3125	Left Guide Rail	1					
16	100099	ED2-R	Frame	1					
17	100104	ED3-R	Plunger	1					
18	63709	ED4	Retainer	1					
19	63731	ED5	Feed Adjustment Guide Block	1					
20	63714	ED6	Spring Retainer	1					
21	63733	ED7	Cam Roll Pin	1					
22	63706	ED8	Cam Roller	1					
23	63704	ED9	Feed Adjustment Block	1					
24	64245	ED10	Feed Arm Pin	1					
25	63717	ED11	Gib	2					
26	63701	ED12	Feed Finger Shaft	1					
27	63705	ED13	Adjustable Feed Piston	1					
28	63700	ED14	Feed Arm	1					
29	63659	ED44	Locating Dowel	1					
30	63732	ED45	Feed Finger Spring	1					
31	100105	ED51-R	Post Feed Cam	1					
32	100106	ED52-R	Pre-Feed Cam	1					
33	100287	ED53-R	Pivot Pin	1					
34	100288	ED100-R	Spring Bracket	1					
35	100097	ED199-R	Safety Guard	1					
36	74491	GS-375	Guard Spacer	2					
37	72310	MX104	Wave Disc Spring	1					
38	74407	MX33	Mounting Post	1					
39	74409	MX35	Insulation Dial	1					
40	77605	MX36-135	Spacer Washer	1					
41	74908	MX54-R	Slide Support	1					
42	74820	MX91-R	Lifter Plate	1					
43	74821	MX92-R	Brake Support	1					
44	71257	MX92-R-3107	Riser Block	1					
45	74822	MX93-R	Lifter	2					
46	74823	MX94-R	Brake Shaft	1					
47	74825	MX96-R	Brake Handle	1					
48	74827	MX97-R	Retaining Ring	2					
49	75342	LC-045E-6-M	Brake Spring	2					
50	74611	LE-037CD-6	Extension Spring	1					
51	70739	McMaster-Carr #3126A53	Spring Plunger	2					
52	63735	MS24585-1453	Piston Spring	1					
53	64213	McMaster Carr #98370A28	1/4" Hardened Flatwasher	1					
54	72069	McMaster Carr #98407A118	#8 E-Style Retaining Ring	2					
55	64214	McMaster Carr #98407A122	#10 E-Style Retaining Ring	2					
56	63734	McMaster Carr #98455A_122	Retaining Ring	1					
57	73785	SPI 99-602-5	#10 Black Knurled Knob	2					
58	100091	8-32_.31sh	#8-32 x 5/16" Socket Hd Cap Screw	2					
59	61472	8-32_.38bh	#8-32 x 3/8" Button Hd Cap Screw	4					
60	63164	8-32_.50sh	#8-32 x 1/2" Socket Hd Cap Screw	2					
61	63949	8-32_.88sh	#8-32 x 7/8" Socket Hd Cap Screw	4					
62	64215	10-32_.69sh	#10-32 x 11/16" Socket Hd Cap Screw	2					
63	63054	10-32_.25ss	#10-32 x 1/4" Socket Hd Set Screw	5					
64	63473	10-32_.25sh	#10-32 x 1/4" Socket Hd Cap Screw	1					
65	78993	10-32_.38bh	#10-32 x 3/8" Button Hd Cap Screw	2					
66	76501	10-32_.50bh	#10-32 x 1/2" Button Hd Cap Screw	8					

DO NOT SCALE DRAWING		UNLESS OTHERWISE SPECIFIED DIMENSIONS ARE IN INCHES. TOLERANCES ARE:		FRACTIONS		DECIMALS		ANGLES	
1/16"		.005"		.010"		.015"		.031"	
SURFACE FINISH		ALL OVER		FINISH		USED ON		SCALE	
1:2		1:2		1:2		1:2		1:2	
DATE		DATE		DATE		DATE		DATE	
9/10/20		9/10/20		9/10/20		9/10/20		9/10/20	