

| ITEM NO. | Part Code | PART NUMBER | DESCRIPTION | QTY. |
|----------|-----------|---------------------------|-----------------------------------|------|
| 1 | 63963 | 8-3152 | Cut-Off Die | 1 |
| 2 | 63964 | 9-3152-CF977-5-12 | Anvil | 1 |
| 3 | 63966 | 12-3152 | Cut-Off Punch | 1 |
| 4 | 63965 | 13-3152-CF977-5-12 | Wire Rolling Tool | 1 |
| 5 | 61540 | 26-3114 | Back-Up Block | 1 |
| 6 | 72803 | 34-3073 | Wire Crimp Dial | 8 |
| 7 | 100554 | 35-8000 | No Insulation Dial | 1 |
| 8 | 76403 | 199-3005 | Safety Guard | 1 |
| 9 | 100701 | 200-8047 | Baseplate | 1 |
| 10 | 63967 | 250-3152 | Feed Plate | 1 |
| 11 | 64261 | 303-8001 | Feed Finger | 1 |
| 12 | 63975 | 500-3152 | Rear Guide Rail | 1 |
| 13 | 63970 | 1600A-3152 | Adjustable Stripper Block | 1 |
| 14 | 74803 | 1600B-3000 | Adjustable Stripper Holder | 1 |
| 15 | 63660 | ED2-M | Frame | 1 |
| 16 | 63658 | ED3 | Plunger | 1 |
| 17 | 63709 | ED4 | Retainer | 1 |
| 18 | 63731 | ED5 | Feed Adjustment Guide Block | 1 |
| 19 | 63714 | ED6 | Spring Retainer | 1 |
| 20 | 63733 | ED7 | Cam Roll Pin | 1 |
| 21 | 63706 | ED8 | Cam Roller | 1 |
| 22 | 63704 | ED9 | Feed Adjustment Block | 1 |
| 23 | 64245 | ED10 | Feed Arm Pin | 1 |
| 24 | 63717 | ED11 | Gib | 2 |
| 25 | 63701 | ED12 | Feed Finger Shaft | 1 |
| 26 | 63705 | ED13 | Adjustable Feed Piston | 1 |
| 27 | 63700 | ED14 | Feed Arm | 1 |
| 28 | 63702 | ED16 | Feed Finger Retainer | 1 |
| 29 | 63659 | ED44 | Locating Dowel | 1 |
| 30 | 63732 | ED45 | Feed Finger Spring | 1 |
| 31 | 63715 | ED51 | Post-feed Cam | 1 |
| 32 | 63716 | ED52 | Pre-Feed Cam | 1 |
| 33 | 74491 | GS-375 | Guard Spacer | 2 |
| 34 | 74840 | MX28-1-S | Front Guide Rail | 1 |
| 35 | 74384 | MX29-S | Slide Support | 1 |
| 36 | 74388 | MX30-S | Support Anchor | 1 |
| 37 | 74390 | MX32-S | Support Cover | 1 |
| 38 | 74407 | MX33 | Mounting Post | 1 |
| 39 | 74411 | MX36 | Dial Spacer | 1 |
| 40 | 74425 | MX84-S | Brake Cam | 1 |
| 41 | 74426 | MX85-S | Cam Pivot Pin | 1 |
| 42 | 74428 | MX86-S | Brake Shoe | 1 |
| 43 | 75178 | MX87-S | Lift Arm | 1 |
| 44 | 74430 | MX88-S | Lever | 1 |
| 45 | 72310 | MX104 | Wave Disc Spring | 1 |
| 46 | 62481 | Producto #MP-02 | 3/8" x 1" Blue Die Spring | 2 |
| 47 | 70739 | McMaster-Carr #3126A53 | Spring Plunger | 1 |
| 48 | 64213 | McMaster Carr #98370A28 | 1/4" Hardened Flatwasher | 1 |
| 49 | 72519 | McMaster Carr #98029A043 | #8 Hardened Washer | 1 |
| 50 | 72069 | McMaster Carr #98407A118 | #8 E-Style Retaining Ring | 2 |
| 51 | 64214 | McMaster Carr #98407A122 | #10 E-Style Retaining Ring | 2 |
| 52 | 63734 | McMaster Carr #98455A_122 | Retaining Ring | 1 |
| 53 | 63735 | MS24585-1453 | Piston Spring | 1 |
| 54 | 73785 | SPI 99-602-5 | #10 Black Knurled Knob | 2 |
| 55 | 62040 | 1.8_1.00rp | 1/8" x 1" Roll Pin | 1 |
| 56 | 63792 | 6-32_.25bh | #6-32 x 1/4" Button Hd Cap Screw | 2 |
| 57 | 63207 | 6-32_.25sh | #6-32 x 1/4" Socket Hd Cap Screw | 6 |
| 58 | 60265 | 8-32_.19sh | #8-32 x 3/16" Socket Hd Cap Screw | 1 |
| 59 | 63163 | 8-32_.25sh | #8-32 x 1/4" Socket Hd Cap Screw | 3 |
| 60 | 77097 | 8-32_.31bh | #8-32 x 5/16" Button Hd Cap Screw | 1 |
| 61 | 100091 | 8-32_.31sh | #8-32 x 5/16" Socket Hd Cap Screw | 1 |
| 62 | 63161 | 8-32_.38sh | #8-32 x 3/8" Socket Hd Cap Screw | 1 |
| 63 | 61472 | 8-32_.38bh | #8-32 x 3/8" Button Hd Cap Screw | 5 |
| 64 | 63054 | 10-32_.25ss | #10-32 x 1/4" Socket Hd Set Screw | 2 |
| 65 | 78993 | 10-32_.38bh | #10-32 x 3/8" Button Hd Cap Screw | 1 |
| 66 | 76501 | 10-32_.50bh | #10-32 x 1/2" Button Hd Cap Screw | 6 |

NOTE: ITEMS MARKED IN BOLD TEXT ARE HIGH WEAR ITEMS

| ITEM NO. | Part Code | PART NUMBER | DESCRIPTION | QTY. |
|----------|-----------|-----------------|-------------------------------------|------|
| 67 | 63056 | 10-32_.50sh | #10-32 x 1/2" Socket Hd Cap Screw | 2 |
| 68 | 64215 | 10-32_.69sh | #10-32 x 11/16" Socket Hd Cap Screw | 2 |
| 69 | 77396 | 10-32_1.25sh | #10-32 x 1 1/4" Socket Hd Cap Screw | 1 |
| 70 | 63826 | 10-32_1.50sh | #10-32 x 1 1/2" Socket Hd Cap Screw | 2 |
| 71 | 63632 | 1.4-20_.50bh | 1/4-20 x 1/2" Button Hd Cap Screw | 2 |
| 72 | 64215 | 1.4_.75dp | 1/4" x 3/4" Dowel Pin | 2 |
| 73 | 63707 | 1.4_20 LN | 1/4-20 Lock Nut | 1 |
| 74 | 63055 | 5.16-18_1.00bh | 5/16-18 x 1" Button Hd Cap Screw | 1 |
| 75 | 63708 | 5.16-18 LN | 5/16-18 Lock Nut | 2 |
| 76 | 64216 | 5.16-24_1.00ssf | 5/16-24 x 1" Socket Hd Set Screw | 1 |

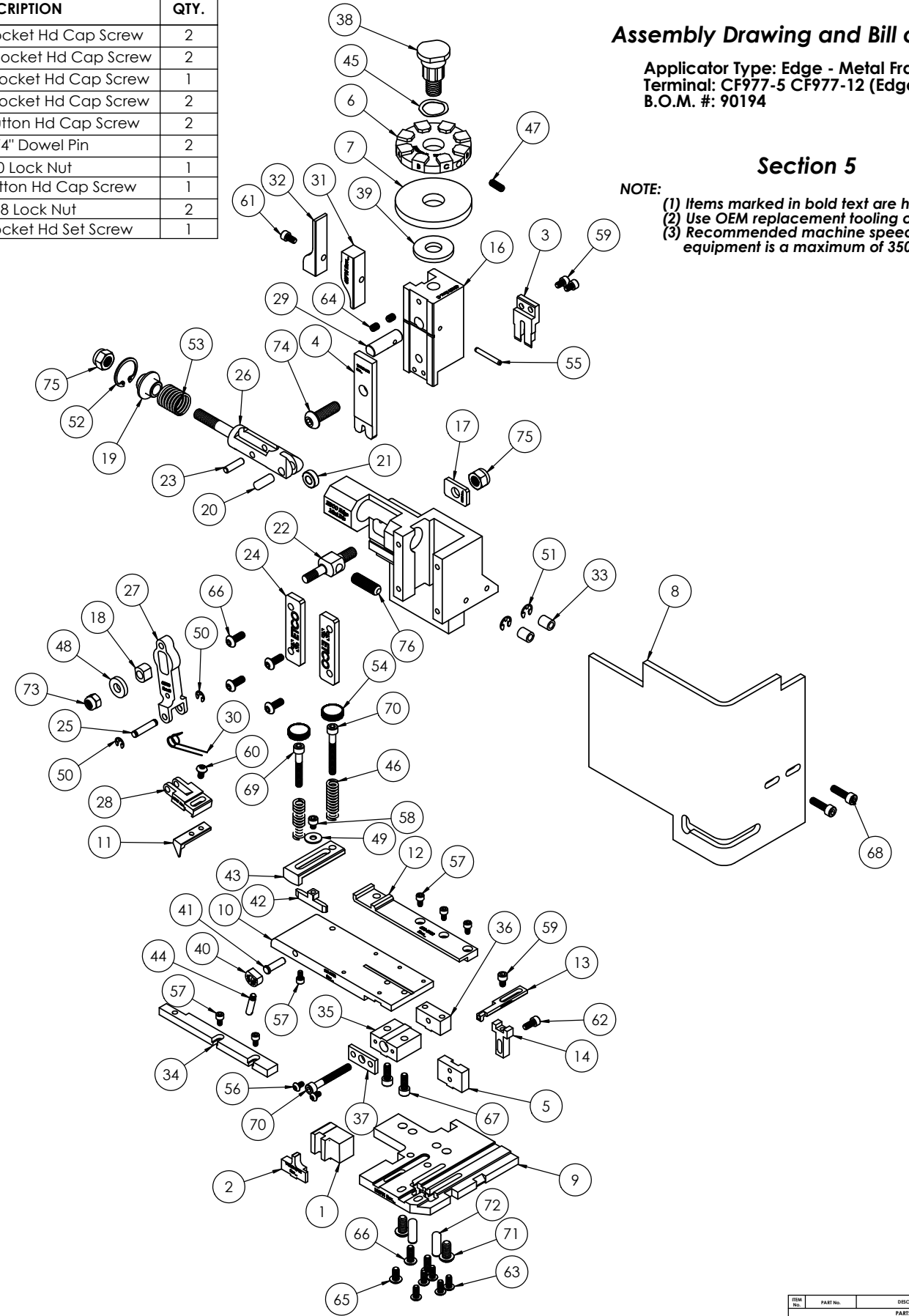

Assembly Drawing and Bill of Materials

Applicator Type: Edge - Metal Frame - L-R
Terminal: CF977-5 CF977-12 (Edge MF)
B.O.M. #: 90194

Section 5

- NOTE:**
- (1) Items marked in bold text are high wear items.
 - (2) Use OEM replacement tooling only.
 - (3) Recommended machine speed for automatic equipment is a maximum of 3500 parts per hour.

| | | | | |
|---|----------|--|------------------------|---------|
| DO NOT SCALE DRAWING | | UNLESS OTHERWISE SPECIFIED DIMENSIONS ARE IN INCHES. TOLERANCES ARE: | | |
| FRACTIONS | DECIMALS | ANGLES | | |
| ±1/64 | ±.001 | ±1/2° | | |
| | ±.0005 | ±.0001 | | |
| SURFACE FINISH: <input checked="" type="checkbox"/> ALL OVER | | | | |
| THE INFORMATION CONTAINED WITHIN THIS DRAWING IS THE SOLE PROPERTY OF ETICO OR WHOSE WHOLE OR PARTS THEREOF ARE REPRODUCED IN ANY MANNER WITHOUT THE WRITTEN PERMISSION OF ETICO IS PROHIBITED. | | | | |
| ITEM NO. | PART NO. | DESCRIPTION | MATERIAL SPECIFICATION | QTY. |
| PARTS LIST | | | | |
| ETICO ENGINEERED PRODUCTS 25 BELLOWS STREET WARWICK, RI 02888 (401) 467-2400 | | | | |
| CF977-5 CF977-12 Edge Metal Frame - L-R | | | | |
| DATE: 12/12/2020 | | | | |
| SCALE: 1:2 | | | | |
| DRAWN BY: SCJ | | | | |
| CHECKED BY: DATE: 12/12/2020 | | | | |
| REVISION | | | | |
| LVL | REVISION | BY/DATE | APPLICATION | USED ON |