

P/C	DESCRIPTION	MAT'L	COLOR	TEMPERATURE
18079	CB67-BS	SILICONE	BLACK	400°

Rev.	Description of Change/ SCN#	Date
1	Redrawn in Sw for ACAD Org.Eng.Dwg.Date: 1/23/03	10/17/19

NOTE: FOR MAXIMUM PERFORMANCE AND RELIABILITY,  
ALWAYS USE ETCO ENGINEERED IGNITION TERMINALS  
WITH ETCO AUTOMOTIVE INSULATORS.

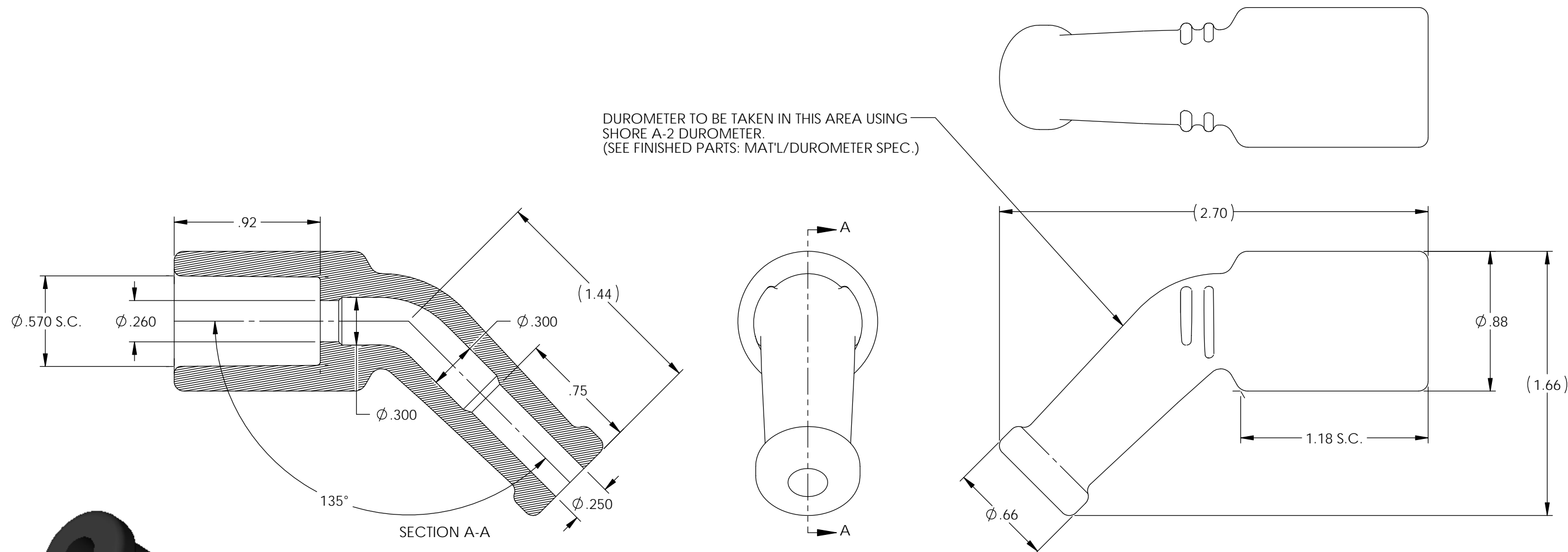

## UNCONTROLLED COPY

 THIRD ANGLE PROJECTION TOLERANCES UNLESS OTHERWISE SPECIFIED INCHES: .XX - ±.030 .XXX - ±.015 ANGLES: ±2°	TOOL NO. <b>2235</b>	Title: <b>135° Coil Boot</b>		
	 <b>ETCO</b>	DO NOT SCALE DWG.	Drawn By: <b>S.Johnson</b>	Date: <b>10/17/19</b>
		ETCO Incorporated Engineered Products 25 Bellows Street Warwick, RI 02888 Phone: (401) 467-2400 Fax: (401) 467-9230 www.ETCO.com	Design Control By: <b>ETCO</b>	Scale: <b>3:2</b> Size <b>B</b>
		Dwg. No.: <b>CB67 cust</b>		