

NOTES:

- MATERIAL: .020 THICK BRASS
#3 TEMPER (3/4 HARD)
PER ETCO METAL CODE 0-0016.
- MATERIAL: .020 THICK S430 STAINLESS STEEL
BRIGHT ANNEALED
PER ETCO METAL CODE 0-0069.
- PARTS MAY BE COATED WITH A LIGHT FILM OF LUBRICATION USED IN THE MANUFACTURING PROCESS.
- TERMINAL MUST BE CAPABLE OF A 90° BEND IN THE FORWARD DIRECTION WITHOUT FRACTURE OR TWIST.
- WIRE RANGE: 8mm.

| P/C | DESCRIPTION | MAT'L | REWIND | CLIP |
|-------|-------------|--------|--------|--------|
| 15248 | DT1000-HB | NOTE 1 | NO | SCA209 |
| 15249 | DT1000-HB-R | NOTE 1 | YES | SCA209 |
| 15313 | DT1000-SS | NOTE 2 | NO | SCA209 |
| 15318 | DT1000-SS-R | NOTE 2 | YES | SCA209 |

| Rev. | Description of Change/ SCN# | Date |
|------|--|----------|
| 1 | Redrawn in SW from ACAD Org.Eng.Dwg.Date: 3/19/02 | 12/14/18 |

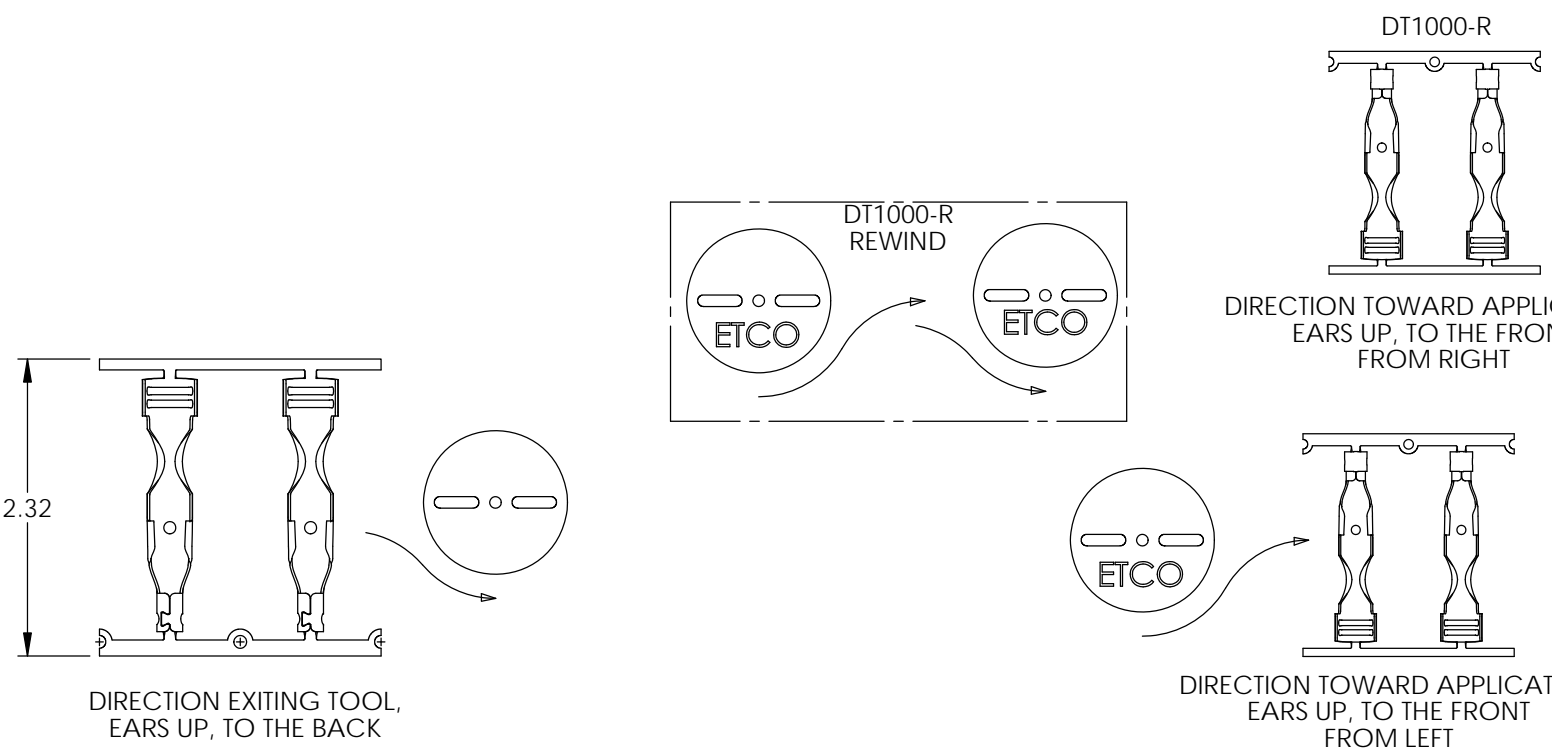
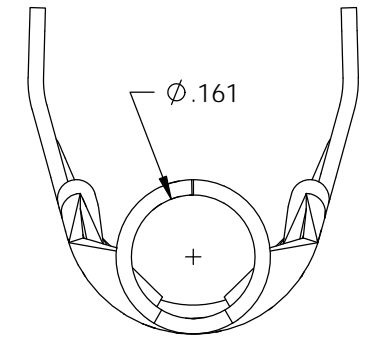
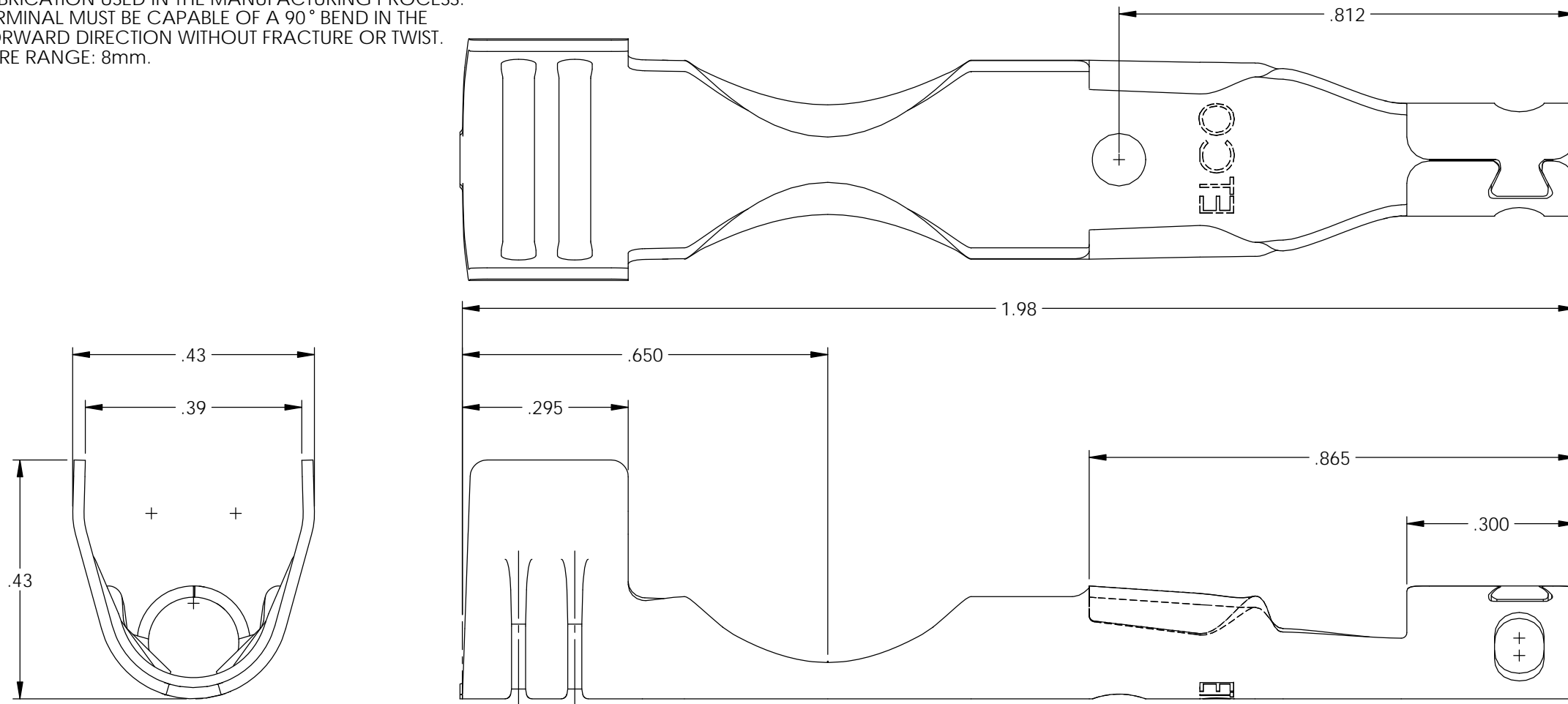

UNCONTROLLED COPY

| | | | | |
|---|---------------------------------|--|------------------------------|--------------------------|
| <p>THIRD ANGLE PROJECTION TOLERANCES UNLESS OTHERWISE SPECIFIED INCHES: .XX - ±.030 .XXX - ±.015 ANGLES: ±5°</p> | <p>TOOL NO. 2204</p> | <p>Title: Distributor Terminal</p> | | |
| | <p>DO NOT SCALE DWG.</p> | <p>Drawn By: S.Johnson</p> | <p>Date: 12/14/18</p> | |
| <p>ETCO Incorporated Engineered Products 25 Bellows Street Warwick, RI 02888 Phone: (401) 467-2400 Fax: (401) 467-9230 www.ETCO.com</p> | | <p>Design Controlled By: ETCO</p> | <p>Scale: 4X</p> | <p>Size B</p> |
| | | <p>Dwg. No.: DT1000 cust</p> | | |