

NOTES:

1. MATERIAL: .028 THICK C26000 BRASS; 1/2 HARD, ANNEALED TO TEMPER, PER ETCO METAL CODE 07009.
2. PARTS MAY BE COATED WITH A LIGHT FILM OF LUBRICATION USED IN THE MANUFACTURING PROCESS.
3. WIRE RANGE: #12-#14 AWG.

P/C	DESCRIPTION	MAT'L
82200	INDLINECT-HB	NOTE 1

Rev.	Description of Change/ SCN#	Date
1	TRANSFERED FROM CP SCJ	8-7-08

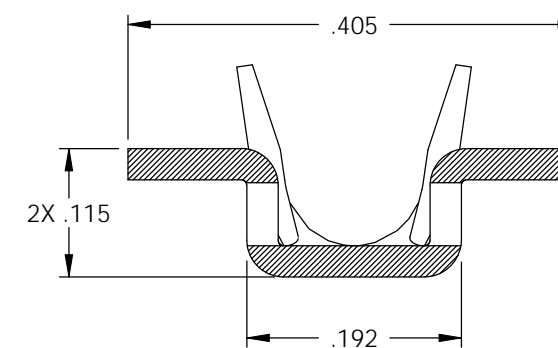
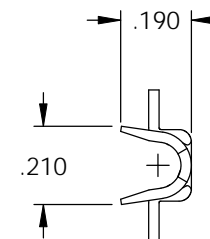
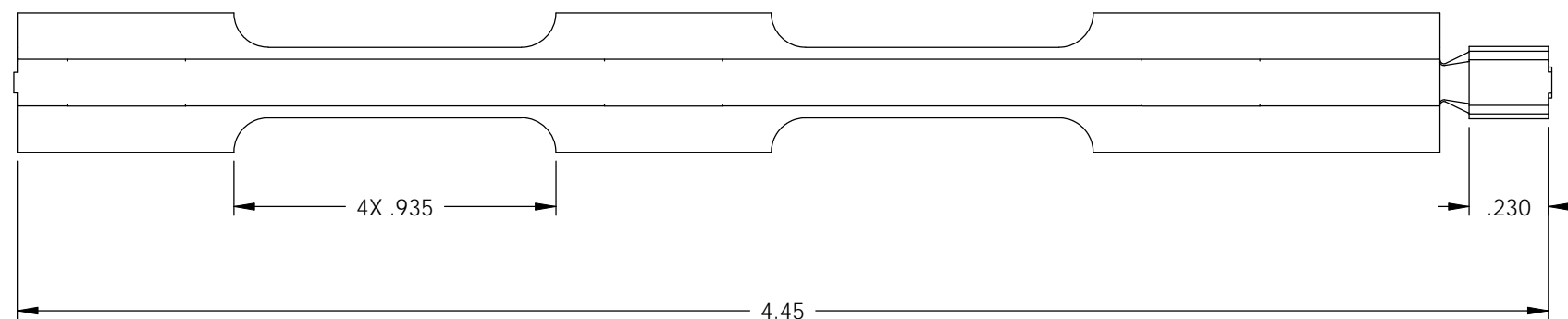

SECTION A-A
SCALE 6 : 1

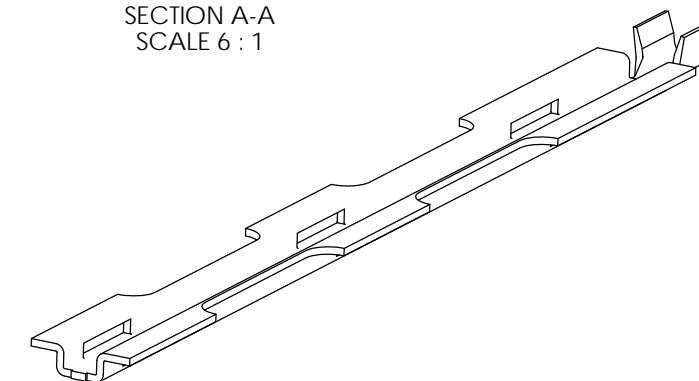
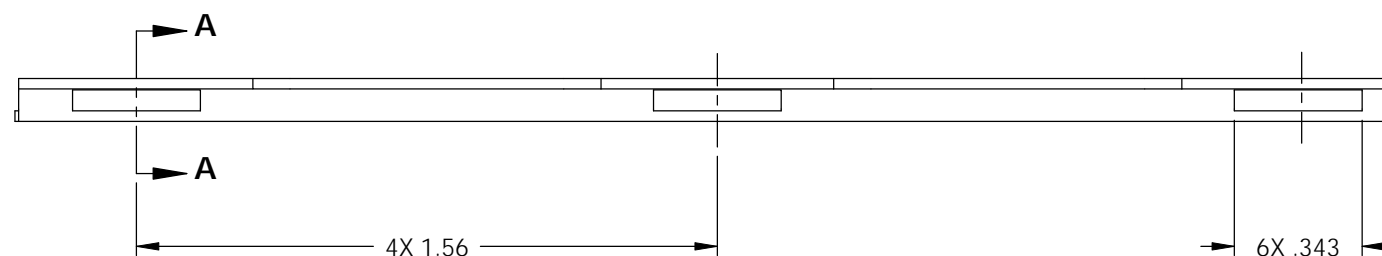

UNCONTROLLED COPY

<p>THIRD ANGLE PROJECTION TOLERANCES UNLESS OTHERWISE SPECIFIED INCHES: .XX - ±.030 .XXX - ±.015 ANGLES: ±5°</p>	<p>TOOL NO. 0833</p>	<p>Title: INDOOR LINE CONTACT</p>			
		<p>ETCO Incorporated Engineered Products 25 Bellows Street Warwick, RI 02888 Phone: (401) 467-2400 Fax: (401) 467-9230 www.ETCO.com</p>	<p>DO NOT SCALE DWG.</p>	<p>Drawn By: S.JOHNSON</p>	<p>Date: 8-7-08</p>
		<p>Chk'd/App'd By:</p>	<p>Scale: 2X</p>	<p>Size B</p>	<p>Dwg. No.: INDLINECT cust</p>