

- NOTES:
 1. MATERIAL: .016 THICK PHOSPHOR BRONZE,
 #3 TEMPER (3/4 HARD)
 PER ETCO METAL CODE 2-3535.
 2. WIRE RANGE: 18-16 AWG.

P/C	DESCRIPTION
09718	LSWB2-PB

Rev.	Description of Change/ SCN#	Date
-	Redrawn in SW/No chgs SCJ	3/18/14

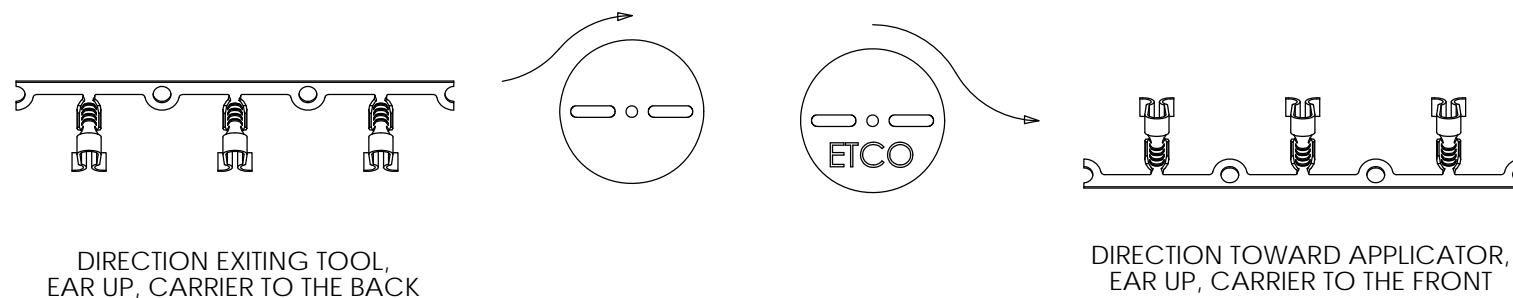
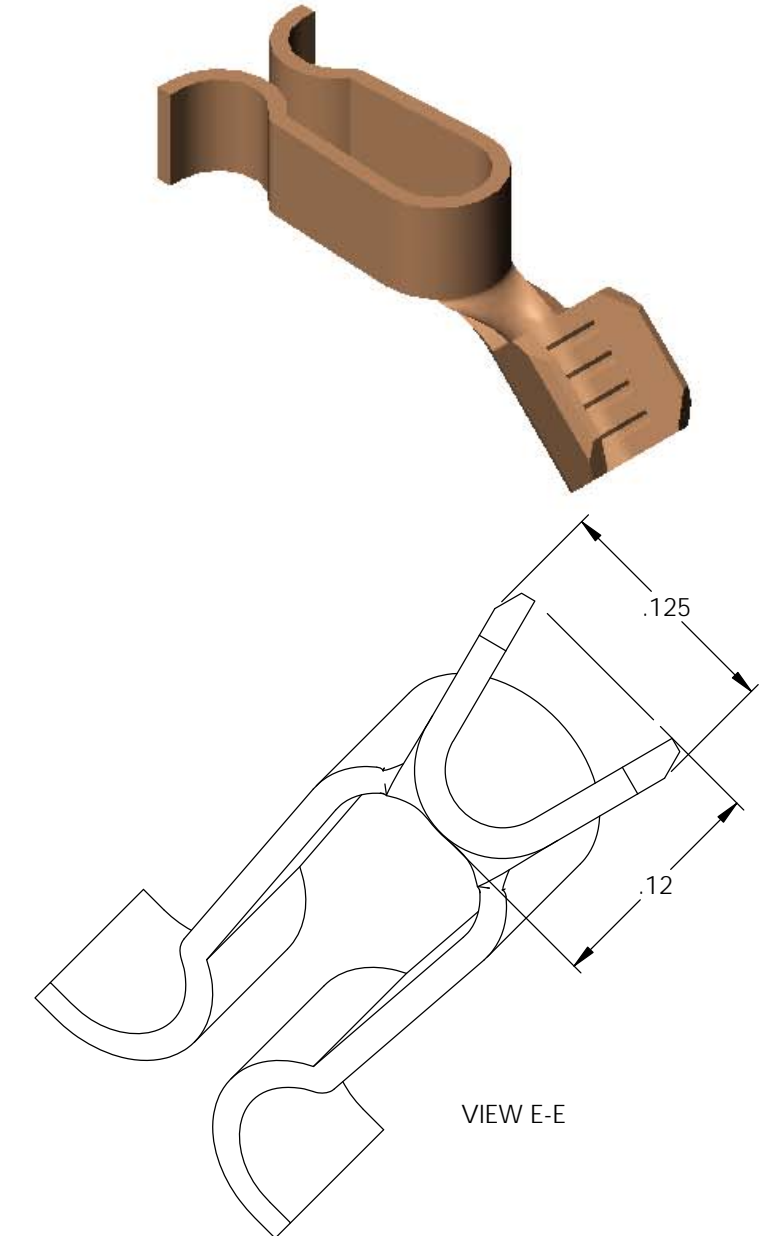
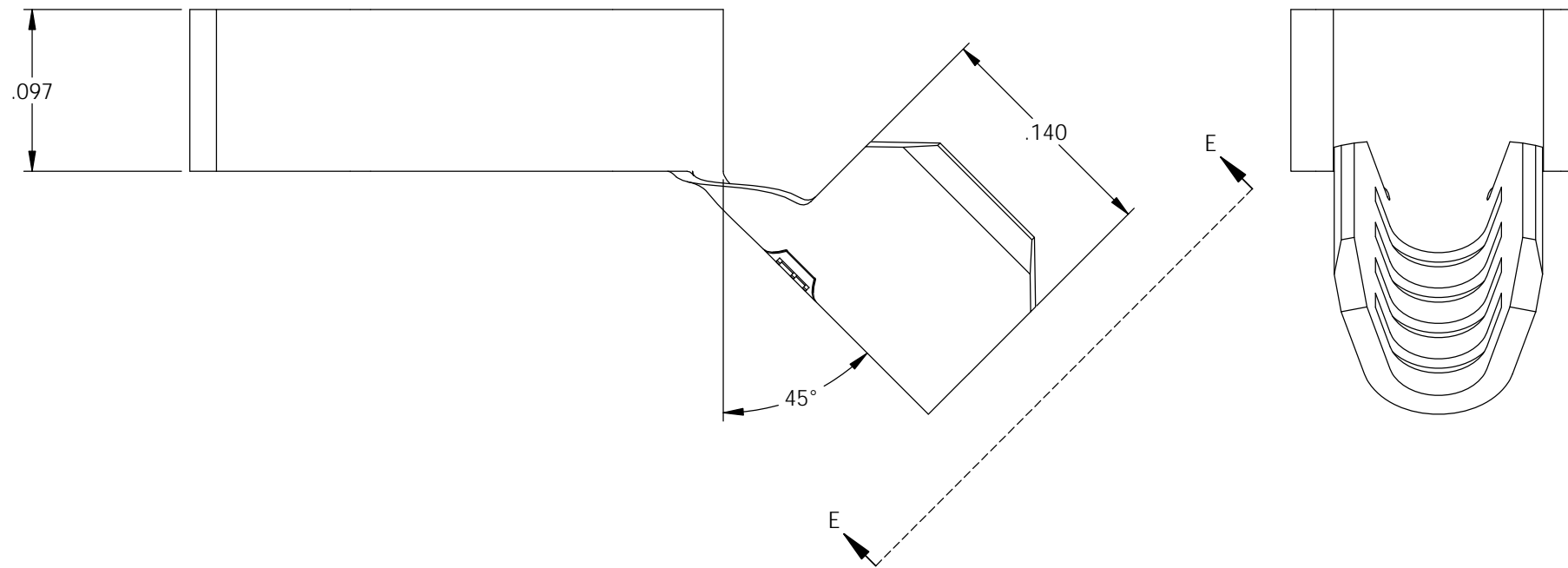
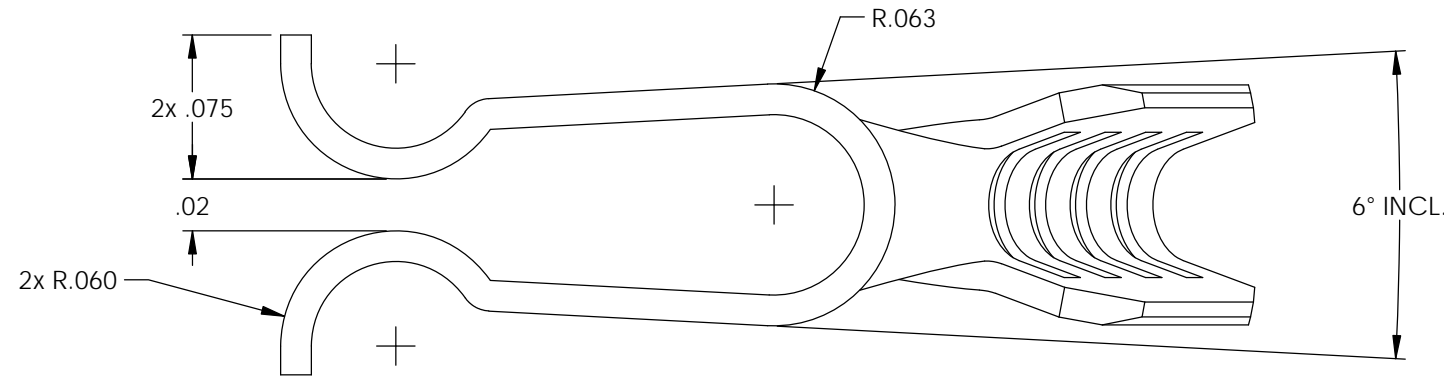

UNCONTROLLED COPY

 THIRD ANGLE PROJECTION TOLERANCES UNLESS OTHERWISE SPECIFIED INCHES: .XX - ±.030 .XXX - ±.015 ANGLES: ±5°	TOOL NO. 0217	Title: Contact		
		DO NOT SCALE DWG.	Drawn By: S.Johnson	Date: 3/18/14
		ETCO Incorporated Engineered Products 25 Bellows Street Warwick, RI 02888 Phone: (401) 467-2400 Fax: (401) 467-9230 www.ETCO.com	Chk'd/App'd By:	Scale: 10X Size B
		Dwg. No.: LSWB2 cust		