

NOTES:

1. MATERIAL: .032 THICK PRE-TINNED BRASS
#2 TEMPER (1/2 HARD)
PER ETCO METAL CODE 01776.
2. PARTS MAY BE COATED WITH A LIGHT FILM OF LUBRICATION
USED IN THE MANUFACTURING PROCESS.

P/C	DESCRIPTION
08112	MB250-THB

Rev.	Description of Change/ SCN#	Date
3	REDRAWN ON SOLIDWORKS WITHOUT CHANGE COR ORG.ENG.DWG.DATE: 5-3-93	2/22/06

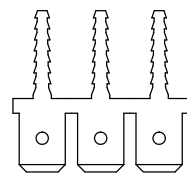
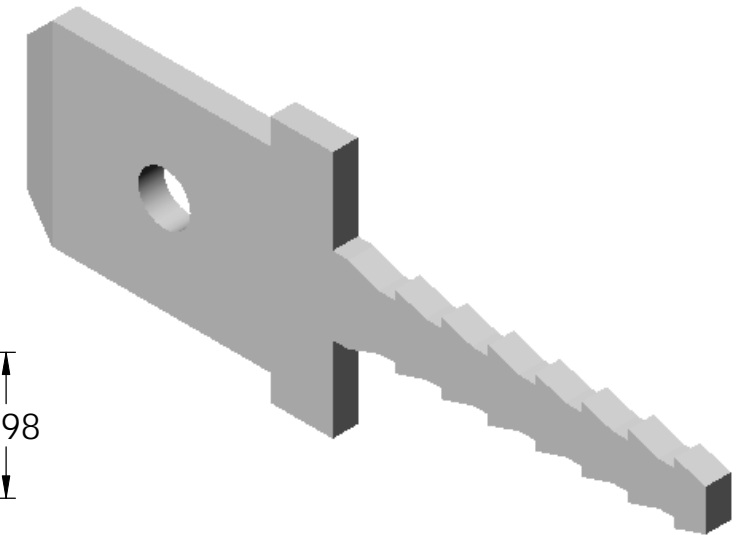
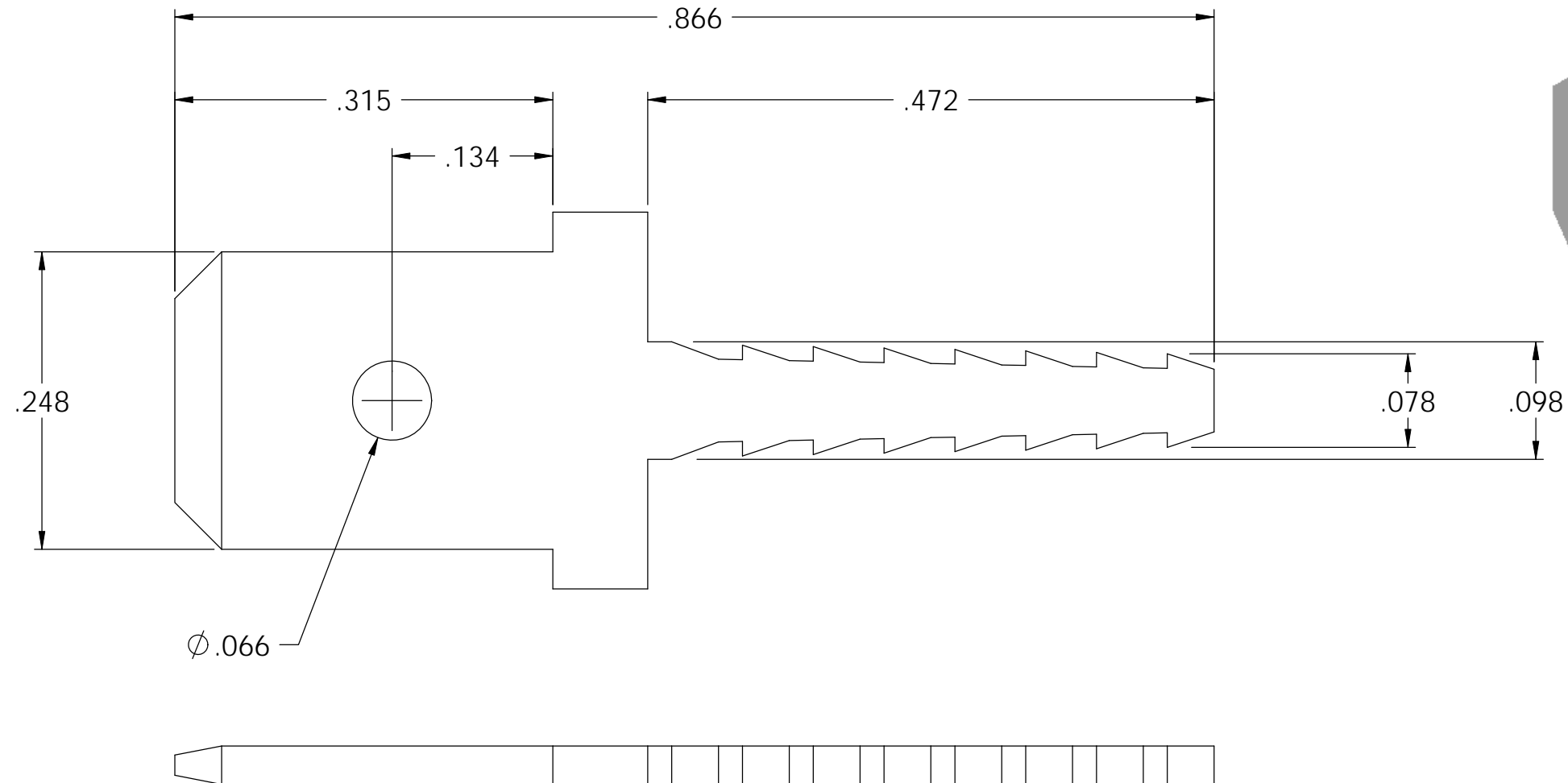

DIRECTION EXITING TOOL
MALE END TO THE FRONT

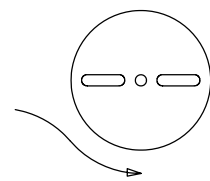

DIRECTION TOWARDS APPLICATOR,
MALE END TO THE REAR

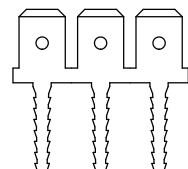
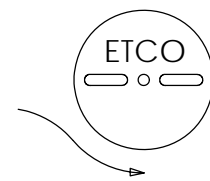

UNCONTROLLED COPY

<p>THIRD ANGLE PROJECTION TOLERANCES UNLESS OTHERWISE SPECIFIED INCHES: .XX - ±.030 .XXX - ±.015 ANGLES: ±5°</p>	<p>TOOL NO. 0673</p>	<p>Title: MALE BOBBIN PIN</p>		
		<p>DO NOT SCALE DWG.</p>	<p>Drawn By: C. O'REILLY</p>	<p>Date: 2/22/06</p>
<p>ETCO Incorporated Engineered Products 25 Bellows Street Warwick, RI 02888 Phone: (401) 467-2400 Fax: (401) 467-9230 www.ETCO.com</p>		<p>Chk'd/App'd By:</p>	<p>Scale: 8X</p>	<p>Size B</p>
		<p>Dwg. No.: MB250 cust</p>		