

NOTE:

- 1.) MAT'L: .010 THK., BRASS, #2 TEMPER (HALF HARD), PER ETCO METAL CODE NO. 05004.
- 2.) MAT'L: .010 THK., PRE-TINNED BRASS, #2 TEMPER (HALF HARD), PER ETCO METAL CODE NO. 01045.
- 3.) PARTS MAY BE COATED WITH A LIGHT FILM OF LUBRICATION USED IN THE MANUFACTURING PROCESS.
- 4.) \* DIMENSIONS ARE BEFORE COINING.
- 5.) WIRE RANGE: 26-22 AWG.
- 6.) INSULATION RANGE:  $\phi$ .040 -  $\phi$ .060

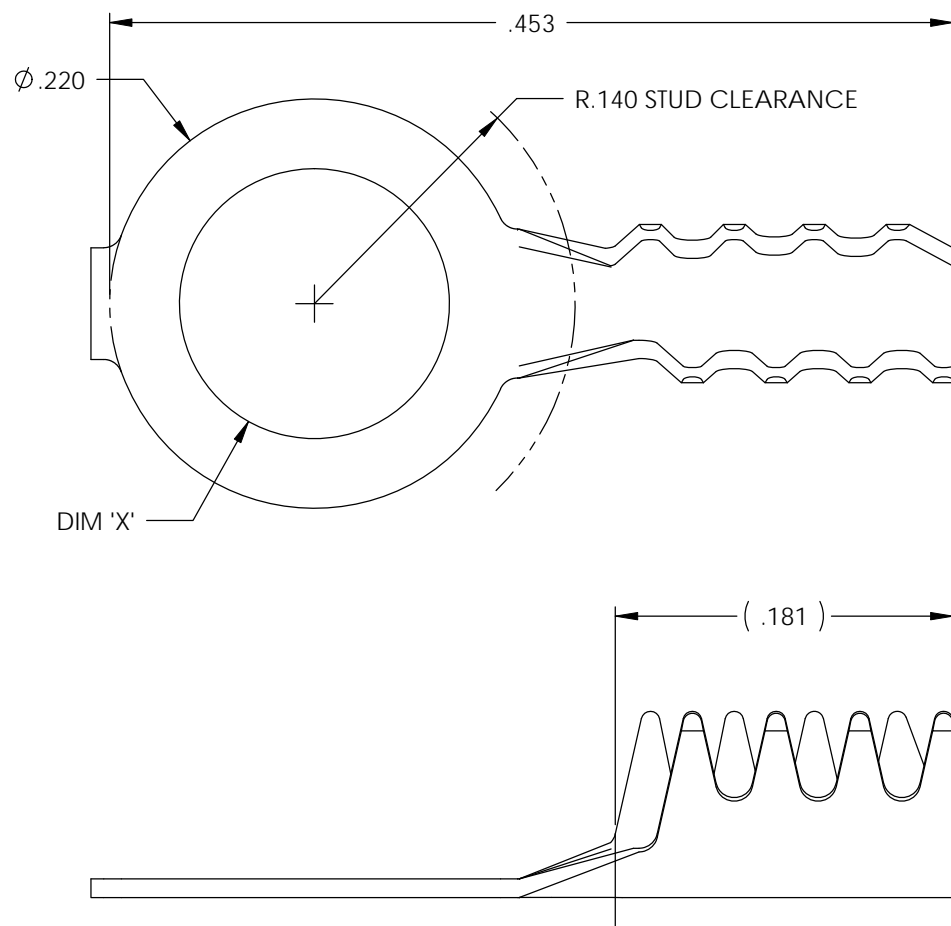

P/C	DESCRIPTION	DIM 'X'	MAT'L
04883	PR55-4-HB	$\phi$ .119	NOTE 1
04884	PR55-4-THB	$\phi$ .119	NOTE 2
04885	PR55-6-THB	$\phi$ .145	NOTE 2
04886	PR55-6-HB	$\phi$ .145	NOTE 1

Rev.	Description of Change/ SCN#	Date
1	SCN# 102146 SCJ ORG.ENG.DWG.DATE: 7-26-91	3-11-03
2	ADDED P/Cs SCN#140162 SCJ	8-1-07
3	SCN-140363 JMR	5-13-08

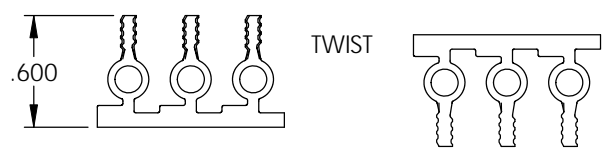
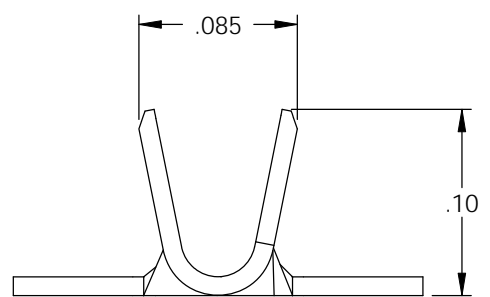

DIRECTION EXITING TOOL,  
EARS UP, TO THE BACK.  
TWIST FINISHED TERMINALS  
AND WIND OVER.

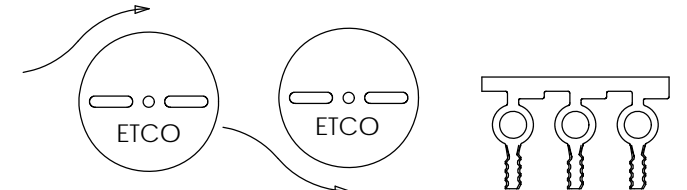

DIRECTION TOWARD APPLICATOR,  
EARS UP, TO THE FRONT.

THIS PRINT IS THE PROPERTY OF ETCO INCORPORATED. NO PART OF THIS DESIGN MAY BE USED IN ANY WAY WITHOUT WRITTEN CONSENT FROM ETCO INCORPORATED.

# UNCONTROLLED COPY

<p>THIRD ANGLE PROJECTION TOLERANCES UNLESS OTHERWISE SPECIFIED INCHES: .XX - <math>\pm</math>.030 .XXX - <math>\pm</math>.015 ANGLES: <math>\pm</math>5°</p>	<p>TOOL NO. <b>0250</b></p>	<p>Title: <b>INSULATION PIERCING RING</b></p>		
		<p>DO NOT SCALE DWG.</p>	<p>Drawn By: S.JOHNSON</p>	<p>Date: 3-11-03</p>
<p>ETCO Incorporated Engineered Products 25 Bellows Street Warwick, RI 02888 Phone: (401) 467-2400 Fax: (401) 467-9230 www.ETCO.com</p>		<p>Chk'd/App'd By:</p>	<p>Scale: 10X</p>	<p>Size <b>B</b></p>
		<p>Dwg. No.: <b>PR55 cust</b></p>		