

NOTE:

- 1.) MAT'L: .050 THK., BRASS, #2 TEMPER (HALF HARD), PER ETCO METAL CODE NO. 07039.
- 2.) MAT'L: .050 THK., PRE-TINNED BRASS, #2 TEMPER (HALF HARD), PER ETCO METAL CODE NO. 01882.
- 3.) PARTS MAY BE COATED WITH A LIGHT FILM OF LUBRICATION USED IN THE MANUFACTURING PROCESS.
- 4.) WIRE RANGE: 8-10 AWG.
- 5.) INSUL RANGE: ϕ .165-.350

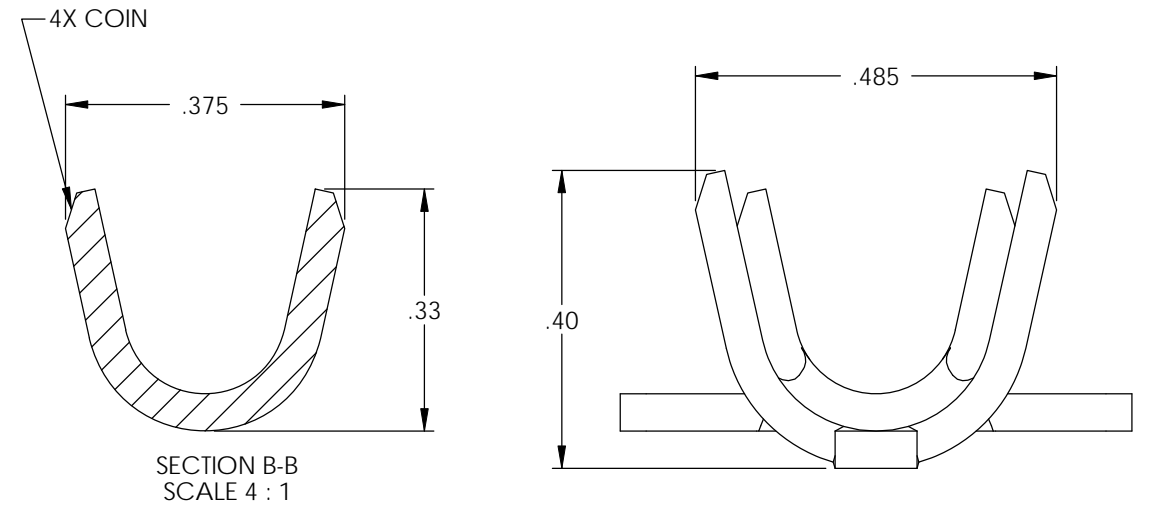
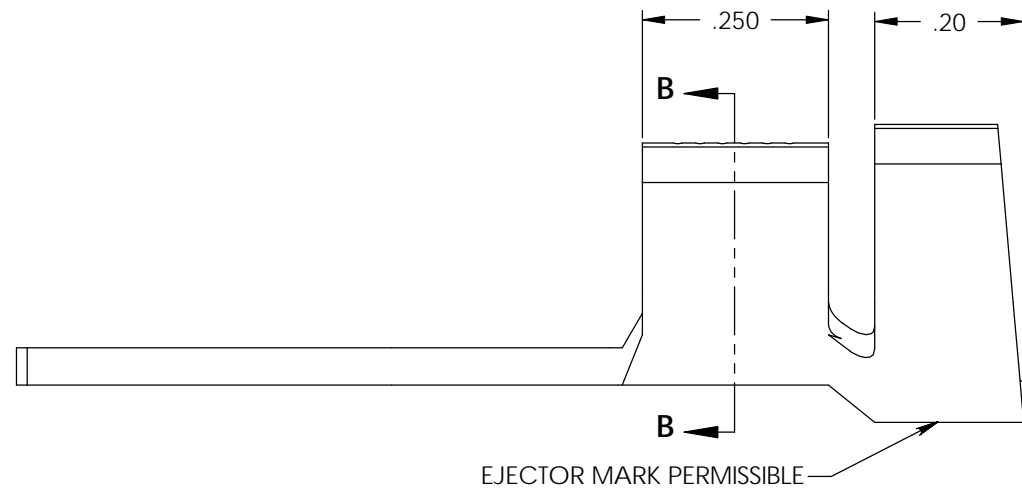
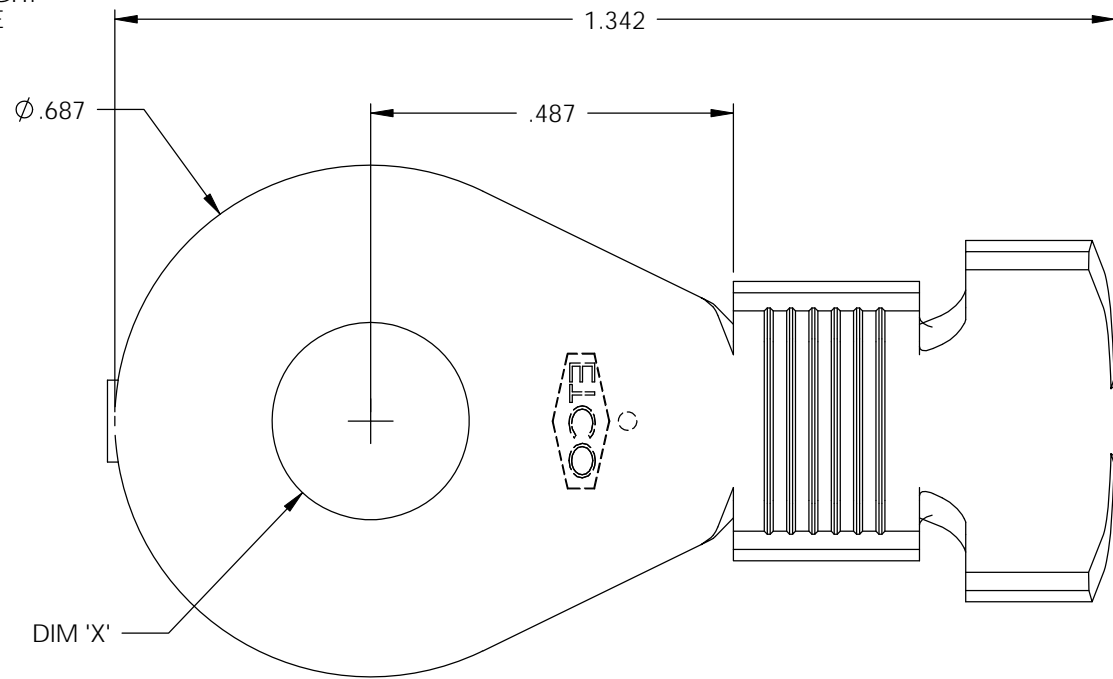

P/C	DESCRIPTION	DIM 'X'	MAT'L
83040	R482E-10-THB	ϕ .197	NOTE 2
83041	R482E-1/4-THB	ϕ .265	NOTE 2
83042	R482E-5/16-THB	ϕ .328	NOTE 2
83043	R482E-3/8-THB	ϕ .406	NOTE 2
83044	R482E-1/2-THB	ϕ .515	NOTE 2

Rev.	Description of Change/ SCN#	Date
1	REDRAWN ON SOLIDWORKS NO CHANGES SCJ ORG.ENG.DWG.DATE: 2-11-93	5-5-03
2	SCN# 102525 SCJ	3-26-04
3	SCN# 102735 SCJ	11-1-04
4	UPDATED FORMAT SCN#140162 SCJ	9-25-07

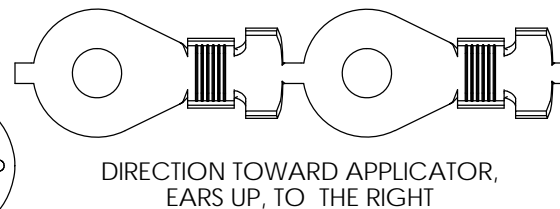
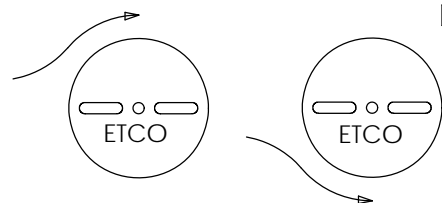
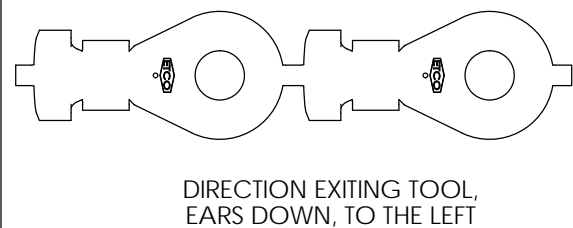
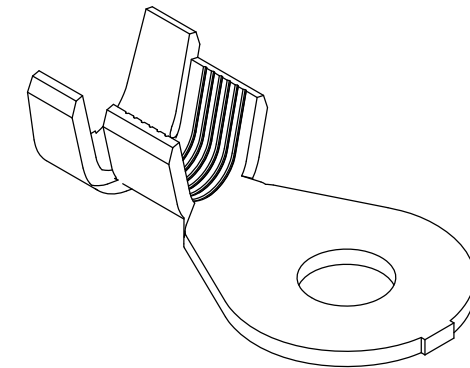

THIS PRINT IS THE PROPERTY OF ETCO INCORPORATED. NO PART OF THIS DESIGN MAY BE USED IN ANY WAY WITHOUT WRITTEN CONSENT FROM ETCO INCORPORATED.

UNCONTROLLED COPY

<p>THIRD ANGLE PROJECTION TOLERANCES UNLESS OTHERWISE SPECIFIED INCHES: .XX - \pm.030 .XXX - \pm.015 ANGLES: \pm5°</p>	<p>TOOL NO. 0739</p>	<p>Title: RING TERMINAL</p>		
		<p>DO NOT SCALE DWG.</p>	<p>Drawn By: S.JOHNSON</p>	<p>Date: 5-5-03</p>
<p>ETCO Incorporated Engineered Products 25 Bellows Street Warwick, RI 02888 Phone: (401) 467-2400 Fax: (401) 467-9230 www.ETCO.com</p>		<p>Chk'd/App'd By:</p>	<p>Scale: 4X</p>	<p>Size B</p>
		<p>Dwg. No.: R482E cust</p>		