

NOTES:

1. MATERIAL: .060 THICK C26000 BRASS; 1/2 HARD, ANNEALED TO TEMPER, PER ETCO METAL CODE 07032.
2. MATERIAL: .060 THICK C26000 PRE-TINNED BRASS; 1/2 HARD, ANNEALED TO TEMPER, PER ETCO METAL CODE 01900.
3. MATERIAL: .060 THICK C11000 PRE-TINNED COPPER; 1/2 HARD, PER ETCO METAL CODE 00223.
4. PARTS MAY BE COATED WITH A LIGHT FILM OF LUBRICATION USED IN THE MANUFACTURING PROCESS.
5. WIRE RANGE: #4-#6 AWG.

P/C	DESCRIPTION	MAT'L	DIM 'X'
82350	R553E-350-HB	NOTE 1	Ø .355-.345
82352	R553E-14-HB	NOTE 1	Ø .255-.245
82354	R553E-275-THB	NOTE 2	Ø .280-.270
82359	R553E-5/16-THB	NOTE 2	Ø .333-.323
82361	R553E-275-HB	NOTE 1	Ø .280-.270
82338	R553E-281-HB	NOTE 1	Ø .286-.276
82339	R553E-403-HB	NOTE 1	Ø .408-.398
82344	R553E-437-HB	NOTE 1	Ø .442-.432
82346	R553E-281-TCU	NOTE 3	Ø .286-.276
82348	R553E-403-TCU	NOTE 3	Ø .408-.398
82349	R553E-437-TCU	NOTE 3	Ø .442-.432

Rev.	Description of Change/ SCN#	Date
-	INITIAL RELEASE SCN#140184 SCJ	6-1-07

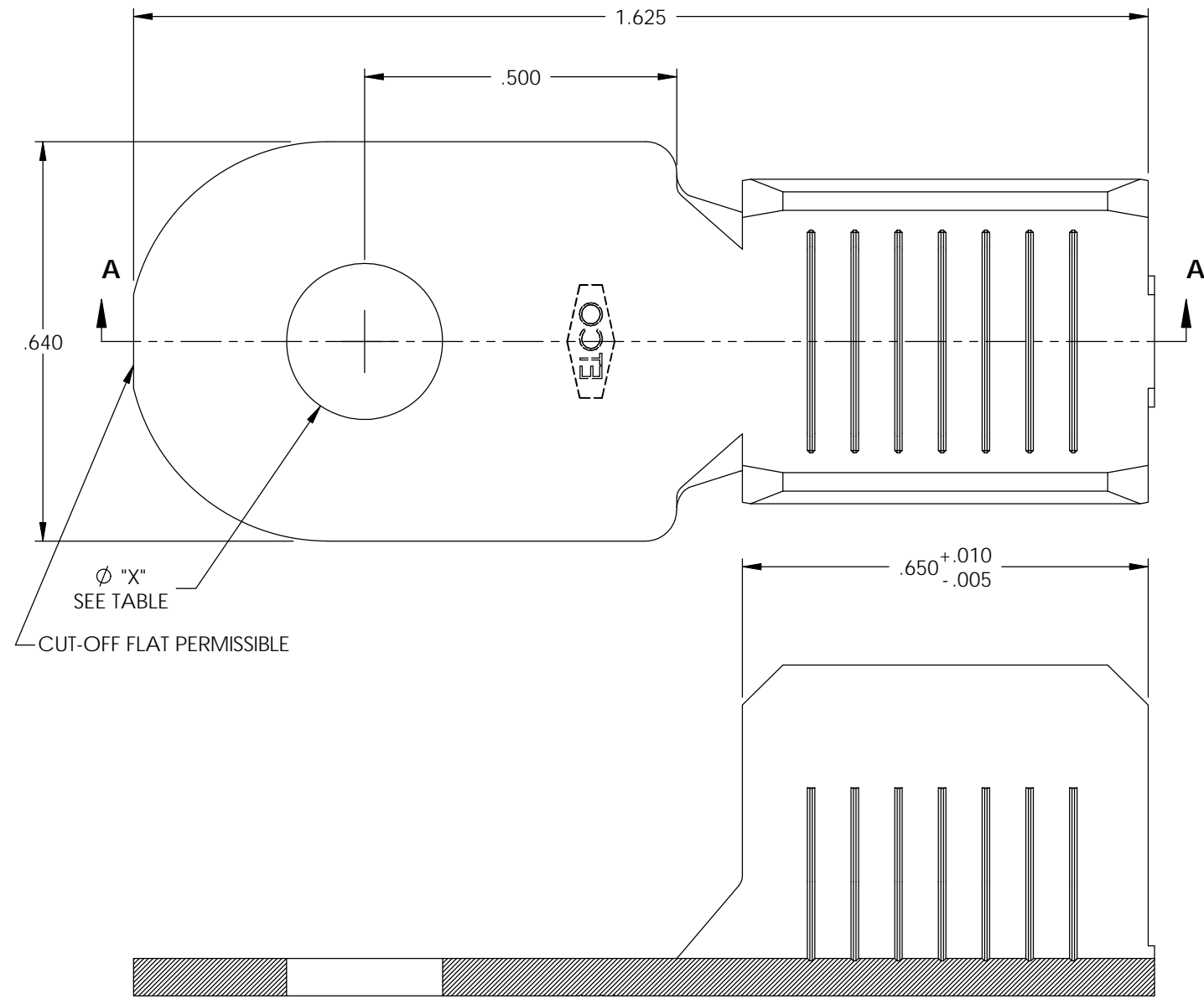

SECTION A-A

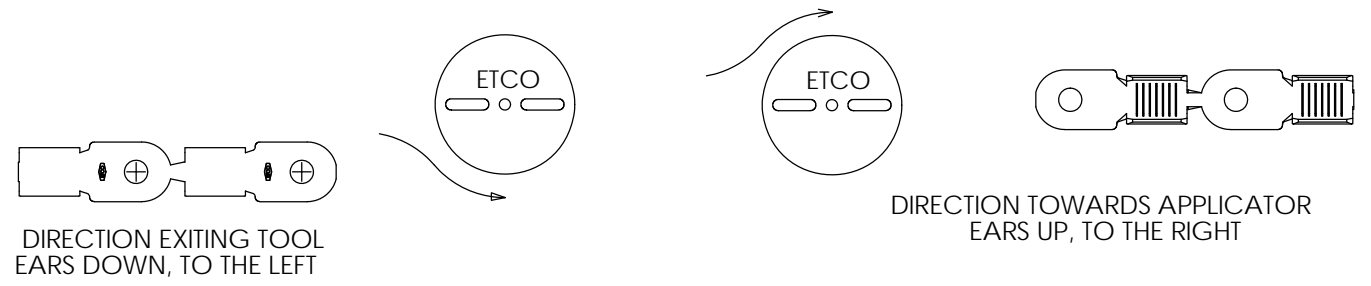
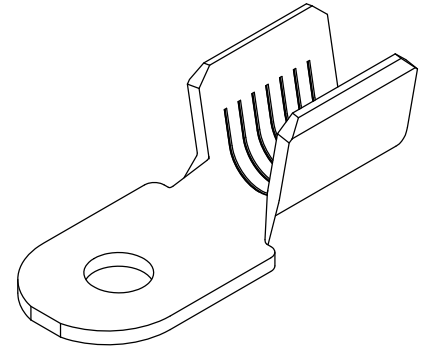
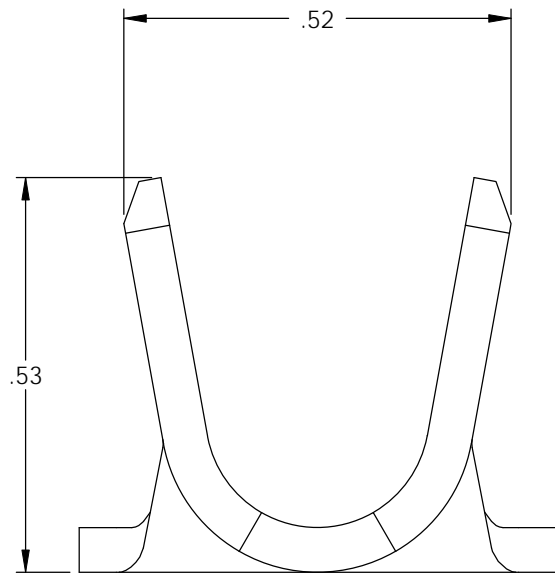

UNCONTROLLED COPY

<p>THIRD ANGLE PROJECTION TOLERANCES UNLESS OTHERWISE SPECIFIED INCHES: .XX - ±.030 .XXX - ±.015 ANGLES: ±5°</p>	<p>TOOL NO. 0843</p>	<p>Title: RING TERMINAL</p>		
		<p>DO NOT SCALE DWG.</p>	<p>Drawn By: S.JOHNSON</p>	<p>Date: 6-1-07</p>
<p>ETCO Incorporated Engineered Products 25 Bellows Street Warwick, RI 02888 Phone: (401) 467-2400 Fax: (401) 467-9230 www.ETCO.com</p>		<p>Chk'd/App'd By:</p>	<p>Scale: 4X</p>	<p>Size B</p>
		<p>Dwg. No.: R553E cust</p>		